

REGISTER'S OFFICE  
Forest County, Wis.

Received for record this 15<sup>th</sup> day  
of January A.D., 2002 at  
1:00 o'clock P. M. and recorded  
in Vol. Corner Restoration  
page J-5,6.

174279

Kay Swanson, Deputy  
Register of Deeds

U.S. PUBLIC LAND SURVEY MONUMENT RECORD

(As Required by WI Adm. Code)

History of original corner establishment and subsequent restorations and descriptions of any record, monument, occupational, testimonial or other evidence considered:

1865 - James Nowlin, set original corner post and made the following B.T.'s:

Spruce, 7", N 85° E, 7 lks., 4.62 feet.

Spruce, 8", S 25° W, 6 lks., 3.96 feet.

1960 - Philip T. Hansen, Registered Land Surveyor established the Meander Corner by first establishing the SE corner of the Bonnie Beach Plat from existing lot stakes, then he extended line from the North 1/4 of Sec. 17 Westerly through the SE corner of said Plat to the Lake shore for the M.C. A 1 1/4" Dia. Iron Pipe was set at this point.

2001 - I found the 1 1/4" dia. Iron Pipe as set by Hansen. Over the years the winter ice had plowed a large amount of sand over the pipe but the pipe itself had not been disturbed. I accepted the iron pipe as the best possible evidence of the Meander Corner position. I left the iron pipe and set a 2" dia. Forest County Aluminum Monument over it and made new BT's shown below.

Corner was: (Check All That Apply)

- Restored through acceptance of an obliterated evidence location.
- Restored through acceptance of a found perpetuated location.
- Considered a lost corner and reestablished through lost corner proportionate methods (include a plan view drawing showing distances and directions to other Public Land Survey Corners used for proportioning and determining the corner location).
- Restored or reestablished in a location that differs from a previous restoration or reestablishment (include a plan view drawing and indicate what was set and/or found).

Describe the monument and accessories used to perpetuate the location of this corner (include a plan view drawing and indicate what was set and/or found).

LEGEND:

● Set Forest County Aluminum Monument

Note: All distances are taken to nail in side of tree.

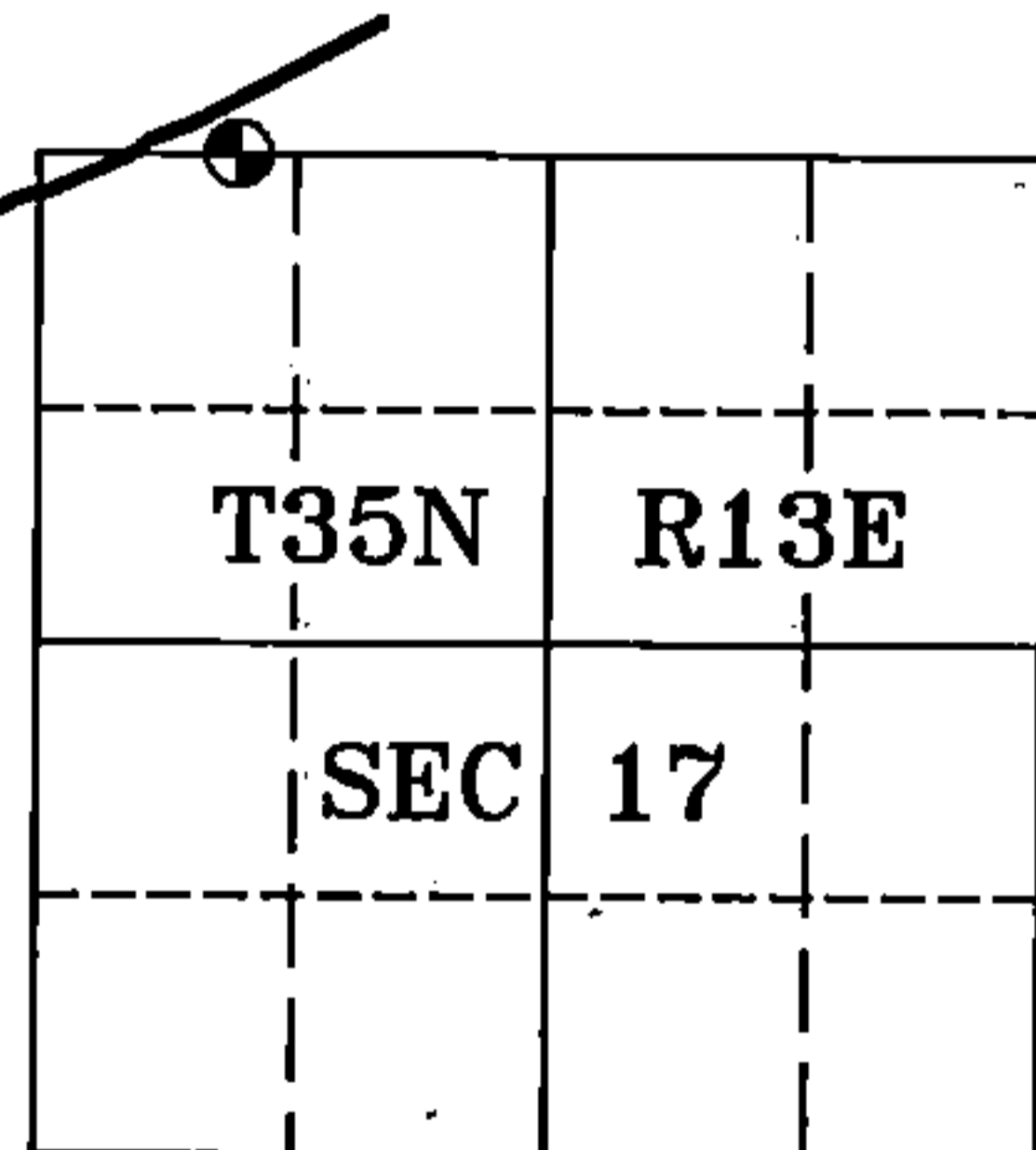
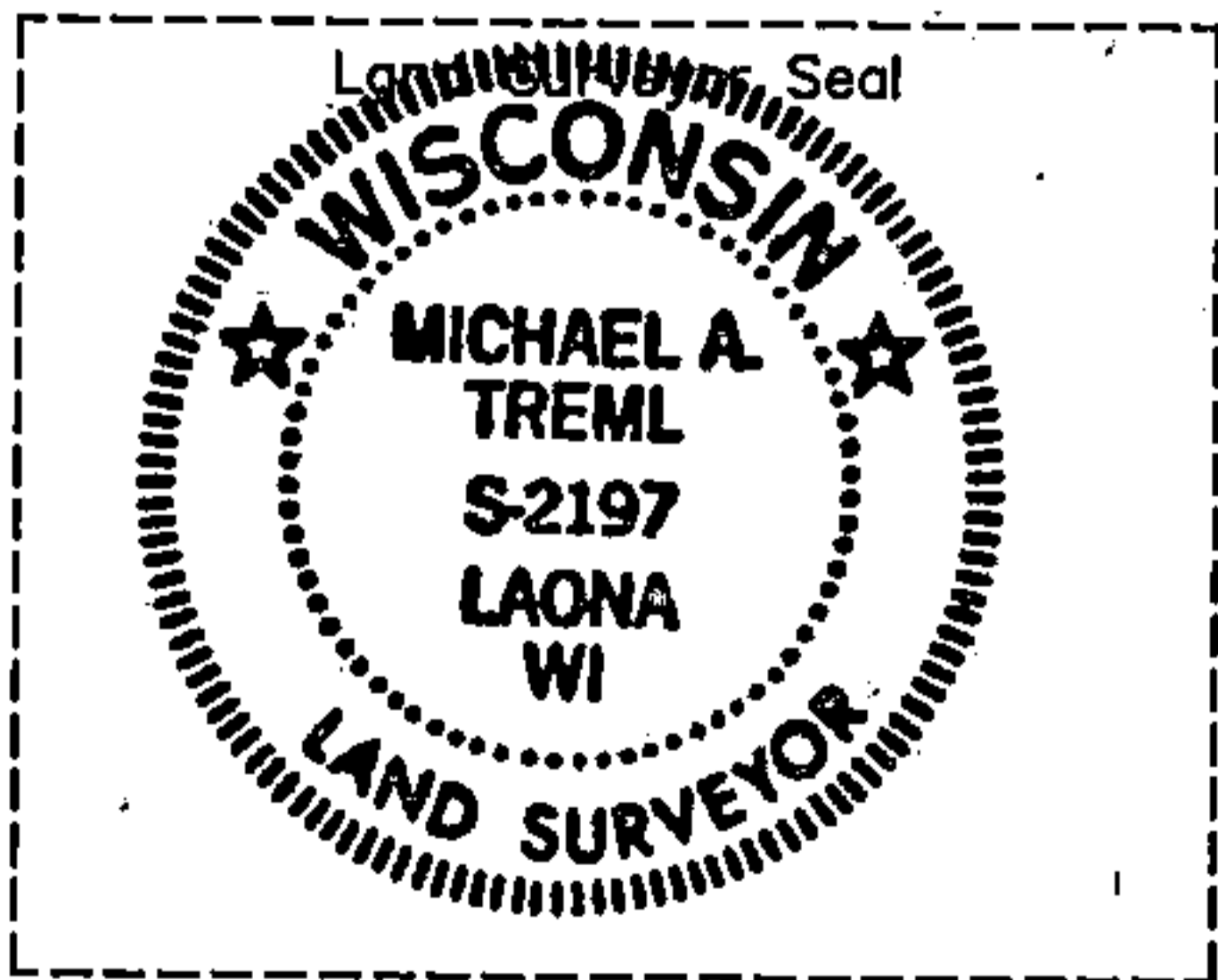
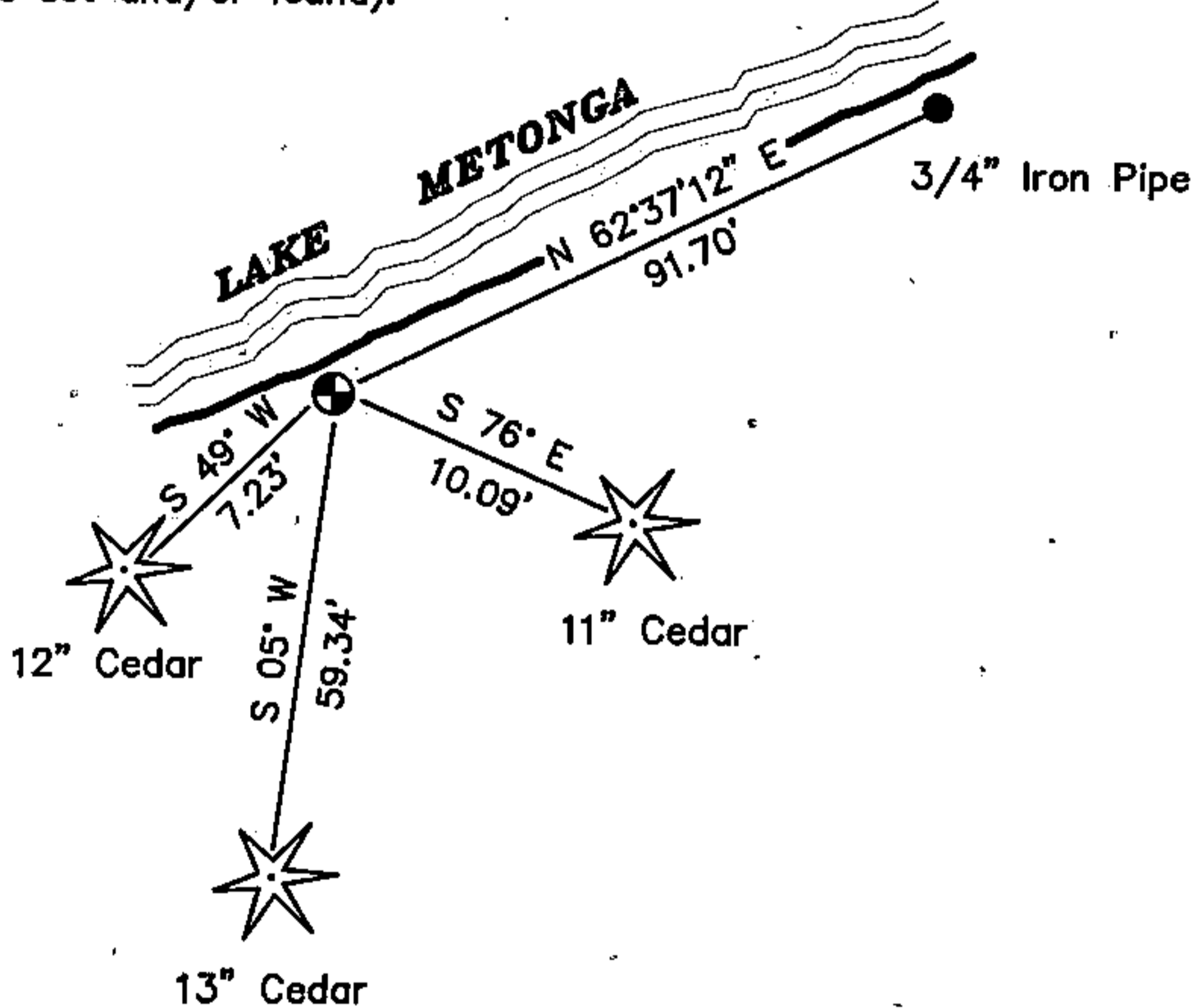

I, Michael A. Trembl, RLS  
(type or print name) certify that the corner location shown on this record was determined by me or under my direction and control and that this U.S. Public Land Survey Monument Record is correct and complete to the best of my knowledge and belief.

Michael A. Trembl 12/21/01  
Signature Date

The North Meander Corner corner of  
Section 17 T. 35 N., R. 13 E.  
Forest County, WI

Index No. J-5,6

43513080028

J-5,6