

CERTIFIED LAND CORNER RESTORATION

Index No. F-19

19

State of Wisconsin }
County of Forest } ss.

History of original corner establishment:

Old fence corner bears N59W 37.50 ft. of established corner. Fence runs south & east.

I Glen Barker, do hereby certify that on the 14th day of October, 1983, I found evidence of the NC 1/16 corner of Section 11 Township 35, North, Range 12 East, Fourth Principal Meridian, as described hereon; and that from this evidence I established a new monument and accessories as described hereon to perpetuate the original location of this corner.

Description of corner evidence found:
total distance from 1/4 corner between Sections 2 & 11 to C1/4 Section 11 is 2719.38 ft.
Set NC 1/16 1359.69 intermediate.

Resident witnesses:

J. Claflin

H. Wagoner

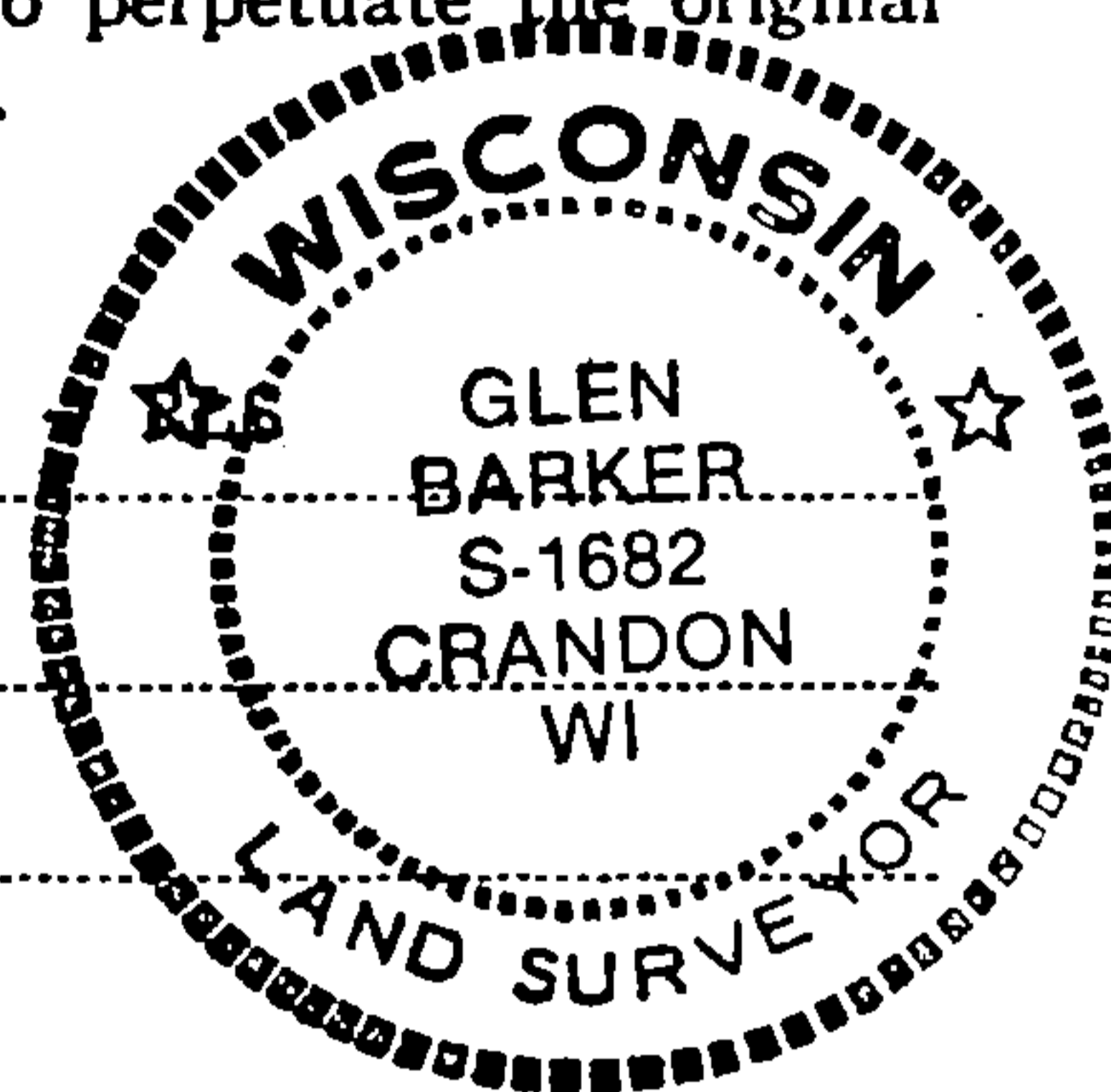

Description of monument and accessories I established to perpetuate the original location of this corner.
Set a 1" iron pipe with 2" diameter alloy cap stamped: S1682

Monument projects 18" above ground. T35N R12E

Marked NBTs

Sugar 6" S33W 5.65 ft. NC 1/16 S 11

Sugar 7" N81E 7.79 ft.

Scribed 1/16 - B.T. CPI - 1983

T35N

R12E

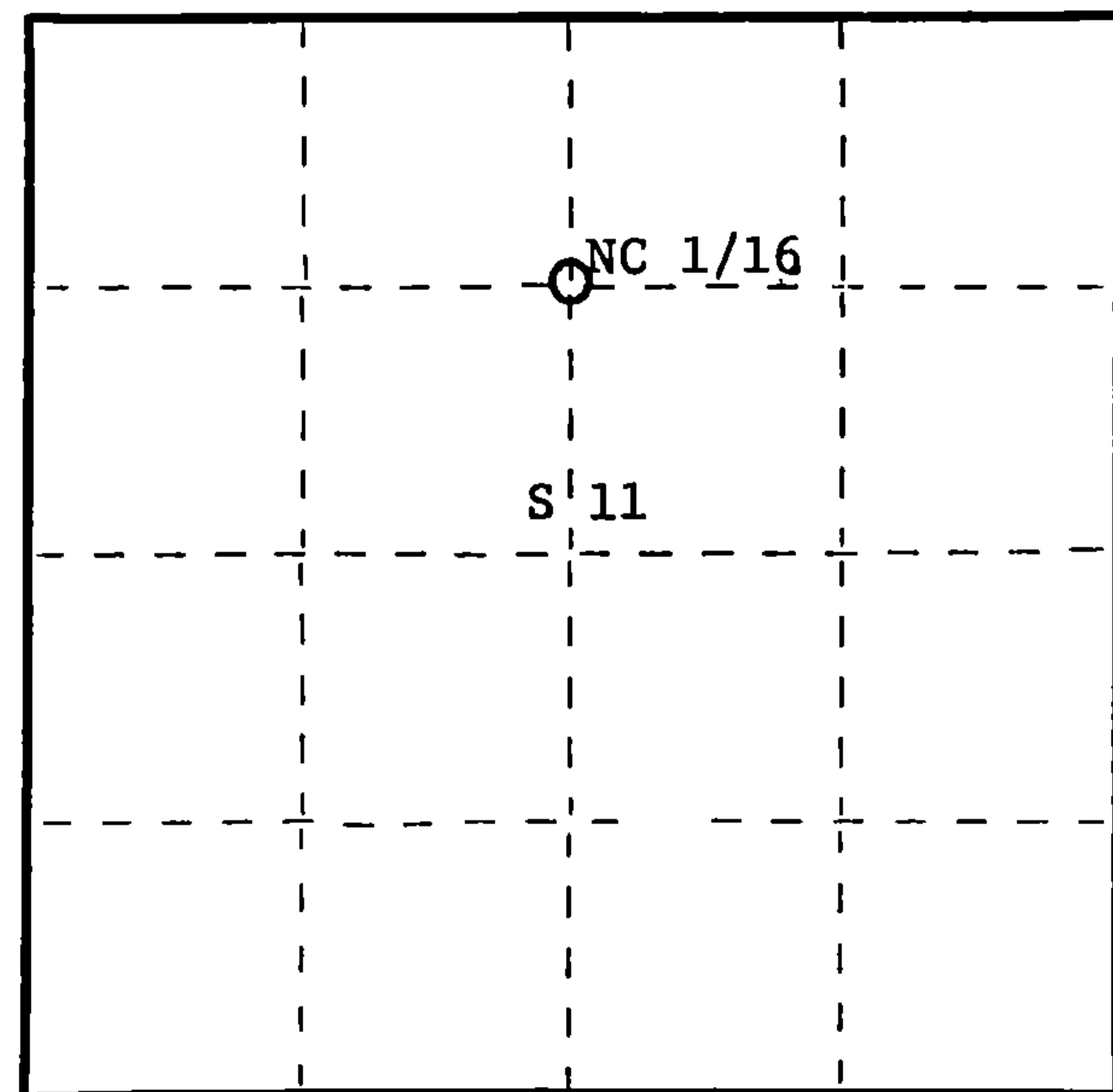

○ = Corner monument restored.

Dated at Rhineland, Wis., this 22nd day of November, 1983.

Signature Glen Barker Title Registered Land Surveyor Registration No. S1682
(County Surveyor, Registered Land Surveyor, or other duly authorized official)

Office of Register of Deeds, County of Forest
I hereby certify that the within instrument was filed in this office for record on the 13th day of December, 1983 at 10:30 o'clock A. M.

Eugene Stutzman
(Register of Deeds)
By _____ Deputy

DOCUMENT NO. **124849**

Stock No. 26272



FORM 983

43512113020