

State of Wisconsin }
County of FOREST } ss.

I WILLIAM F. KELLY, do hereby certify that on the 19th day of MAY, 19 83, I found evidence of the SE corner of SECTION 10 Township 35, North, Range 12 EAST, Fourth Principal Meridian, as described hereon; and that from this evidence I established a new monument and accessories as described hereon to perpetuate the original location of this corner.

Resident witnesses:

.....
.....
.....

FORM 985 M. C. MILLER CO., MILWAUKEE

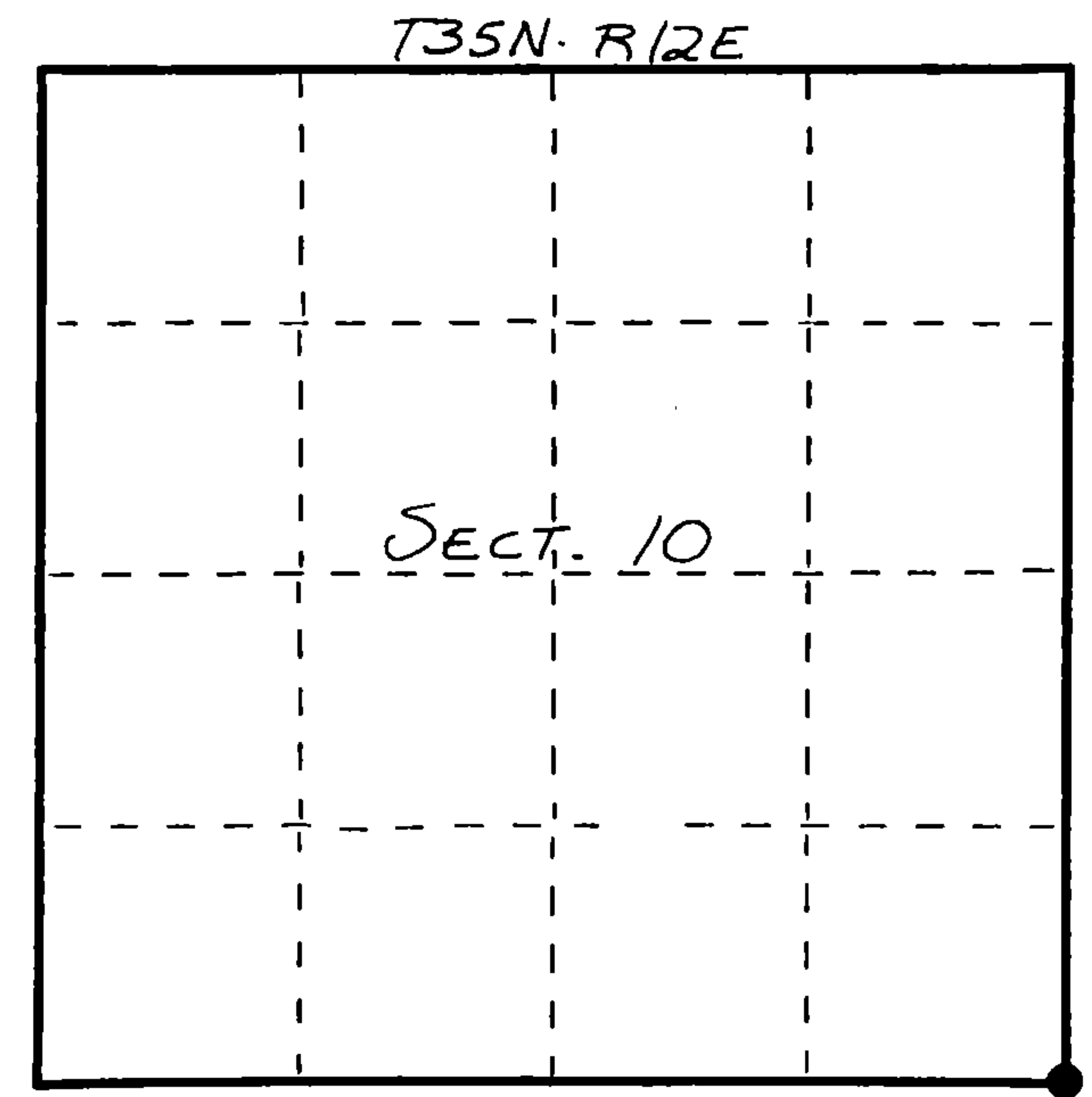

○ = Corner monument restored.

CERTIFIED LAND CORNER RESTORATION
U.S. PUBLIC LAND SURVEY MONUMENT RECORD

History of original corner establishment:
*ORIGINAL CORNER ESTABLISHED BY
JAMES L. NOWLIN IN JUNE-JULY, 1865.*

Description of corner evidence found:

REPLACED 1" IRON PIPE FOUND IN PLACE WITH ALUMINUM CAPPED MONUMENT. SET STONE FILE AROUND CAP.

Description of monument and accessories I established to perpetuate the original location of this corner.

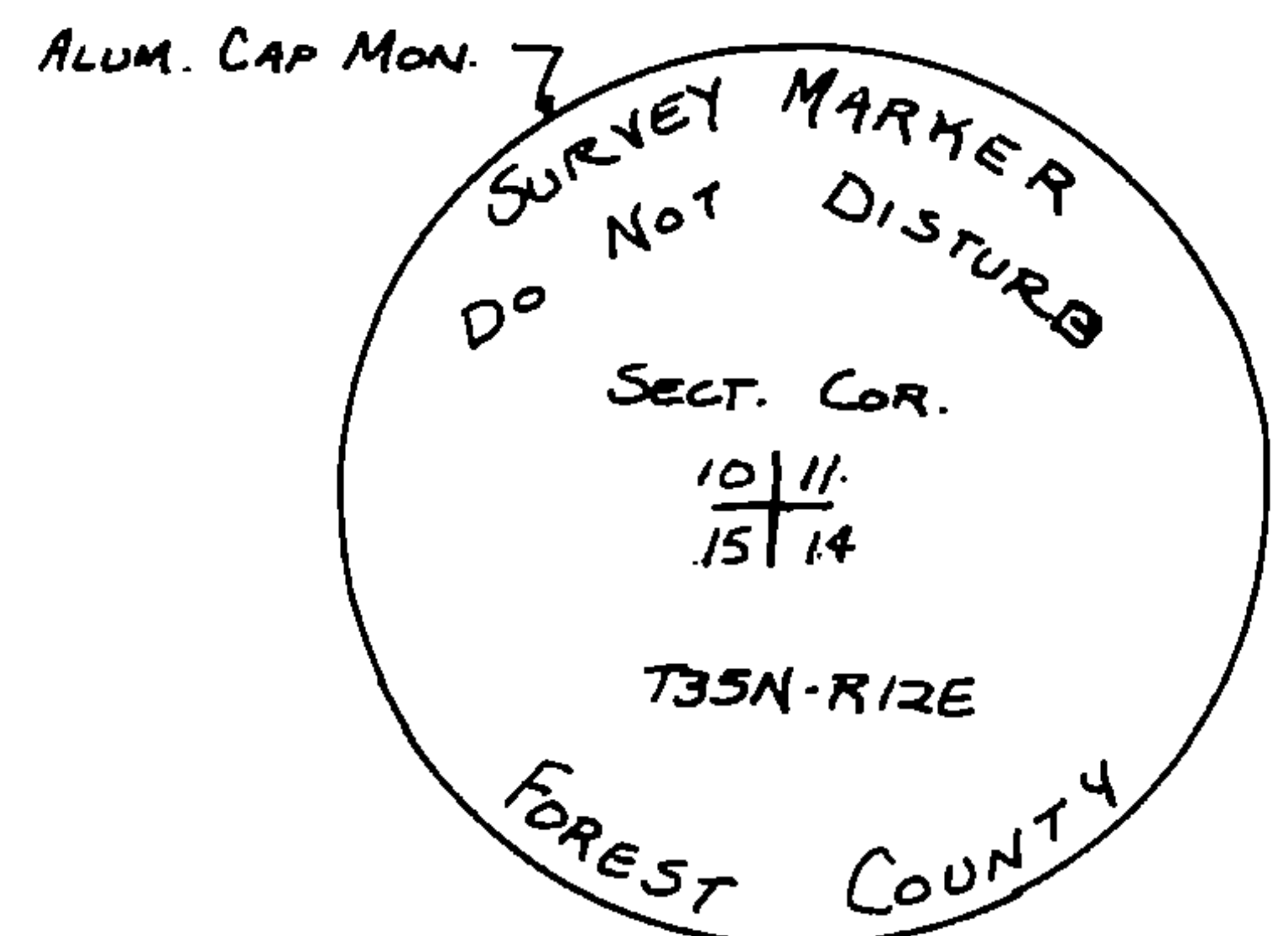
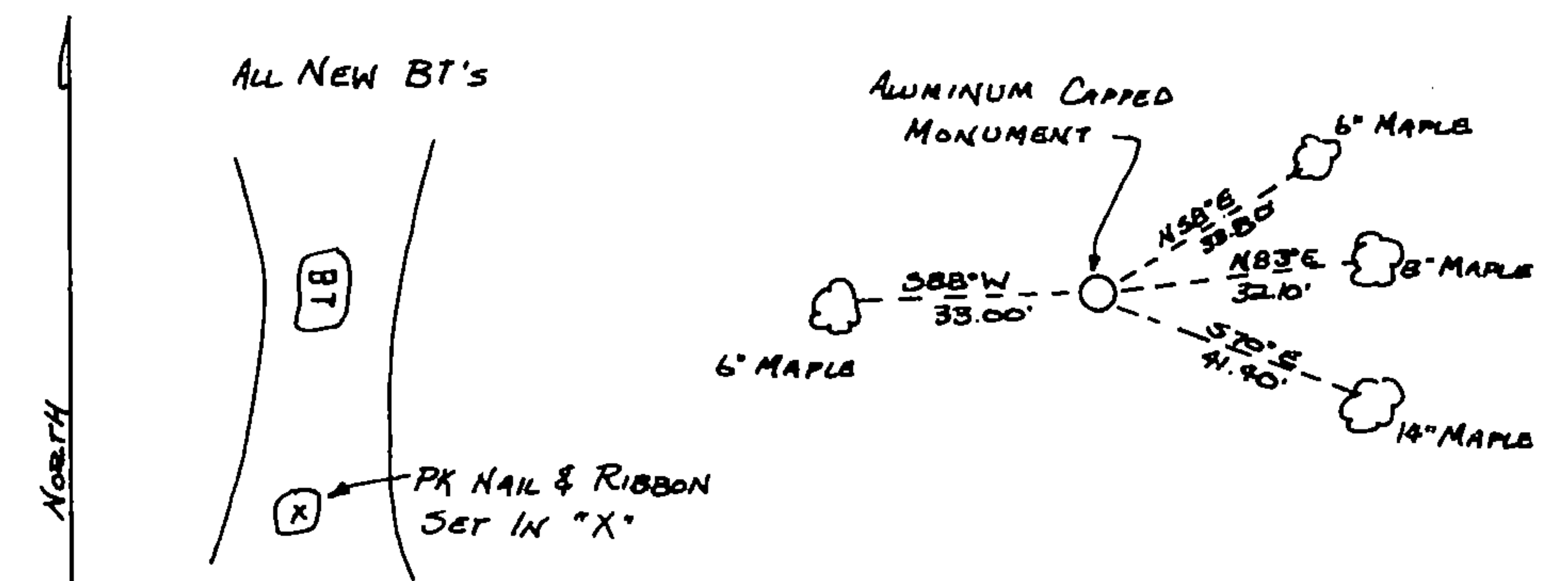

Dated at ELCHO, Wis., this 19th day of MAY, 19 83.

Signature William F. Kelly Title LANGUARD COUNTY SURVEYOR Registration No. 1098
(County Surveyor, Registered Land Surveyor, or other duly authorized official)

Office of Register of Deeds, County of Forest, I hereby certify that the within instrument was filed in this office for record on the 27th day of May, 19 83 at 11:00 o'clock A. M.

Eugene Stasiak
(Register of Deeds)

By..... Deputy

DOCUMENT NO.
123471

43512100000