

CERTIFIED LAND CORNER RESTORATION

Index No. E-12

State of Wisconsin }
County of Forest } ss.

I Philip T. Hansen, do hereby certify that on the 23rd day of May, 19 77, I ~~found~~ established ~~corner~~ of the E 1/16 corner of Section 4 & 9 Township 35, North, Range 12 East, Fourth Principal Meridian, as described hereon; and that from this evidence I established a new monument and accessories as described hereon to perpetuate the original location of this corner.

Resident witnesses:

Glen Barker

Jim Claflin

Herb Wagoner

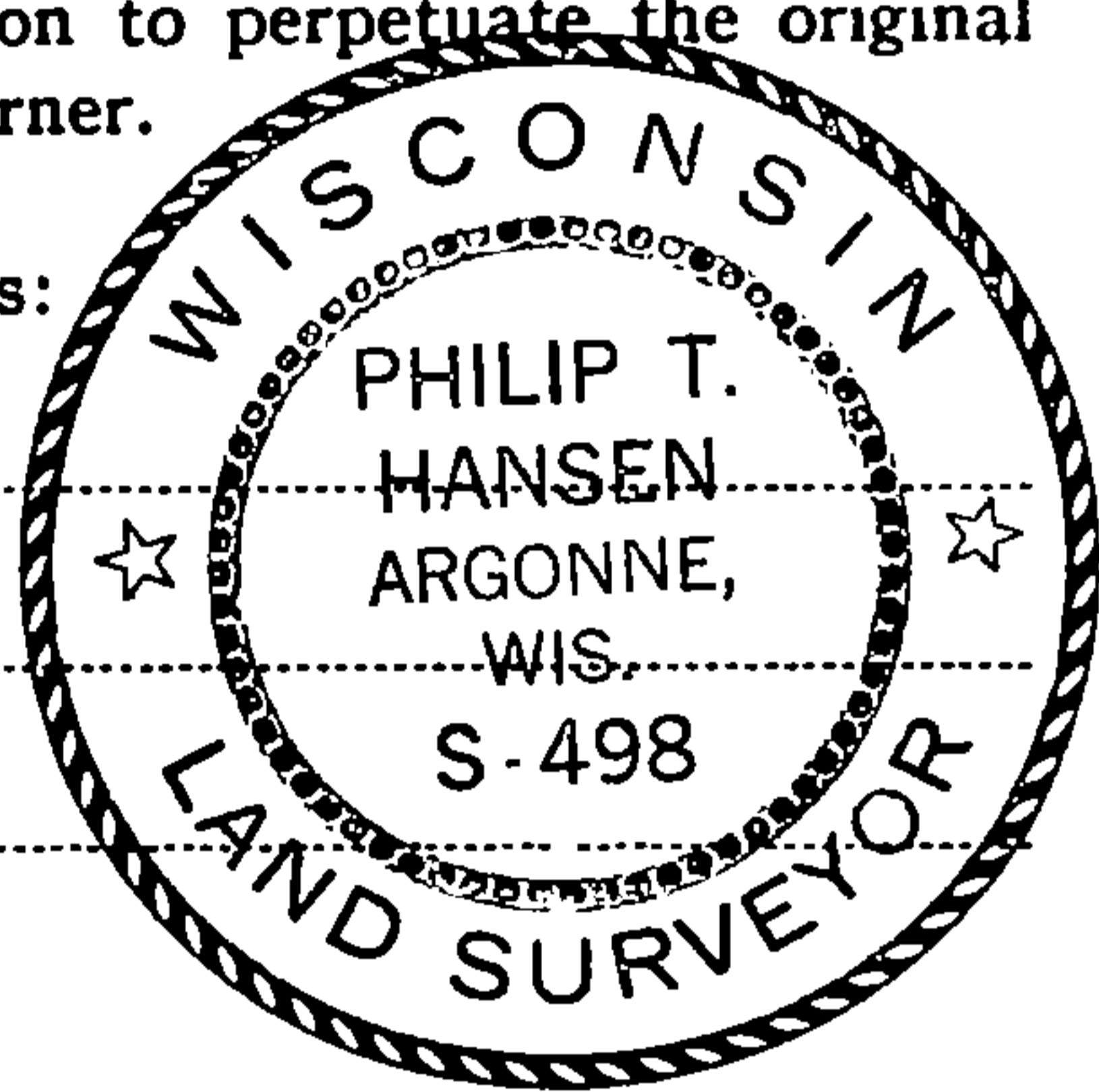

T35N R12E

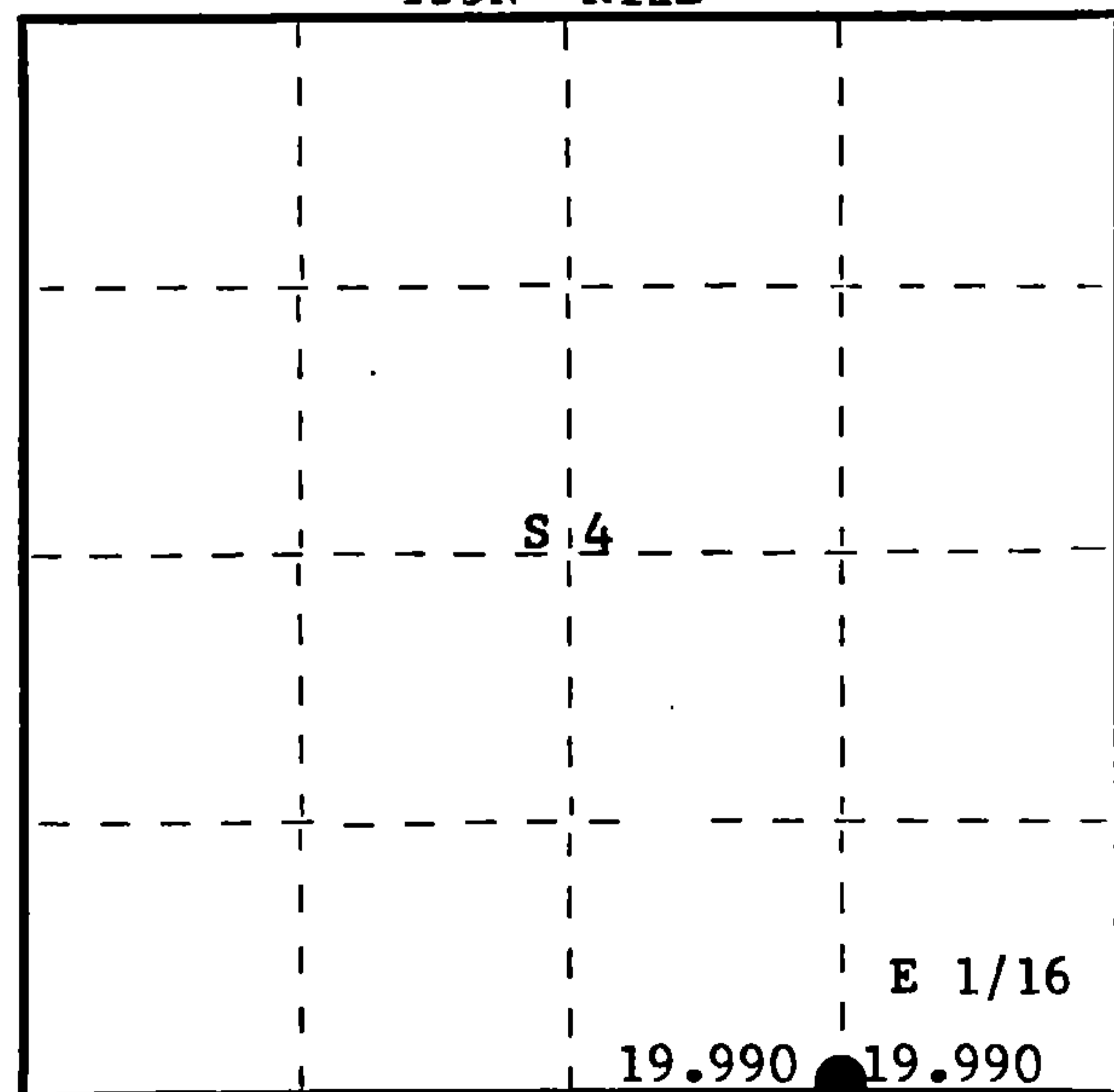

○ = Corner monument restored.

History of original corner establishment:
No records on file of any survey for this corner.

Description of corner evidence found:

No evidence found of corner or BT after extensive search.
Corner set by proportion, ran traverse from recovered 1/4 corner between Section 4 and 9, and Section Corner 3, 4, 9 and 10. Computed distance 39.98 chains, bearing N 89° 24' 34"
Set corner at 19.990 chains intermediate.

Description of monument and accessories I established to perpetuate the original location of this corner.

Set 1 1/2" iron pipe with 2" brass cap, stamped:
Monument projects 24" above ground.
Marked NBTs - Sugar 6" S80°W, 4.2 links, scribed 1/16 BT.
Sugar 8" S43°E, 19.5 links, scribed 1/16 BT.

S498
T35N R12E
E 1/16 $\frac{S}{S} \frac{4}{9}$
CPI-1977

Dated at Rhineland, Wis., this 31st day of May, 19 77.

Signature Philip T. Hansen Title Registered Land Surveyor Registration No. S-498
(County Surveyor, Registered Land Surveyor, or other duly authorized official)

Office of Register of Deeds, County of Forest, I hereby certify that the within instrument was filed in this office for record on the 6th day of July, 19 77 at 3:30 o'clock P. M.

Eugene Steatyn
(Register of Deeds)

By _____ Deputy

DOCUMENT NUMBER
111819

FORM 985

4351204010