

U.S. PUBLIC LAND SURVEY MONUMENT RECORD

Index No. N.O-17

State of Wisconsin }
 County of Forest } ss.

I, Gary L. Pisoni, do hereby certify that on the 16th day of July, 1991, I found evidence of the Meander Corner ~~corner~~ between Sections 22 and 23 Township 41, North, Range 14 East, Fourth Principal Meridian, as described hereon; and that from this evidence I established a new monument and accessories as described hereon to perpetuate the original location of this corner.

Resident witnesses:

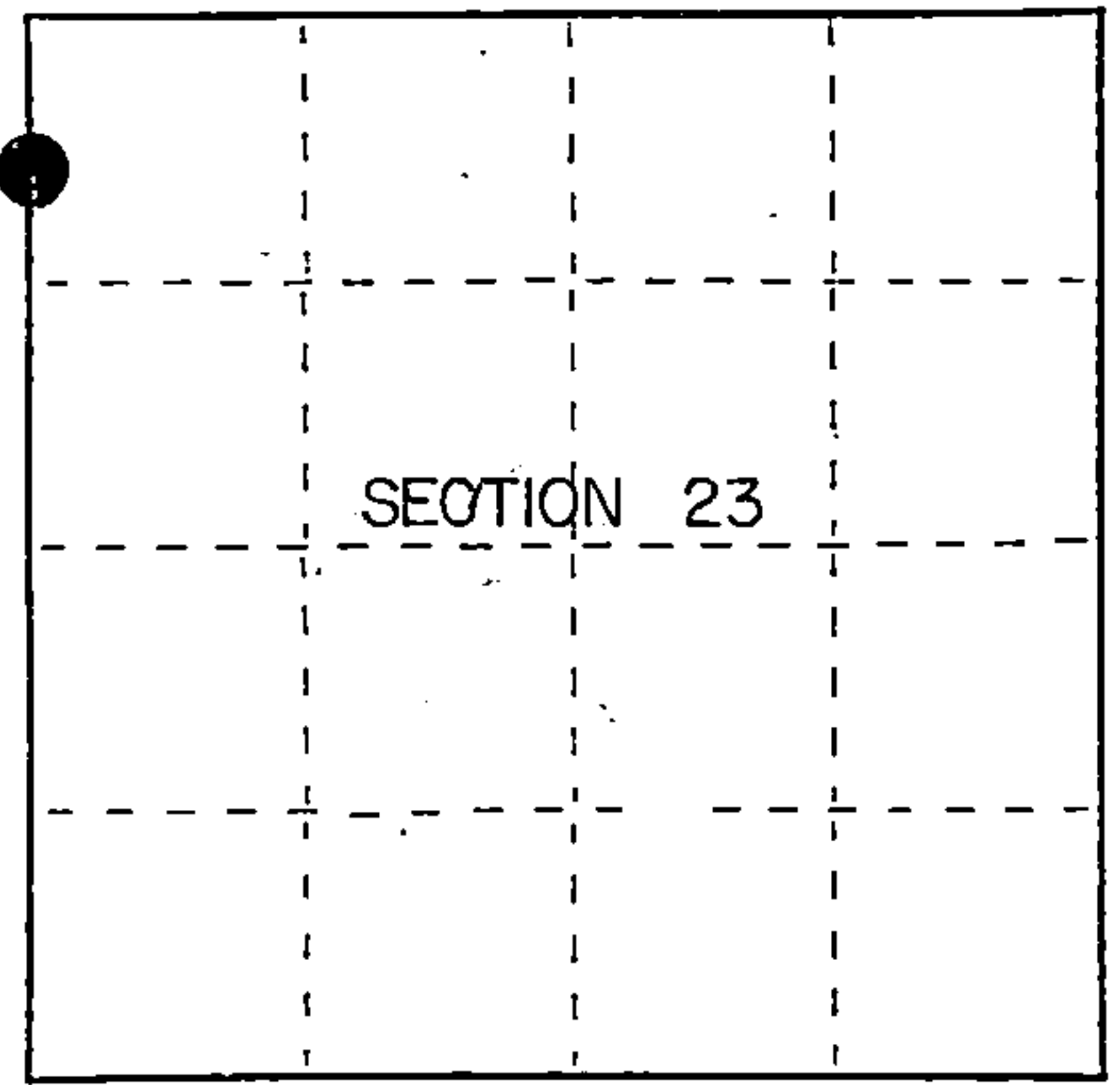

● = Corner monument restored.

History of original corner establishment:
 Original Government Survey in 1865 by William E. Daugherty. North 64.46 chs. set Meander Post to Sections 22 and 23.
 In 1962, Jean Resvick, a Land Surveyor with the Forest Service found a 2"x2"x6" wood post located approximately 21 feet South of the right bank of the Brule River. He also found a rotted stump covered with growth S78°W, 9.00 feet.

Original Bearing Trees:
 Cedar 10" S15°E 33 lks.
 Cedar 10" S78°W 15 lks.

Description of corner evidence found:
 Found the wood post as described above which is now 2"x2"x3" lying on the ground. Found post hole to be best available evidence for restoring the corner position.

Description of monument and accessories I established to perpetuate the original location of this corner.
 In post hole, set a 2½ inch diameter aluminum pipe monument, 3 feet long, 3 inches above the ground, with an aluminum cap stamped; T41N R14E, Meander Corner, S22, S23, 1991, S-1634. From which the following new blazed and scribed bearing trees bear; (measurements taken to a nail in side of tree)

Balsam	3"	N76°W	15.21 feet
Balsam	12"	N01°W	5.62 feet
S. Maple	4"	S43°W	22.62 feet
Steel Sign Post		S52°W	0.62 feet

Monument is located approximately 21 feet from river shoreline.

Dated at Iron River, MI ~~Wis.~~ this 16th day of February, 1992

Signature Gary L. Pisoni Title Land Surveyor Registration No. S-1634
 (County Surveyor, Registered Land Surveyor, or other duly authorized official)

Office of Register of Deeds, County of Forest, I hereby certify that the within instrument was filed in this office for record on the 10th day of March, 1993 at 10:45 o'clock A. M.

Paul Aschenbrenner
 (Register of Deeds)

By.....Deputy

FORM NO. 985-A
 H.C. Miller Company
 Stock No. 26273
 146871

43415223400

(d) Describe any material discrepancy between the location of the corner as restored or reestablished and the location of that corner as previously restored or reestablished by distance and direction. Show the discrepancy on the plan view drawing under (d), above. Show the distances between the corner as previously restored or reestablished and (1) the corner as restored or reestablished, and (2) to at least 2 of the witness monuments shown on the drawing in (d), above.

See drawing below.

(f) Was the corner restored through acceptance of (1) an obliterated evidence location, or, (2) a found perpetuated location?
 Restored through accepted evidence.

(g&h) Was the corner reestablished through lost corner proportionate methods? If so, show the method, including the directions and distances to other public land survey corners used as evidence or used for proportioning in determining the corner location?

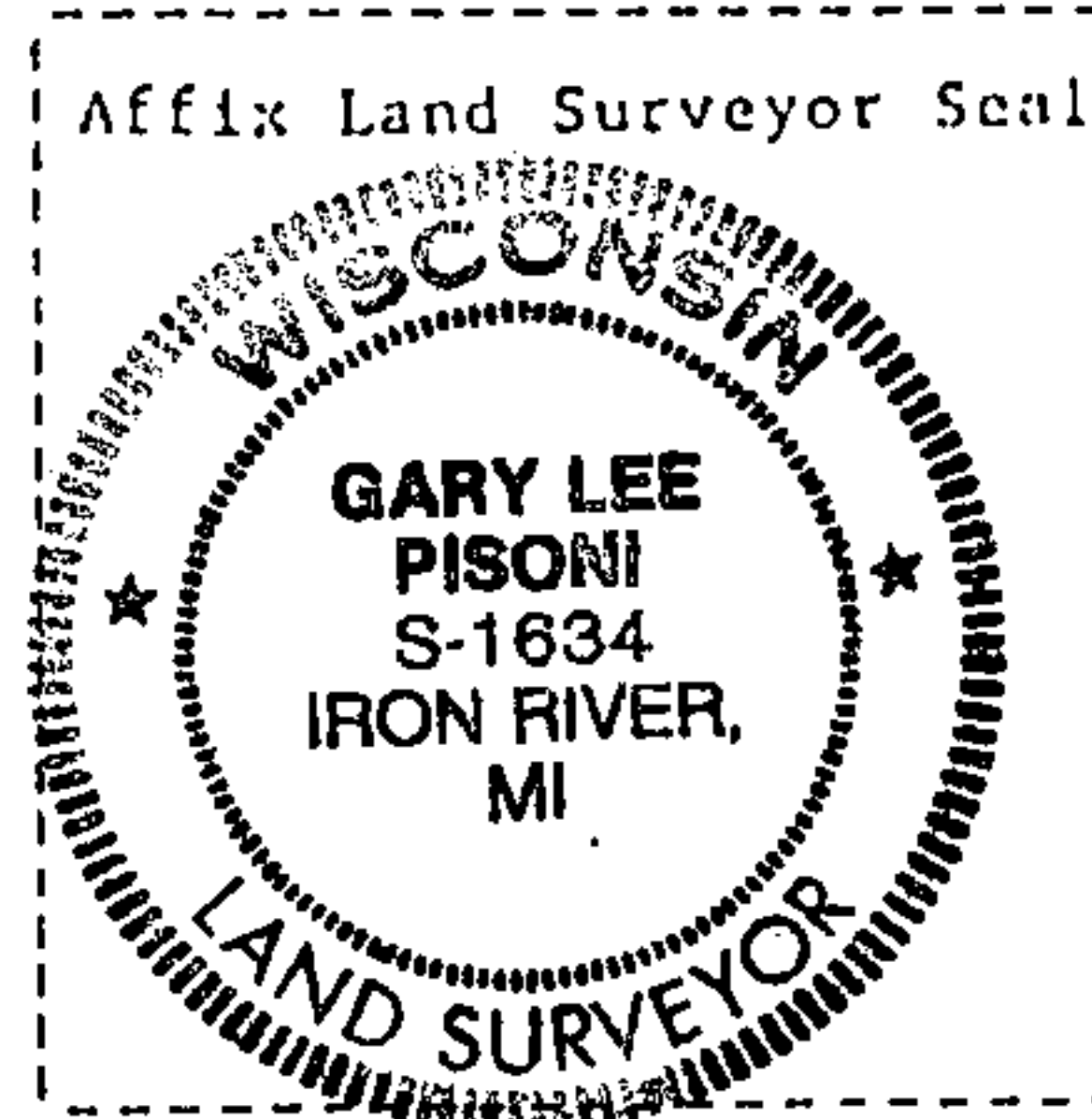
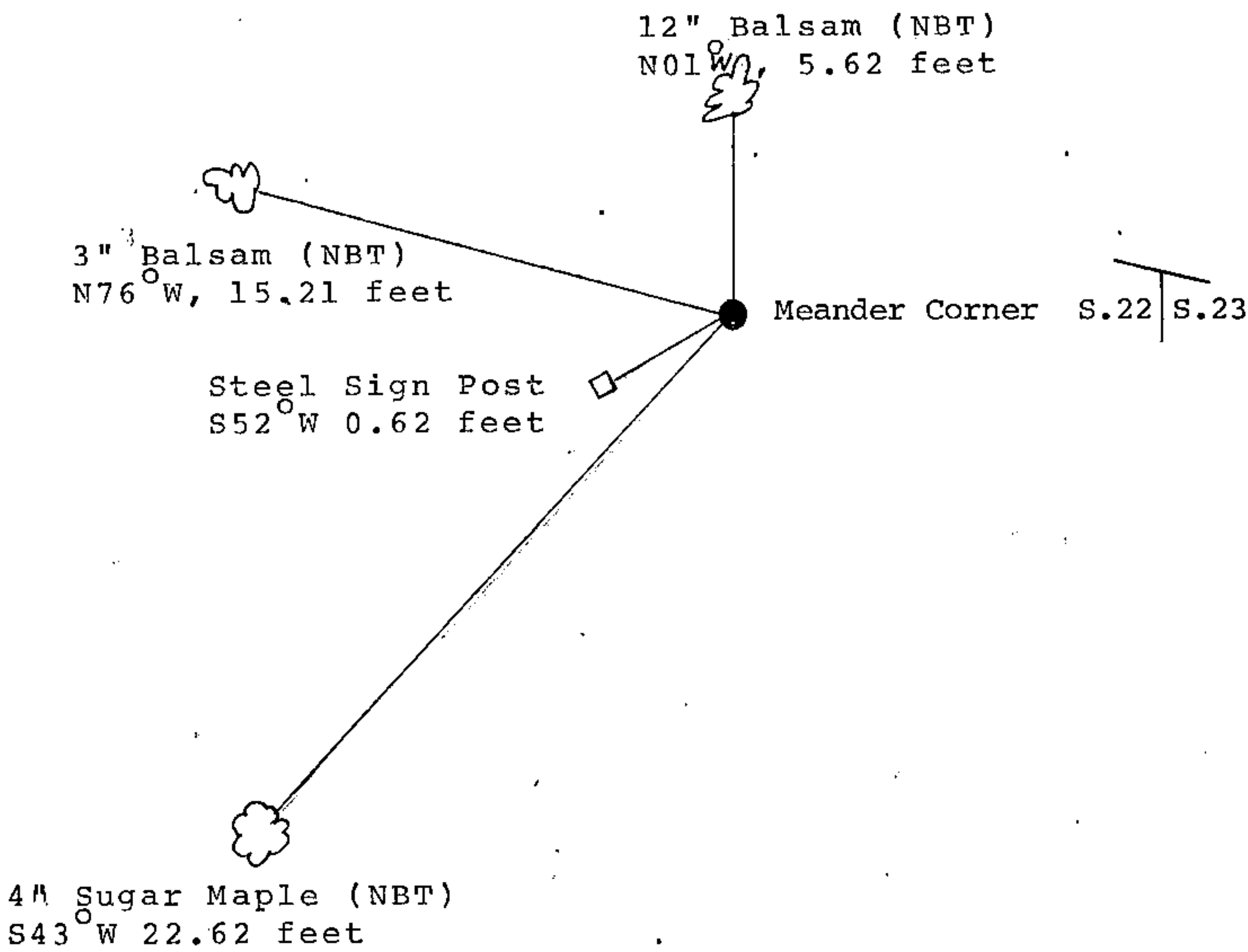

(i) I, Gary L. Pisoni
 (type or print name) certify that the corner location shown on this record was determined by me or under my direction and control and that this U.S. Public Land Survey Monument Record is correct and complete to the best of my knowledge and belief.

Gary L. Pisoni Signature March 13th 1992 Date

Survey requested by: [Signature] District Ranger 10/2/92 Date