

CERTIFIED LAND CORNER RESTORATION

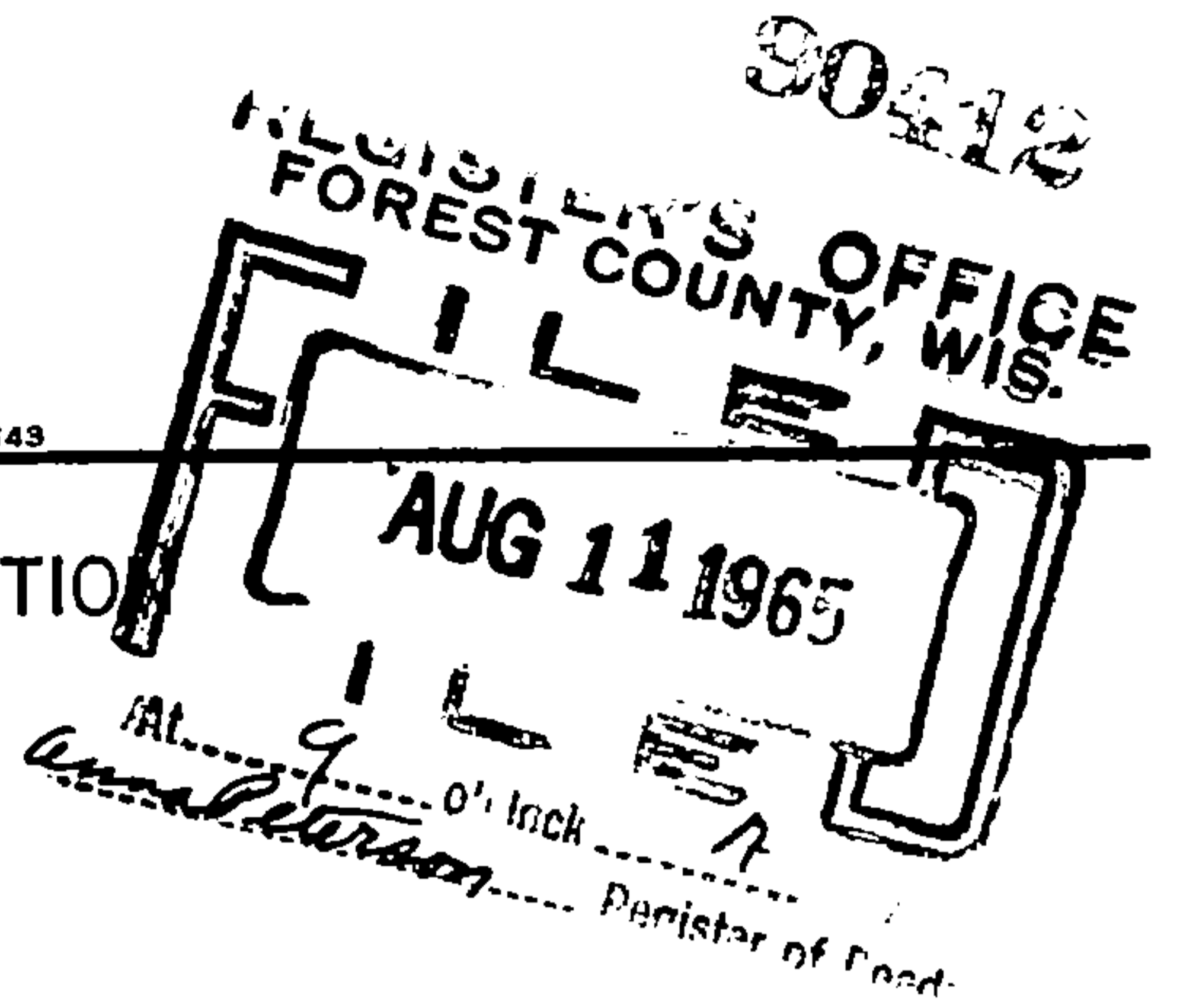

State of Wisconsin }  
County of Forest } ss.

I Jean F. Resvick do hereby certify that on the 24th day of May, 1965, I found evidence of the East Meander corner of Sections 16 and 21 Township T34N, Range 14 East, Fourth Principal Meridian, as described hereon; and that from this evidence I established a new monument and accessories as described hereon to perpetuate the original location of this corner:

Description of original monument and accessories and subsequent restorations:

Surveyed in 1859 by James McBride  
45.00 chains west corrected between Sections 16 & 21.  
Set wood post from which:

- A Hemlock, 15 inches diam., bears south 1°W, 19 lks. dist.
- A Hemlock, 12 inches diam., bears north 7°E, 18 lks. dist.



Description of corner evidence found:

Hemlock, 24 inches diam., fallen, scribed slab readable.  
At S7°W, 11.88 ft. from B.T. stump found hemlock post and point. From point of post S1°W, 12.5 ft. found hemlock stump.

Description of monument and accessories I established to perpetuate the original location of this corner:

Replace hemlock post with 2 in. inside diam., galvanized iron pipe, 5 feet long, filled with concrete, flanged at bottom, 18 in. above ground with brass cap marked:

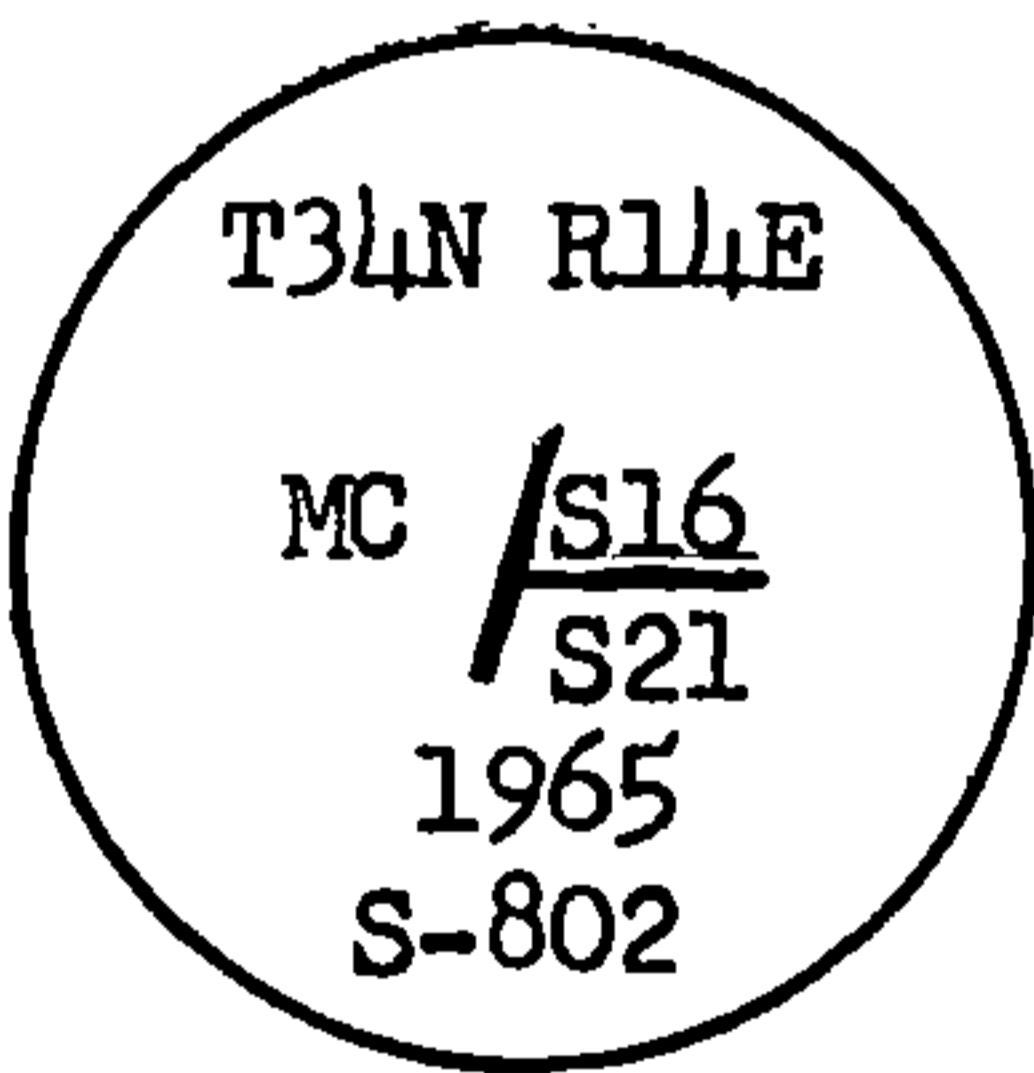

from which the following blazed and scribed new bearing trees bear:  
Yellow birch 9 in., S39°E, 28.52 ft. or 43.2 lks.  
White birch 6 in., S9°30'W, 16.19 ft. or 24.5 lks.  
Cedar, 10 in., N44°W, 15.56 ft. or 23.6 lks.

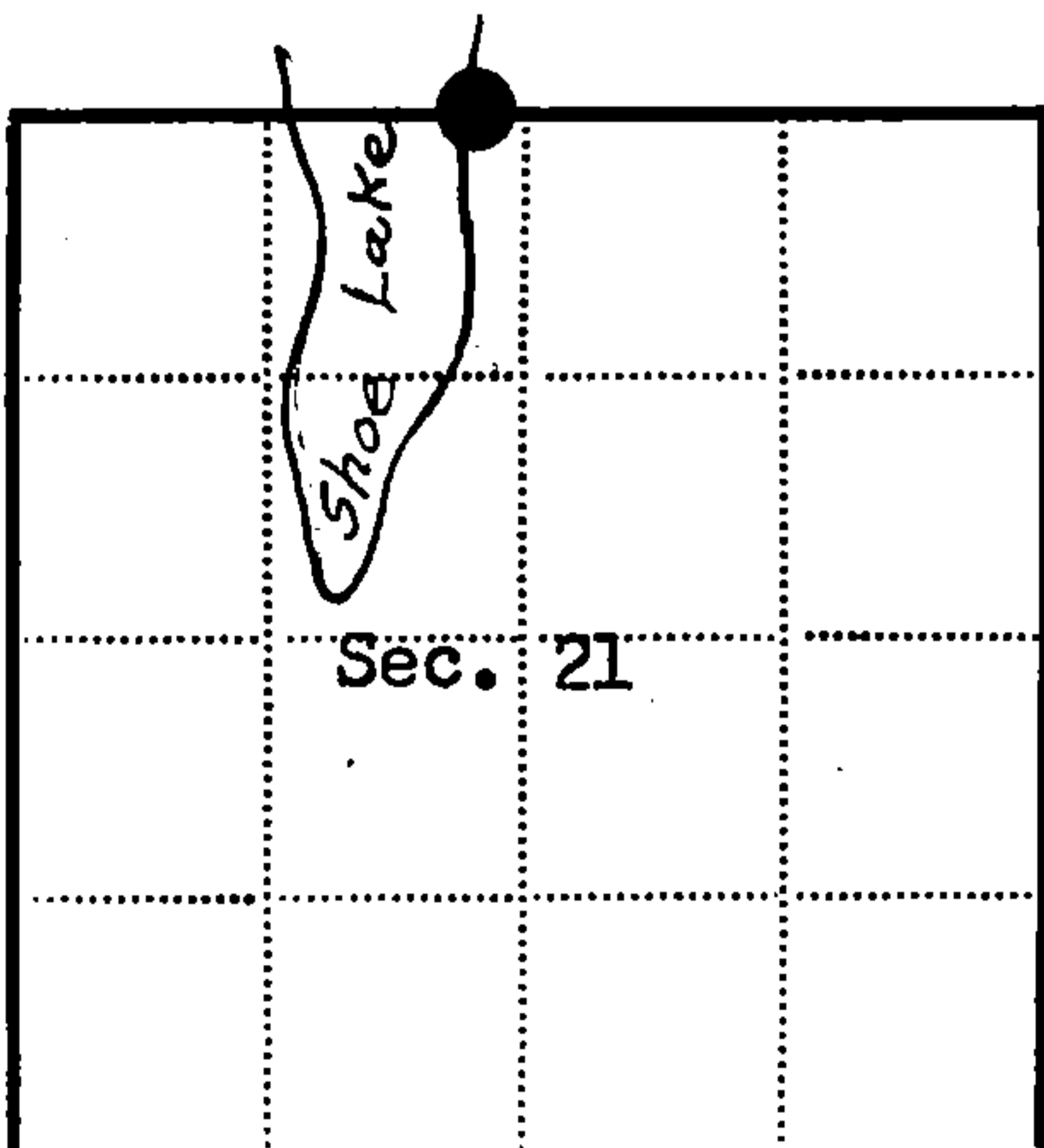

● = Corner monument restored  
□ =

Resident witnesses.....

Dated at Rhinelander Wisconsin, this 14th day of June 1965..

Signature *Jean F. Resvick* Title Cadastral Surveyor  
(County Surveyor, Registered Land Surveyor, or other duly authorized official)

Surveyors Registration No. S-802

Office of.....County of.....  
I hereby certify that the within instrument was filed in this office for record on the.....day of.....19....., and was filed in Book No.....Page No.....of County Records.

Signature.....Title.....

Township 34 North, Range 14 East, Section 21, Index No. L-10, 11, Page No.

4341410022

7-10-65  
N101-11