

CERTIFIED LAND CORNER RESTORATION

Index No. X-12

State of Wisconsin }
County of Forest } ss.

History of original corner establishment:
No evidence of any previous corner.

X 12

I Glen Barker, do hereby
certify that on the 4th day
of May, 19 82, I ~~found~~
~~evidence of~~ the EC 1/16
corner of Section 33
Township 34, North, Range
13 East, Fourth Principal Meridian,
as described hereon; and that from this evidence
I established a new monument and accessories
as described hereon to perpetuate the original
location of this corner.

Description of corner evidence found:

Total distance from 1/4 corner between sections 33 & 34 to C 1/4 section 33 is
2630.09 ft. at bearing S89-55-19W.
Set EC 1/16 1315.04 ft. intermediate.

Resident witnesses:

James Claflin

Herb Wagoner

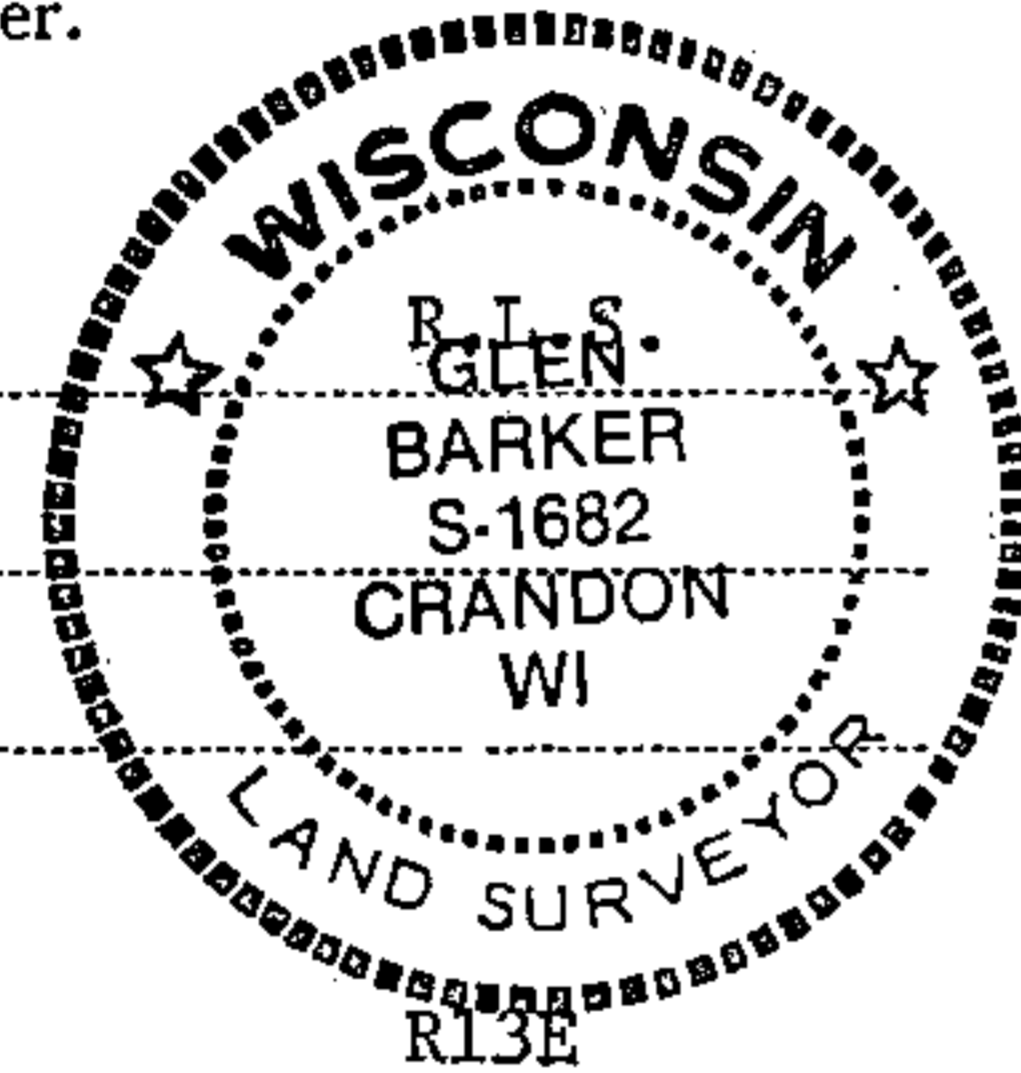

Description of monument and accessories I established to perpetuate the original location of this corner.

Set a 1" iron pipe with 2" diameter alloy cap stamped:
Monument projects 18" above ground

1682
T34N R13E

Marked NBTs

Maple 7" N16W 72.29 ft.
Twin maple 6" S21W 34.85 ft.
Scribed 1/16 - B.T.

EC 1/16 S 33
CPI - 1982

T34N

R13E

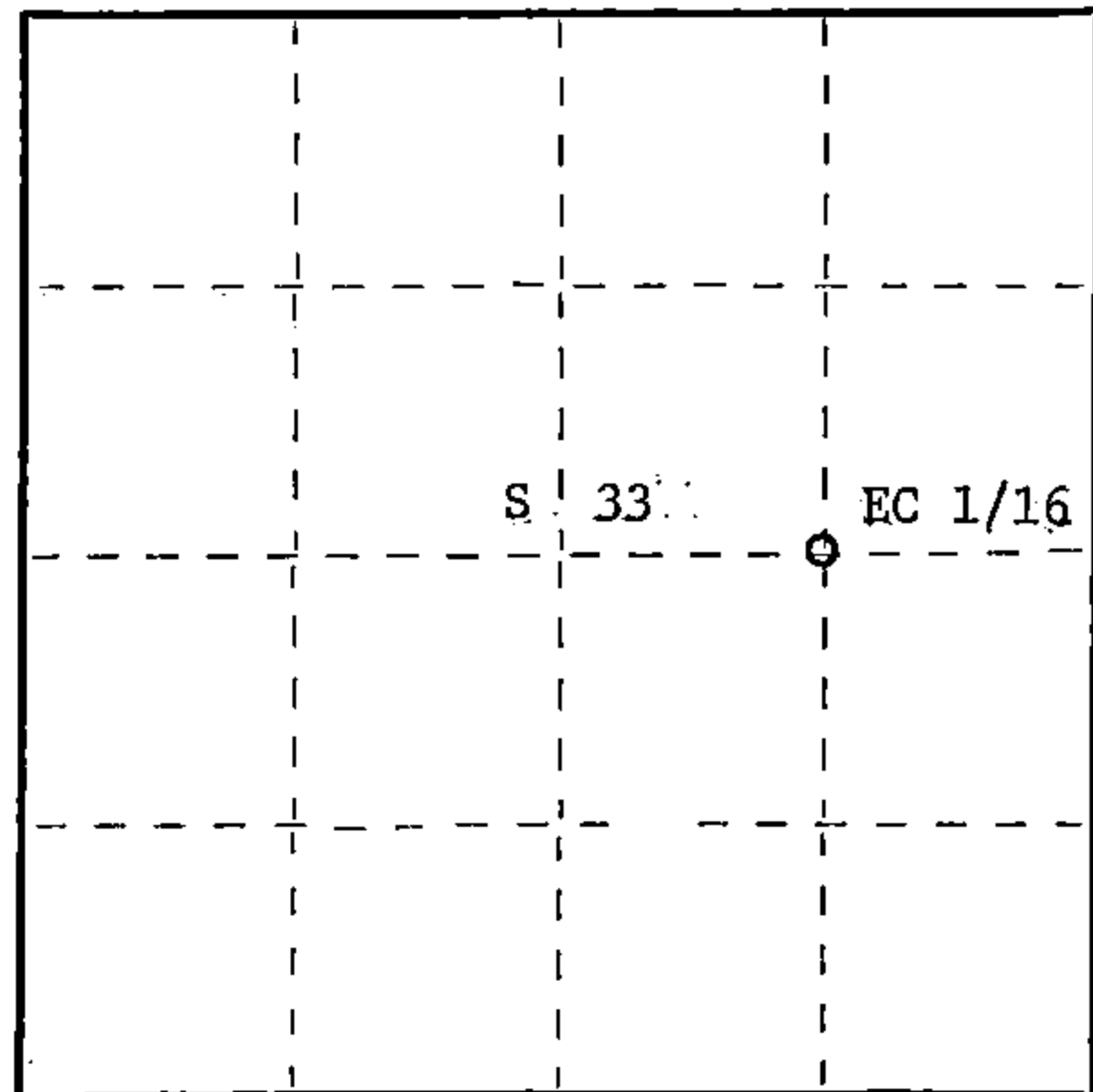

○ = Corner monument restored.

Dated at Rhinelander, Wis., this 18th day of May, 19 82.

Signature Glen Barker Title Registered Land Surveyor Registration No. S-1682
(County Surveyor, Registered Land Surveyor, or other duly authorized official)

Office of Register of Deeds, County of Forest, I hereby certify that the within
instrument was filed in this office for record on the 15th day of June, 19 82
at 10:00 o'clock A. M.

Eugene Statezny

(Register of Deeds)

DOCUMENT NO.
121688

By Sharon Mueller Deputy

FORM 985 H. C. MILLER CO., MILWAUKEE

43413332010