

CERTIFIED LAND CORNER RESTORATION

Index No. Y-11

Y 11

State of Wisconsin }
County of Forest } ss.

History of original corner establishment:
No evidence of any previous corner.

I Glen Barker, do hereby certify that on the 29th day of April, 1982, I found evidence of the SC 1/16 corner of Section 33 Township 34, North, Range 13 East, Fourth Principal Meridian, as described hereon; and that from this evidence I established a new monument and accessories as described hereon to perpetuate the original location of this corner.

Description of corner evidence found:
Total distance from 1/4 corner between sections 4 & 33, T33 & 34N R13E to C/1/4 corner section 33 is 2759.57 ft. at bearing N1-30-33E.
Set SC 1/16 1379.78 ft. intermediate.

Resident witnesses:

James D. Claflin
Herb Wagoner

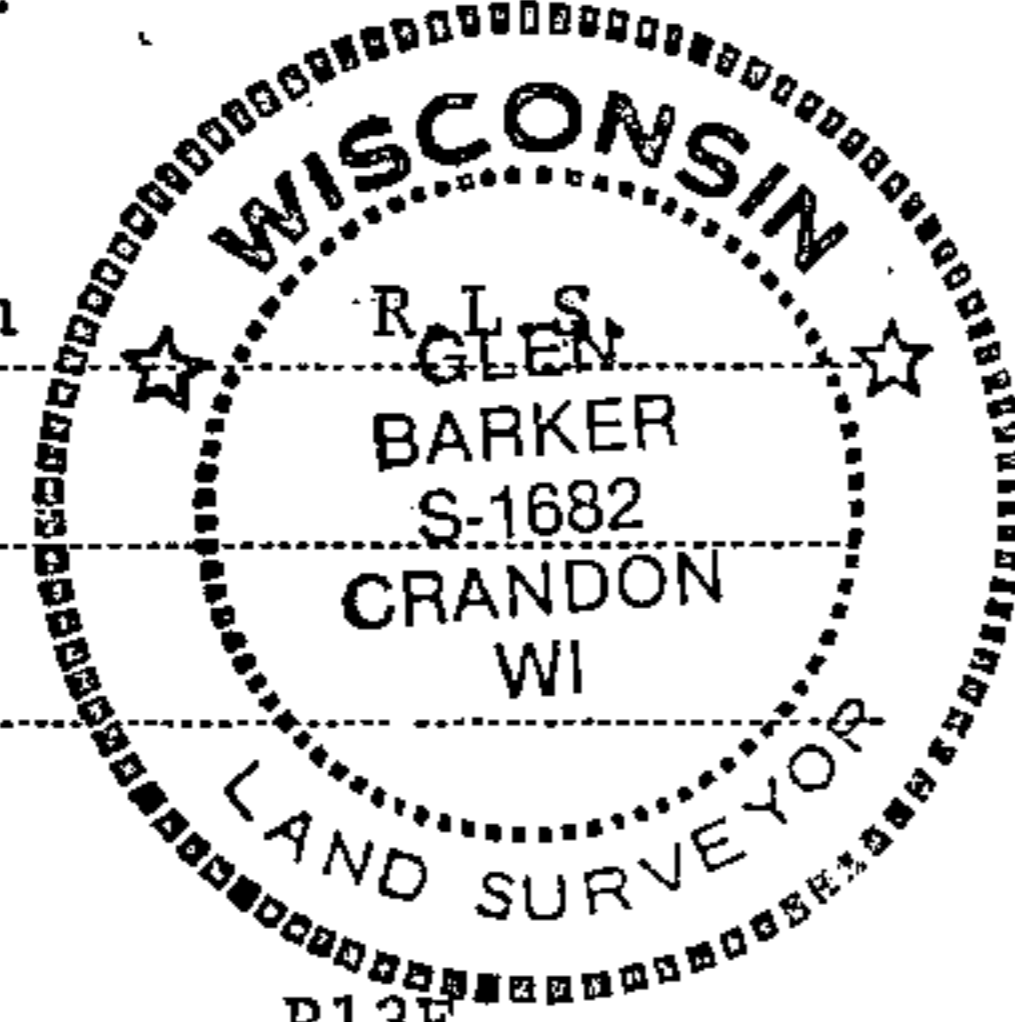

Description of monument and accessories I established to perpetuate the original location of this corner.

Set a 1" iron pipe with 2" diameter alloy cap stamped: S1682
Monument projects 18" above ground T34N R13E
Marked NBTs: SC 1/16 S 33
Sugar 6" S86W 27.35 ft. CPI - 1982
Sugar 5" N14W 21.33 ft.
Scribed 1/16 - B.T.

FORM 985 H. C. MILLER CO., MILWAUKEE

T34N R13E

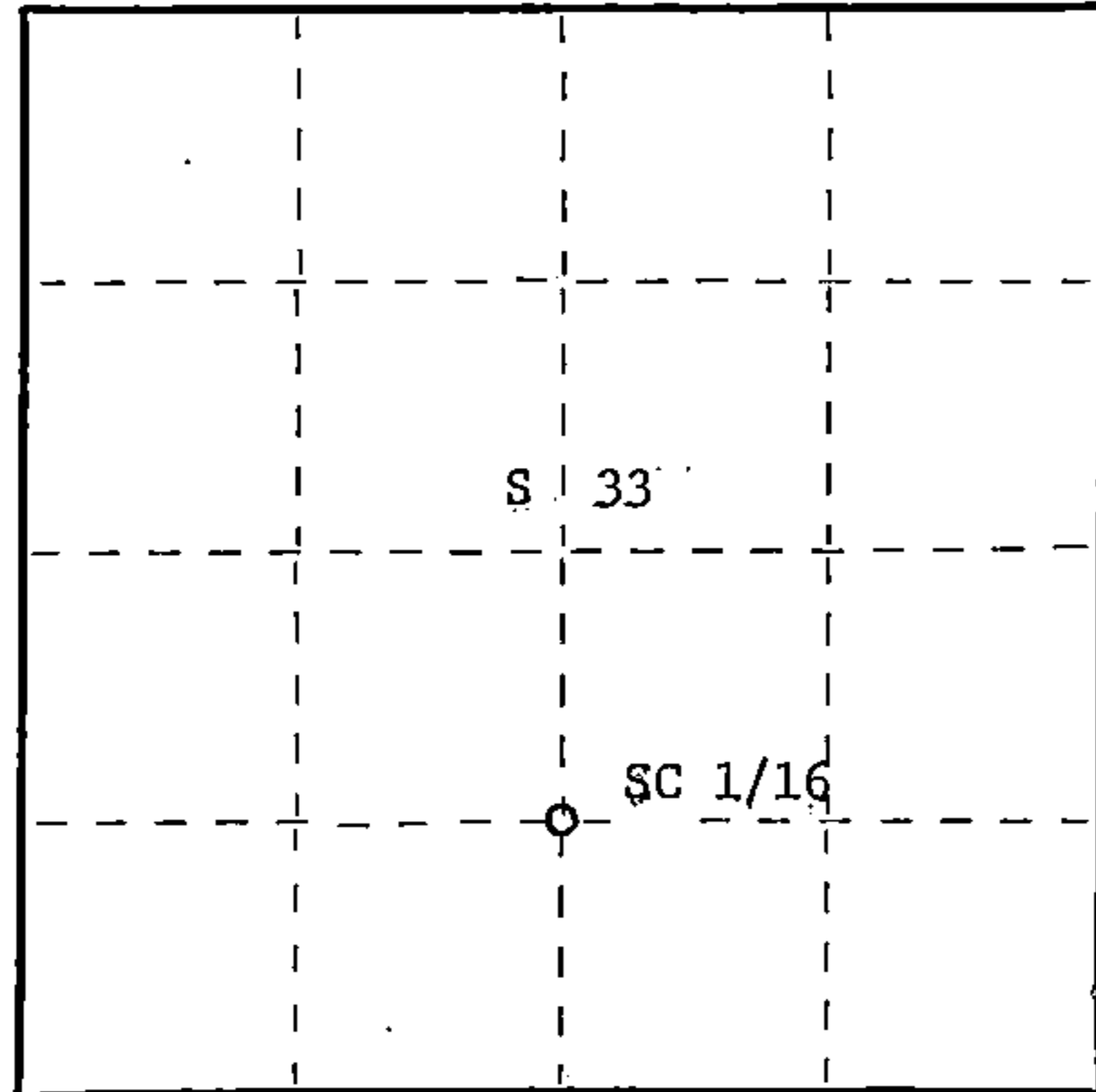

○ = Corner monument restored.

Dated at Rhineland, Wis., this 18th day of May, 1982

Signature Glen Barker Title Registered Land Surveyor Registration No. S-1682
(County Surveyor, Registered Land Surveyor, or other duly authorized official)

Office of Register of Deeds, County of Forest, I hereby certify that the within instrument was filed in this office for record on the 15th day of June, 1982 at 10:00 o'clock A. M.

Eugene Statezny
(Register of Deeds)

By Sharon Mueller Deputy

DOCUMENT NO.
121690

43413331020