

CERTIFIED LAND CORNER RESTORATION

Index No. 7-13

Y13

State of Wisconsin }
County of Forest } ss.

I Glen Barker, do hereby certify that on the 29th day of December, 1982, I found evidence of the S 1/16 corner of Sections 33-34 Township 34, North, Range 13 East, Fourth Principal Meridian, as described hereon; and that from this evidence I established a new monument and accessories as described hereon to perpetuate the original location of this corner.

History of original corner establishment:

Corner previously established by Kimberly Clark Corp.

Description of corner evidence found:

Total distance from section corner 3-4-33-34 T33 & 34N R13E to 1/4 corner between sections 33 & 34 is 2768.59 feet at bearing N 0-40-30 W. Position falls .50 feet of Kimberly Clark monument.

Resident witnesses:

J. Claflin - Reg. Land Surveyor

H. Wagoner

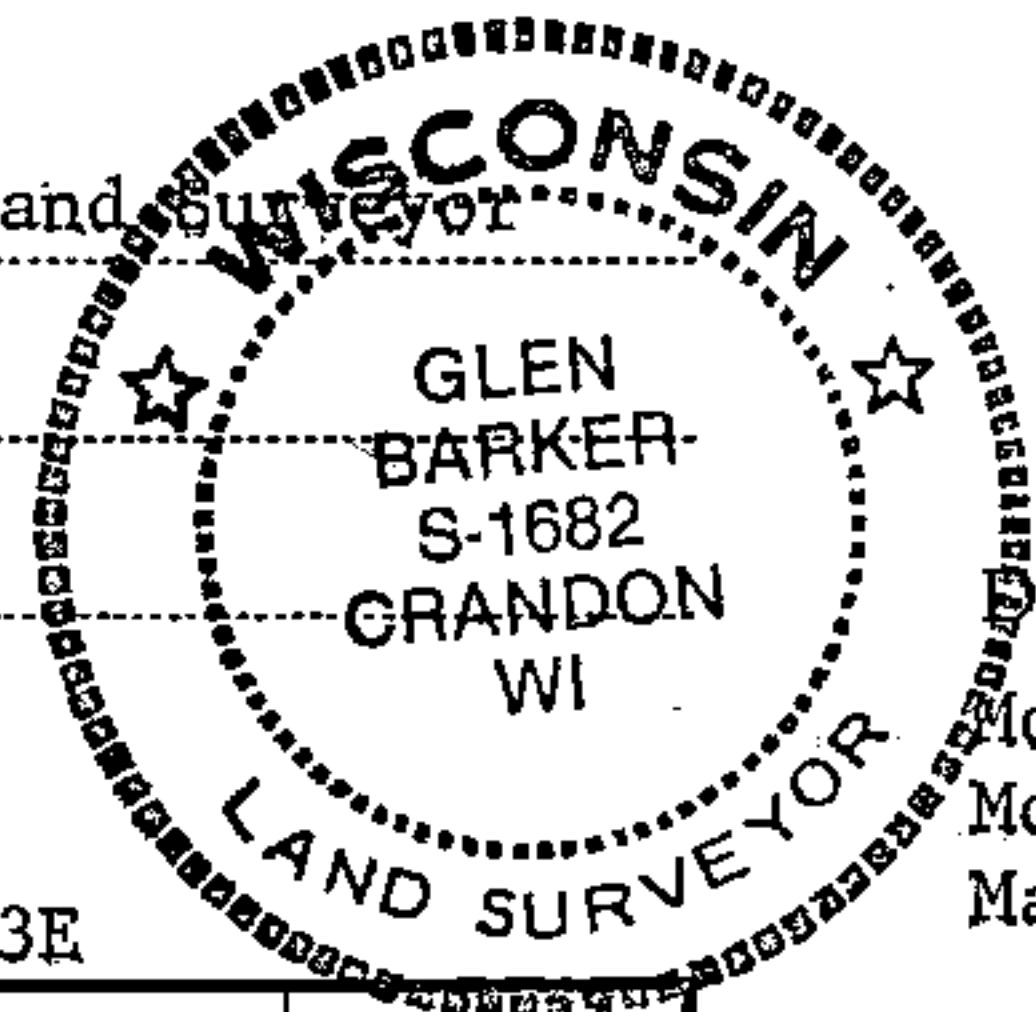

Description of monument and accessories I established to perpetuate the original location of this corner.

Monument is a 1" iron pipe with 4" diameter alloy cap, stamped: Monument projects 12" above ground.

Marked NBT's:

Sugar 5" N82°E 38.25 feet
Sugar 5" S18°E 32.53 feet
scribed 1/16 B.T.

T34N
BTWN
S 1/16 33+34
R13E
SPERHAKE
RLS 463
10-22-63

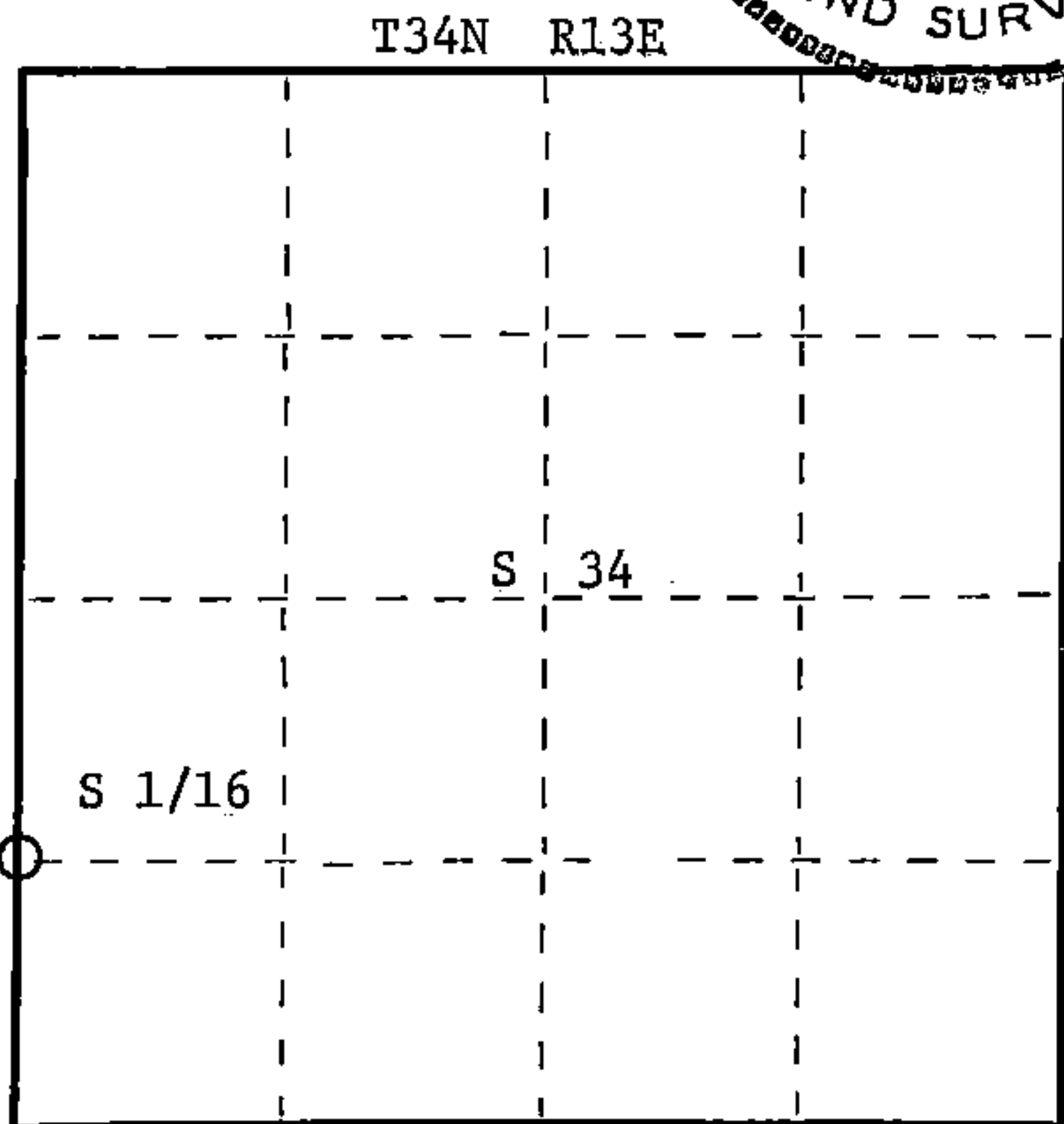

Dated at Rhinelander, Wis., this 21st day of March, 1983

Signature Glen Barker Title Registered Land Surveyor Registration No. S-1682
(County Surveyor, Registered Land Surveyor, or other duly authorized official)

Office of Register of Deeds, County of Forest, I hereby certify that the within instrument was filed in this office for record on the 7th day of April, 1983 at 9:30 o'clock A. M.

Eugene Stegny
(Register of Deeds)

DOCUMENT NO. 123152

By.....Deputy

○ = Corner monument restored.

Stock No. 26272

FORM 985

HC Miller Company

43413331000

State of Wisconsin
County of FOREST

ss. ESTABLISHMENT OF QUARTER - QUARTER SECTION CORNER BETWEEN ORIGINAL GOVERNMENT SURVEY CORNERS.

I NEAL SPERHAKE, do hereby certify that on the TWENTY-SECOND day of OCTOBER, 19 63, I established the SOUTH ONE SIXTEENTH CORNER BETWEEN SECTIONS 33 AND 34, TOWNSHIP 34 NORTH, RANGE 13 EAST, Fourth Principal Meridian, as described hereon.

History: There is no record of this corner having ever been previously established.

Description of monument and accessories I established to perpetuate the location of this corner:

At the point determined for the location of the corner I emplaced a:

GALVANIZED IRON PIPE, THREE FEET LONG, ONE INCH IN DIAMETER, WITH ALUMINUM CAP DENOTED AS, "KIMBERLY CLARK CORP. T34N S 1/16 BTWN. 33 & 34 R13E SPERHAKE RLS 463 10/22/63."

The pipe is witnessed by:

- Aspen 6 S 36°E 26 links. (SCRIBED S34 BT).
- Aspen 8 N 78°W 49½ links. (SCRIBED S33 BT).

Description as to how corner was located: The section corner ¼ mile south and the quarter corner ¼ mile north have been previously established with a distance of 42.00 chains between them. Thus, set the S 1/16 corner 21.00 chains from either corner and on a straight line between them.

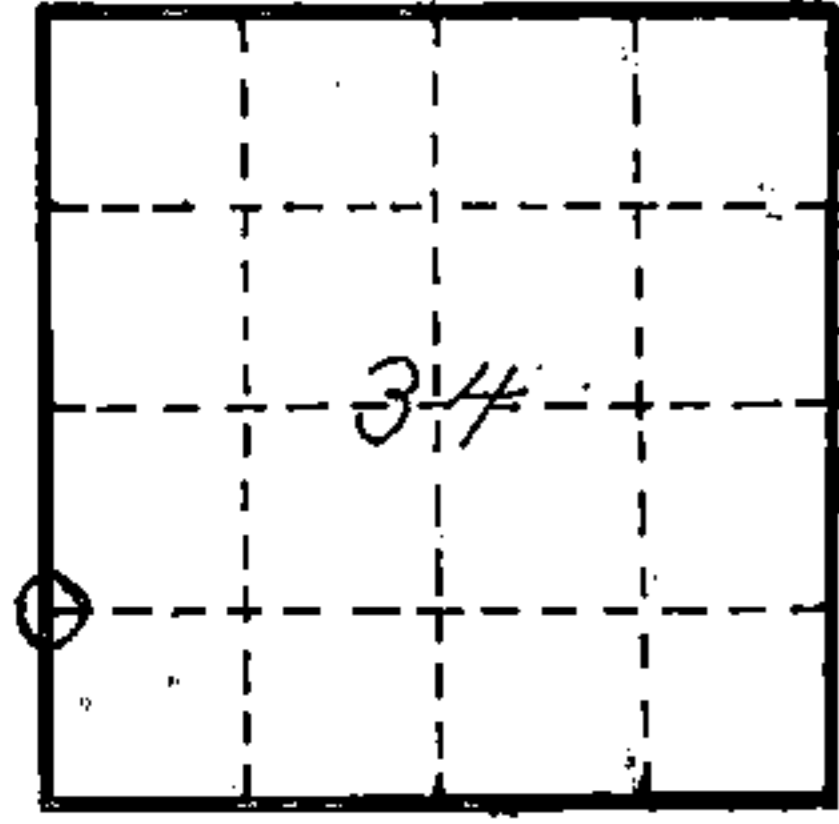

○ = Corner monument restored

Subscribed & sworn to before me this 25 day Aug. 1964

Anna Peterson
NOTARY PUBLIC, FOREST CO., WIS
COM. EXPIRES 10/31/65

SS011

Resident witnesses _____

Dated at Crandon, Wisconsin, this 25 day of Aug, 19 64.

Signature *Neal Sperhake*

Title Registered Land Surveyor Registration No. 463

Office of Reg. of Deeds County of Forest

I hereby certify that the within instrument was filed in this office for record on the 25 day of Aug 19 64, and was filed in Book No. _____ Page No. _____ of County Records.

Surveyor's Seal

Signature *Anna Peterson* Title Reg. of Deeds

4 3413 33 1000

Index No. 413