

CERTIFIED LAND CORNER RESTORATION

Index No. J-24
J 24

State of Wisconsin }
County of Forest } ss.

History of original corner establishment:

No evidence of any previous corner.

I Glen Barker, do hereby certify that on the 15th day of September, 19 82, I ~~found~~ found evidence of the E 1/16 corner of Sections 12, 13 Township 34, North, Range 13 East, Fourth Principal Meridian, as described hereon; and that from this evidence I established a new monument and accessories as described hereon to perpetuate the original location of this corner.

Description of corner evidence found:

Total distance from section corner 12-13-7 & 18, T34N R13, 14E to 1/4 corner between Sections 12 & 13 is 2552.29 ft. at bearing S89-58-34W. Set E 1/16 1276.14 ft. intermediate.

Resident witnesses:

Jim Claflin - RLS

H. Wagoner

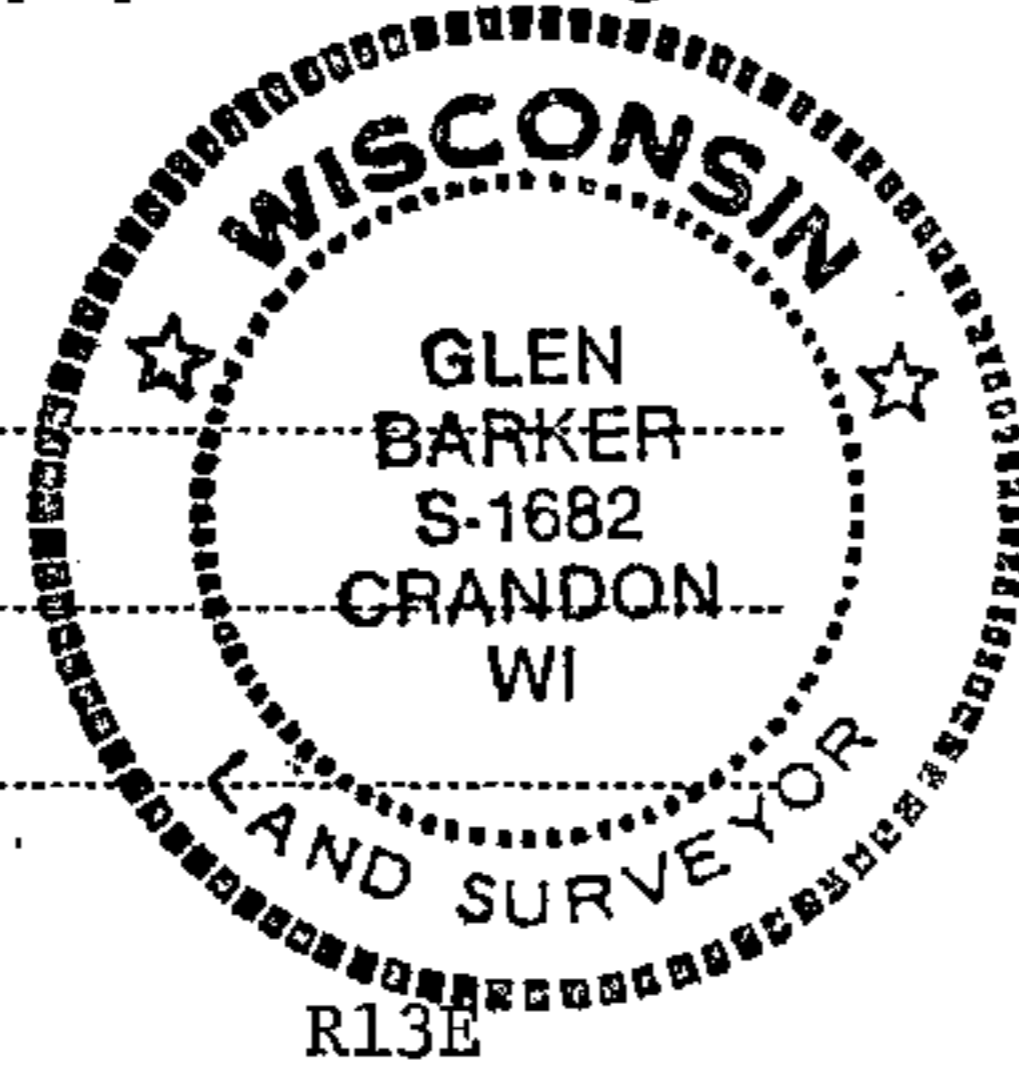

Description of monument and accessories I established to perpetuate the original location of this corner.

Set a 1" iron pipe with 2" alloy cap stamped:

S1682

Monument projects 18" above ground.

T34N R13E

Marked NBTs:

Black spruce 5" N64W 8.32 ft.

E 1/16 S 12

White spruce 5" S61E 21.23 ft.

S 13

Scribed 1/16 - BT

CPI - 1982

FORM 985 H. C. MILLER CO., MILWAUKEE

T34N

R13E

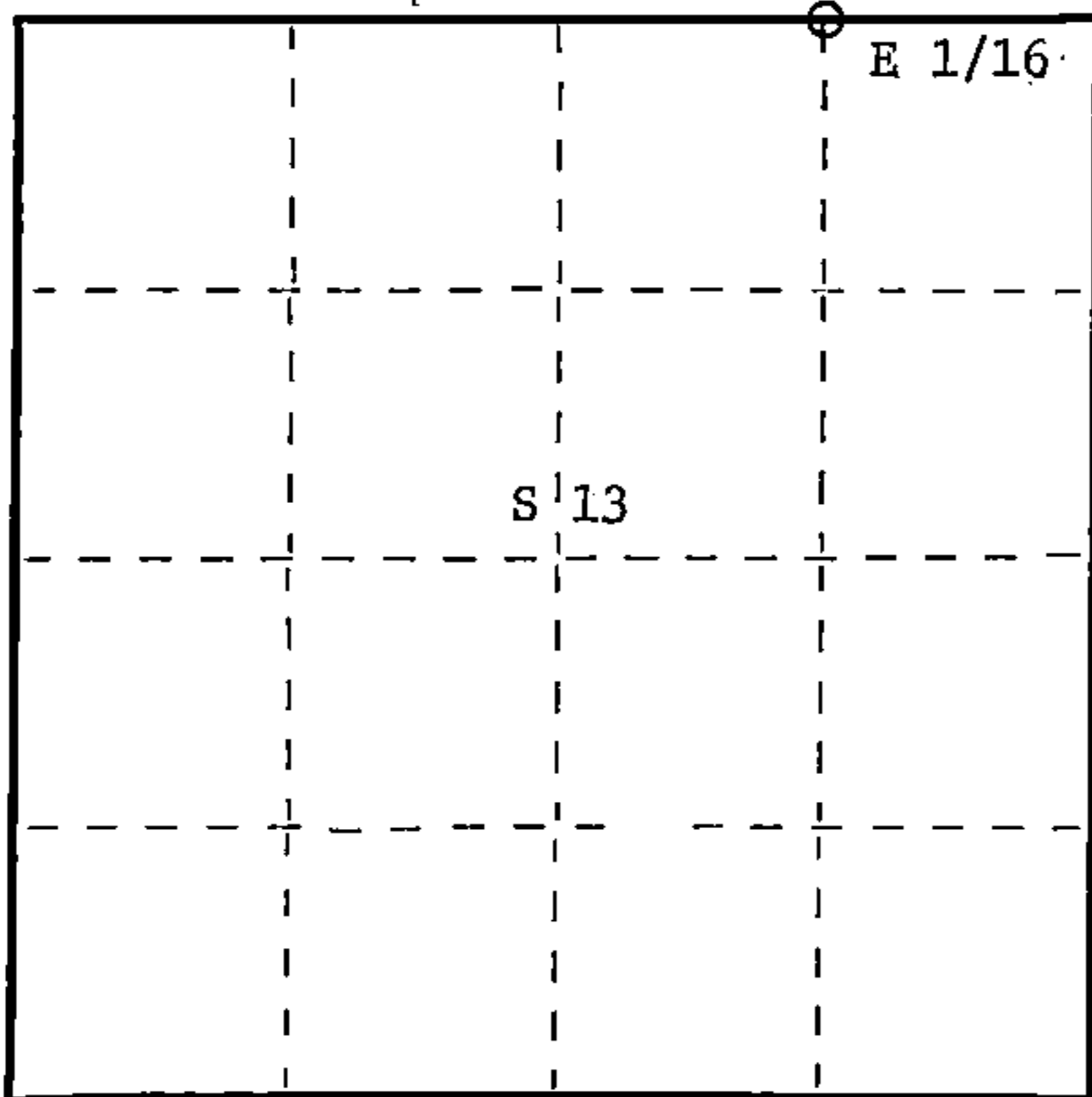

○ = Corner monument restored.

Dated at Rhineland, Wis., this 30th day of December, 19 82

Signature Glen Barker Title Registered Land Surveyor Registration No. S1682

(County Surveyor, Registered Land Surveyor, or other duly authorized official)

Office of Register of Deeds, County of Forest I hereby certify that the within instrument was filed in this office for record on the 16th day of February, 19 83 at 10:30 o'clock A. M.

Eugene Statelyny
(Register of Deeds)

By _____ Deputy

DOCUMENT NO. **122899**

43413120014