

CERTIFIED LAND CORNER RESTORATION

Index No. J-9-1/4
9 9/4

State of Wisconsin }
County of Forest } ss.

History of original corner establishment:

No evidence of any previous corner

I Glen Barker, do hereby
certify that on the 21st day
of September, 1983, I found
evidence of the West M.C.
corner of Sections 9 & 16 - St. John's Lake
Township 34, North, Range
13 East, Fourth Principal Meridian,
as described hereon; and that from this evidence
I established a new monument and accessories
as described hereon to perpetuate the original
location of this corner.

Description of corner evidence found:

Set meander corner on west shore of St. Johns Lake 22.0 ft. of waters edge. On a straight line between Section corner 8-9-16-17 and 1/4 corner between Section 9 & 16. Corner sets 224.02 ft. of section corner and 2351.46 ft. of 1/4 corner.

Resident witnesses:

J. Claflin - RL

H. Wagoner

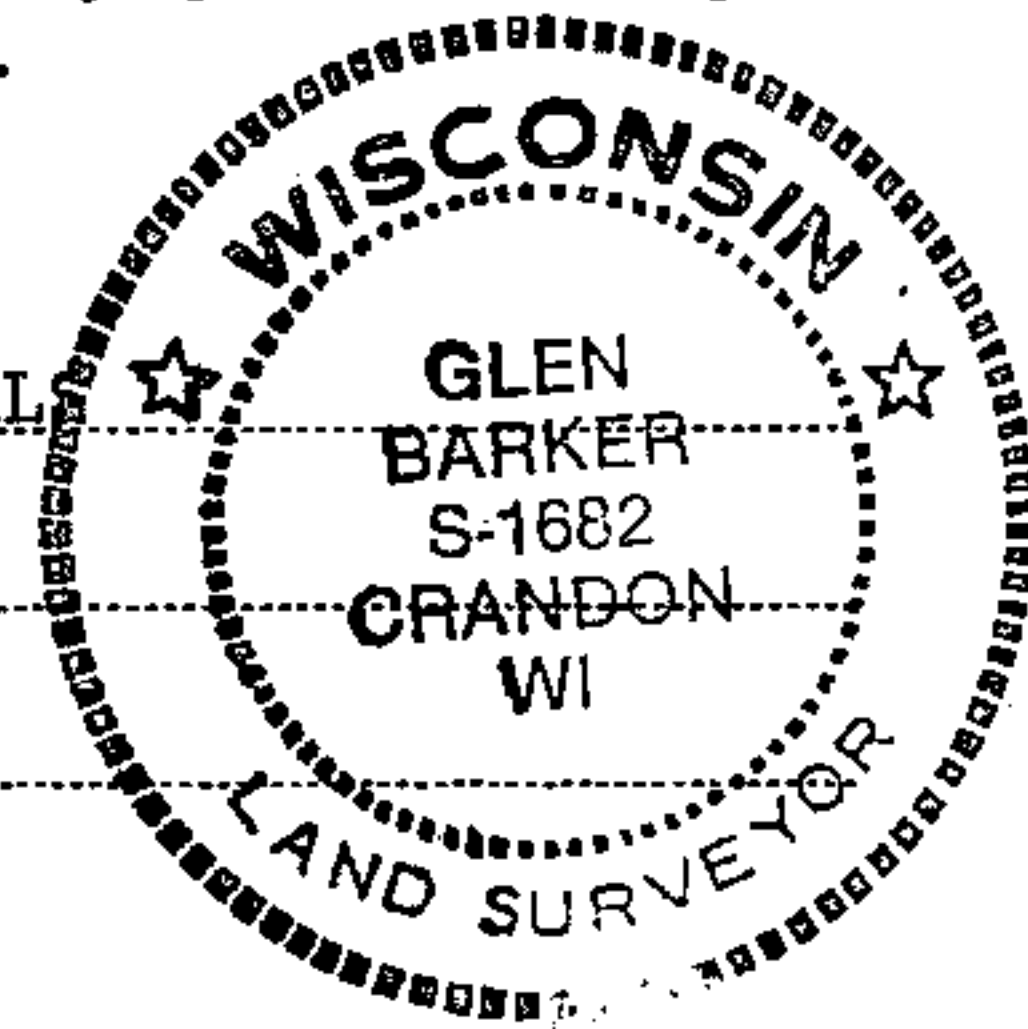

Description of monument and accessories I established to perpetuate the original location of this corner.

Set a 1" x 48" iron pipe for M.C.

Marked NBTs

Tamarack 6" S65W 5.48 ft.

Tamarack 4" S62E 12.67 ft.

Scribed M.C. - B.T.

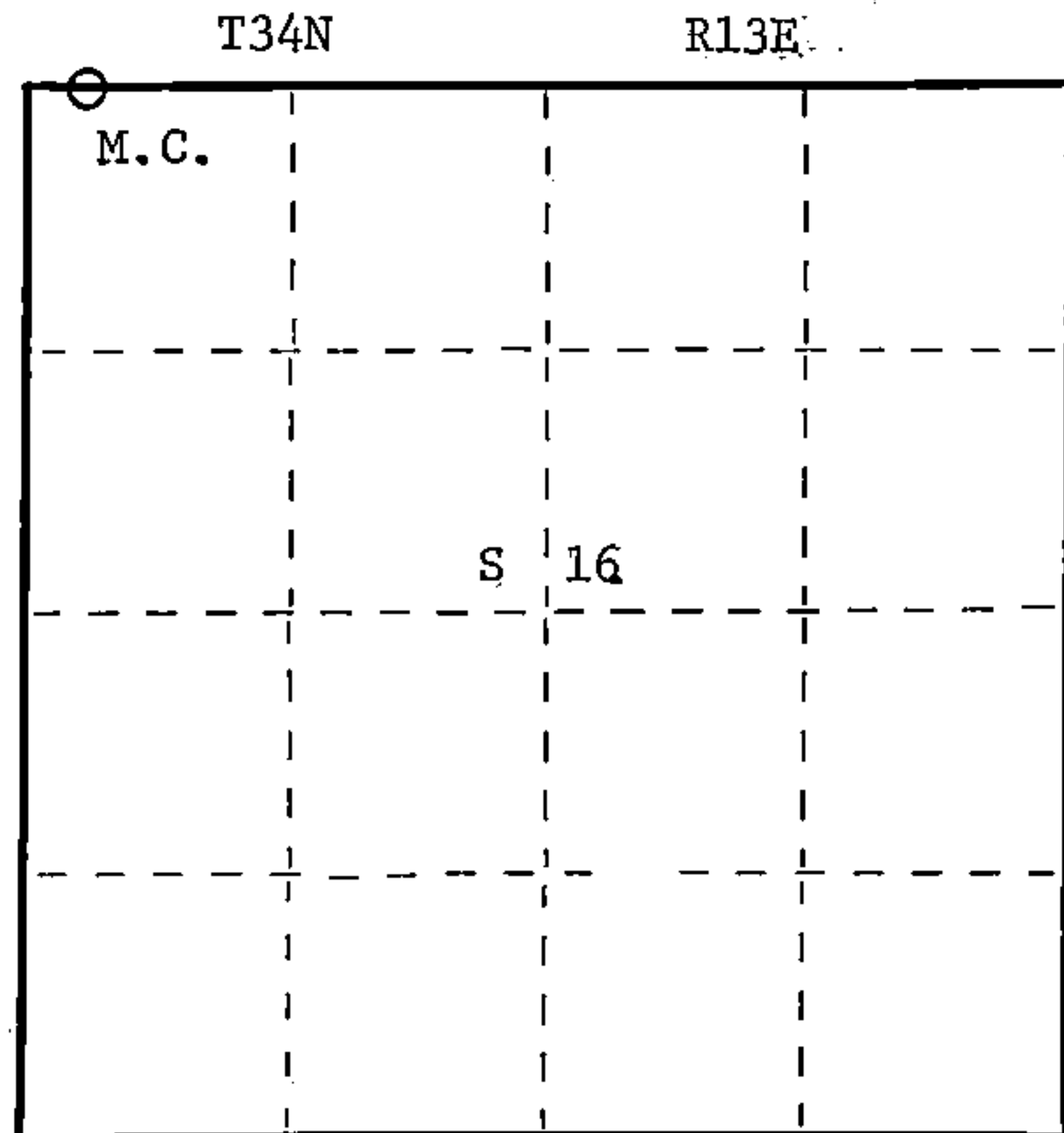

○ = Corner monument restored.

Dated at Rhinelander, Wis., this 23rd day of November, 1983.

Signature Glen Barker Title Registered Land Surveyor Registration No. S1682
(County Surveyor, Registered Land Surveyor, or other duly authorized official)

Office of Register of Deeds, County of Forest, I hereby certify that the within
instrument was filed in this office for record on the 13th day of December, 1983
at 10:30 o'clock A. M.

Eugene Stutzman
(Register of Deeds)
By _____ Deputy

DOCUMENT NO. **124851**

Stock No. 26272
FORM 985
H.C. Miller Company
MILWAUKEE, WISCONSIN

43413090050