

N 1/4 Cor.  
Sec. 35

S 87°32'32" E

1211.90'

Pine River  
E 1/16 Cor.

(Rec. as S 87°31'56" E)

Section Line

S 87°32'32" E

S.26  
S.35

FOREST CO SURVEYOR  
FILE # 401335-19971208  
DATE \_\_\_\_\_ BY \_\_\_\_\_

### MAP OF SURVEY

Being the East & South line of the NW1/4 - NE1/4  
of Section 35, T40N R13E, Township of Alvin  
Forest County, Wisconsin

N 01°28'33" E

1322.58'

NW 1/4 - NE 1/4

51.00'

69.04'

1308.82'

1239.78'

S 00°19'14" W



Scale 1" = 300'

1295.60'

S 00°51'19" E

2591.22'

Section Line

N 00°51'08" W

1295.62'

S 00°50'56" E

N 1/16 Cor.

E 1/4 Cor.

CN 1/16 Cor.

N 88°12'44" W

944.92'

293.21'

NE 1/16 Cor.

N 01°54'58" W

21.47'

N 21°03'05" W

164.68'

Centerline of 16' Wide  
Existing Access Road

P.O.B.  
1422.82' South  
& 1451.31' West  
of the NE Cor.  
Section 35

R.O.W.

HOLFORD ROAD  
(Town Road)

HWY. 55

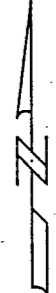

Bearings are referenced to the East line  
of Section 35 from the U.S. Forest Service  
Plat of Survey which bears N 00°51'08" W

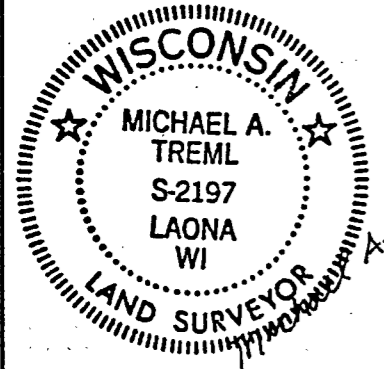

SW 1/4 - NE 1/4  
*A. Treml*

DRAWN BY: MICHAEL A. TREML R.L.S.	MICHAEL A. TREML R.L.S. RT. 1, BOX 71 LAONA, WI 54541 (715) 674-2923	PROJECT LEGEND: ● 1" X 30" Iron Pipe Set this Survey ⊙ 2 1/2" Aluminum Pipe Monument (U.S.F.S.) Found ○ 1" Aluminum Pipe Monument (U.S.F.S.) Found ▲ Mathematically Computed Position	SHT. NO.  1 of 2
DATE: December 8, 1997			
DWG. NO.: D011/97			