

MAP OF SURVEY

FOR: LYNN KRAMER

SECTION 16, T35N, R12E,
TOWN OF NASHVILLE, FOREST CO., WI

LEGEND:

- 1" x 30" IRON PIPE, SET, MIN. WT. 1.13" / L.F.
- 4" x 4" WOOD POST, SET
- 4" x 4" WOOD POST, FOUND IN PLACE
- 1 1/4" IRON PIPE, FOUND IN PLACE
- R.R. SPIKE, FOUND IN PLACE
- ▲ NAIL, SET FROM EXISTING BT'S
- ⊙ 3" ALUMINUM MONUMENT, FOUND IN PLACE

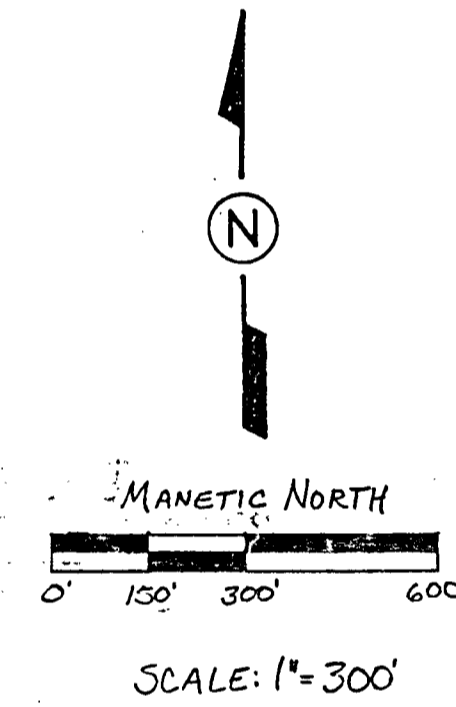

FOREST CO SURVEYOR
FILE # 351216-19891229
DATE _____ BY _____

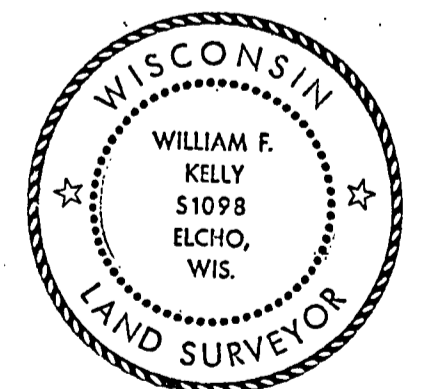

William F. Kelly
12-29-89

BUILDERS SERVICE ENGINEERING DIVISION	
SURVEY MAP	
FOR: LYNN KRAMER	
SECTION 16, T35N, R12E	
DRAWN BY: LISA REYNOLDS	
SCALE 1"=300'	DATE DEC. 29, 1989
SHEET 1 OF 1	DWG. NO: 2295

Easement Description to Parcel E:

Commencing at the N. 1/8 corner on the 1/4 line of Sect. 16, T35N, R12E, thence N89°27'41"E, 19.49 feet to the point of beginning;

Thence S01°17'41"W, 53.54 feet; thence S10°45'21"W, 398.33 feet; thence S20°36'36"W, 375.84 feet; thence S00°56'01"W, 151.60 feet; thence S17°42'41"W, 301.54 feet; thence S70°07'36"W, 105.97 feet; thence S07°54'26"W, 280.45 feet; thence S39°18'56"W, 276.95 feet; thence S11°07'21"W, 125.37 feet; thence S69°09'51"W, 232.98 feet; thence S73°00'26"W, 200.31 feet; thence S51°17'35"W, 378.33 feet to the E. line of Parcel E.

Easement Description to Parcel F:

Commencing at the N. 1/8 corner on the 1/4 line of Sect. 16, T35N, R12E, thence N89°27'41"E, 19.49 feet to the point of beginning;

Thence S01°17'41"W, 53.54 feet; thence S10°45'21"W, 398.33 feet; thence S20°36'36"W, 375.84 feet; thence S00°56'11"W, 151.60 feet; thence S17°42'41"W, 301.54 feet; thence S70°07'36"W, 105.97 feet; thence S07°54'26"W, 35.63 feet to the N. line of Parcel F.

Easement Description of Parcel G:

Commencing at the N. 1/8 corner on the 1/4 line of Sect. 16, T35N, R12E, thence N89°27'41"E, 19.49 feet to the point of beginning;

Thence S01°17'41"W, 53.54 feet; thence S10°45'21"W, 398.33 feet; thence S20°36'36"W, 375.84 feet; thence S00°56'11"W, 151.60 feet; thence S17°42'41"W, 301.54 feet; thence S70°07'36"W, 105.97 feet; thence S07°54'26"W, 280.45 feet; thence S39°18'56"W, 276.95 feet; thence S11°07'21"W, 125.37 feet; thence S69°09'51"W, 232.98 feet; thence S26°30'18"W, 319.35 feet; thence S11°20'30"W, 192.83 feet; thence S10°21'58"E, 204.18 feet; thence S14°05'40"W, 257.38 feet; thence S11°06'25"E, 230.56 feet; thence S73°32'07"E, 181.41 feet; thence S61°36'47"E, 132.59 feet; thence N76°35'10"E, 146.74 feet; thence N49°31'44"E, 237.22 feet; thence N70°31'28"E, 276.75 feet; thence N80°13'36"E, 98.97 feet to the W. line of Parcel G.

Easement Description to Parcel H:

Commencing at the N. 1/8 corner on the 1/4 line of Sect. 16, T35N, R12E; thence N89°27'41"E, 19.49 feet to the point of beginning;

Thence S01°17'41"W, 53.54 feet; thence S10°45'21"W, 398.33 feet; thence S20°36'36"W, 375.84 feet; thence S00°56'11"W, 151.60 feet; thence S17°42'41"W, 301.54 feet; thence S70°07'36"W, 105.97 feet; thence S07°54'26"W, 280.45 feet; thence S39°18'56"W, 276.95 feet; thence S11°07'21"W, 125.37 feet; thence S69°09'51"W, 232.98 feet; thence S26°30'18"W, 319.35 feet; thence S11°20'30"W, 192.83 feet; thence S10°21'58"E, 204.18 feet; thence S14°05'40"W, 257.38 feet; thence S11°06'25"E, 230.56 feet; thence S73°32'07"E, 181.41 feet; thence S61°36'47"E, 132.59 feet; thence N76°35'10"E, 146.74 feet; thence N49°31'44"E, 237.22 feet; thence N70°31'28"E, 276.75 feet; thence N80°13'36"E, 645.45 feet; thence S89°45'55"E, 392.55 feet; thence S32°21'27"E, 232.99 feet; thence S02°49'20"W, 137.15 feet; thence S34°03'44"E, 129.49 feet; thence S69°02'31"E, 82.77 feet; thence N83°26'02"E, 94.45 feet to the W. line of Parcel H.

Easement Description to Southeasterly corner of Sect. 16, T35N, R12E:

Commencing at the N. 1/8 corner on the 1/4 line of Sect. 16, T35N, R12E; thence N89°27'41"E, 19.49 feet to the point of beginning;

Thence southerly and easterly along the easement to the W. line of Parcel H; thence continuing N83°26'02"E, 197.96 feet; thence S68°42'03"E, 238.41 feet to a fork in the road; thence S19°37'04"W, 80.42 feet; thence S32°12'13"E, 144.56 feet; thence S11°33'38"E, 324.83 feet to the S. line of said Sect. 16; thence retracing this description to the fork in the road and continuing thence S89°04'46"E, 308.16 feet; thence S70°42'56"E, 610.74 feet to the E. line of said Sect. 16.

Easement Description to Southwest corner of Sect. 16, T35N, R12E:

Commencing at the N. 1/8 corner on the 1/4 line of Sect. 16, T35N, R12E, thence N89°27'41"E, 19.49 feet to the point of beginning;

Thence Southerly along the easement to the E. line of Parcel E; thence continuing S71°05'06"W, 173.00 feet; thence S32°35'49"W, 184.63 feet; thence S47°28'26"W, 233.86 feet; thence S25°09'14"W, 383.77 feet; thence S12°10'56"W, 214.05 feet; thence S55°36'08"W, 208.26 feet; thence S44°58'50"W, 352.62 feet; thence S31°18'06"W, 303.81 feet; thence S39°24'48"W, 159.80 feet to the Southwest corner of said Sect. 16.

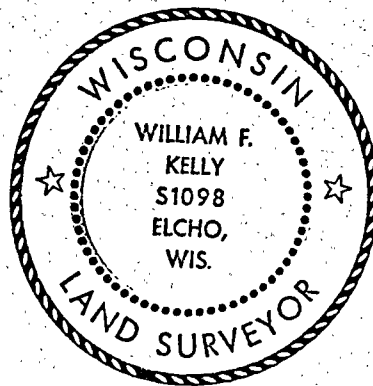

William F. Kelly

12-29-89