

CERTIFIED LAND CORNER RESTORATION

State of Wisconsin

County of Forest

ss.

I William B. Cochran, do hereby certify that on the 26th day of September, 1974, I found evidence of the West Meander corner of Sections 26 and 35 Township 40 North, Range 14 East, Fourth Principal Meridian, as described hereon; and that from this evidence I established a new monument and accessories as described hereon to perpetuate the original location of this corner:

Description of original monument and accessories and subsequent restorations:

Dependent Resurvey of 1950 by H. B. Crawford

On west shore of Little Wapoose Lake set tamarack post, 6 feet long, 3 inches diameter, squared on top, set 36 inches in the ground. Marked MC on E, S26 on N., S35 on S. and T40N, R14E on W.

White pine 4, bears S20°E, 13 lks
White pine, 4, bears N79°30W, 44 lks

Description of corner evidence found:

Tamarack post as described above in place.

White pine 4, dead and down, S20E, 13 lks

White pine 4, dead, N79°W, 44 lks

Description of monument and accessories I established to perpetuate the location of this corner:

Replace tamarack post with a 2 inch inside diameter, galvanized iron pipe, 5 feet long, filled with concrete with brass cap stamped: T40N, R14E, S26, MC, S35, 1974, S-1107.

Blazed and scribed the following near bearing tree

Black spruce 3, S 25W, 7.76 ft.

Set steel sign post 0.5 feet southwest of monument.

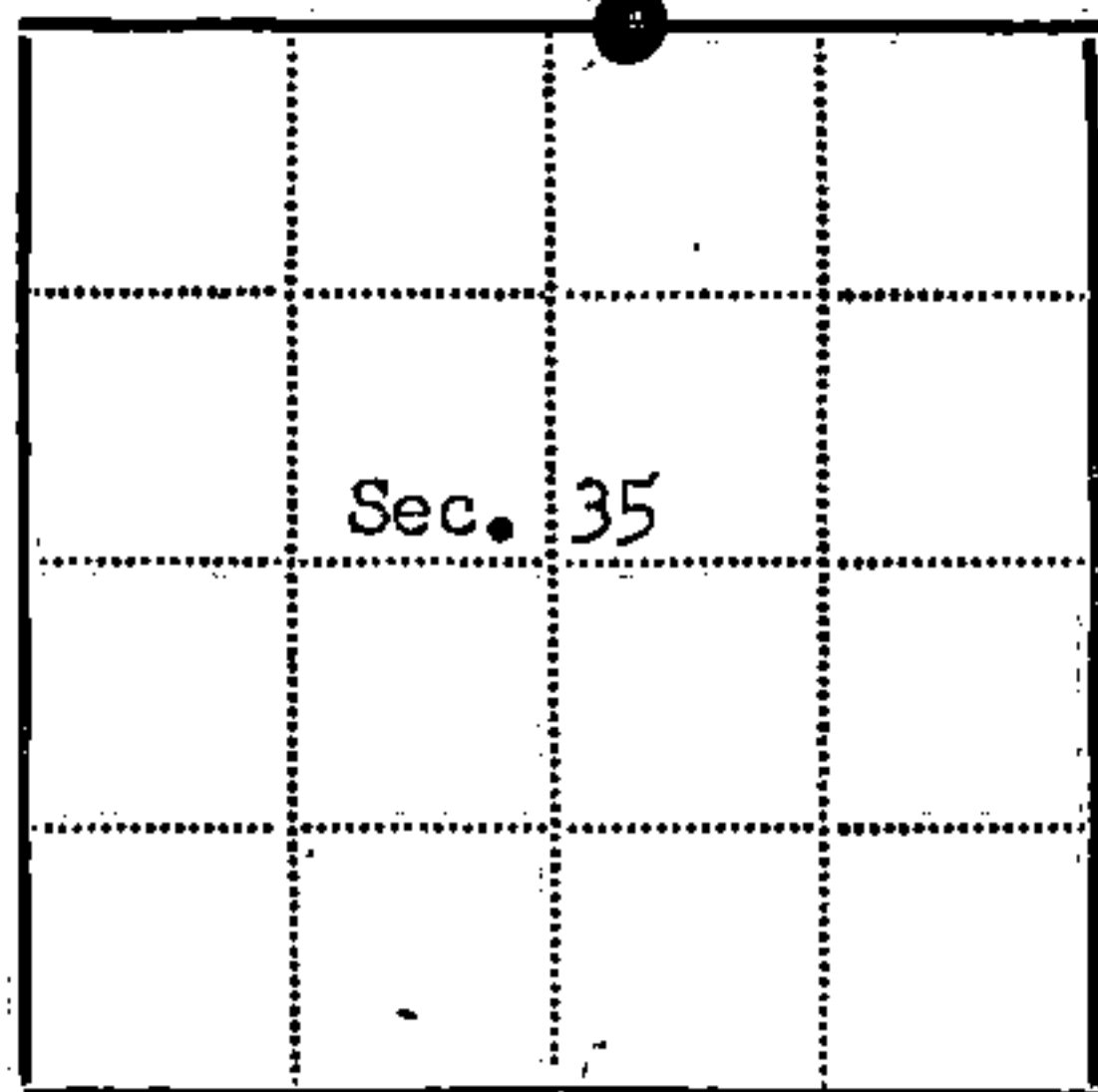
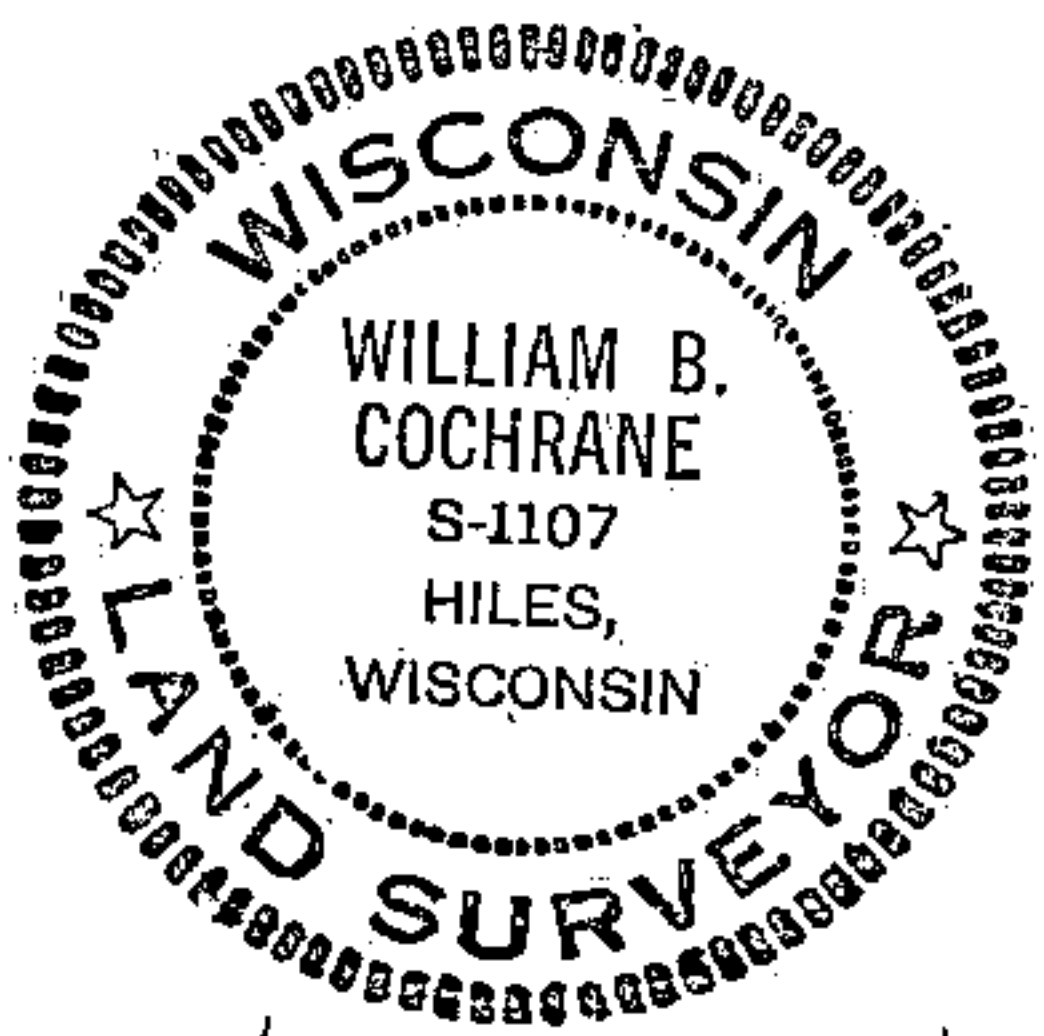

= Corner monument restored



=

Resident witnesses

Dated at Rhineland Wisconsin, this 26th day of March 1975.

Signature William B. Cochran Title Survey Technician
(County Surveyor, Registered Land Surveyor, or other duly authorized official)

Surveyors Registration No. S-1107 Document Number 106891

Office of Register of Deeds County of Forest

I hereby certify that the within instrument was filed in this office for record on the 31st day of March 1975, and was filed in Book Corner No. V-19, 20 Page No. 20 of County Records.

Signature Eugene Stetson Title Register of Deeds

Township 40 North, Range 14 East, Section 35, Index No. V-19, 20, Page No. 20

44014 260018

V19
20