

U.S. PUBLIC LAND SURVEY MONUMENT RECORD

Index No. R-II

State of Wisconsin }
County of Forest } ss.

I, Gary L. Pisoni, do hereby
certify that on the 24th day
of June, 1986, I found
evidence of the South quarter
corner of Section 21
Township 40, North, Range
14E, Fourth Principal Meridian,
as described hereon; and that from this evidence
I established a new monument and accessories
as described hereon to perpetuate the original
location of this corner.

Resident witnesses:

Kyle Erickson

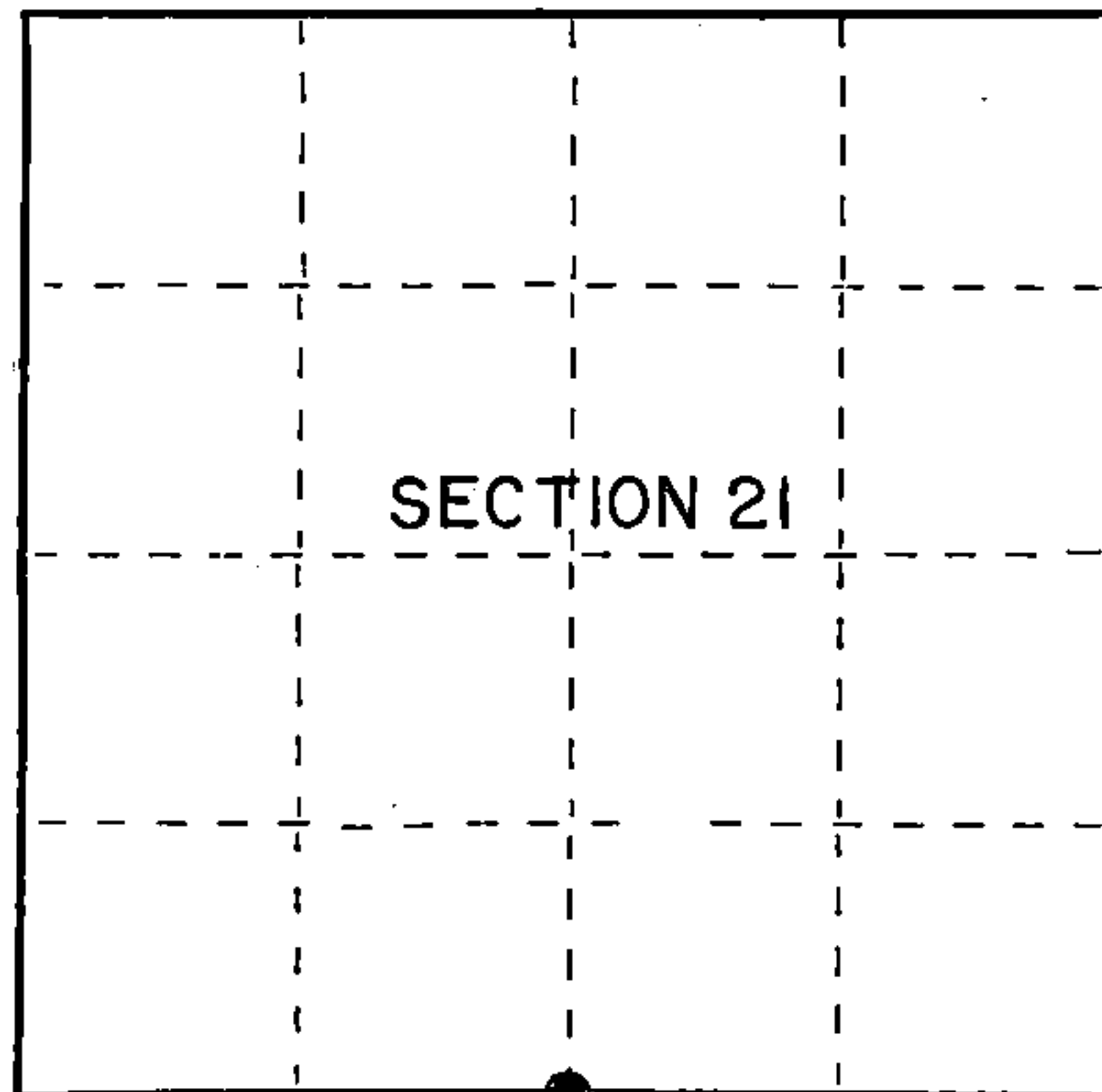

○ = Corner monument restored.

History of original corner establishment:

Original Government survey in 1865.

Dependent Re-survey in 1925 by Brown. On August 28, 1974, Jean Resvick, a land surveyor with the U.S. Forest Service reset the quarter corner between Sections 21 and 28 because the monument set by Brown was destroyed in a logging operation. Monument set by Resvick was a 2½" diameter by 3' long galvanized iron pipe with a brass cap stamped: T40N, R14E, ¼, S21, S28, 1974, S-802 from which the following bear:

Yellow Birch	16"	N.48°E.	24.42 feet	Steel sign post
Hemlock	10"	S.11°W.	29.70 feet	South
Maple	18"	N.15°E.	115.94 feet	0.5 feet

Description of corner evidence found:

Monument as described and in place, from which the following bear:

Maple	20"	N.15°E.	115.94 feet
Steel sign post		South	0.5 feet

Description of monument and accessories I established to perpetuate the original location of this corner.

Blazed and scribed the following new bearing tree:

Balsam	8"	S.61°E.	43.26 feet
--------	----	---------	------------

Dated at Iron River, MI, Wis., this 2nd day of November, 1987

Signature Gary L. Pisoni Title Land Surveyor Registration No. S-1634
(County Surveyor, Registered Land Surveyor, or other duly authorized official)

Office of Register of Deeds, County of Forest, I hereby certify that the within instrument was filed in this office for record on the 18th day of March, 1988 at 12:50 clock P. M.

Paul Aschenbrenner
(Register of Deeds)

By _____ Deputy

FORM NO. 985-A

H.C. Miller Company
Milwaukee, Wisconsin

Stock No. 26273

DOCUMENT NUMBER 134852

44014210020

(e) Describe any material discrepancy between the location of the corner as restored or reestablished and the location of that corner as previously restored or reestablished by distance and direction. Show the discrepancy on the plan view drawing under (d), above. Show the distances between the corner as previously restored or reestablished and (1) the corner as restored or reestablished, and (2) to at least 2 of the witness monuments shown on the drawing in (d), above.

See drawing below.

(f) Was the corner restored through acceptance of (1) an obliterated evidence location, or, (2) a found perpetuated location?

Restored through acceptance of a found perpetuated location.

(g&h) Was the corner reestablished through lost corner proportionate methods? If so, show the method, including the directions and distances to other public land survey corners used as evidence or used for proportioning in determining the corner location?

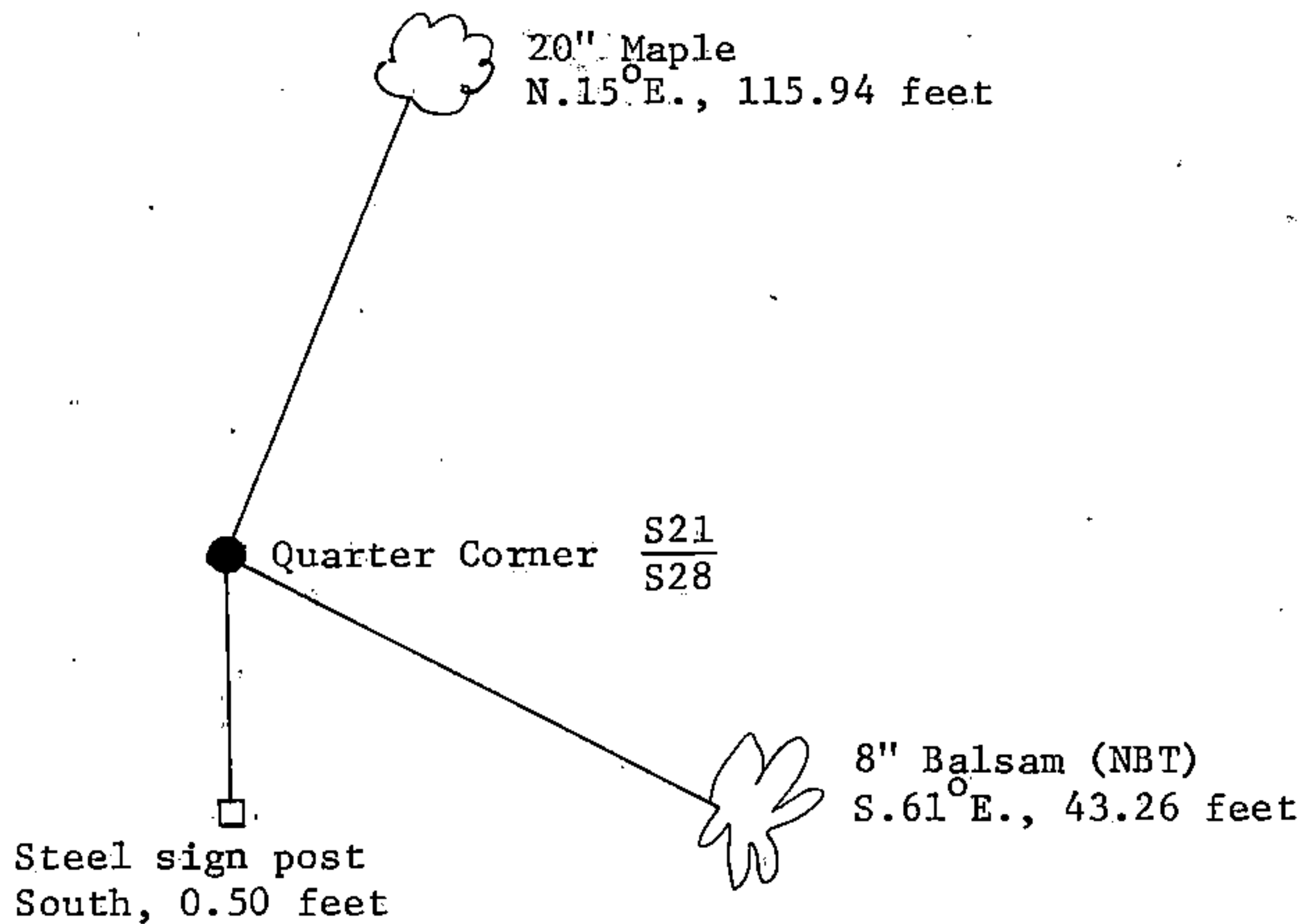

(i) I, Gary L. Pisoni
(type or print name) certify that the corner location shown on this record was determined by me or under my direction and control and that this U.S. Public Land Survey Monument Record is correct and complete to the best of my knowledge and belief.

Signature

Gary L. Pisoni

Date

11-2-87

Survey requested by:

Edward [unclear]
District Ranger

Date

3-7-88