

U.S. PUBLIC LAND SURVEY MONUMENT RECORD

Index No. J-19

State of Wisconsin }
County of Forest } ss.

I, William B. Cochrane, do hereby certify that on the 13th day of November, 1985, I found evidence of the South Quarter corner of Section 11 Township 40 North, Range 14 East, Fourth Principal Meridian, as described hereon; and that from this evidence I established a new monument and accessories as described hereon to perpetuate the original location of this corner.

Resident witnesses:

David Brownell

Tony Tillman

History of original corner establishment:

Original Government Survey in 1865 by William E. Daugherty. West corrected between Sections 11 and 14, 40.30 chains, set Quarter Section Post to Sections 11 and 14, from which the following bear;

Birch	7"	S66°W	21 lks.
Cedar	12"	N22°E	36 lks.

Description of corner evidence found:

No corner evidence recovered.

The corner position is re-established at proportionate distance, and on line between the Southeast and Southwest Section Corners of Section 11.

Description of monument and accessories I established to perpetuate the original location of this corner.

At the corner position, set a 2½ inch diameter aluminum pipe monument, 3 feet long, 2½ feet in the ground, with an aluminum cap stamped; T40N R14E, 1/4, S11, S14, 1985, S-1107. From which the following new blazed and scribed bearing trees bear;

Spruce	5"	N52°E	12.80 feet
Spruce	5"	S22°E	21.43 feet
Steel Sign Post		West	1.00 feet

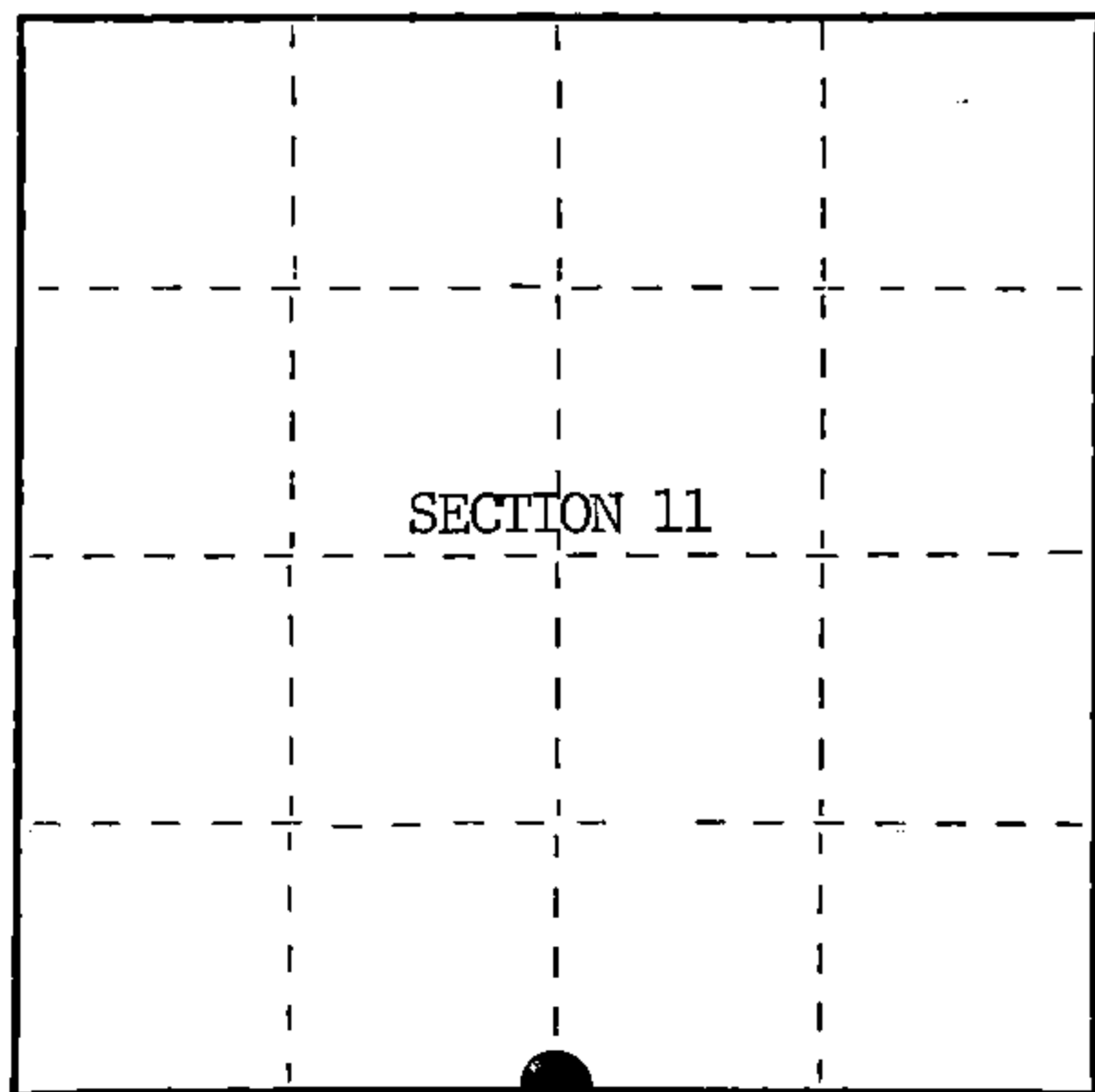

○ = Corner monument restored.

Dated at Hiles, Wis., this 12th day of October, 1986

Signature *William B. Cochrane* Title Land Surveyor Registration No. S-1107
(County Surveyor, Registered Land Surveyor, or other duly authorized official)

Office of Register of Deeds, County of Forest, I hereby certify that the within instrument was filed in this office for record on the 11th day of March, 1987 at 3:30 o'clock P. M.

Paul Achenbrenner
(Register of Deeds)

By _____ Deputy

FORM NO. 985-A

H. C. Miller Company

Stock No. 26273

DOCUMENT NUMBER 132453

44014110020

(e) Describe any material discrepancy between the location of the corner as restored or reestablished and the location of that corner as previously restored or reestablished by distance and direction. Show the discrepancy on the plan view drawing under (d), above. Show the distances between the corner as previously restored or reestablished and (1) the corner as restored or reestablished, and (2) to at least 2 of the witness monuments shown on the drawing in (d), above.

See drawing below.

(f) Was the corner restored through acceptance of (1) an obliterated evidence location, or, (2) a found perpetuated location?

(g&h) Was the corner reestablished through lost corner proportionate methods? If so, show the method, including the directions and distances to other public land survey corners used as evidence or used for proportioning in determining the corner location?
 Re-established through lost corner proportionate methods.

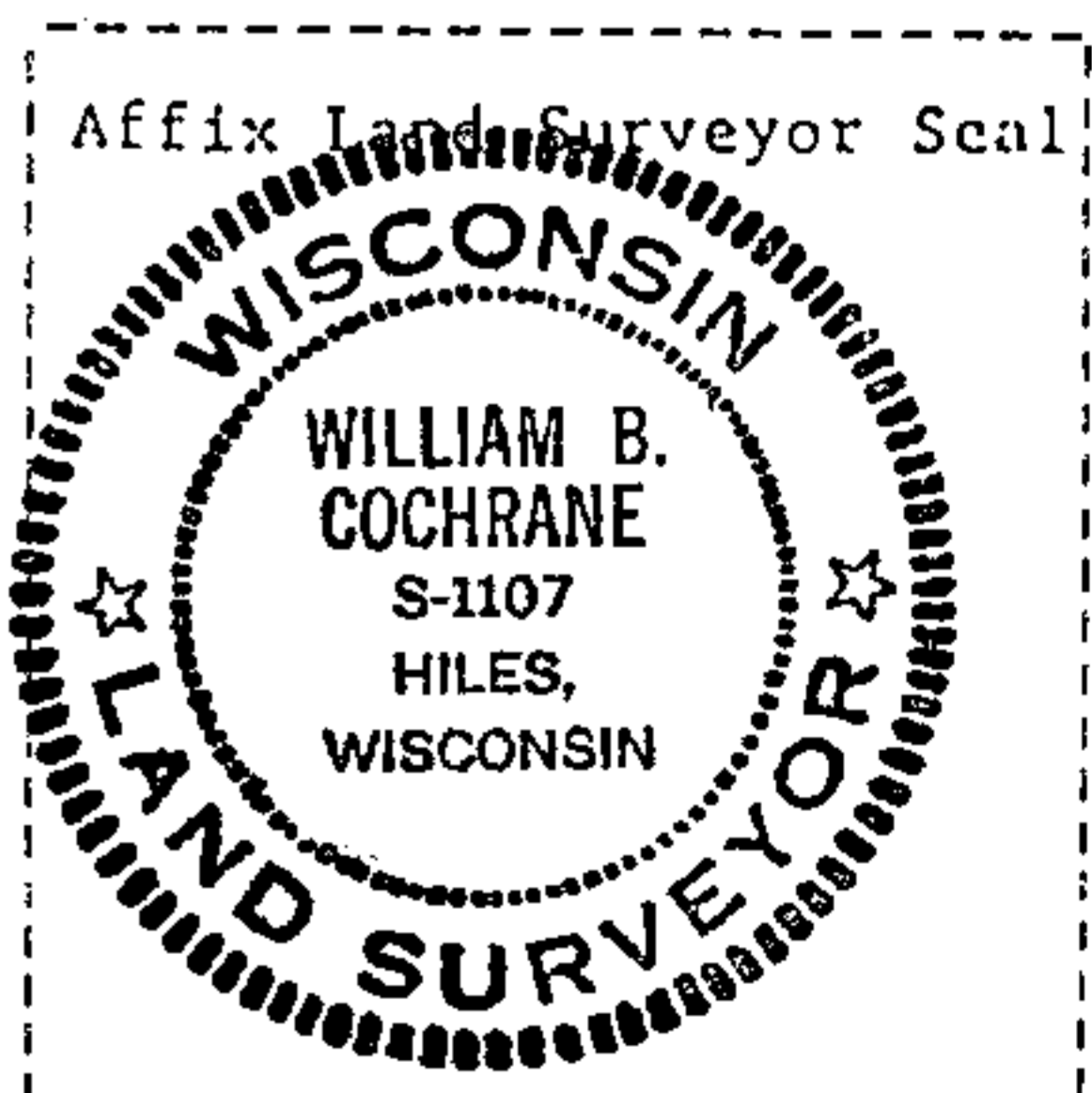
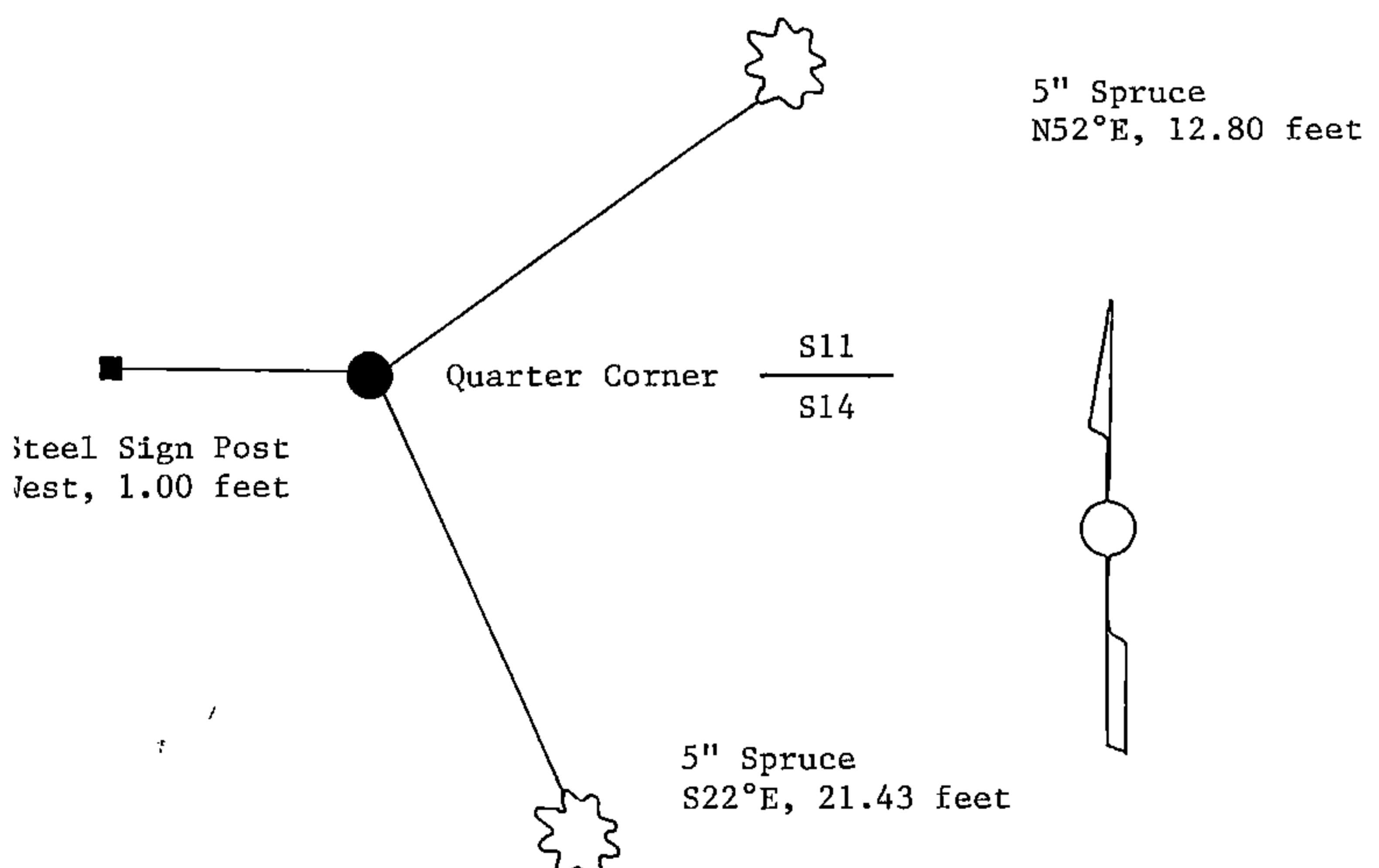
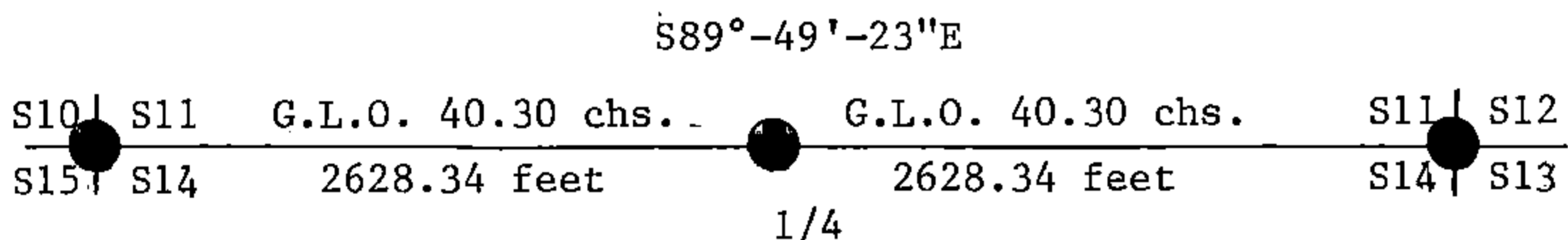

(i) I, William B. Cochrane
 (type or print name) certify that the corner location shown on this record was determined by me or under my direction and control and that this U.S. Public Land Survey Monument Record is correct and complete to the best of my knowledge and belief.

William B. Cochrane Signature October 14, 1986 Date

Certificate ready for filing: [Signature] District Ranger 3-9-87 Date