

U.S. PUBLIC LAND SURVEY MONUMENT RECORD

Index No. E-13

State of Wisconsin }
 County of Forest } ss.

I William B. Cochran, do hereby certify that on the 29th day of February, 1985, I found evidence of the Northwest Section corner of Section 10 Township 40, North, Range 14 East, Fourth Principal Meridian, as described hereon; and that from this evidence I established a new monument and accessories as described hereon to perpetuate the original location of this corner.

Resident witnesses:

Tony Tillman

History of original corner establishment:

Original Government Survey in 1865 by William E. Daugherty. North between Sections 9 and 10, 80.00 chains, set Section Corner Post to Sections 3, 4, 9 and 10, from which the following bear;

Cedar	12"	S45°W	29 lks.
Cedar	12"	N73°E	12 lks.

Description of corner evidence found:

3"x3" Squared Wood Post

I accept the 3"x3" Squared Wooden Post as the best available evidence for restoring the corner position.

No original corner evidence was recovered.

Description of monument and accessories I established to perpetuate the original location of this corner.

At the restored corner position, set a 2½" diameter aluminum pipe monument, 5 feet long, 4 feet in the ground, with an aluminum cap stamped; T40N R14E, S3, S4, S9, S10, 1985, S-1107. From which the following new blazed and scribed bearing trees bear;

Spruce	13"	N40°E	21.76 feet
Balsam	6"	S68°E	23.05 feet
Cedar	7"	S44°W	25.98 feet
Steel Sign Post		SE	0.50 feet

Dated at Hiles, Wis., this 7th day of January, 1986.

Signature William B. Cochran Title Land Surveyor Registration No. S-1107
 (County Surveyor, Registered Land Surveyor, or other duly authorized official)

Office of Register of Deeds, County of Forest, I hereby certify that the within instrument was filed in this office for record on the 11th day of March, 1987 at 3:30 clock P. M.

Paul Achenbrenner
 - (Register of Deeds)

By _____ Deputy

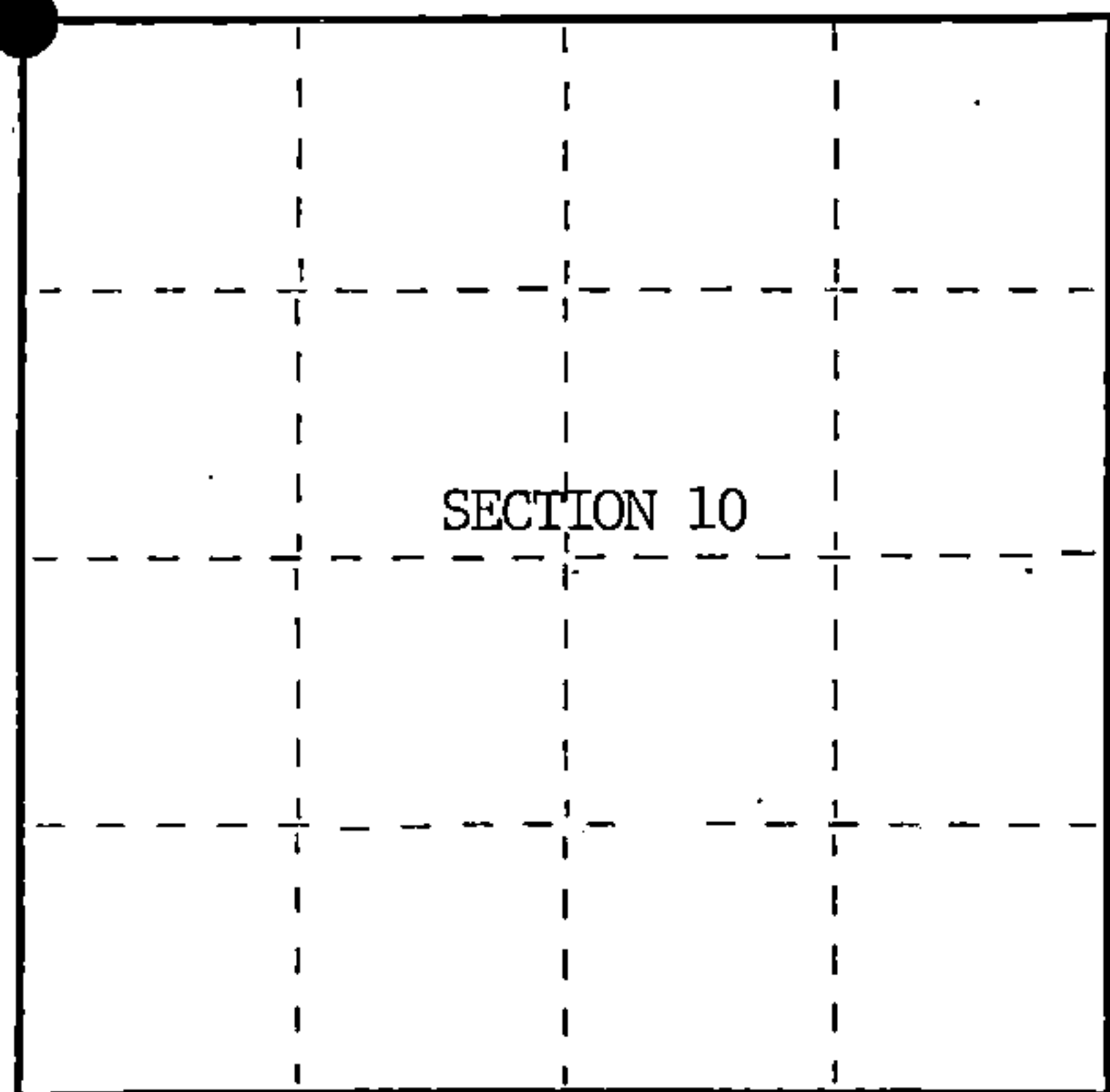

○ = Corner monument restored.

FORM NO. 985-A

H.C. Miller Company

Stock No. 26273

DOCUMENT NUMBER 132445

4401404.0000

(e) Describe any material discrepancy between the location of the corner as restored or reestablished and the location of that corner as previously restored or reestablished by distance and direction. Show the discrepancy on the plan view drawing under (d), above. Show the distances between the corner as previously restored or reestablished and (1) the corner as restored or reestablished, and (2) to at least 2 of the witness monuments shown on the drawing in (d), above.

See drawing below.

(f) Was the corner restored through acceptance of (1) an obliterated evidence location, or, (2) a found perpetuated location?

Restored from accepted evidence.

(g&h) Was the corner reestablished through lost corner proportionate methods? If so, show the method, including the directions and distances to other public land survey corners used as evidence or used for proportioning in determining the corner location?

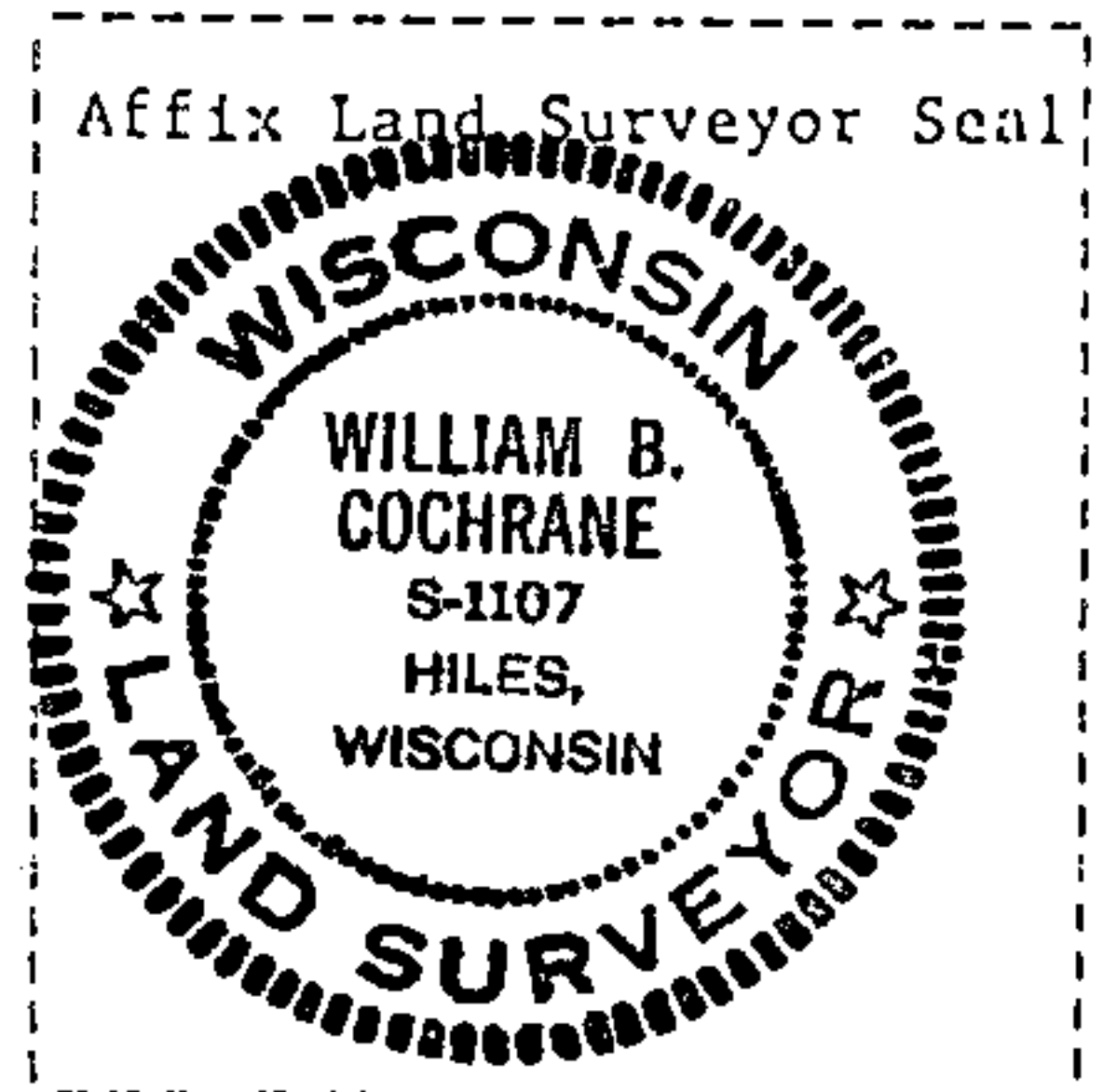
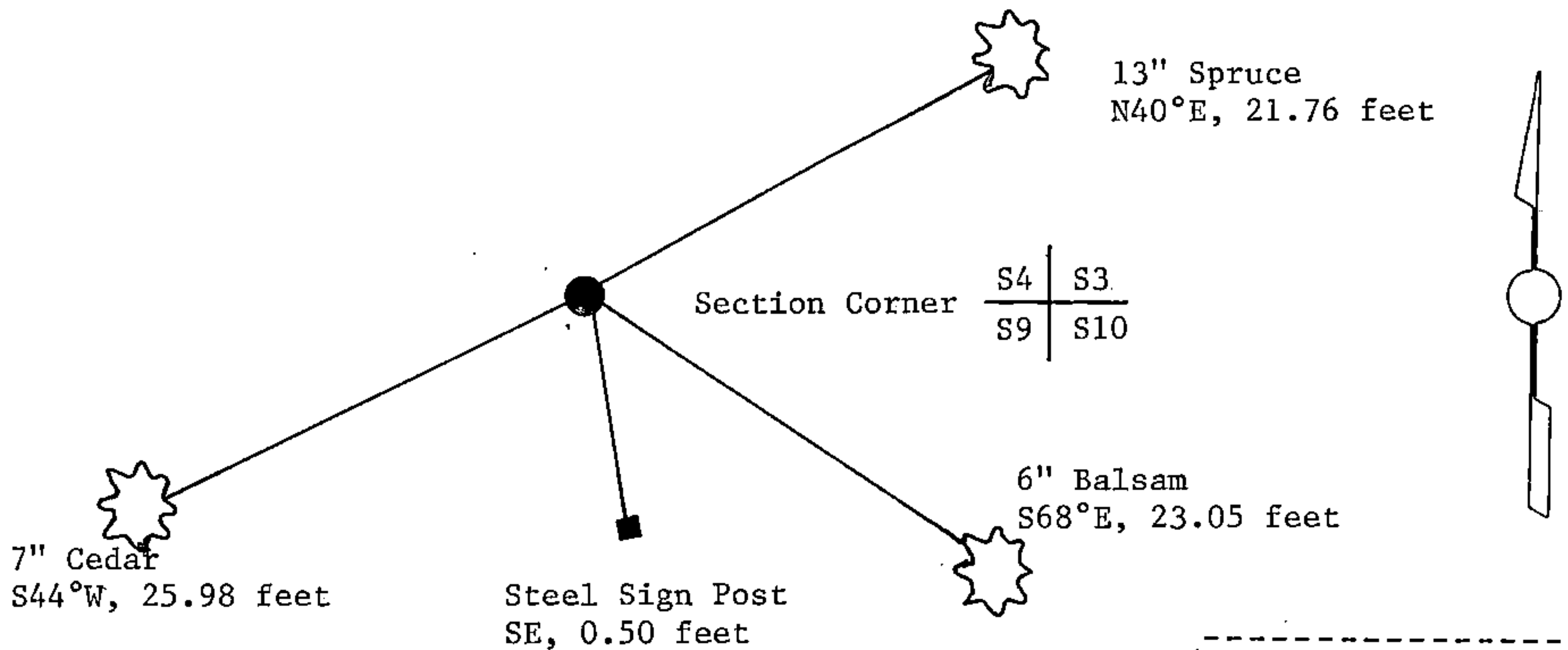

(i) I, William B. Cochrane
 (type or print name) certify that the corner location shown on this record was determined by me or under my direction and control and that this U.S. Public Land Survey Monument Record is correct and complete to the best of my knowledge and belief.

William B. Cochrane October 14, 1986
 Signature Date

Certificate ready for filing: [Signature] 3-9-87
 District Ranger Date