

U.S. PUBLIC LAND SURVEY MONUMENT RECORD

Index No. A-15

State of Wisconsin }  
County of Forest } ss.

I, Gary L. Pisoni, do hereby certify that on the 9th day of July, 1990, I found evidence of the North Quarter corner of Section 3 Township 39, North, Range 13 East, Fourth Principal Meridian, as described hereon; and that from this evidence I established a new monument and accessories as described hereon to perpetuate the original location of this corner.

Resident witnesses:

.....  
.....  
.....

History of original corner establishment:

Original Government Survey in 1858 by Alfred Millard. West between Sections 34 and 3, at 40.00 chains, set Quarter Corner Post to Sections 34 and 3, T39-40N, R13E. From which the following bear;

Black Ash	11"	N.20°E.	28 links
Hemlock	15"	S 50°W	27 links

Description of corner evidence found:

Found a 2" x 3½" x 16" wood post lying on the ground and rotted at ground line.

I accept the wood post as the best available evidence for restoring the corner position.

No original corner evidence was recovered.

Description of monument and accessories I established to perpetuate the original location of this corner.

In place of wood post, set a 2½" x 36" aluminum pipe monument 3" above the ground with an aluminum cap stamped; T39N, T40N, 1/4, S34, S3, 1990, S-1634. From which the following new blazed and scribed bearing trees bear; Measurements taken to nail in side of tree..

Spruce	16"	N 84°E	21.96 feet
Ash	4"	S 58°E	19.50 feet
Spruce	9"	West	21.93 feet
Steel Sign Post		N 32°E	1.20 feet

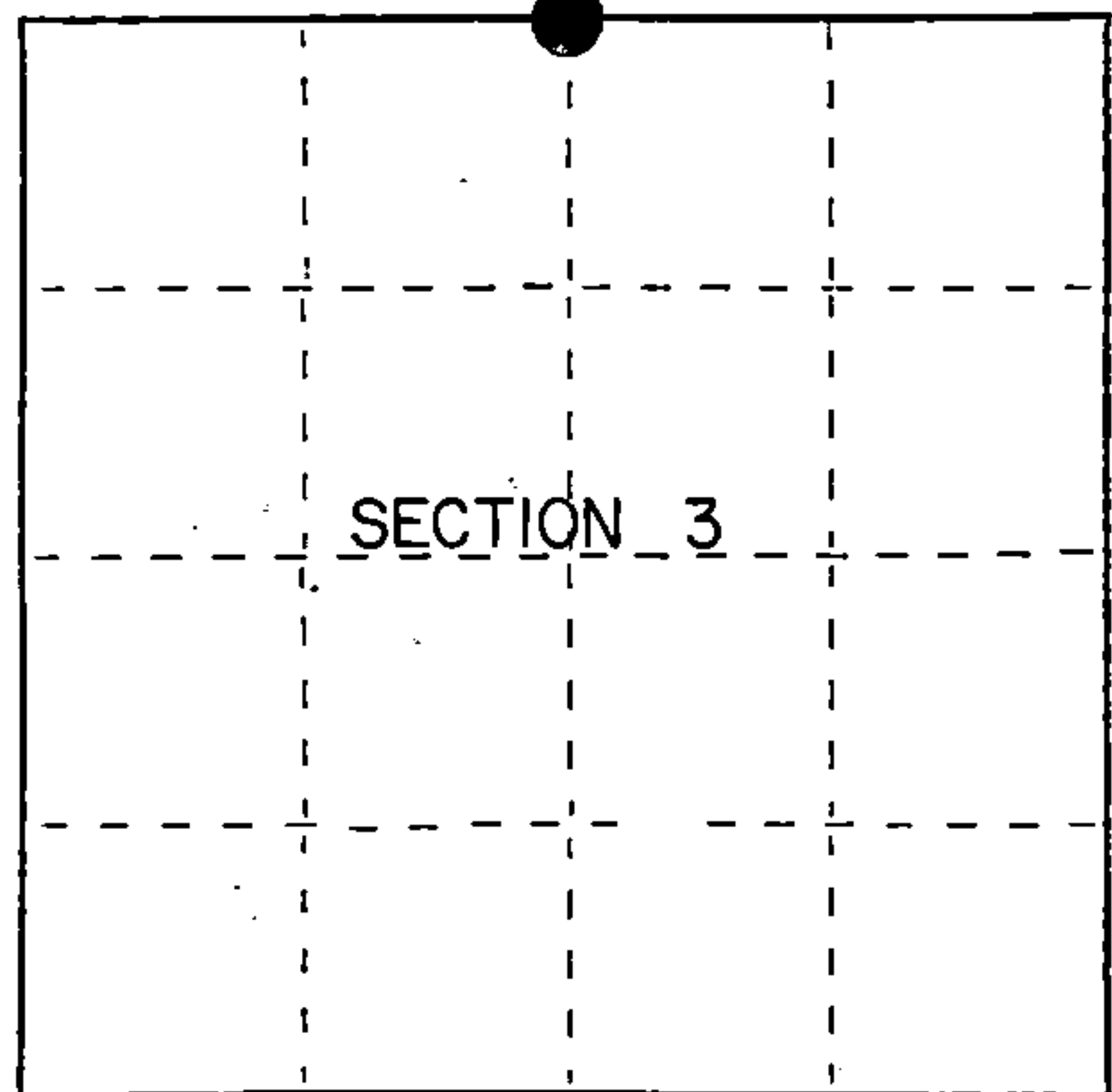

● = Corner monument restored.

Dated at Iron River, MI, ~~WIS~~, this 20th day of August, 1990

Signature Gary L. Pisoni Title Land Surveyor Registration No. 1634  
(County Surveyor, Registered Land Surveyor, or other duly authorized official)

Office of Register of Deeds, County of Forest, I hereby certify that the within instrument was filed in this office for record on the 10th day of March, 1993 at 10:45 o'clock A M.

Paul Schenck  
(Register of Deeds)

By \_\_\_\_\_ Deputy

FORM NO. 985-A

H.C. Miller Company  
MILWAUKEE, WISCONSIN

Stock No. 26273

146893

4401334020

e) Describe any material discrepancy between the location of the corner as restored or reestablished and the location of that corner as previously restored or reestablished by distance and direction. Show the discrepancy on the plan view drawing under (d), above. Show the distances between the corner as previously restored or reestablished and (1) the corner as restored or reestablished, and (2) to at least 2 of the witness monuments shown on the drawing in (d), above.

See drawing below

(f) Was the corner restored through acceptance of (1) an obliterated evidence location, or, (2) a found perpetuated location?

Restored from accepted evidence.

(g&h) Was the corner reestablished through lost corner proportionate methods? If so, show the method, including the directions and distances to other public land survey corners used as evidence or used for proportioning in determining the corner location?

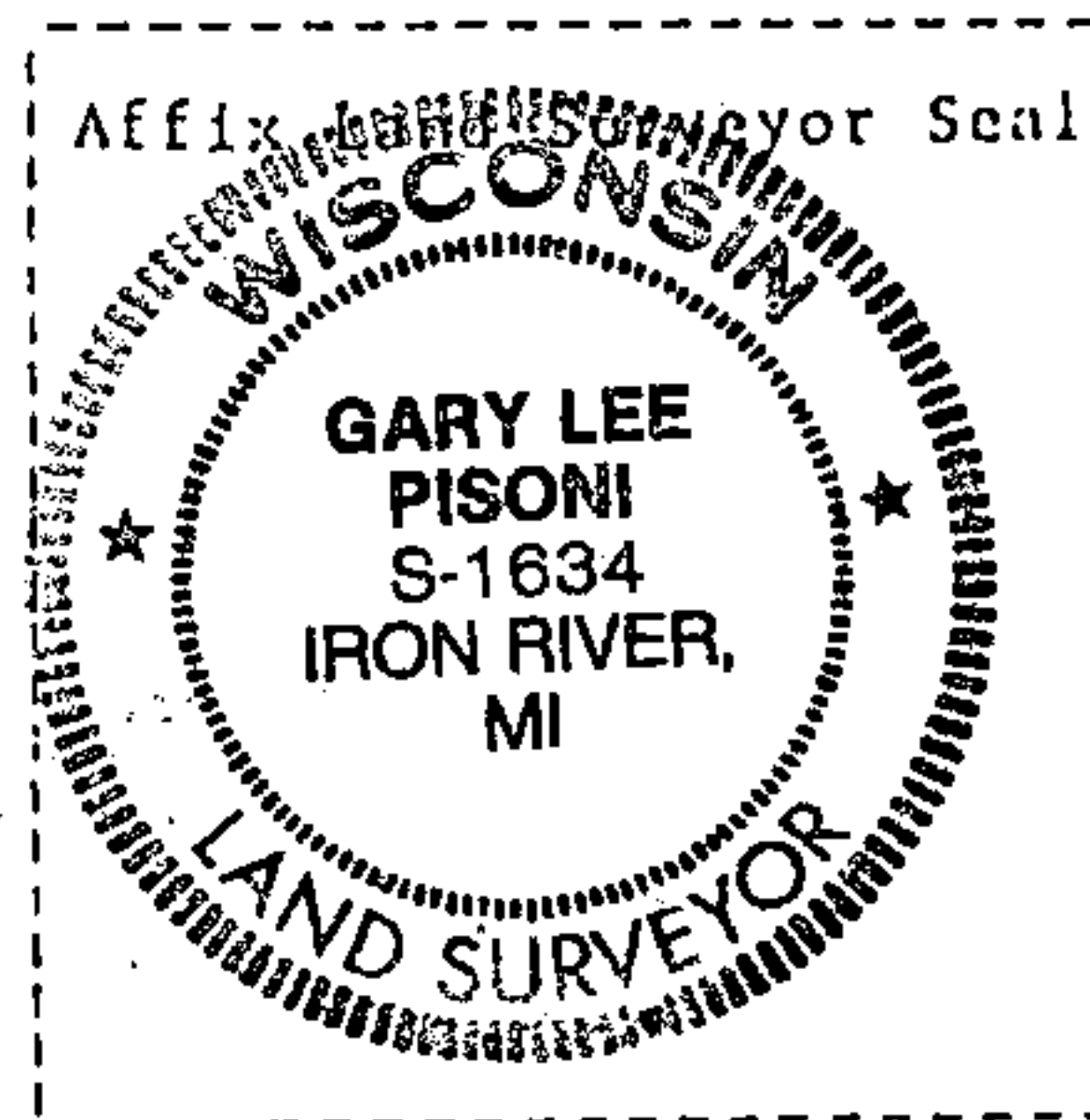
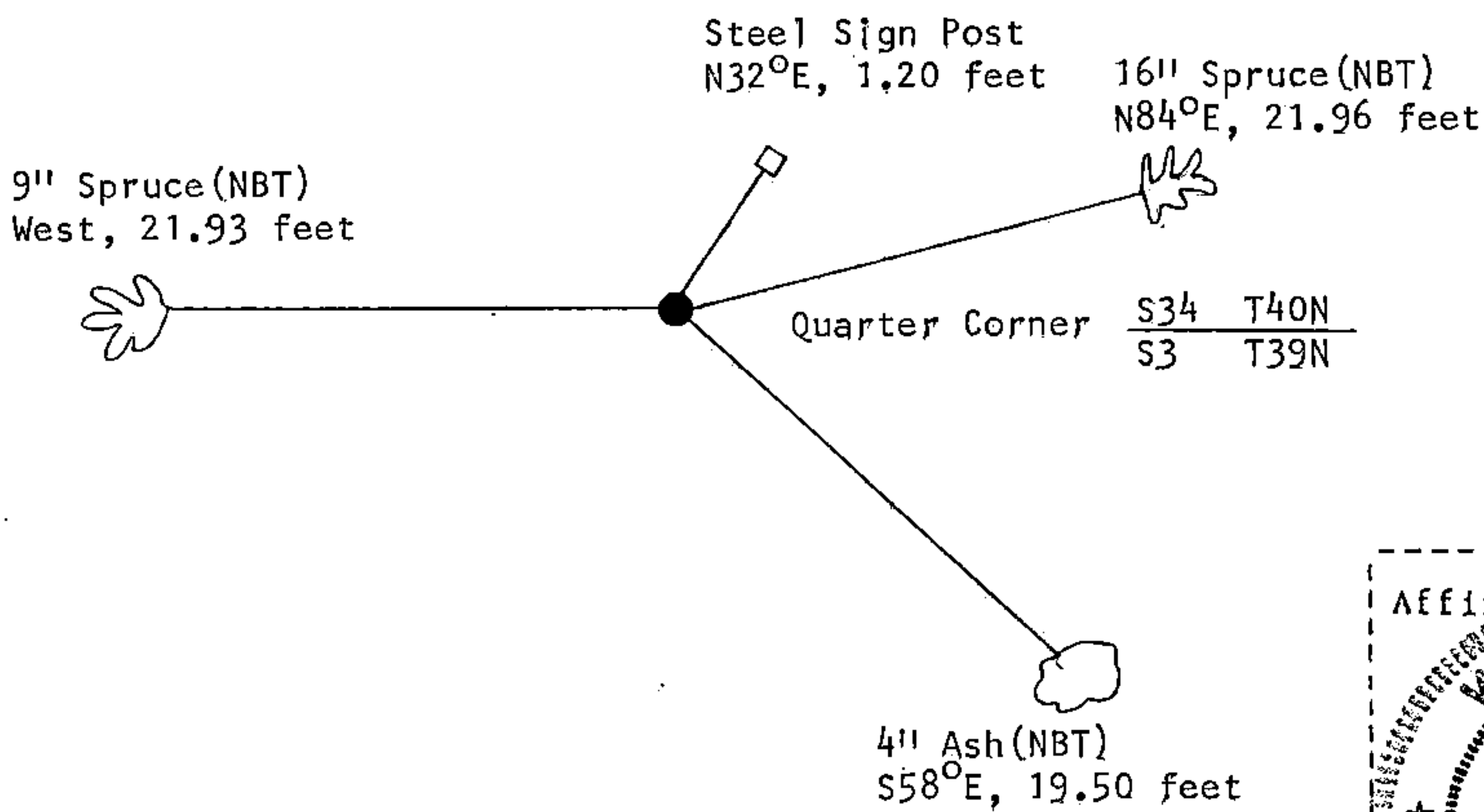

(i) I, Gary L. Pisoni  
 (type or print name) certify that the corner location shown on this record was determined by me or under my direction and control and that this U.S. Public Land Survey Monument Record is correct and complete to the best of my knowledge and belief.

Gary L. Pisoni 11/21/91  
 Signature Date

Survey requested by: Pam Gerke 12/17/92  
 District Ranger Date