

CERTIFIED LAND CORNER RESTORATION

State of Wisconsin }
County of Forest } ss.

I, Jean F. Resvick, do hereby certify that on the 26 day of September, 1979, I found evidence of the Northwest Section corner of Section 31 Township 40 North, Range 14 East, Fourth Principal Meridian, as described hereon; and that from this evidence I established a new monument and accessories as described hereon to perpetuate the original location of this corner:

Description of original monument and accessories and subsequent restorations:

Surveyed in 1858 by Alfred Millard
80.0 chains north between sections 31 & 36, Set post
Yellow Birch 12, N80E, 27 lks.
Lynn 12, N45W, 24 lks.
Yellow Birch 12, S88W, 20 lks.
Hemlock 18, S8E, 35 lks.

Description of corner evidence found:

2 inch iron pipe
Yellow birch snag bears S88W, 20 lks. with blazes, heart of tree rotted out.

Description of monument and accessories I established to perpetuate the location of this corner:

Set 2 inch inside diameter galvanized iron pipe, 3 feet long, filled with concrete with brass cap stamped: T40N, R13E, R14E, S25, S30, S36, S31, 1979, S-802 at N88E, 13.20 feet from yellow birch bearing tree snag.

Blazed and scribed the following new bearing trees:

Sugar 8, N48E, 48.45 feet
Sugar 8, S49E, 48.84 feet
Black Ash 8, S43W, 37.63 feet
Red maple 7, N51W, 23.65 feet

Set iron pipe found 0.5 feet west of monument
Set steel sign post 0.5 feet northwest of monument

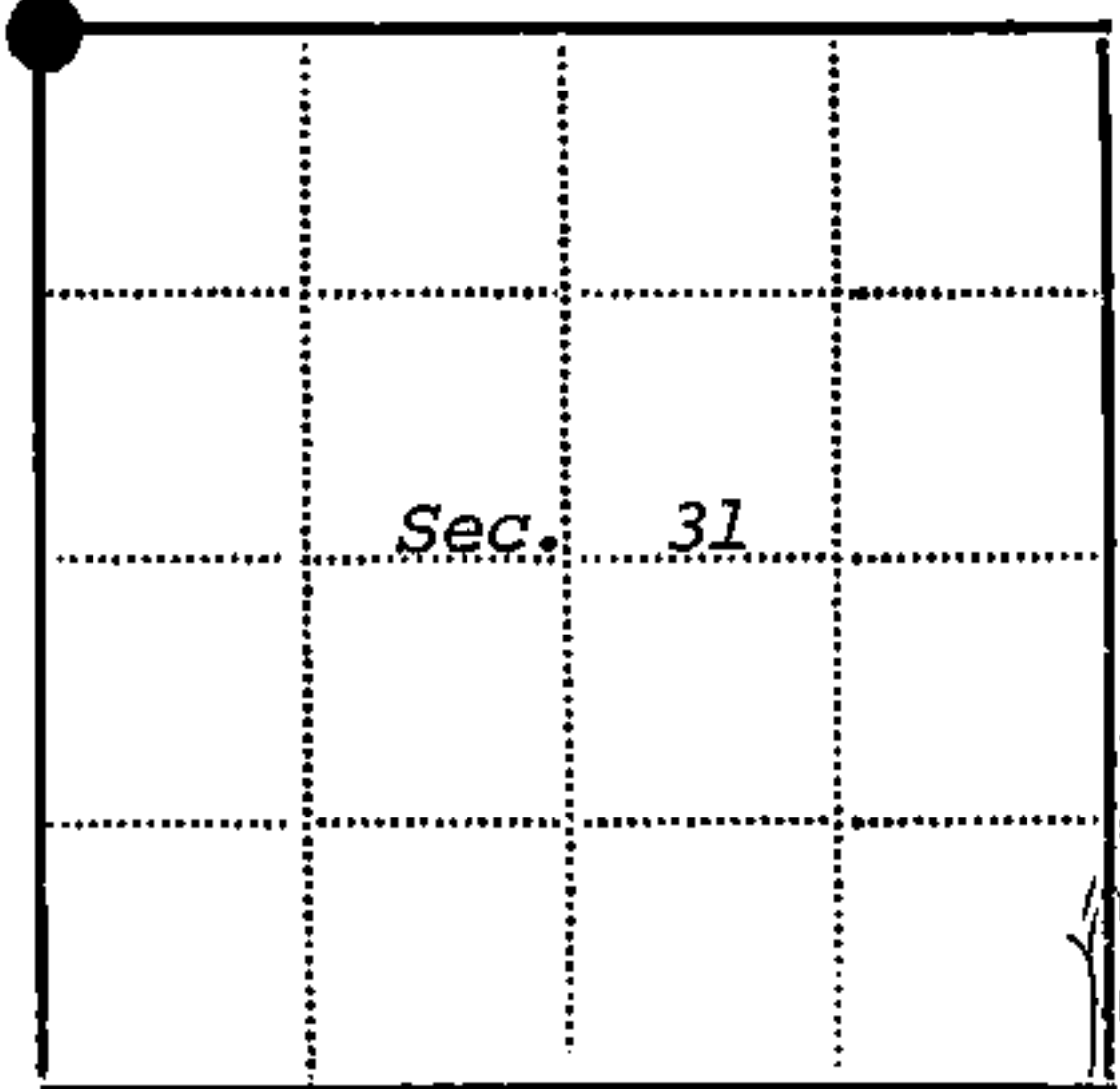
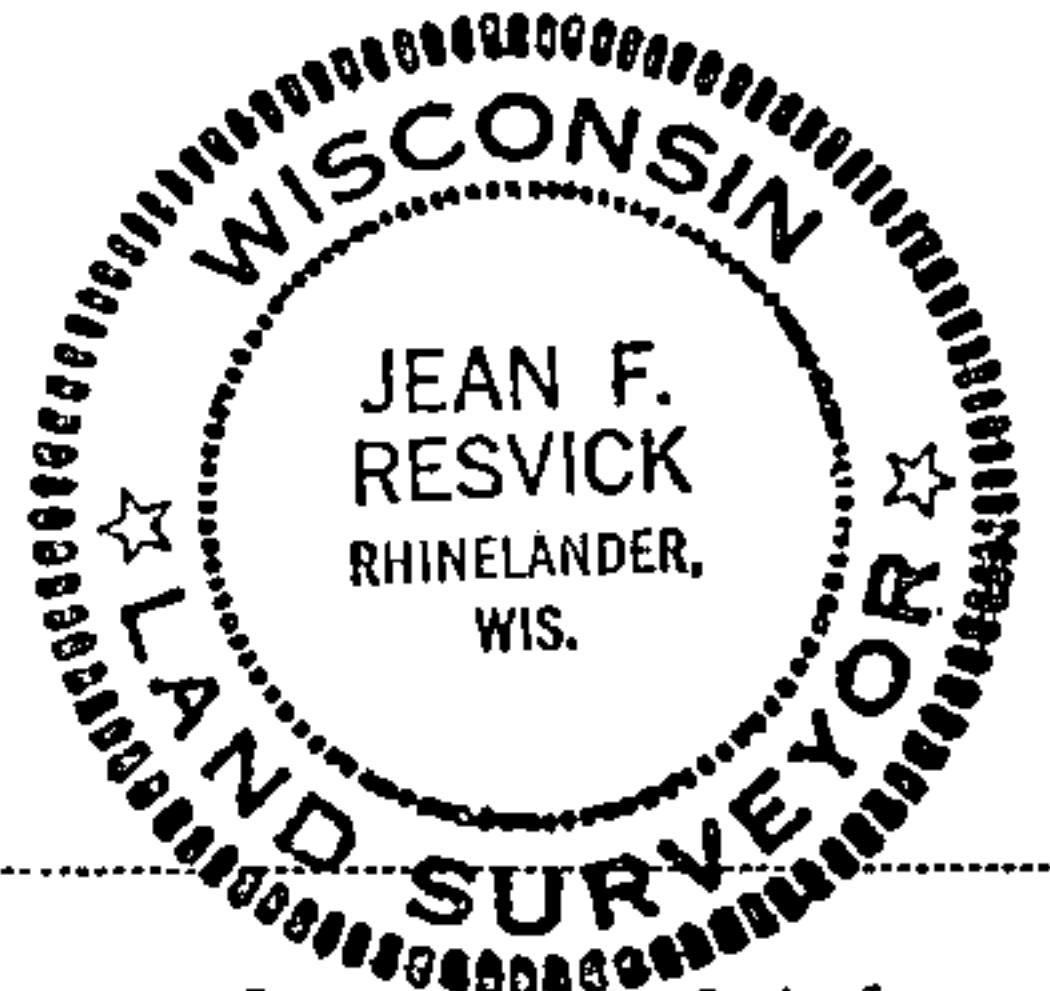

● - Corner monument restored
□ -

Resident witnesses.....

Dated at Rhinelander Wisconsin, this 1 day of October 1979.

Signature Jean F. Resvick Title Land Surveyor
(County Surveyor, Registered Land Surveyor, or other duly authorized official)

Surveyors Registration No. 5-802 DOCUMENT NO. 118085

Office of Register of Deeds County of Forest

I hereby certify that the within instrument was filed in this office for record on the 9th day of June 1980, and was filed in Book No. 1111 Page No. of County Records.

Signature Sharon Mueller Title Deputy

44013250000
Township 40 North, Range 14 East, Section 31, Index No. V-1, Page No.