

CERTIFIED LAND CORNER RESTORATION

Index No. E-3

State of Wisconsin }
County of Forest } ss.

I, William B. Cochran, do hereby certify that on the 12th day of January, 19 93, I found evidence of the SOUTH QUARTER corner of SECTION 6 Township 40 North, Range 13 EAST, Fourth Principal Meridian, as described hereon; and that from this evidence I established a new monument and accessories as described hereon to perpetuate the original location of this corner.

Resident witnesses:

History of original corner establishment:

Original Government Survey in 1865 by William E. Daugherty. East corrected between Sections 6 and 7, at 44.67 chains, set Quarter Section Post to Sections 6 and 7. From which the following bear; Sugar, 14", S60°E, 18 lks., Sugar, 12", N27°W, 16 lks.

On 10-5-70, Jean Resvick, a Land Surveyor with the Forest Service, found a scribed 4" x 4" post. In place of post, he set a 2 inch diameter galvanized wrought iron pipe, 5 feet long, with a brass cap marked; T40N R13E, 1/4, S6, S7, 1971, S-802. From which the following bear; Maple, 22", N29°W, 21.30 feet, Maple, 16", S73°W, 28.90 feet, Iron Sign Post, Southwest, 1.00 feet.

Description of corner evidence found:

Found monument as described above, and the following bearing trees;

Maple	23"	N29°W	21.30 feet
Maple(DEAD)	16"	S73°W	28.90 feet
Iron Post		Southwest	1.00 feet

Description of monument and accessories I established to perpetuate the original location of this corner.

Blazed and scribed a new bearing tree;

Spruce	12"	N12°E	30.17 feet
--------	-----	-------	------------

Re-painted existing bearing trees and Iron Sign Post.

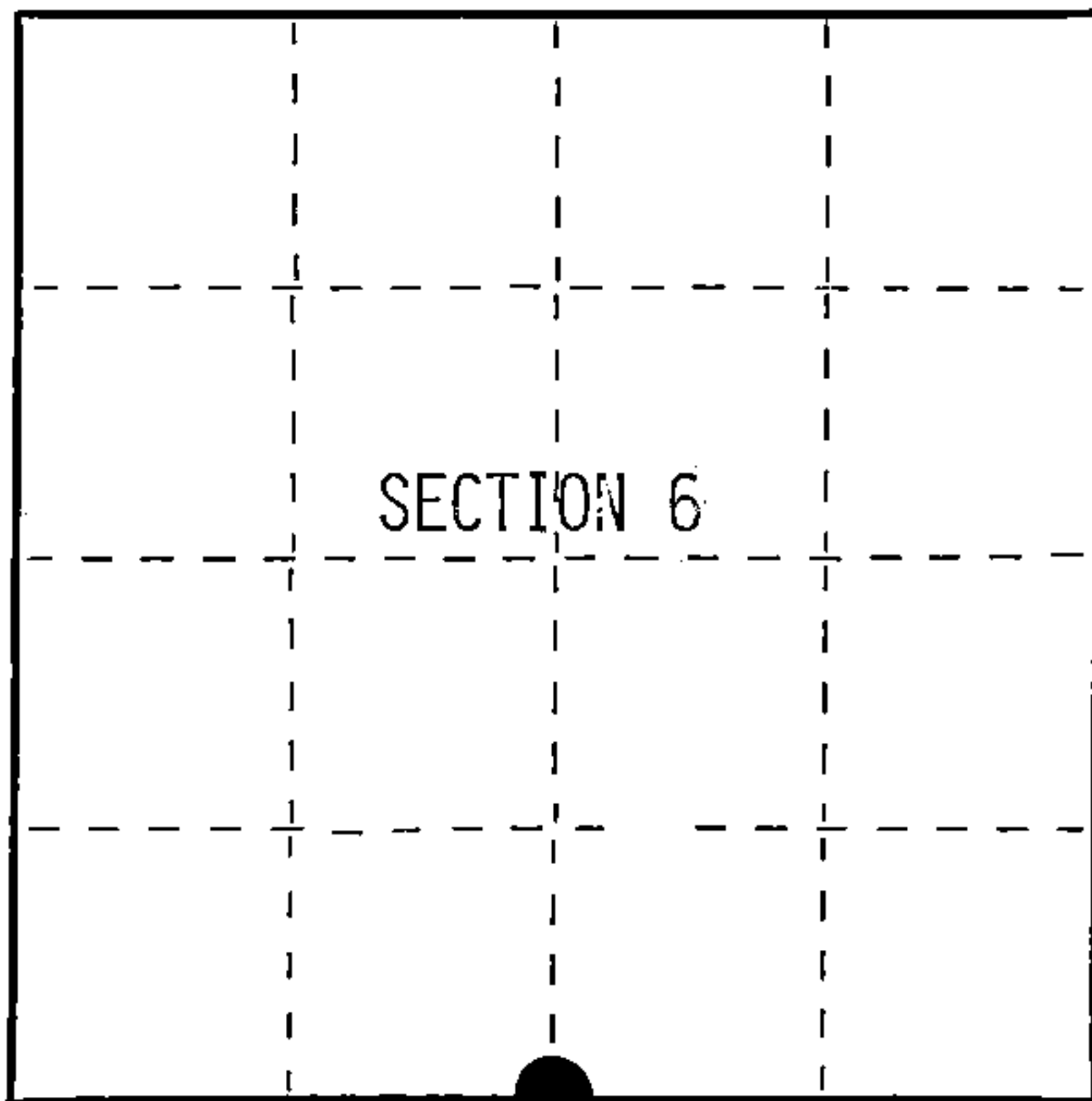

○ = Corner monument restored.

Dated at Hiles, Wis., this 10th day of February, 19 93

Signature William B. Cochran Title Land Surveyor Registration No. S-1107
(County Surveyor, Registered Land Surveyor, or other duly authorized official)

Office of Register of Deeds, County of Forest, I hereby certify that the within instrument was filed in this office for record on the 20th day of March, 19 97 at 1:30 o'clock P. M.

(Register of Deeds)

By Paul Tamburic Deputy

FORM NO. 985-A

H.C. Miller Company

Stock No. 26273

158080

FORM 985 H. C. MILLER CO., MILWAUKEE

4401300020

(e) Describe any material discrepancy between the location of the corner as restored or reestablished and the location of that corner as previously restored or reestablished by distance and direction. Show the discrepancy on the plan view drawing under (d), above. Show the distances between the corner as previously restored or reestablished and (1) the corner as restored or reestablished, and (2) to at least 2 of the witness monuments shown on the drawing in (d), above.

None

(f) Was the corner restored through acceptance of (1) an obliterated evidence location, or, (2) a found perpetuated location?

Restored through acceptance of a found perpetuated location.

(g/h) Was the corner reestablished through lost corner proportionate methods? If so, show the method, including the directions and distances to other public land survey corners used as evidence or used for proportioning in determining the corner location?

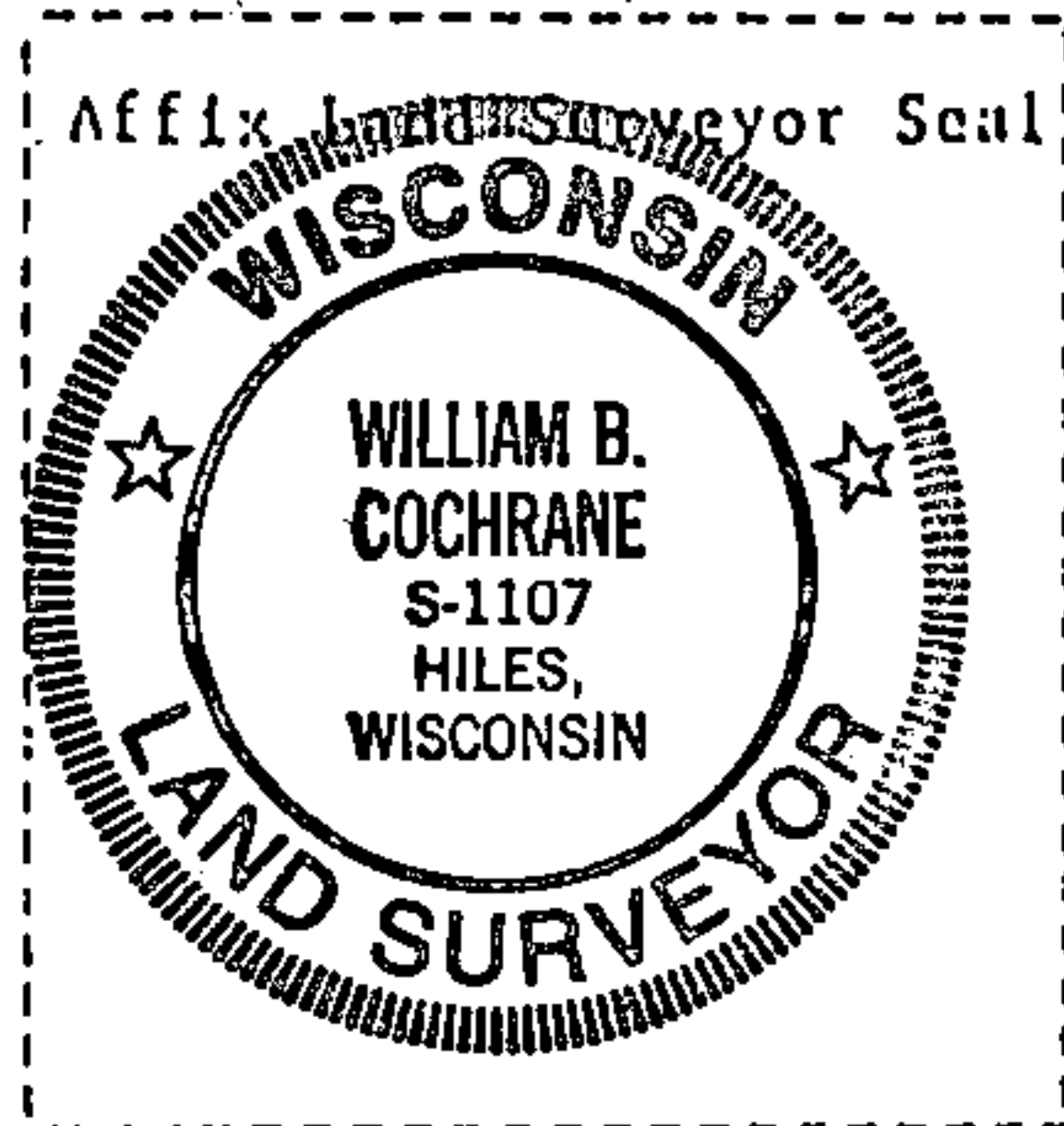
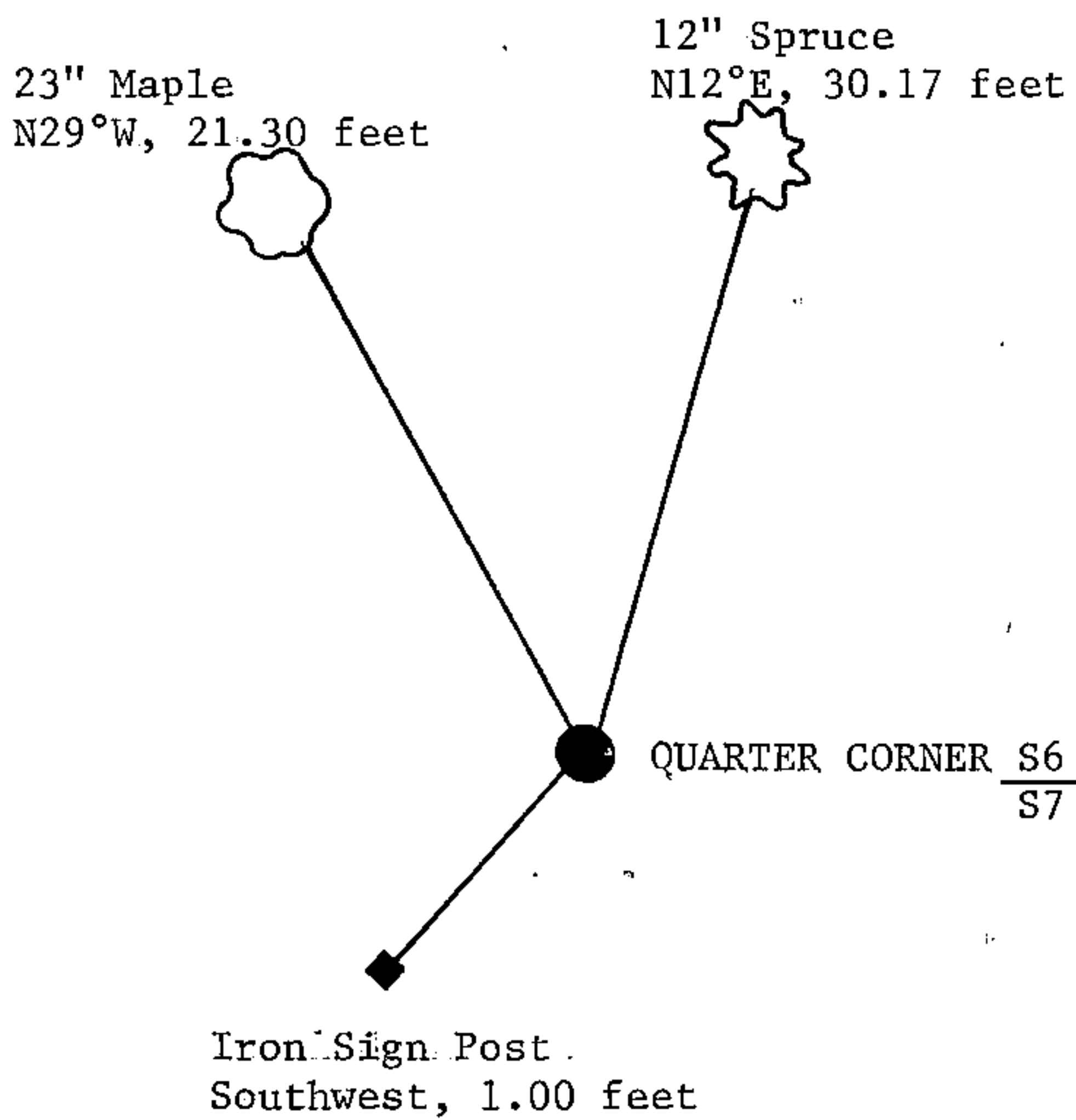

(i) I, William B. Cochrane
(type or print name) certify that the corner location shown on this record was determined by me or under my direction and control and that this U.S. Public Land Survey Monument Record is correct and complete to the best of my knowledge and belief.

William B. Cochrane 2/10/93
Signature Date

Survey requested by; _____
District Ranger Date