

U.S. PUBLIC LAND SURVEY MONUMENT RECORD

Index No. A-1

State of Wisconsin }
County of Forest } ss.

I, William B. Cochrane, do hereby certify that on the 30th day of July, 1986, I found evidence of the Northwest Section corner of Section 6 Township 40 North, Range 14 East, Fourth Principal Meridian, as described hereon; and that from this evidence I established a new monument and accessories as described hereon to perpetuate the original location of this corner.

Resident witnesses:

David Brownell

History of original corner establishment:

Original Government Survey in 1858 by Alfred Millard. Dependent Resurvey in 1945 by Hugh B. Crawford. North between Sections 1 and 6, 40.89 chains, intersect the Fourth Standard Parallel North. Set a concrete monument, 2 feet long, 6 inches in dia., 18 inches in the ground, with an iron post in center, and a brass cap mkd; T41N R14E, S31, S1, S6, R13E, R14E, T40N, CC, 1945. From which the following bear;

Poplar	4"	S54°45'E	48 lks.(31.68 feet)
Elm	12"	S10°15'W	129½ lks.(85.47 feet)

Description of corner evidence found:

Found monument as described and in place, from which the following bear;

Poplar(Stump)	S54°45'E	31.68 feet
Elm(Stump)	S10°15'W	85.47 feet

Description of monument and accessories I established to perpetuate the original location of this corner.

No Bearing Trees Available.

Steel Sign Post North 1.00 feet

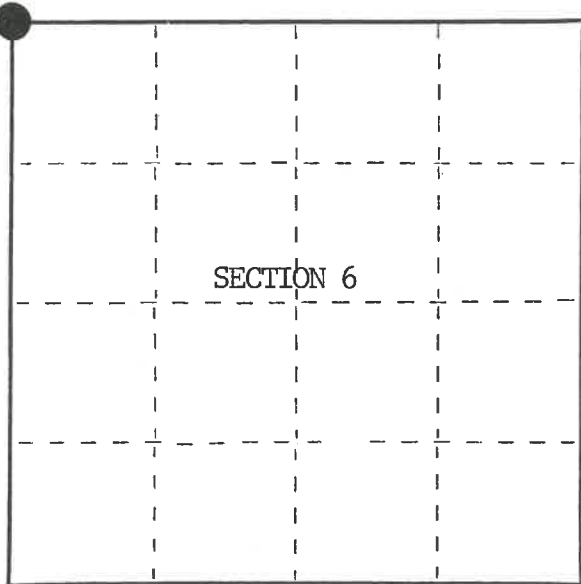

○ = Corner monument restored.

Dated at Hiles, Wis., this 25th day of September, 1986

Signature William B. Cochrane Title Land Surveyor Registration No. S-1107
(County Surveyor, Registered Land Surveyor, or other duly authorized official)

Office of Register of Deeds, County of Forest, I hereby certify that the within instrument was filed in this office for record on the 11th day of March, 1987 at 3:30 o'clock P. M.

Paul Achenbrenner
(Register of Deeds)

By _____ Deputy

FORM NO. 985-A



Stock No. 26273

DOCUMENT NUMBER 132424

44013014000

(e) Describe any material discrepancy between the location of the corner as restored or reestablished and the location of that corner as previously restored or reestablished by distance and direction. Show the discrepancy on the plan view drawing under (d), above. Show the distances between the corner as previously restored or reestablished and (1) the corner as restored or reestablished, and (2) to at least 2 of the witness monuments shown on the drawing in (d), above.

See drawing below.

(f) Was the corner restored through acceptance of (1) an obliterated evidence location, or, (2) a found perpetuated location?

Restored through acceptance of a found perpetuated location.

(g&h) Was the corner reestablished through lost corner proportionate methods? If so, show the method, including the directions and distances to other public land survey corners used as evidence or used for proportioning in determining the corner location?

Steel Sign Post
North, 1.00 feet



Closing Township Corner



S31 T41N
S1 √ S6 T40N
R13E R14E

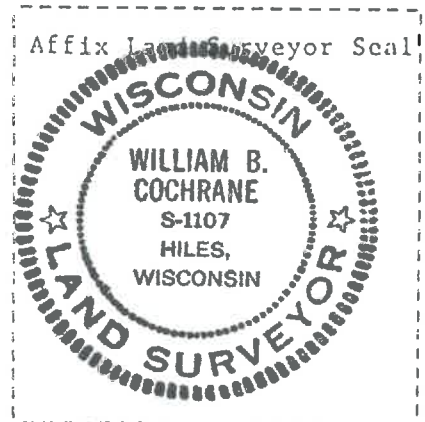

(i) I, William B. Cochrane
(type or print name) certify that the corner location shown on this record was determined by me or under my direction and control and that this U.S. Public Land Survey Monument Record is correct and complete to the best of my knowledge and belief.

William B. Cochrane October 14, 1986
Signature Date

Certificate ready for filing: [Signature] 3-9-87
District Ranger Date

U.S. PUBLIC LAND SURVEY MONUMENT RECORD

Index No. A-25

State of Wisconsin }
County of Forest } ss.

I, William B. Cochrane, do hereby certify that on the 30th day of July, 1986, I found evidence of the Northeast Section corner of Section 1 Township 40, North, Range 13 East, Fourth Principal Meridian, as described hereon; and that from this evidence I established a new monument and accessories as described hereon to perpetuate the original location of this corner.

Resident witnesses:

David Brownell
.....
.....

History of original corner establishment:

Original Government Survey in 1858 by Alfred Millard. Dependent Resurvey in 1945 by Hugh B. Crawford. North between Sections 1 and 6, 40.89 chains, intersect the Fourth Standard Parallel North. Set a concrete monument, 2 feet long, 6 inches dia., 18 inches in the ground, with an iron post in center, and a brass cap mkd; T41N, R14E, S31, S1, S6, R13E, R14E, T40N, CC, 1945. From which the following bear;

Poplar	4"	S54°45'E	48 lks. (31.68 feet)
Elm	12"	S10°15'W	129½ lks. (85.47 feet)

Description of corner evidence found:

Found monument as described and in place, from which the following bear;

Aspen (Stump)	S54°45'E	31.68 feet
Elm (Stump)	S10°15'W	85.47 feet

Description of monument and accessories I established to perpetuate the original location of this corner.

No Bearing Trees Available.

Steel Sign Post North 1.00 feet

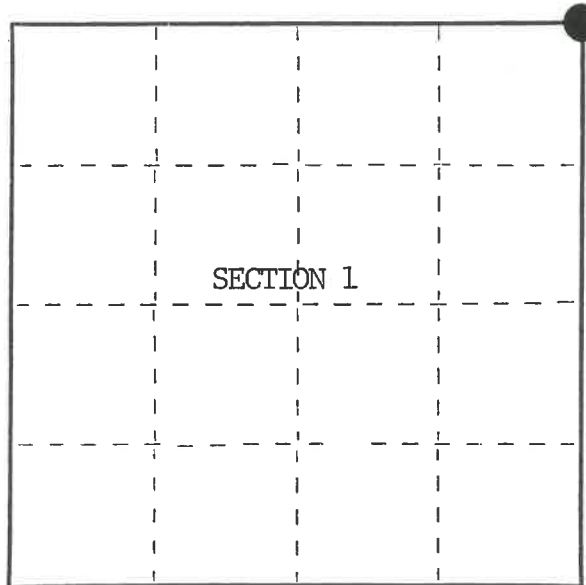

○ = Corner monument restored.

Dated at Hiles, Wis., this 25th day of September, 1986.

Signature William B. Cochrane Title Land Surveyor Registration No. S-1107
(County Surveyor, Registered Land Surveyor, or other duly authorized official)

Office of Register of Deeds, County of Forest, I hereby certify that the within instrument was filed in this office for record on the 11th day of March, 1987 at 3:30 o'clock P. M.

Paul Aschenbrenner
(Register of Deeds)

By.....Deputy

FORM NO. 985-A



Stock No. 26273

DOCUMENT NUMBER 132414

44013014000

(e) Describe any material discrepancy between the location of the corner as restored or reestablished and the location of that corner as previously restored or reestablished by distance and direction. Show the discrepancy on the plan view drawing under (d), above. Show the distances between the corner as previously restored or reestablished and (1) the corner as restored or reestablished, and (2) to at least 2 of the witness monuments shown on the drawing in (d), above.

See drawing below.

(f) Was the corner restored through acceptance of (1) an obliterated evidence location, or, (2) a found perpetuated location?

Restored through acceptance of a found perpetuated location.

(g&h) Was the corner reestablished through lost corner proportionate methods? If so, show the method, including the directions and distances to other public land survey corners used as evidence or used for proportioning in determining the corner location?

Steel Sign Post
North, 1.00 feet



Closing Township Corner

S31		T41N
S1	S6	T40N
R13E	R14E	

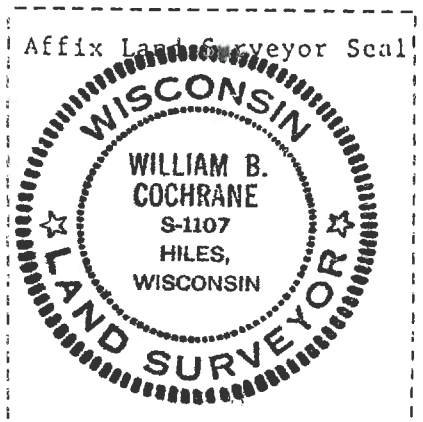

(i) I, William B. Cochrane
(type or print name) certify that the corner location shown on this record was determined by me or under my direction and control and that this U.S. Public Land Survey Monument Record is correct and complete to the best of my knowledge and belief.

William B. Cochrane
Signature

October 14, 1986
Date

Certificate ready for filing:

[Signature]
District Ranger

3-9-87
Date