

CERTIFIED LAND CORNER RESTORATION

State of Wisconsin

County of Forest

ss.

I William B. Cochrane, do hereby certify that on the 9th day of February, 1976, I found evidence of the North Quarter corner of Section 5 Township 39 North, Range 12 East, Fourth Principal Meridian, as described hereon; and that from this evidence I established a new monument and accessories as described hereon to perpetuate the original location of this corner:

Description of original monument and accessories and subsequent restorations:

Surveyed in September 1859 by Wm. E. Daugherty. Dependent resurvey in 1939 by H. D. Craig. At proportionate distance set a concrete monument, 24 ins. long, 6 ins. diam, 18 ins. in the ground with a brass cap stamped: 1/4, S5, S32, 1939 From which the following bear: Hemlock, 6", N23°15'E, 22 Lks. Hemlock, 24", S4°E, 24 Lks.

Description of corner evidence found:

Found the monument as described above in place. Hemlock, 16", N23°E, 22 Lks. Hemlock, 24" tipover, S4°E, 24 Lks.

Description of monument and accessories I established to perpetuate the location of this corner:

Blazed and scribed the following new bearing tree: Maple, 19", S40°E, 68.24 feet Set a steel sign post, SE of the monument, 0.50 feet.

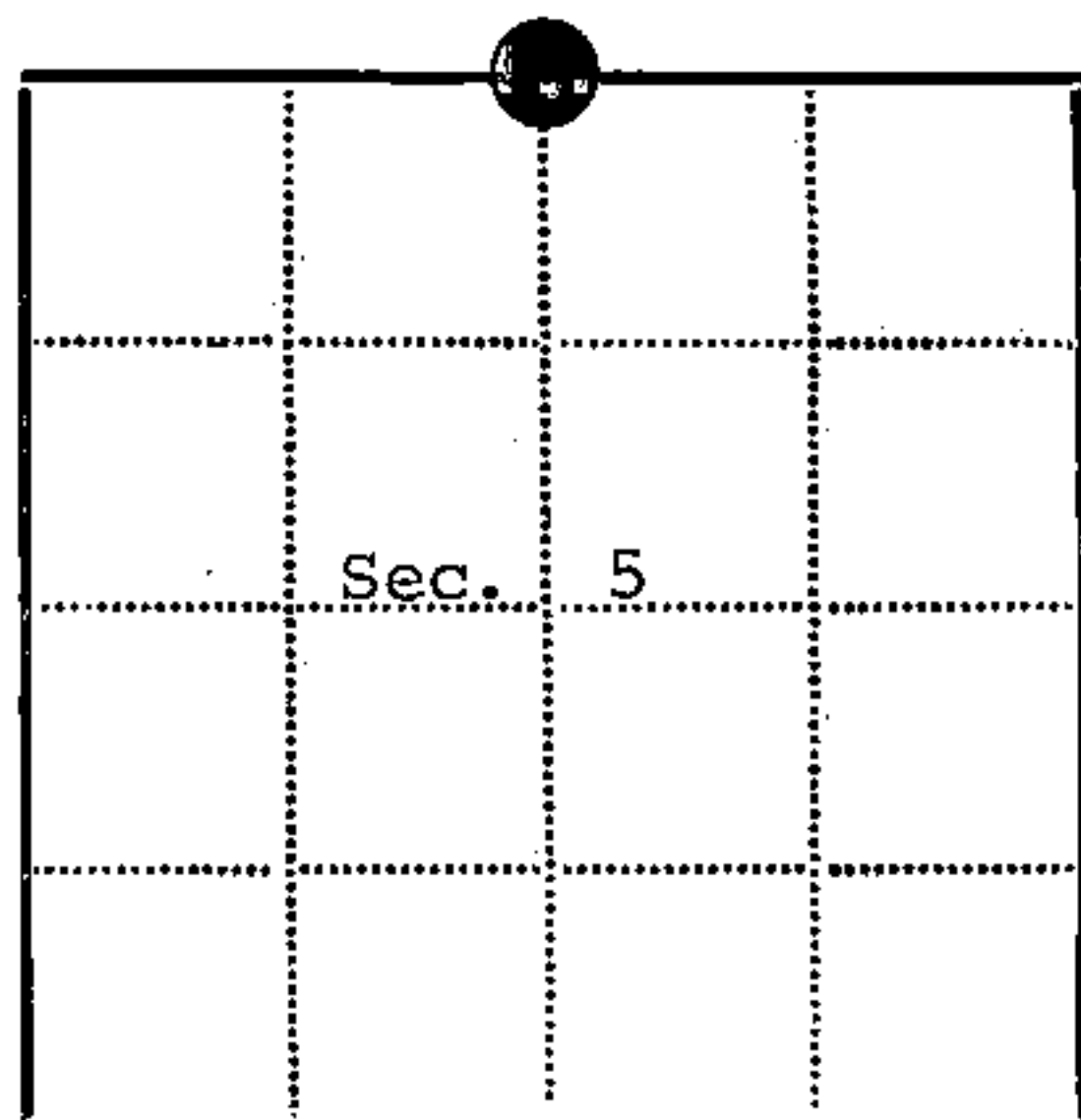

Legend: A dot in a circle = Corner monument restored. A square =

Resident witnesses

Dated at Three Lakes, Wisconsin, this 16th day of April, 1976.

Signature William B. Cochrane, Title Survey Technician (County Surveyor, Registered Land Surveyor, or other duly authorized official)

Surveyors Registration No. S-1107, DOCUMENT NUMBER 109590

Office of Register of Deeds, County of Forest

I hereby certify that the within instrument was filed in this office for record on the 2nd day of July, 1976, and was filed in Book No. of County Records.

Signature Eugene Staszny, Title Register of Deeds

Township 39 North, Range 12 East, Section 5, Index No. A-7, Page No.

44012 320820

CERTIFIED LAND CORNER RESTORATION

State of Wisconsin }  
County of Forest } ss.

I, William B. Cochrane, do hereby certify that on the 11th day of May, 1982, I found evidence of the North Quarter corner of Section 5 Township 39 North, Range 12 East, Fourth Principal Meridian, as described hereon; and that from this evidence I established a new monument and accessories as described hereon to perpetuate the original location of this corner:

Description of original monument and accessories and subsequent restorations:

Surveyed in September, 1859, by Wm. E. Daugherty  
Dependent resurvey in 1939 by H. D. Craig  
At proportionate distance, set a concrete monument, 24" long, 6" in diameter, 18" in the ground, with a brass cap stamped 1/4, S5, S32, 1939  
Hemlock, 6", N23°15'E, 22 lks.  
Hemlock, 24", S4E, 24 lks.  
Corner restoration 2/9/76 by Wm. B. Cochrane  
Blazed and scribed Maple, 19", S40E, 68.24 ft.

Description of corner evidence found:

Found the monument as described above in place  
Hemlock, 18", N23°15'E, 22 lks.  
Hemlock, (tip-out) S4E, 24 lks.  
Maple, 22", S40E, 68.24 ft.

Description of monument and accessories I established to perpetuate the location of this corner:

Blazed and scribed the following new bearing tree:  
Maple, 17", S58E, 102.95 ft.  
Set a steel sign post SE of the monument, 0.75 ft.

DOCUMENT NO.  
**124409**

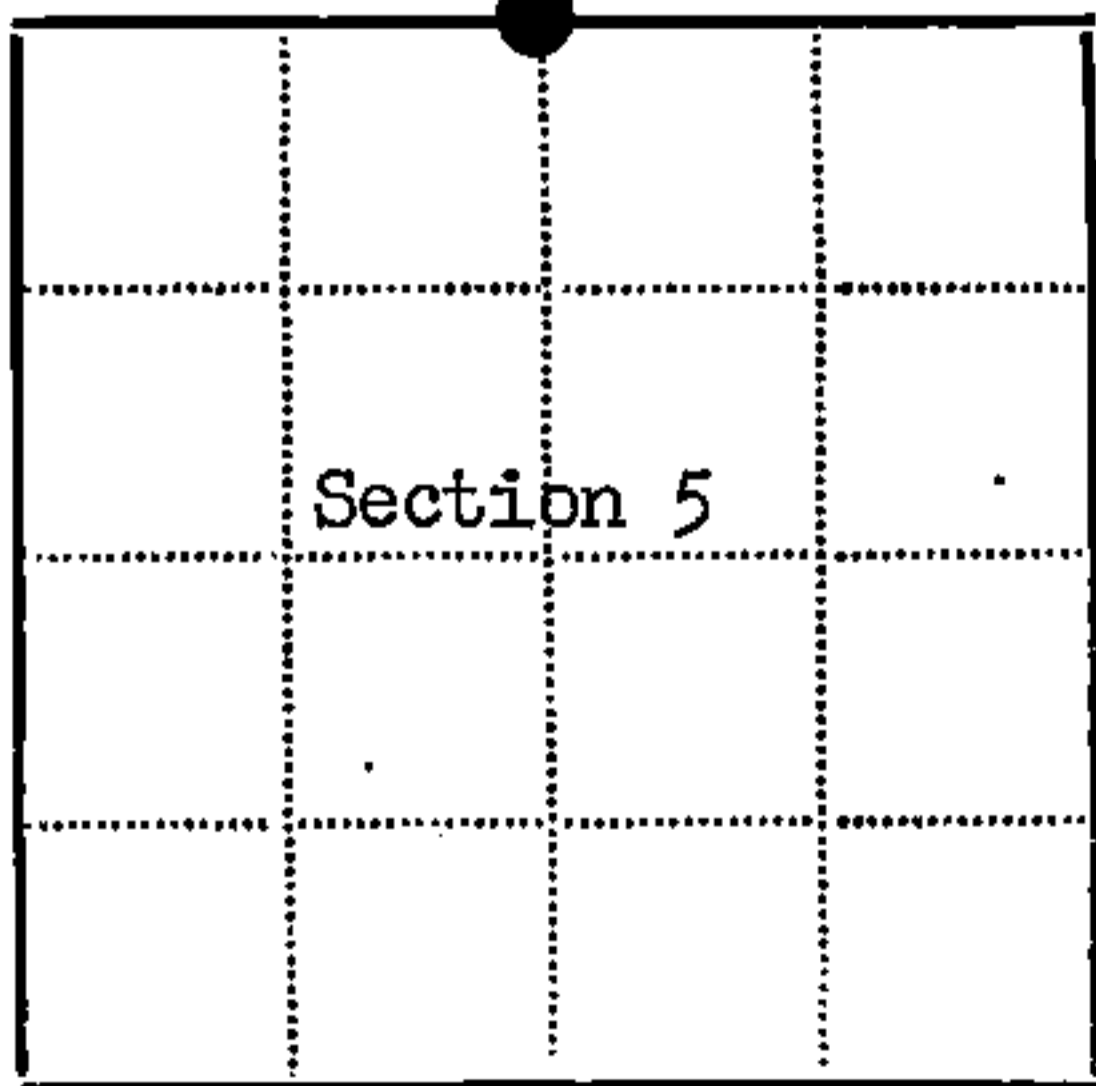
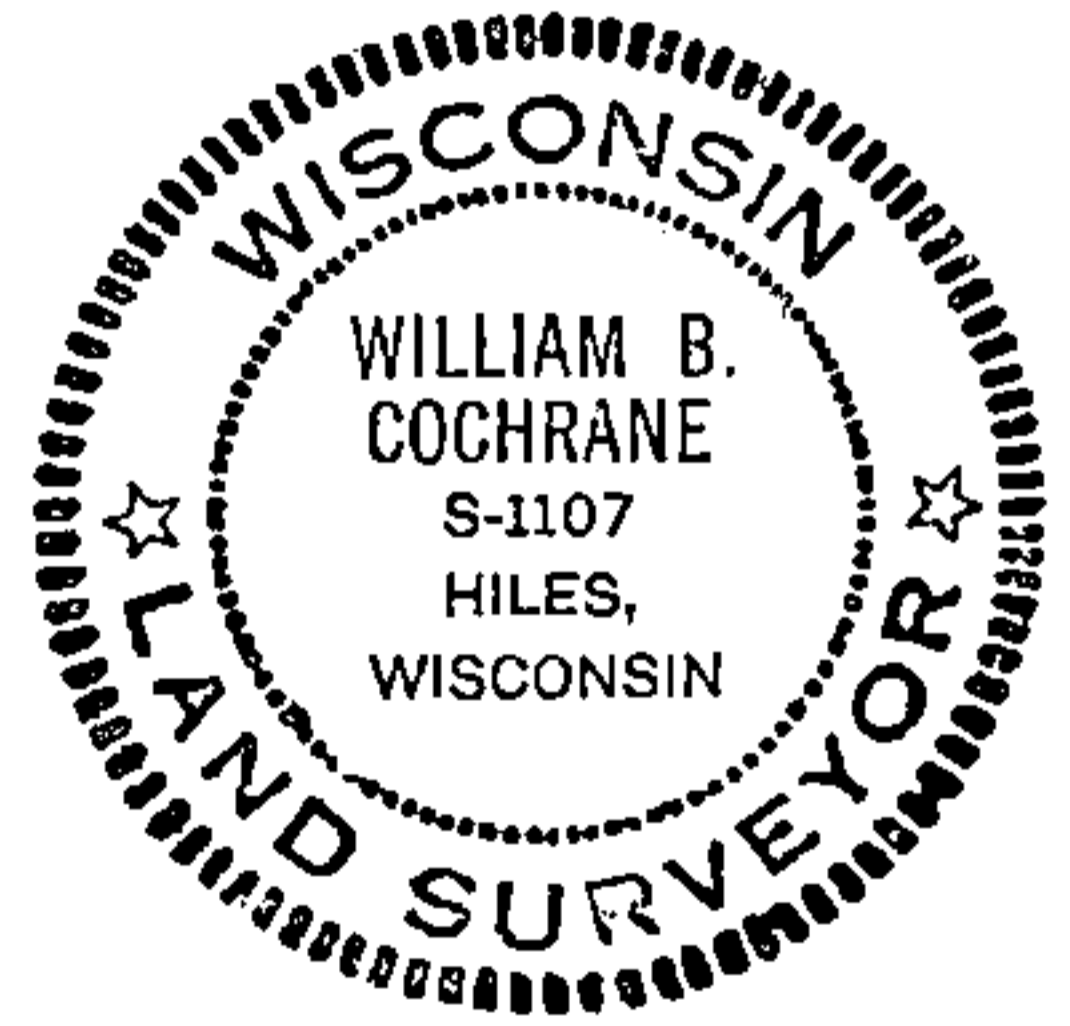

● - Corner monument restored  
□ -

Resident witnesses.....

Dated at Hiles, Wisconsin, this 20th day of July, 1982.

Signature William B. Cochrane Title Land Surveyor  
(County Surveyor, Registered Land Surveyor, or other duly authorized official)

Surveyors Registration No. S-1107

Office of Register of Deeds County of Forest

I hereby certify that the within instrument was filed in this office for record on the 7th day of October, 1983, and was filed in Book No. .... Page No. .... of County Records.

Signature Eugene Stategoy Title Register of Deeds

Township 39 North, Range 12 East, Section 5, Index No. A-7, Page No. ....

44012320020