

U.S. PUBLIC LAND SURVEY MONUMENT RECORD

Index No. V-5

State of Wisconsin }
 County of Forest } ss.

I, John H. Fisher, do hereby certify that on the 14 day of May, 1984, I found evidence of the Northeast corner of Section 31 Township 40, North, Range 12 East, Fourth Principal Meridian, as described hereon; and that from this evidence I established a new monument and accessories as described hereon to perpetuate the original location of this corner.

Resident witnesses:

None

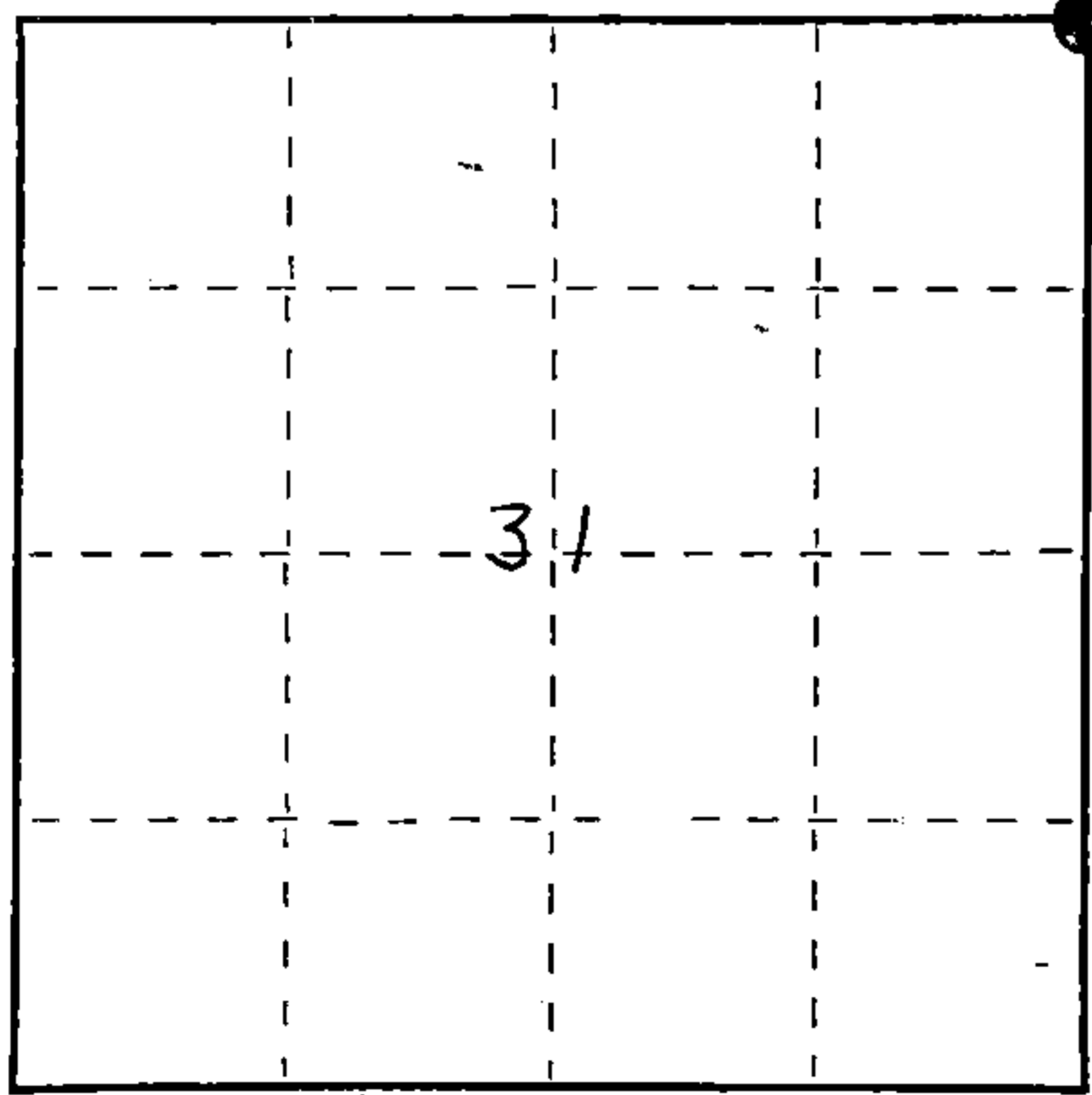

○ = Corner monument restored.

History of original corner establishment: Original survey in 1859 by William E. Dauherty. Dependent Resurvey in 1941 by Guy R. Veal; at 80.65 chains set a concrete monument 24" long, 6 ins. Diameter, 18 ins. in ground with an iron post, 22 ins. long, 1 in. Diameter embedded in top, with brass tablet stamped.

T40N	R12E	From which the following bear;		
S 30	S 29	Spruce	16"	N50-3/4°E 124 lks.
S 31	S 32	Spruce	16"	S44-3/4°E 72 lks.
		Maple	10"	S68°W 79 lks.
1941		White Birch	6"	N46-1/4°W 44 lks.

Description of corner evidence found:

B.L.M. monument as described and in place; and the following bearing trees

White Birch	9"	N44°W	29.2 feet
Sugar Maple	14"	S73°W	52.21 feet

Description of monument and accessories I established to perpetuate the original location of this corner.

Corner in good condition.

Set nail in:

Sugar Maple	8"	N 1°E	17.17 feet
Sugar Maple	8"	N51°E	20.97 feet

Set Steel Sign Post

West 0.8 feet

Dated at Minocqua, Wis., this 22nd day of January, 1985

Signature John H. Fisher Title Registered Land Surveyor Registration No. S-836
 (County Surveyor, Registered Land Surveyor, or other duly authorized official)

Office of Register of Deeds, County of Forest, I hereby certify that the within instrument was filed in this office for record on the 24th day of April, 1985 at 1:00 o'clock P. M.

Paul Aschenbrenner
 (Register of Deeds)

By.....Deputy

FORM NO. 985-A
 H.C. Miller Company
 MINNEAPOLIS, MINN.

Stock No: 26273

Document Number 127880

44012 300000

(e) Describe any material discrepancy between the location of the corner as restored or reestablished and the location of that corner as previously restored or reestablished by distance and direction. Show the discrepancy on the plan view drawing under (d), above. Show the distances between the corner as previously restored or reestablished and (1) the corner as restored or reestablished, and (2) to at least 2 of the witness monuments shown on the drawing in (d), above.

See drawing below

(f) Was the corner restored through acceptance of (1) an obliterated evidence location, or, (2) a found perpetuated location?

Found perpetuated location

(g&h) Was the corner reestablished through lost corner proportionate methods? If so, show the method, including the directions and distances to other public land survey corners used as evidence or used for proportioning in determining the corner location?

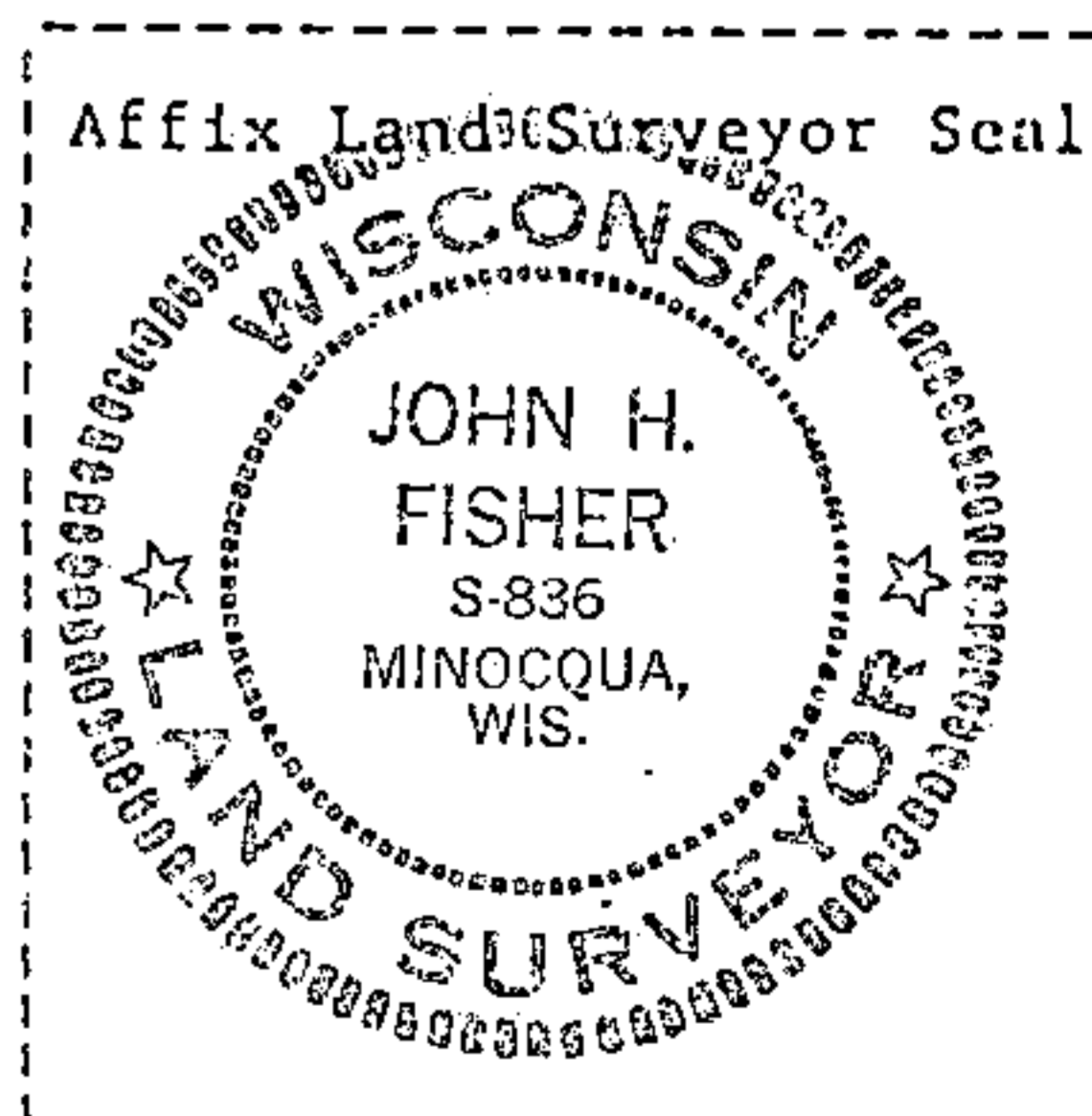
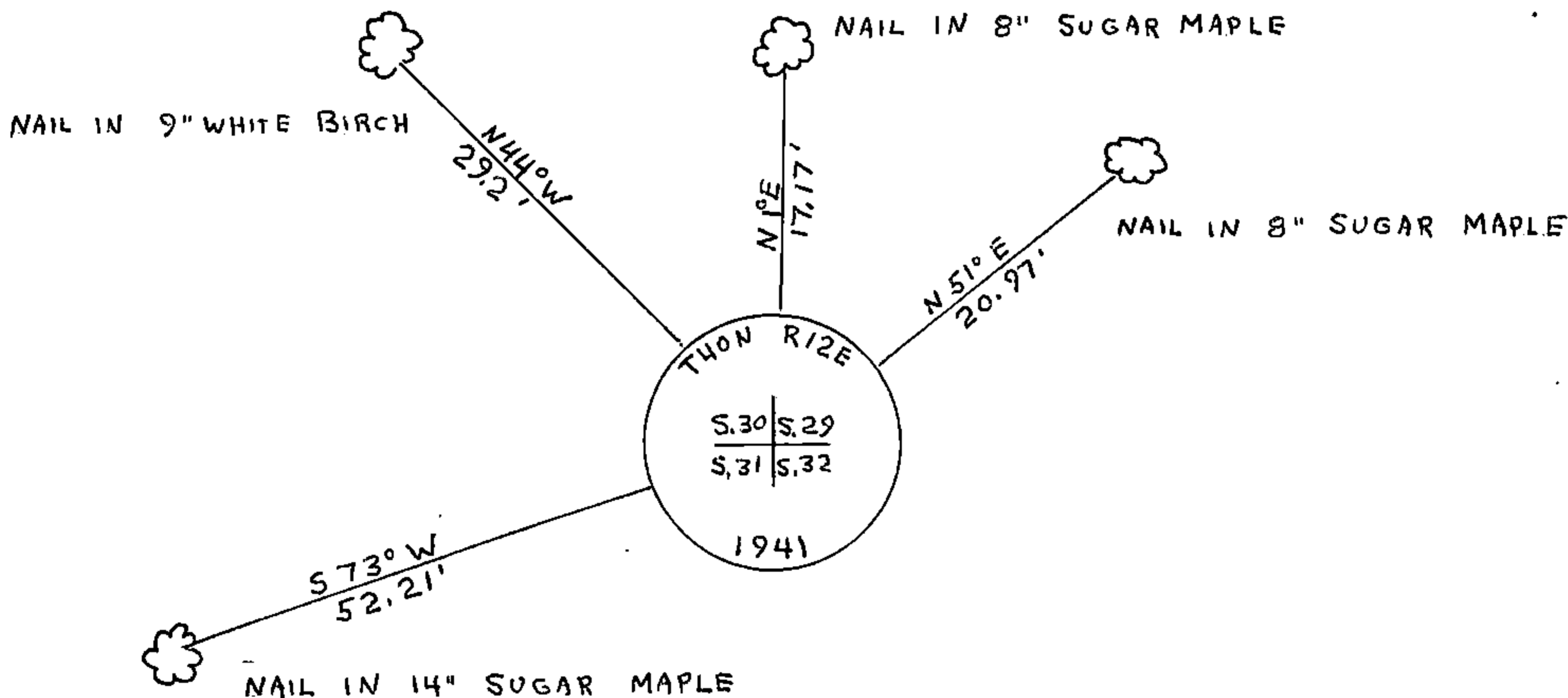

(i) I, John H. Fisher
 (type or print name) certify that the corner location shown on this record was determined by me or under my direction and control and that this U.S. Public Land Survey Monument Record is correct and complete to the best of my knowledge and belief.

John H. Fisher
 Signature

1/22/85
 Date