

CERTIFIED LAND CORNER RESTORATION

State of Wisconsin }
County of Forest } ss.

I Jean F. Resvick, do hereby certify that on the 1st day of June, 1973, I found evidence of the North quarter corner of Section 19 Township 40 North, Range 12 East, Fourth Principal Meridian, as described hereon; and that from this evidence I established a new ~~monument~~ accessories as described hereon to perpetuate the ~~original~~ location of this corner:

Description of original monument and accessories and subsequent restorations:

Surveyed in 1859 by William E. Daugherty
Dependent Resurvey in 1941 by Guy R. Veal
At proportionate distance set an iron post, 3 feet long, 2 inches in diameter, with brass cap marked 1/4, S18, S19, 1941
Poplar 6, bears S62W, 32 lks.
Yellow Birch 22, bears N26W, 86 lks.

Description of corner evidence found:

Monument as described above
Yellow Birch stump bears N26W, 86 lks.

Description of ~~monument~~ accessories I established to perpetuate the location of this corner:

Blazed and scribed the following new bearing trees:
Balsam 7, N28W, 10.32 feet
Spruce 6, S77E, 13.23 feet
Set galvanized sign post 1 foot southwest of monument

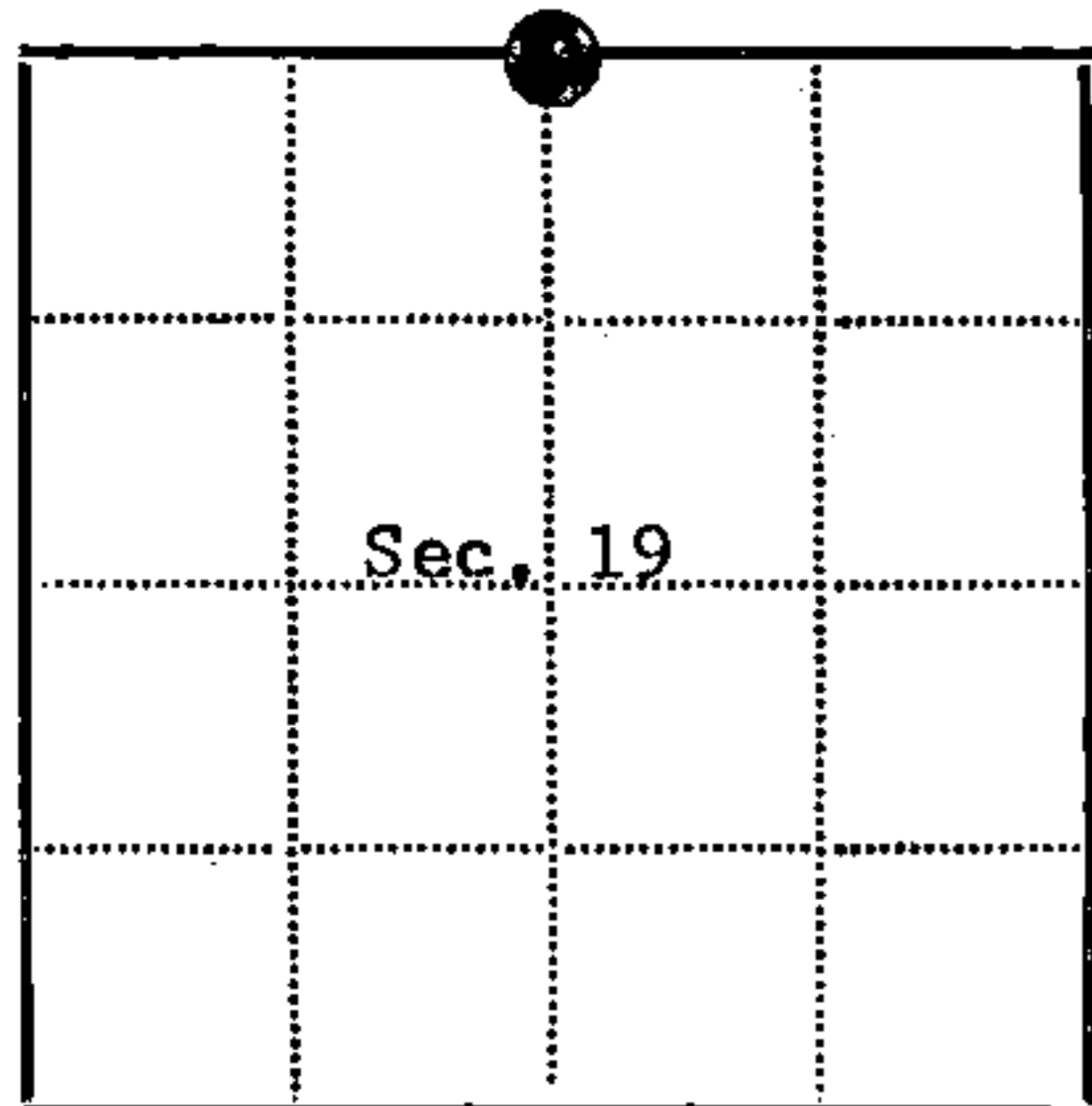

● = Corner monument restored
□ =

Resident witnesses _____

Dated at Rhinelander Wisconsin, this 27th day of June 1973.

Signature *Jean F. Resvick* Title: Land Surveyor
(County Surveyor, Registered Land Surveyor, or other duly authorized official)

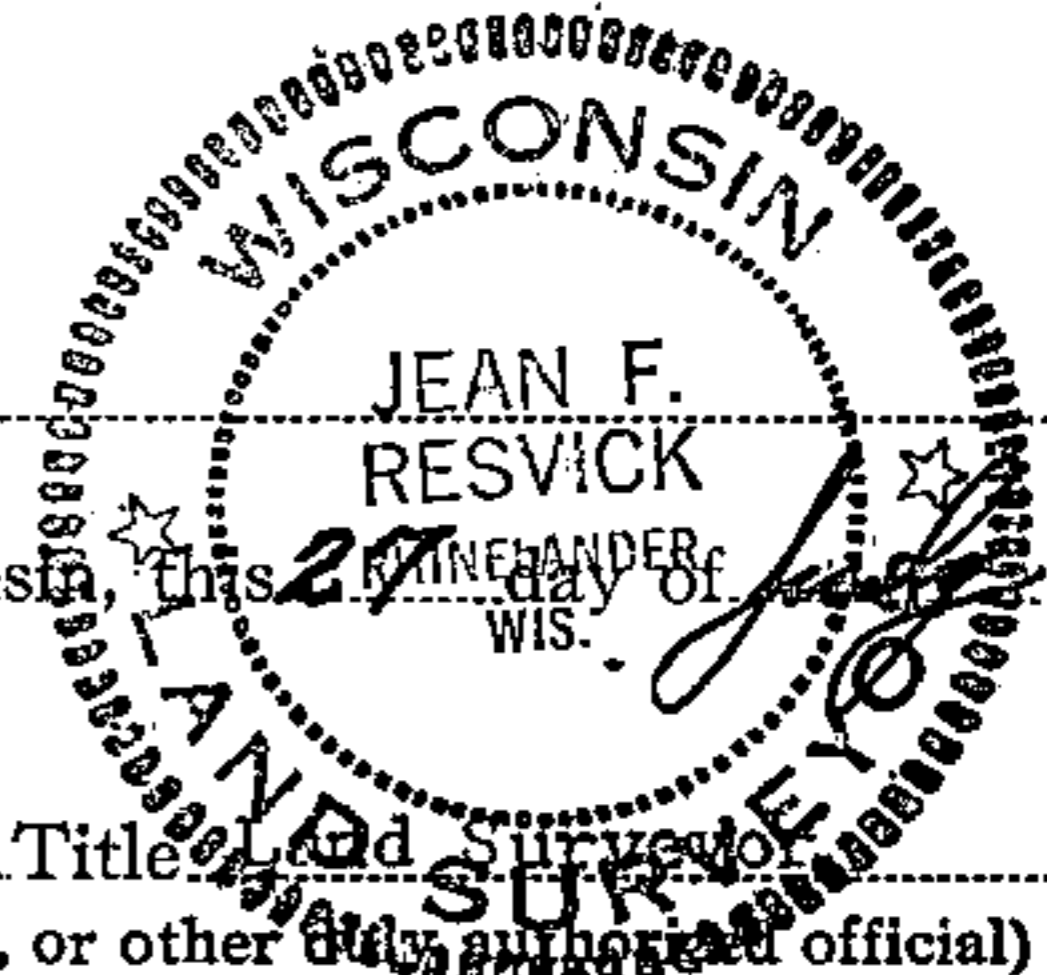

Surveyors Registration No. S-802 DOCUMENT NUMBER 104452

Office of Register of Deeds County of Forest

I hereby certify that the within instrument was filed in this office for record on the 13th day of November 1973, and was filed in Book No. _____ Page No. N-3 of County Records.

Signature *Eugene K. Stutzman* Title Register of Deeds

Township 40 North, Range 12 East, Section 19, Index No. N-3, Page No. _____

44012180020

N
3