

## CERTIFIED LAND CORNER RESTORATION

State of Wisconsin

County of Forest

ss.

I, Jean F. Resvick, do hereby certify that on the 3rd day of November, 19 71,  
I found evidence of the Northwest Section corner of Section 20  
Township 40 North, Range 12 East, Fourth Principal Meridian, as described  
hereon; and that from this evidence I established a new monument and accessories as described hereon to per-  
petuate the original location of this corner:

## Description of original monument and accessories and subsequent restorations:

Dependent Resurvey by Guy R. Veal in 1941. Proportionate location.

Set concrete monument, 2 feet long, 6 inches in diameter, with iron post  
1 inch in diameter, 22 inches long encased therein, with brass cap stamped.

T40N, R12E, S18, S17, S19, S20 1941

Poplar 8, N41E, 31 lks.

Poplar 6, S32E, 24 lks.

Poplar 5, S42°30'W, 35 lks.

Poplar 7, N66°30'W, 14 lks.

## Description of corner evidence found:

6 inch diameter concrete monument with brass cap stamped as above.

Aspen stump 8, N41E, 20.5 feet

Aspen stump 6, S32E, 15.8 feet

Aspen stump 6, S42W, 23.1 feet

Aspen stump 7, N66W, 9.2 feet

## Description of monument and accessories I established to perpetuate the original location of this corner:

Blazed and scribed the following new bearing trees.

Black Spruce 6, N10W, 24.48 feet

White Spruce 12, S75E, 23.79 feet

White Spruce 15, S 8E, 4.33 feet

White Spruce 10, N33W, 37.43 feet

Set steel sign post near monument.

44012180000

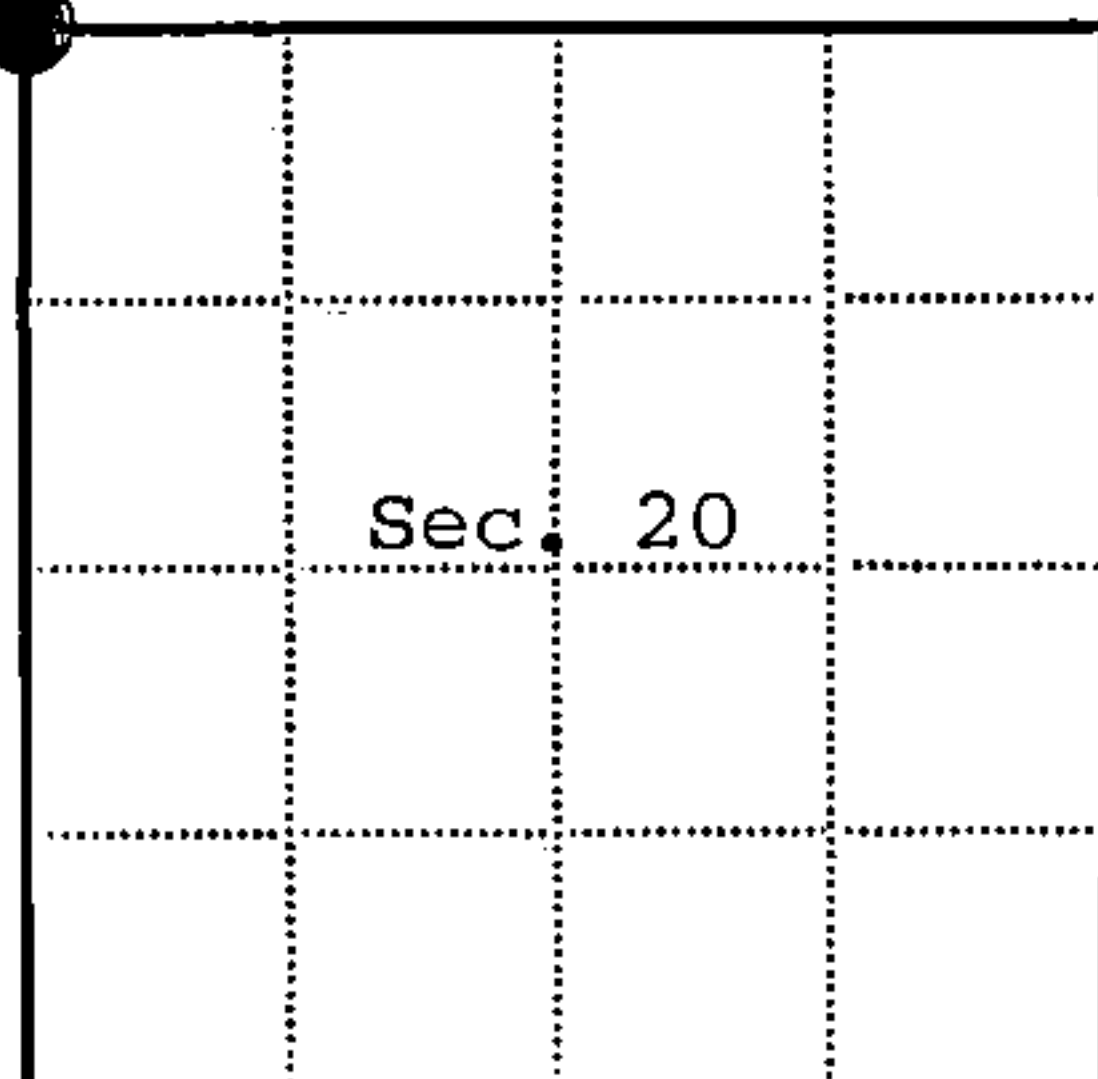

● = Corner monument restored

□ =

Resident witnesses.....

Dated at Rhineland Wisconsin, this 22nd day of Nov.  
19 71Signature Jean F. Resvick Title Land Surveyor  
(County Surveyor, Registered Land Surveyor, or other duly authorized official)Surveyors Registration No. S-802 DOCUMENT NUMBER 101028Office of Register of Deeds County of ForestI hereby certify that the within instrument was filed in this office for record  
on the 20th day of January 19 72, and was filed in Book  
No. \_\_\_\_\_ Page No. N-5 of County Records.

Signature \_\_\_\_\_ Title \_\_\_\_\_

Township 40 North, Range 12 East, Section 20, Index No. N-5, Page No. \_\_\_\_\_