

U.S. PUBLIC LAND SURVEY MONUMENT RECORD

Index No. N-21

State of Wisconsin }
 County of Forest } ss.

I, Robert H. Winat, do hereby certify that on the 3 day of SEPTEMBER, 1984, I found evidence of the Section corner of 13, 14, 23, 24 Township 40, North, Range 12 East, Fourth Principal Meridian, as described hereon; and that from this evidence I established ~~a new monument and~~ accessories as described hereon to perpetuate the original location of this corner.

Resident witnesses:

Robert H. Winat

Michael G. Stevens

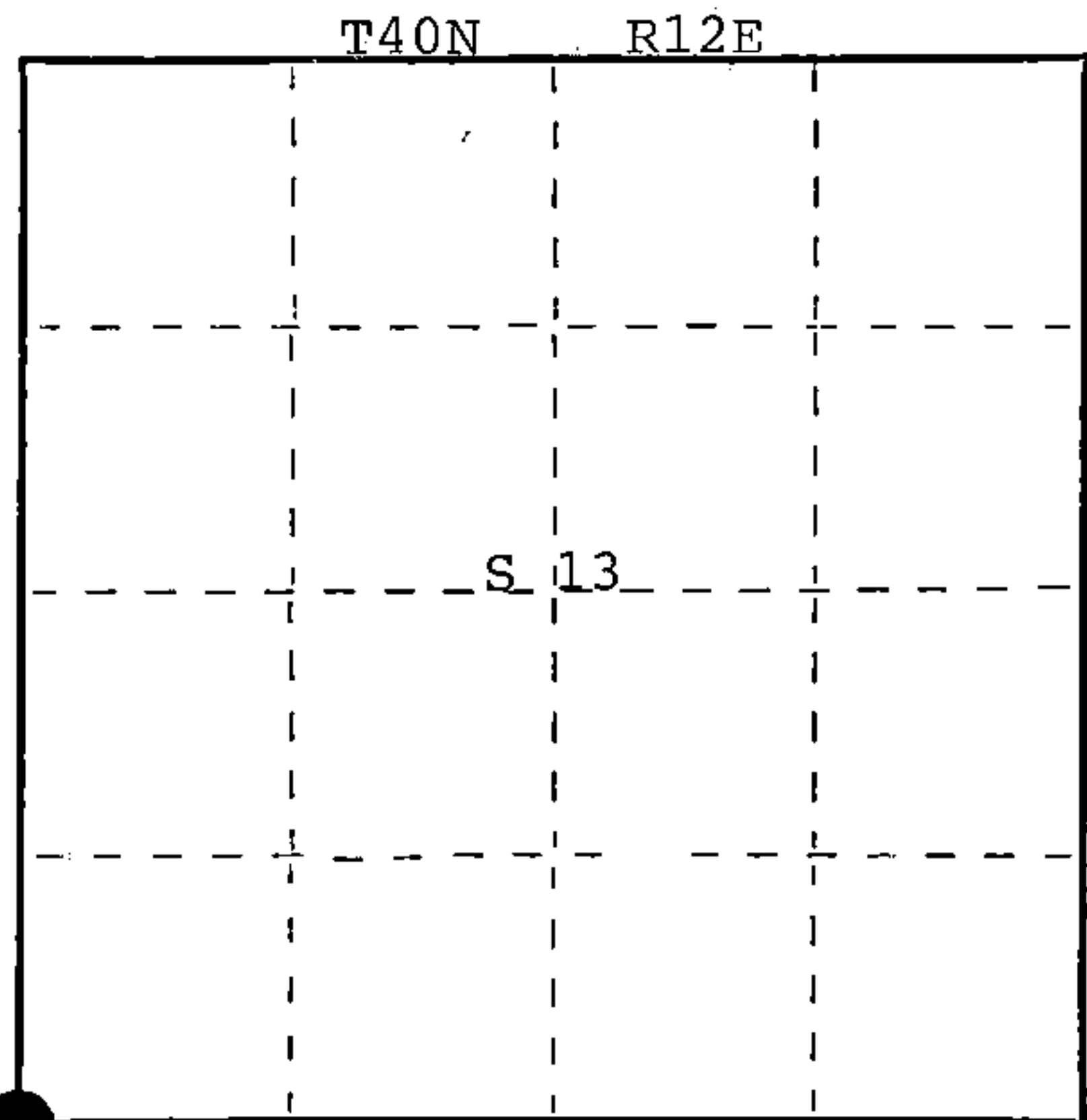

● = Corner monument restored.

History of original corner establishment:

1859-Wm. Daugherty, Deputy Surveyor, set wood post.
 BT's 8" Tamarack S35°W 13 lks. (8.58 ft.)
 9" Tamarack N10°E 12 lks. (7.92 ft.)

1941-G.L.O., corner set at proportionate distance. No remaining evidence of post or BT's. New BT's as follows:

10" Spruce N76°15'E 41 lks. (27.06 ft.)
 12" Cedar S87°E 70 lks. (46.20 ft.)
 6" Cedar S68°15'W 84 lks. (55.44 ft.)
 11" Cedar N72°30'W 38 lks. (25.08 ft.)

Description of corner evidence found: Set a 2"x36" brass capped iron pipe 27" in the ground, stamped to identify corner.

1984-North Country Surveyors found 2" brass capped iron pipe. Stamped to identify corner.

5" Cedar (in very poor condition) S63°30'W 55.58 ft.
 16" Cedar S10°E 56.73 ft.
 18" Spruce S73°W 53.18 ft.

Description of monument and accessories I established to perpetuate the original location of this corner.

New bearing trees

6" Balsam Fir N53°30'W 16.51 ft.
 12" Ash N19°E 33.25 ft.
 Sign Post, Steel Easterly 1.7 ft.

All BT's were brought up to standard by placing a nail in side, placing new BT signs on side facing corner and away-painted red ring on trees.

(OVER)

Dated at EAGLE RIVER, Wis., this 6 day of NOVEMBER, 1984

Signature Robert H. Winat Title L.S. Registration No. 1060
 (County Surveyor, Registered Land Surveyor, or other duly authorized official)

Office of Register of Deeds, County of Forest, I hereby certify that the within instrument was filed in this office for record on the 24th day of July, 1985 at 1:10 o'clock P. M.

Paul Aschenbrenner
 (Register of Deeds)

By.....Deputy

FORM NO. 985-A

J.C. Miller Company

Stock No. 26273

128449

DOCUMENT NUMBER

44012140000

(e) Describe any material discrepancy between the location of the corner as restored or reestablished and the location of that corner as previously restored or reestablished by distance and direction. Show the discrepancy on the plan view drawing under (d), above. Show the distances between the corner as previously restored or reestablished and (1) the corner as restored or reestablished, and (2) to at least 2 of the witness monuments shown on the drawing in (d), above.

N/A

(f) Was the corner restored through acceptance of (1) an obliterated evidence location, or, (2) a found perpetuated location?

2

(g&h) Was the corner reestablished through lost corner proportionate methods? If so, show the method, including the directions and distances to other public land survey corners used as evidence or used for proportioning in determining the corner location?

N/A

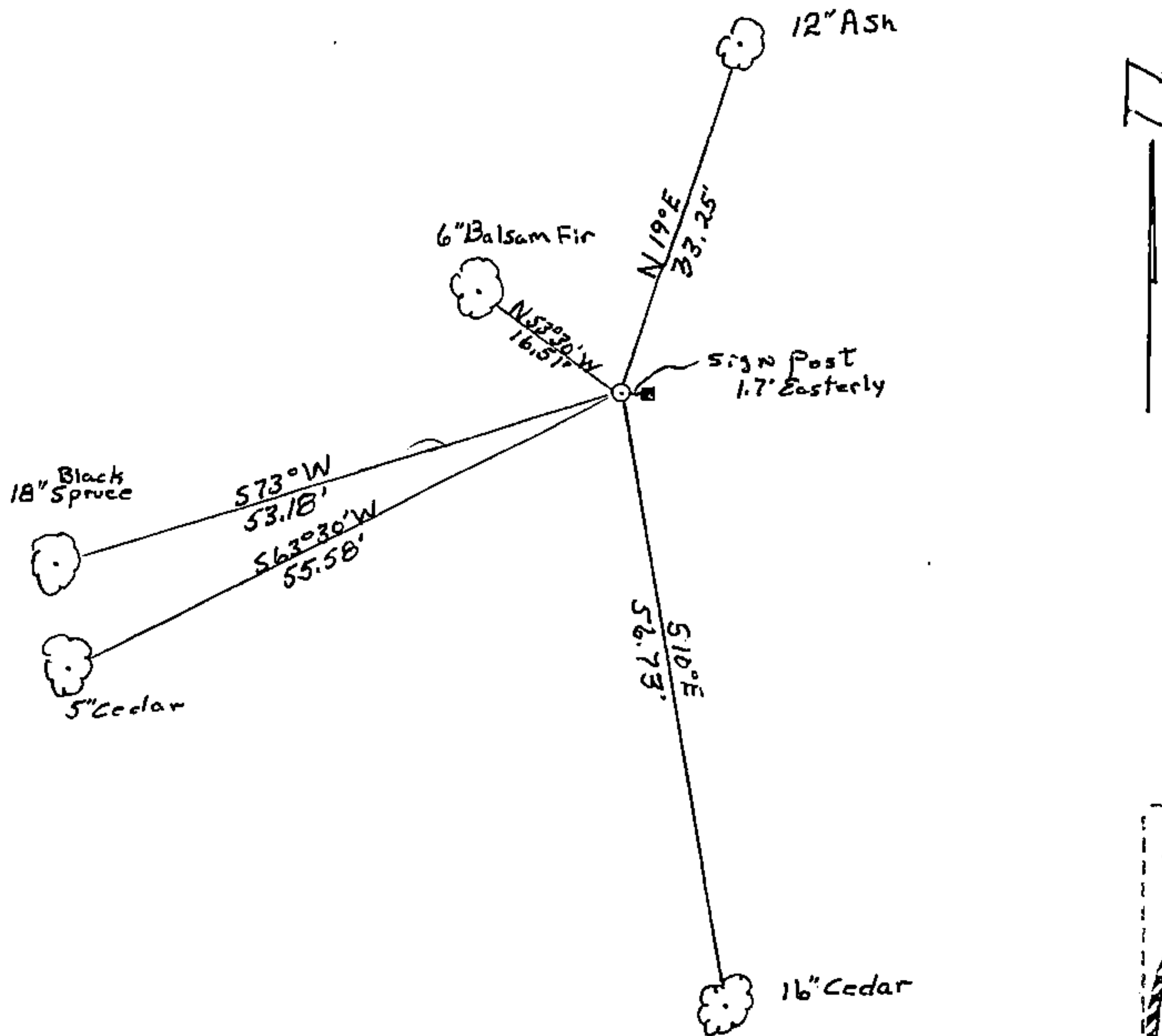

Scale 1"=20'

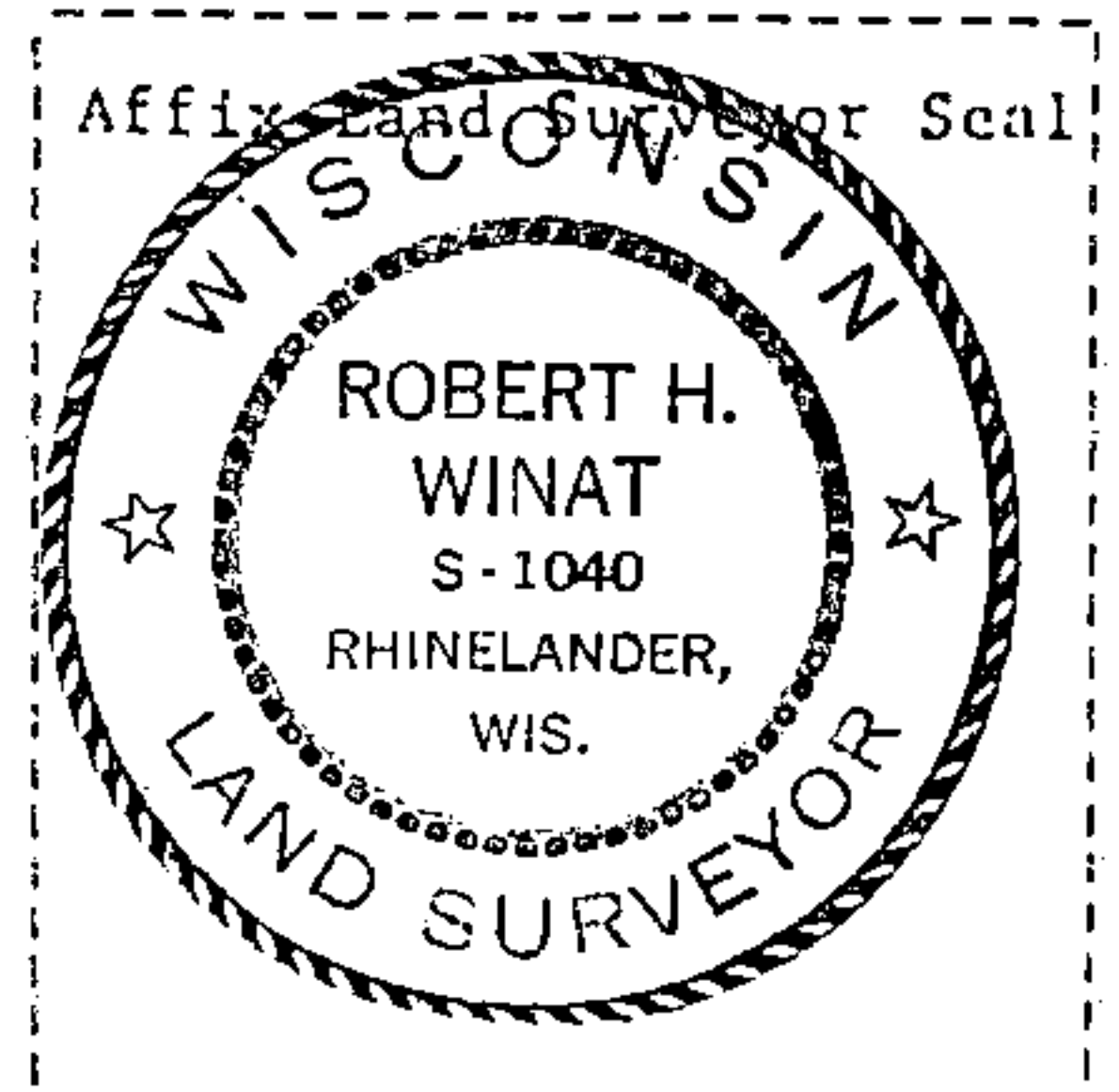

(i) I, Robert H. Winat RLS 1040
 (type or print name) certify that the corner location shown on this record was determined by me or under my direction and control and that this U.S. Public Land Survey Monument Record is correct and complete to the best of my knowledge and belief.

Robert H. Winat
 Signature

6 Nov. '84
 Date