

U.S. PUBLIC LAND SURVEY MONUMENT RECORD

Index No. L-25

State of Wisconsin }  
 County of Forest } ss.

I, Robert H. Winat, do hereby certify that on the 15 day of SEPTEMBER, 1984, I found evidence of the Quarter corner of Sections 13 & 18 Township 40, North, Range 12 East, Fourth Principal Meridian, as described hereon; and that from this evidence I established a new monument and accessories as described hereon to perpetuate the original location of this corner.

Resident witnesses:

Robert H. Winat

Michael G. Stevens

History of original corner establishment:

1858-Alfred Millard, U.S. Government Deputy Surveyor.

Set wood post between R12 & 13 E.  
 BT's 9" Sugar Maple N18°E 18 lks. (11.88 ft.)  
 11" Sugar Maple S30°W 14 lks. (9.24 ft.)

1941-G.L.O. dependent resurvey, found remains of O.B.T. Scribe visible, post not found.

5" Maple S22°30'E 19 lks. (12.54 ft.)  
 12" Hemlock N51°W 59 lks. (38.94 ft.)  
 1982-Gary Pisoni (recovered) 13" Maple S22°30'E (12.78 ft.)  
 Description of corner evidence found: 17" Hemlock N51°45'W (38.94 ft.)

1984-North Country Surveyors-R-A found G.L.O. monument set in 1941 resurvey. 6" round concrete monument & 1941 BT's.

12" Sugar Maple S30°E 12.83 ft.  
 15" Hemlock N55°30'W 38.91 ft.

Also believe I have found remains (decayed) S30°W 11.22 ft.

Description of ~~monument and~~ accessories I established to perpetuate the original location of this corner.

Old BT's brought up to standard. Nail in root crown. New BT signs. Where needed, red band painted on trees.

10" Sugar Maple S69°W 15.23 ft.  
 4" Sugar Maple N27°E 7.92 ft.  
 Sign Post S80°E 1.1 ft.

(over)

Dated at EAGLE RIVER, Wis., this 6 day of NOVEMBER, 1984

Signature Robert H. Winat Title L.S. Registration No. 1060  
 (County Surveyor, Registered Land Surveyor, or other duly authorized official)

Office of Register of Deeds, County of Forest, I hereby certify that the within instrument was filed in this office for record on the 24th day of July, 1985 at 1:10 o'clock P. M.

Paul Aschenbrenner  
 (Register of Deeds)

By.....Deputy

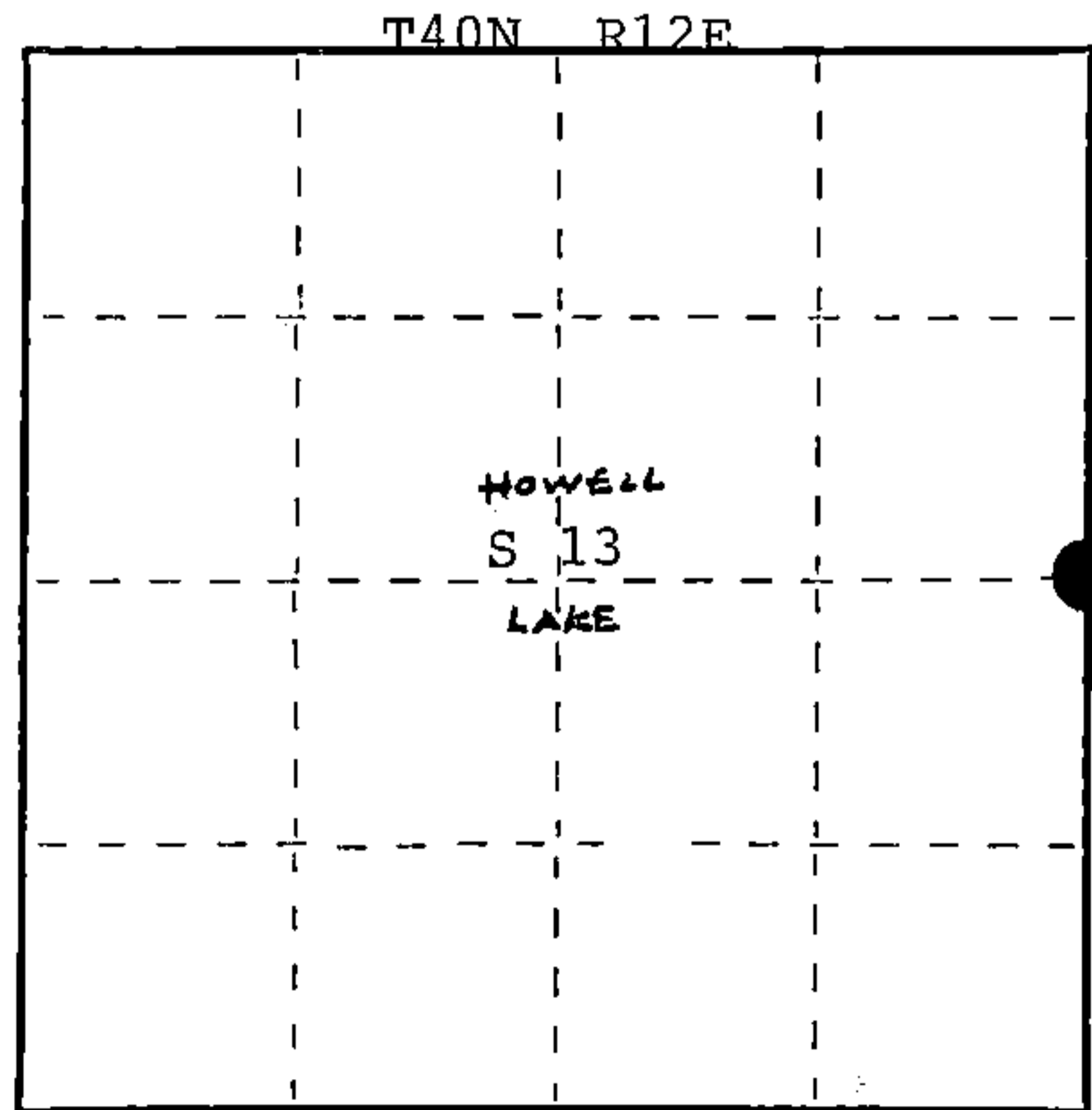

● = Corner monument restored.

FORM NO. 985-A

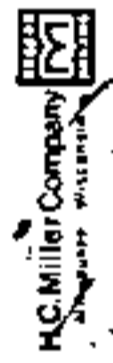

Stock No. 26273

DOCUMENT NUMBER 128448

44012132000

46-1

(e) Describe any material discrepancy between the location of the corner as restored or reestablished and the location of that corner as previously restored or reestablished by distance and direction. Show the discrepancy on the plan view drawing under (d), above. Show the distances between the corner as previously restored or reestablished and (1) the corner as restored or reestablished, and (2) to at least 2 of the witness monuments shown on the drawing in (d), above.

N/A

(f) Was the corner restored through acceptance of (1) an obliterated evidence location, or, (2) a found perpetuated location?

N/A

(g&h) Was the corner reestablished through lost corner proportionate methods? If so, show the method, including the directions and distances to other public land survey corners used as evidence or used for proportioning in determining the corner location?

N/A

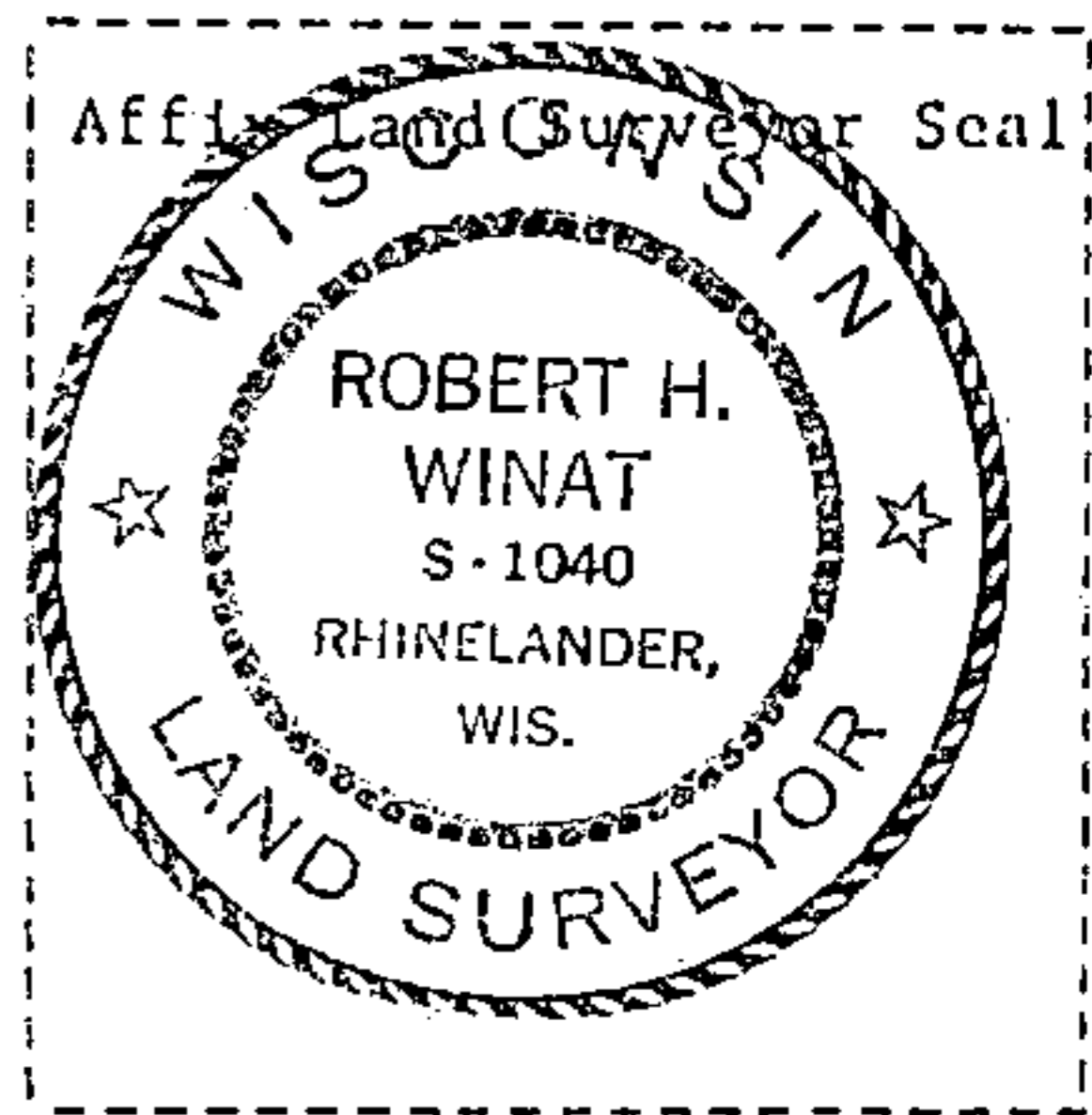
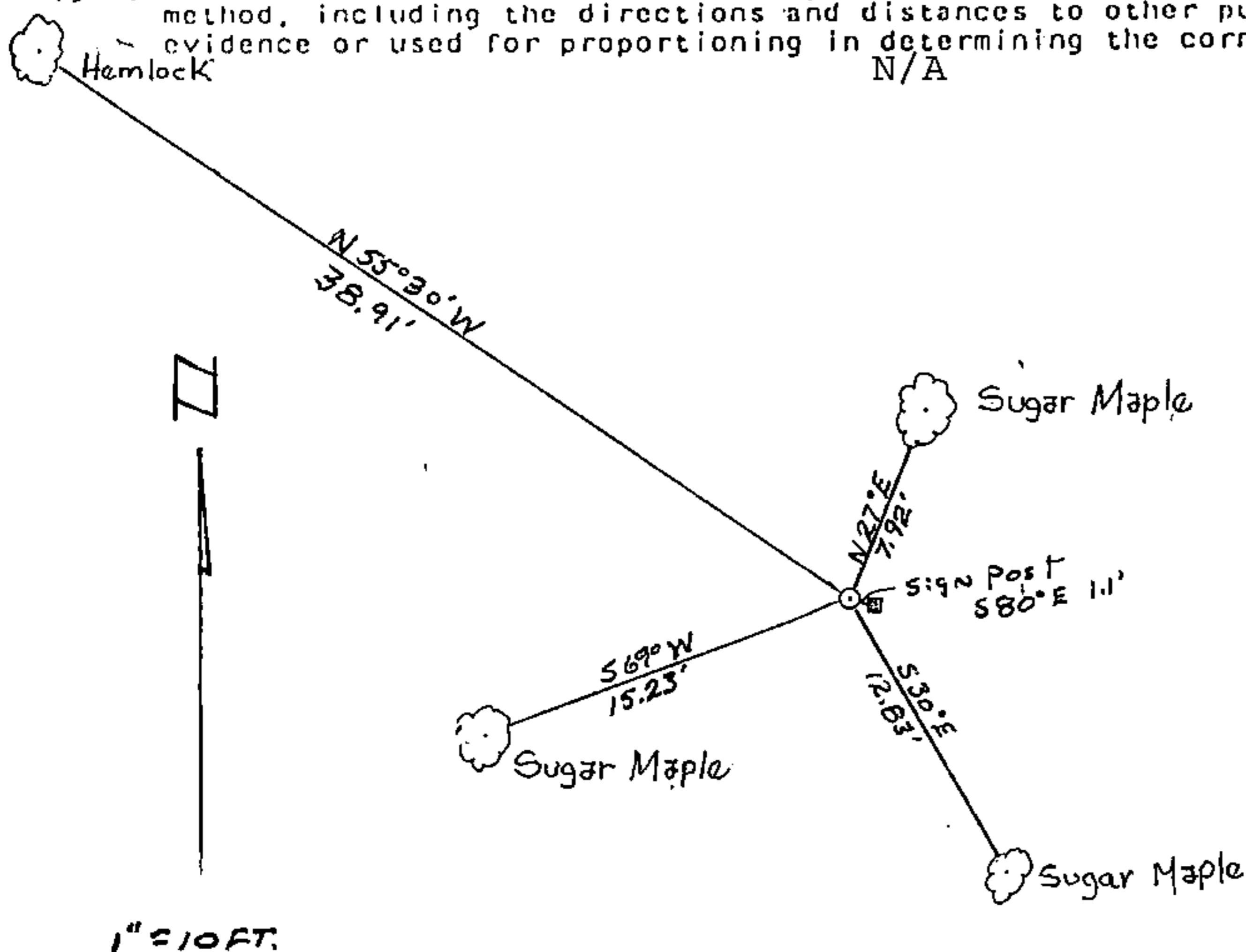

(i) I, Robert H. Winat RLS 1040  
 (type or print name) certify that the corner location shown on this record was determined by me or under my direction and control and that this U.S. Public Land Survey Monument Record is correct and complete to the best of my knowledge and belief.

Robert H. Winat  
 Signature

6 Nov. 1984  
 Date