

U.S. PUBLIC LAND SURVEY MONUMENT RECORD

Index No. J-11

State of Wisconsin }
County of Forest } ss.

I, Robert H. Winat, do hereby certify that on the 11th day of April, 1985, I found evidence of the Quarter corner of sections 9-16 Township 40, North, Range 12 East, Fourth Principal Meridian, as described hereon; and that from this evidence I established a new monument and accessories as described hereon to perpetuate the original location of this corner.

Resident witnesses:

Mike Stevens

Mike Lukasko

History of original corner establishment:
Established in 1859 by Wm. E. Daugherty. Dependent resurvey in 1941 by G.L.O., G.R. Veal, set a brass capped 2" iron pipe with the following BT's:
A fallen Spruce 5" N55°E 10 lks. (remains of original BT)
"No trees available for marking, as corner falls in open swamp."

Description of corner evidence found:
Found G.L.O. corner and possible original BT remains that match bearing and distance of Veal's.

Description of monument and accessories I established to perpetuate the original location of this corner.
Did not set any accessories as corner falls in open swamp.
Witnessed by section corners east and west.

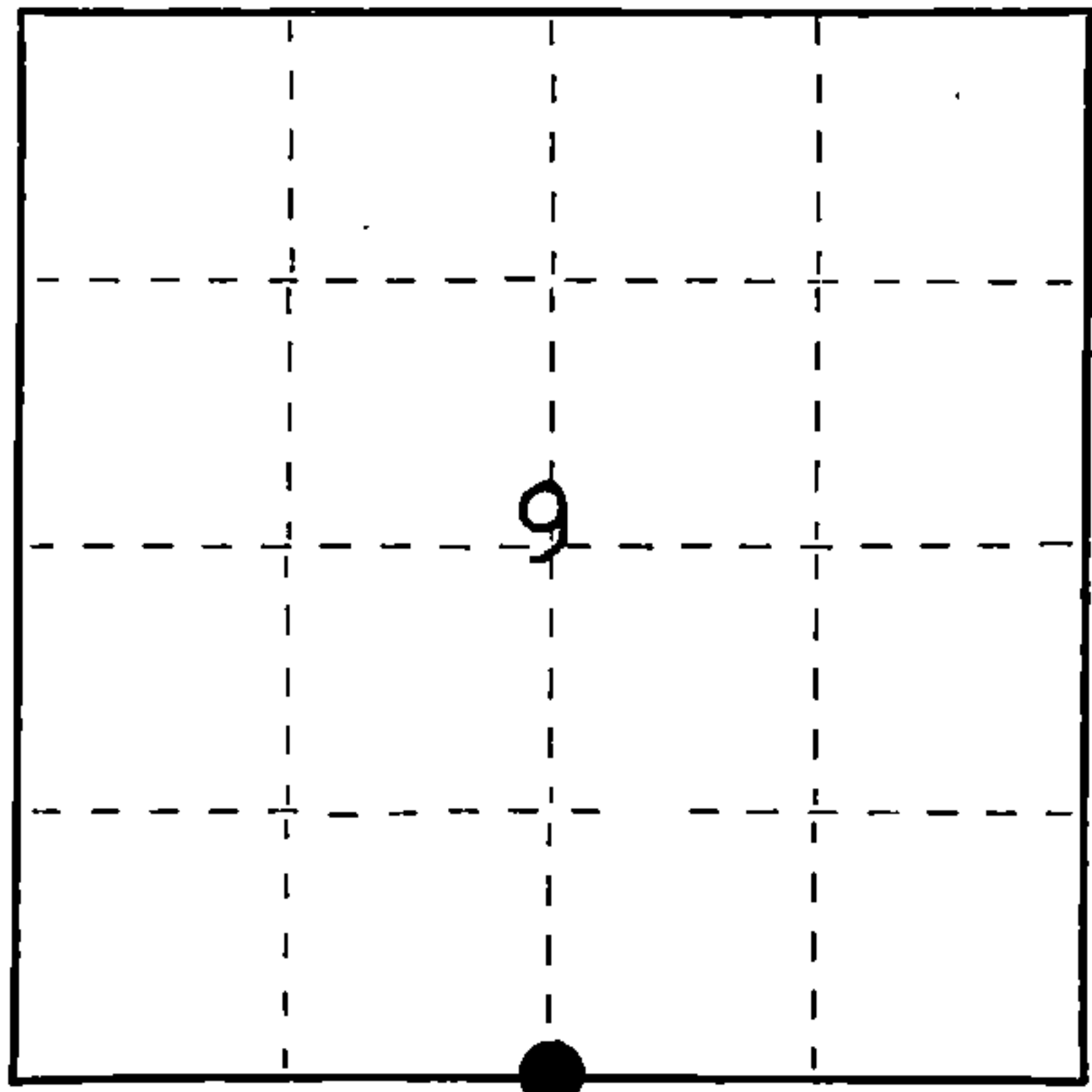

● = Corner monument restored.

(over)
Dated at Rhineland, Wis., this 4 day of June, 1985

Signature Robert H. Winat Title Land Surveyor Registration No. 1090
(County Surveyor, Registered Land Surveyor, or other duly authorized official)

Office of Register of Deeds, County of Forest, I hereby certify that the within instrument was filed in this office for record on the 24th day of July, 1985 at 1:10 o'clock P. M.

Paul Aschenbrenner
(Register of Deeds)

By.....Deputy

FORM NO. 985-A
M.C. Miller Company

Stock No. 26273

DOCUMENT NUMBER 128478

44012090020

(e) Describe any material discrepancy between the location of the corner as restored or reestablished and the location of that corner as previously restored or reestablished by distance and direction. Show the discrepancy on the plan view drawing under (d), above. Show the distances between the corner as previously restored or reestablished and (1) the corner as restored or reestablished, and (2) to at least 2 of the witness monuments shown on the drawing in (d), above.

See drawing below.

(f) Was the corner restored through acceptance of (1) an obliterated evidence location, or, (2) a found perpetuated location?

Found perpetuated location.

(g&h) Was the corner reestablished through lost corner proportionate methods? If so, show the method, including the directions and distances to other public land survey corners used as evidence or used for proportioning in determining the corner location?

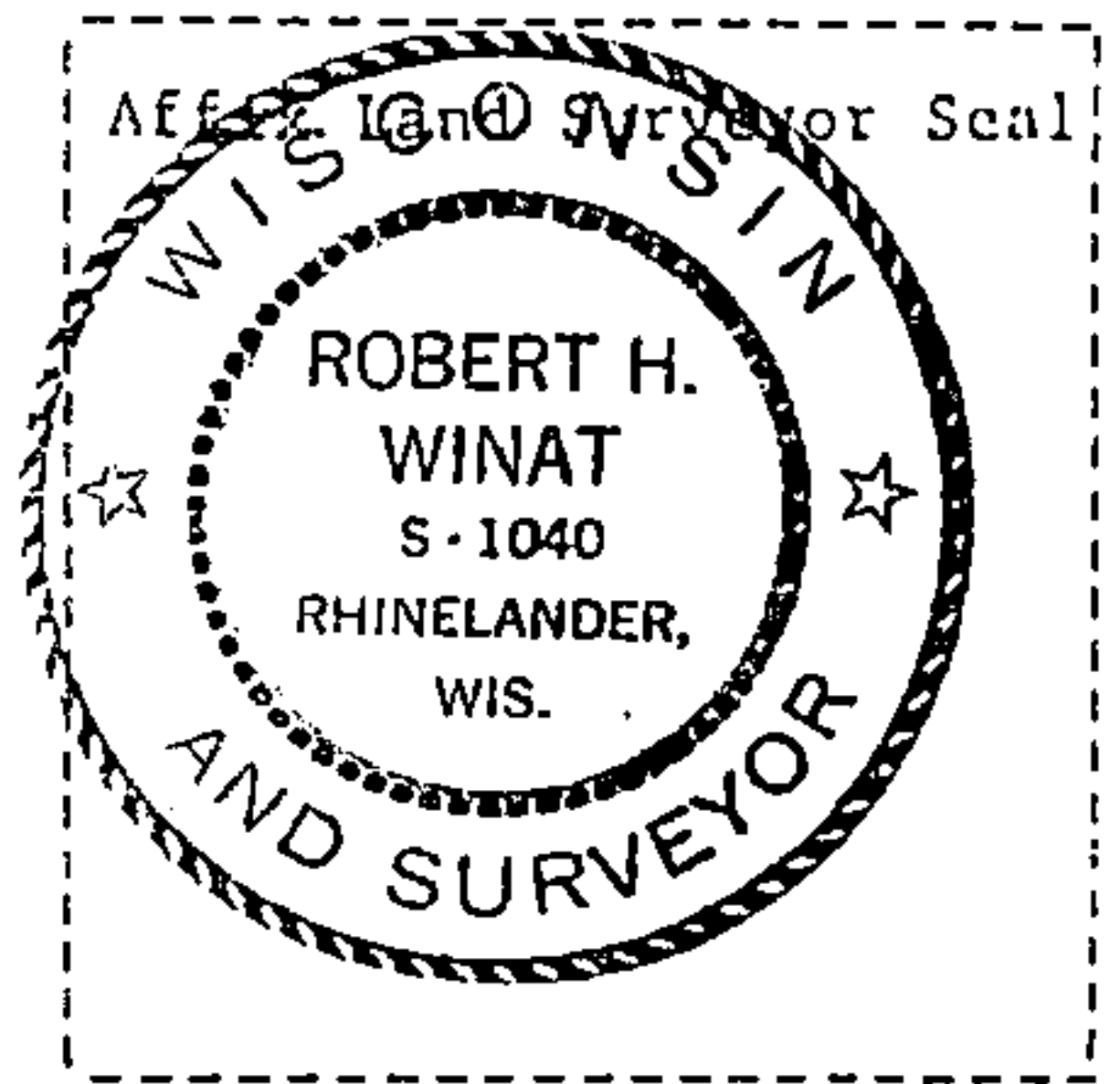
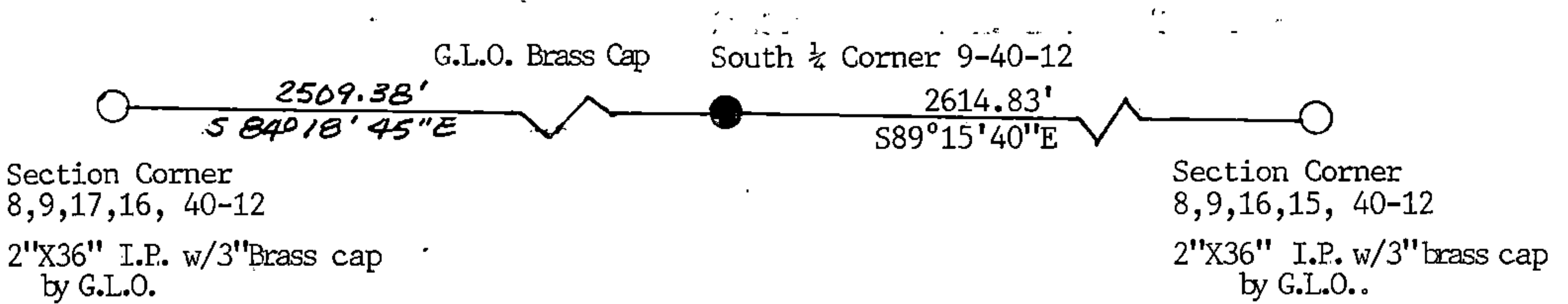

(i) I, Robert H. Winat
 (type or print name) certify that the corner location shown on this record was determined by me or under my direction and control and that this U.S. Public Land Survey Monument Record is correct and complete to the best of my knowledge and belief.

Robert H. Winat June 15
 Signature Date