

CERTIFIED LAND CORNER RESTORATION

State of Wisconsin

County of Forest

ss.

I Jean F. Resvick, do hereby certify that on the 16th day of August, 19 67, I found evidence of the West quarter corner of Section 9 Township 40 North, Range 12 East, Fourth Principal Meridian, as described hereon; and that from this evidence I established ~~a new monument~~ accessories as described hereon to perpetuate the ~~original~~ location of this corner:

Description of original monument and accessories and subsequent restorations:

Surveyed in 1859 by Wm. E. Daugherty. Dependent resurvey in 1941 by G.R. Veal. Proportionate distance. Set a concrete monument 24 ins. long, 6 ins. diameter, with brass cap marked:

from which the following trees bear:

A poplar, 8", S47° 15'E, 41 lks.

A poplar, 12", N44° 15'W, 14 lks.

Description of corner evidence found:

Monument as described above and in place
A poplar stump, 15", N44° 15'W, 9.30 ft.
A stump hole, S47° 15'E, 27.00 ft.

Description of ~~monument and~~ accessories I established to perpetuate the ~~original~~ location of this corner:

Blazed and scribed the following new bearing trees:

A maple, 4", S13°E, 19.07 ft. or 28.894 lks.

A maple, 5", N56°W, 20.22 ft. or 30.636 lks.

Set 4"x4"x7' long cedar post next to monument.

44012082000

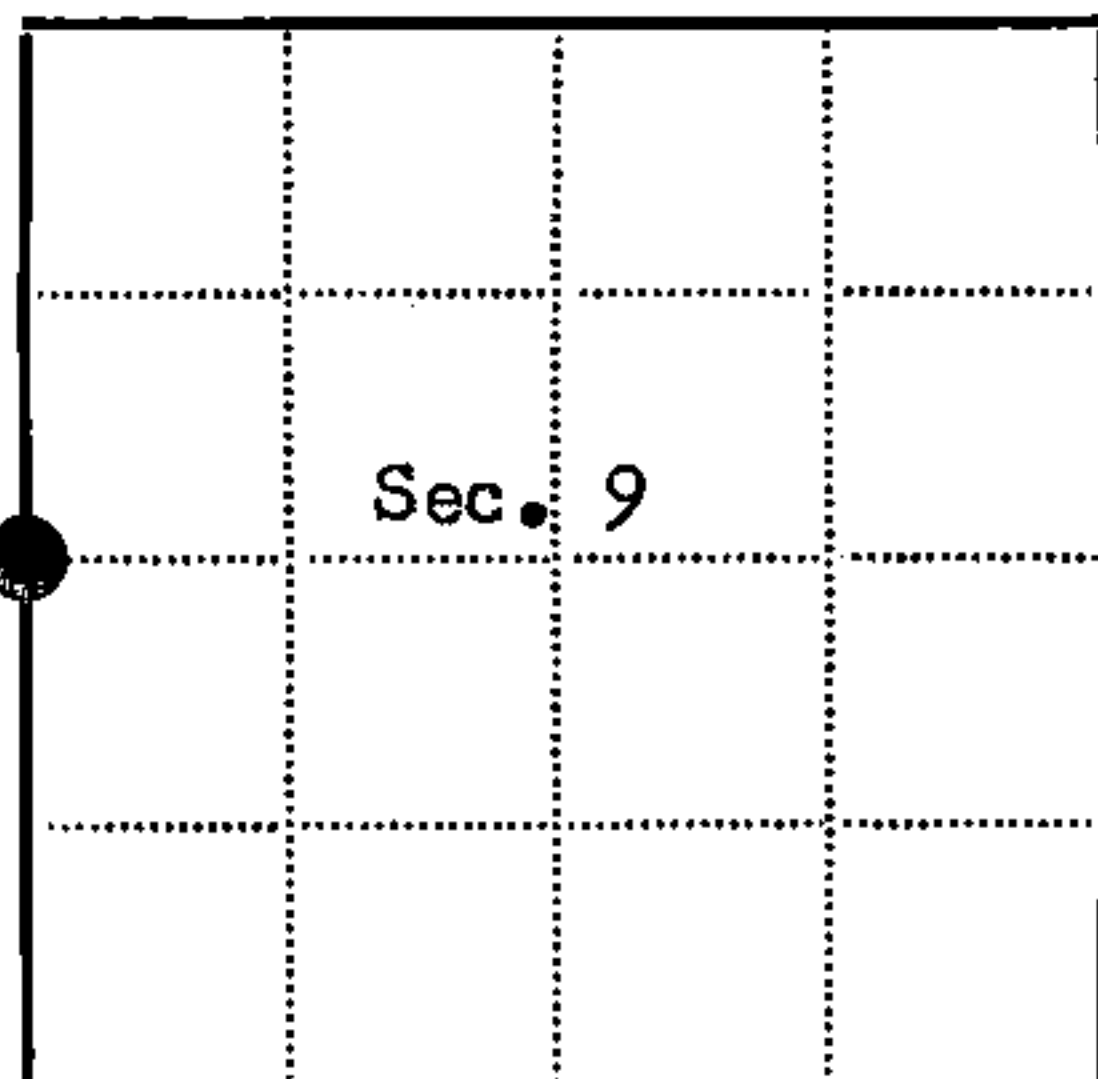

● = Corner monument restored

□ =

Resident witnesses.....

Dated at Rhineland Wisconsin, this 11th day of April, 19 68.

Signature Jean F. Resvick Title Cadastral Surveyor
(County Surveyor, Registered Land Surveyor, or other duly authorized official)

Surveyors Registration No. S-802 DOCUMENT NO. 94558

Office of Register of Deeds County of Forest

I hereby certify that the within instrument was filed in this office for record on the 14th day of May, 19 68 and was filed in Book No. I Page No. G-9 of County Records. at 10:00 AM

Signature Eugene Stetson Title Register of Deeds

Township 40 N, Range 12 E, Section 9, Index No. G-9, Page No. 10

U.S. PUBLIC LAND SURVEY MONUMENT RECORD

Index No. G-9

State of Wisconsin }
County of Forest } ss.

I, Robert H. Winat, do hereby
certify that on the 7th day
of April, 1985, I found
evidence of the quarter
corner of 8 & 9
Township 40, North, Range
12 East, Fourth Principal Meridian,
as described hereon; and that from this evidence
I established a new monument and accessories
as described hereon to perpetuate the original
location of this corner.

Resident witnesses:

Mike Stevens

Mike Lukasko

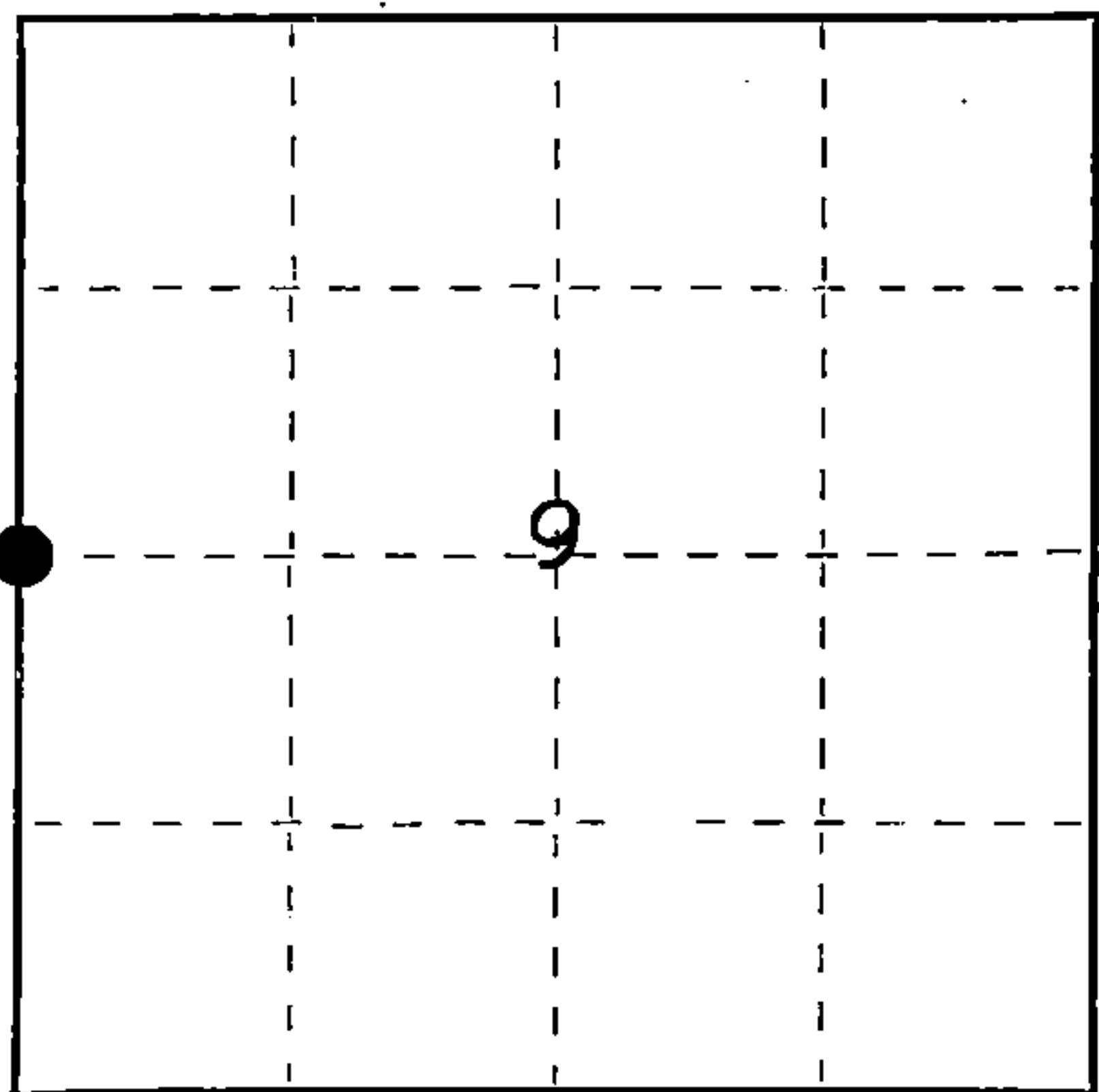

● = Corner monument restored.

History of original corner establishment: Established in 1859 by Wm. E. Daugherty.
Dependant resurvey in 1941 by G.L.O., G.R. Veal set a brass capped concrete
monument and BT's:

Poplar	8"	S47°15'E	41 lks.
Poplar	12"	N44°15'W	14 lks.

Jean F. Resvick found monument in 1968 and the following:

Poplar Stump	15"	N44°15'W	9.30 ft.
Stump Hole		S47°15'E	27.00 ft.

~~XXXXXXXXXXXXXXXXXXXX~~

Resvick set the following BT's:

Maple	4"	S13°E	19.07 ft.
Maple	5"	N56°W	20.22 ft.

Cedar wood post next to corner.

Description of corner evidence found:

Found 2" G.L.O. brass capped concrete monument and BT's:	
Red Maple	5" S13°E 19.13 ft. old blazes visible
Sugar Maple	6" N54°W 20.22 ft. & overgrown
Wood Sign Post	West 1.30 ft. in good shape

Description of monument and accessories I established to perpetuate the original location of this corner.

Established the following new BT's:

Sugar Maple	5"	S77°E	16.37 ft.
Red Maple	7"	S78°W	26.81 ft.

(over) Dated at Rhinslander, Wis., this 4 day of June, 1985

Signature Robert H. Winat Title Land Surveyor Registration No. 1090
(County Surveyor, Registered Land Surveyor, or other duly authorized official)

Office of Register of Deeds, County of Forest, I hereby certify that the within
instrument was filed in this office for record on the 24th day of July, 1985
at 1:10 o'clock P. M.

Paul Aschenbrenner
(Register of Deeds)

By _____ Deputy

44012082000

(e) Describe any material discrepancy between the location of the corner as restored or reestablished and the location of that corner as previously restored or reestablished by distance and direction. Show the discrepancy on the plan view drawing under (d), above. Show the distances between the corner as previously restored or reestablished and (1) the corner as restored or reestablished, and (2) to at least 2 of the witness monuments shown on the drawing in (d), above.

See drawing below.

(f) Was the corner restored through acceptance of (1) an obliterated evidence location, or, (2) a found perpetuated location?

Found perpetuated location.

(g&h) Was the corner reestablished through lost corner proportionate methods? If so, show the method, including the directions and distances to other public land survey corners used as evidence or used for proportioning in determining the corner location?

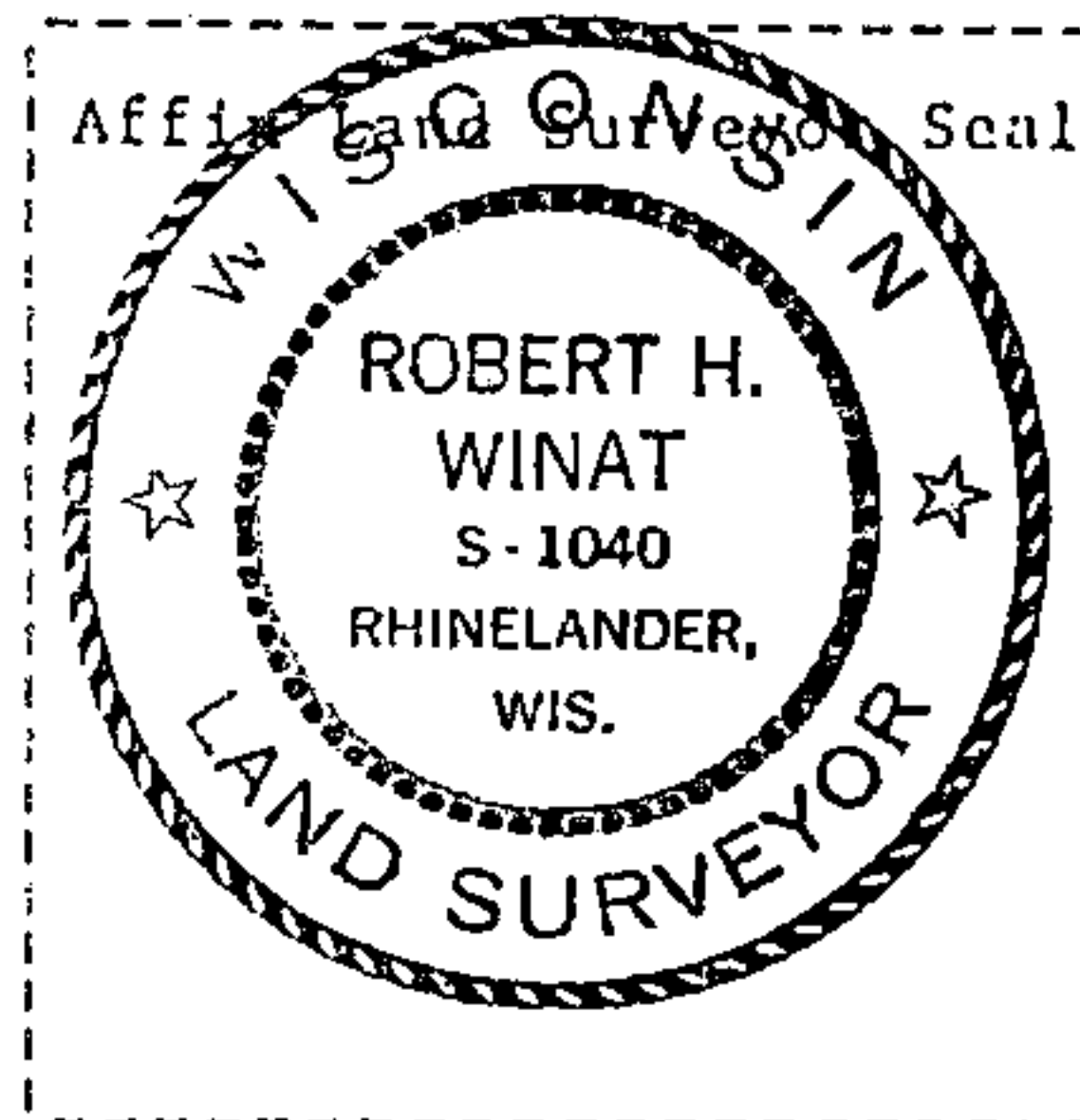
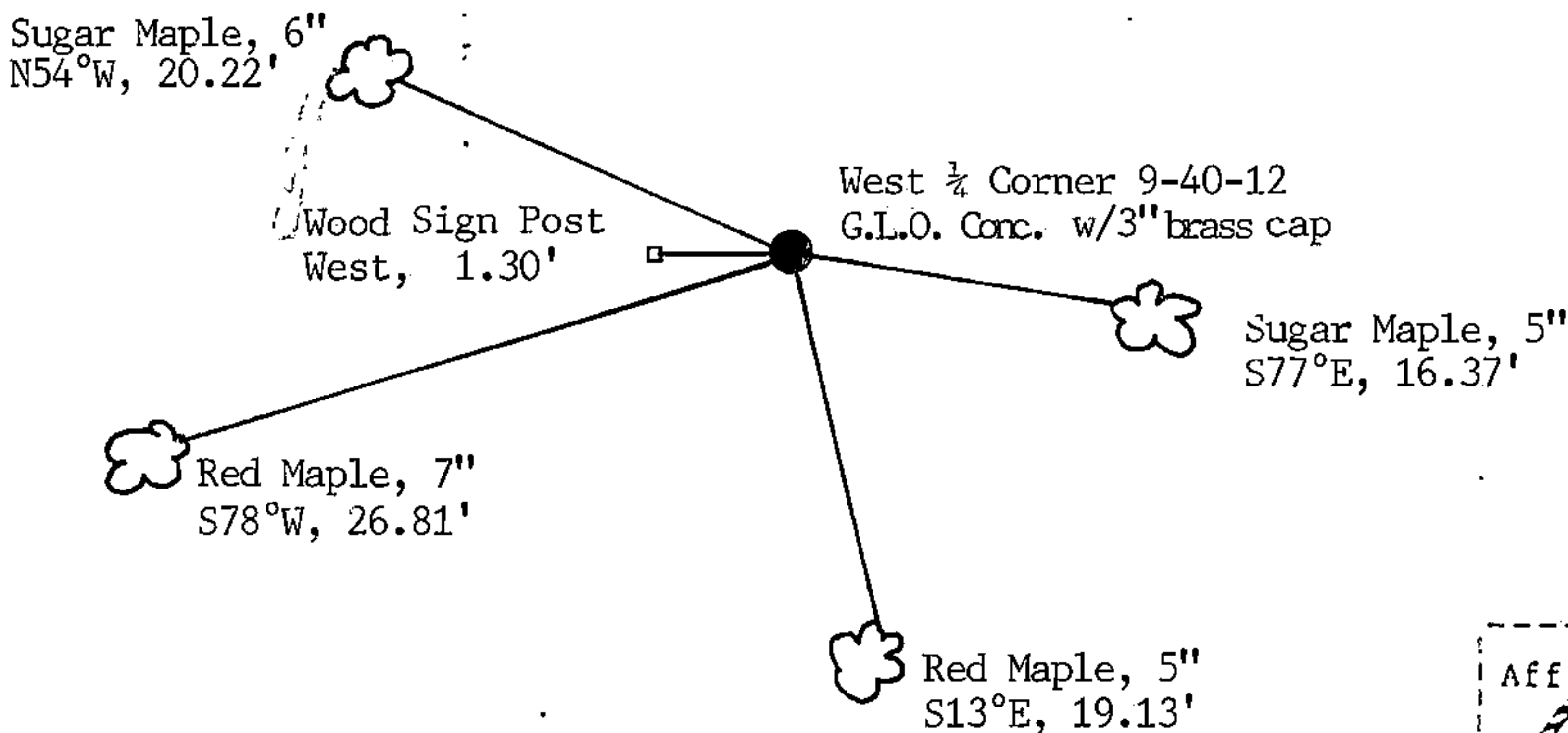

(i) I, Robert H. Winat
(type or print name) certify that the corner location shown on this record was determined by me or under my direction and control and that this U.S. Public Land Survey Monument Record is correct and complete to the best of my knowledge and belief.

Robert H. Winat 4 June '85
Signature Date