

U.S. PUBLIC LAND SURVEY MONUMENT RECORD

Index No. T-9

State of Wisconsin }
County of Forest } ss.

I William B. Cochran, do hereby
certify that on the 23rd day
of July, 1985, I found
evidence of the East Quarter
corner of Section 29
Township 39, North, Range
14 East, Fourth Principal Meridian,
as described hereon; and that from this evidence
I established a new monument and accessories
as described hereon to perpetuate the original
location of this corner.

Resident witnesses:

David Brownell

State Plane Co-ordinates
N- 244,871.2300
E-2,316,667.4010

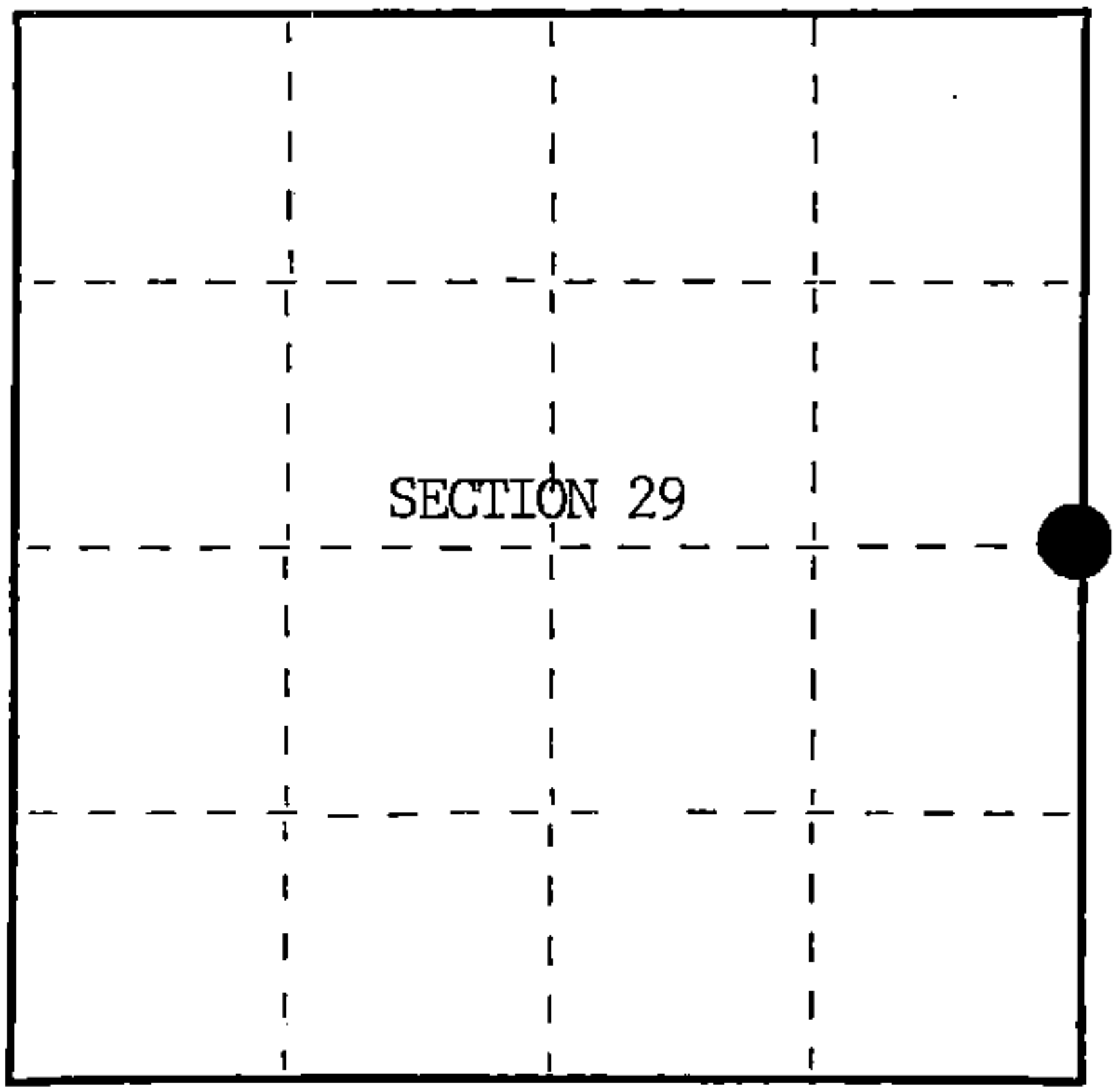

○ = Corner monument restored.

History of original corner establishment:

Original Government Survey in 1865 by William E. Daugherty and Alex McDill.
North between Sections 28 and 29, 40.00 chains, set Quarter Section Post
to Sections 28 and 29, from which the following bear;

Sugar	12"	S66°E	8 lks.
Birch	10"	N65°W	24 lks.

Description of corner evidence found:

Found 6"x6" Scribed Cedar Post in a mound of rock.

I accept the Scribed Cedar Post as the best available evidence for restoring
the corner position.

No original corner evidence was recovered.

Description of monument and accessories I established to perpetuate the original location of this corner.

In place of Scribed Cedar Post, set a 2½" diameter aluminum pipe monument, 3 feet
long, 2 feet in the ground, with an aluminum cap stamped; T39N, R14E, 1/4, S28,
S29, 1985, S-1107. From which the following new blazed and scribed bearing trees bear;

Maple	9"	S30°E	84.05 feet
Maple	7"	S24°W	65.53 feet
Steel Sign Post		NE	4.00 feet

Dated at Hiles, Wis., this 27th day of January, 1986

Signature William B. Cochran Title Land Surveyor Registration No. S-1107
(County Surveyor, Registered Land Surveyor, or other duly authorized official)

Office of Register of Deeds, County of Forest, I hereby certify that the within
instrument was filed in this office for record on the 11th day of March, 1987
at 3:30 o'clock P. M.

Paul Aschenbrenner
(Register of Deeds)

By Deputy

FORM NO. 985-A
H.C. Miller Company

Stock No. 26273

DOCUMENT NUMBER 132386

4391429 2000

- (e) Describe any material discrepancy between the location of the corner as restored or reestablished and the location of that corner as previously restored or reestablished by distance and direction. Show the discrepancy on the plan view drawing under (d), above. Show the distances between the corner as previously restored or reestablished and (1) the corner as restored or reestablished, and (2) to at least 2 of the witness monuments shown on the drawing in (d), above.

See drawing below.

- (f) Was the corner restored through acceptance of (1) an obliterated evidence location, or, (2) a found perpetuated location?

Restored from accepted evidence.

- (g&h) Was the corner reestablished through lost corner proportionate methods? If so, show the method, including the directions and distances to other public land survey corners used as evidence or used for proportioning in determining the corner location?

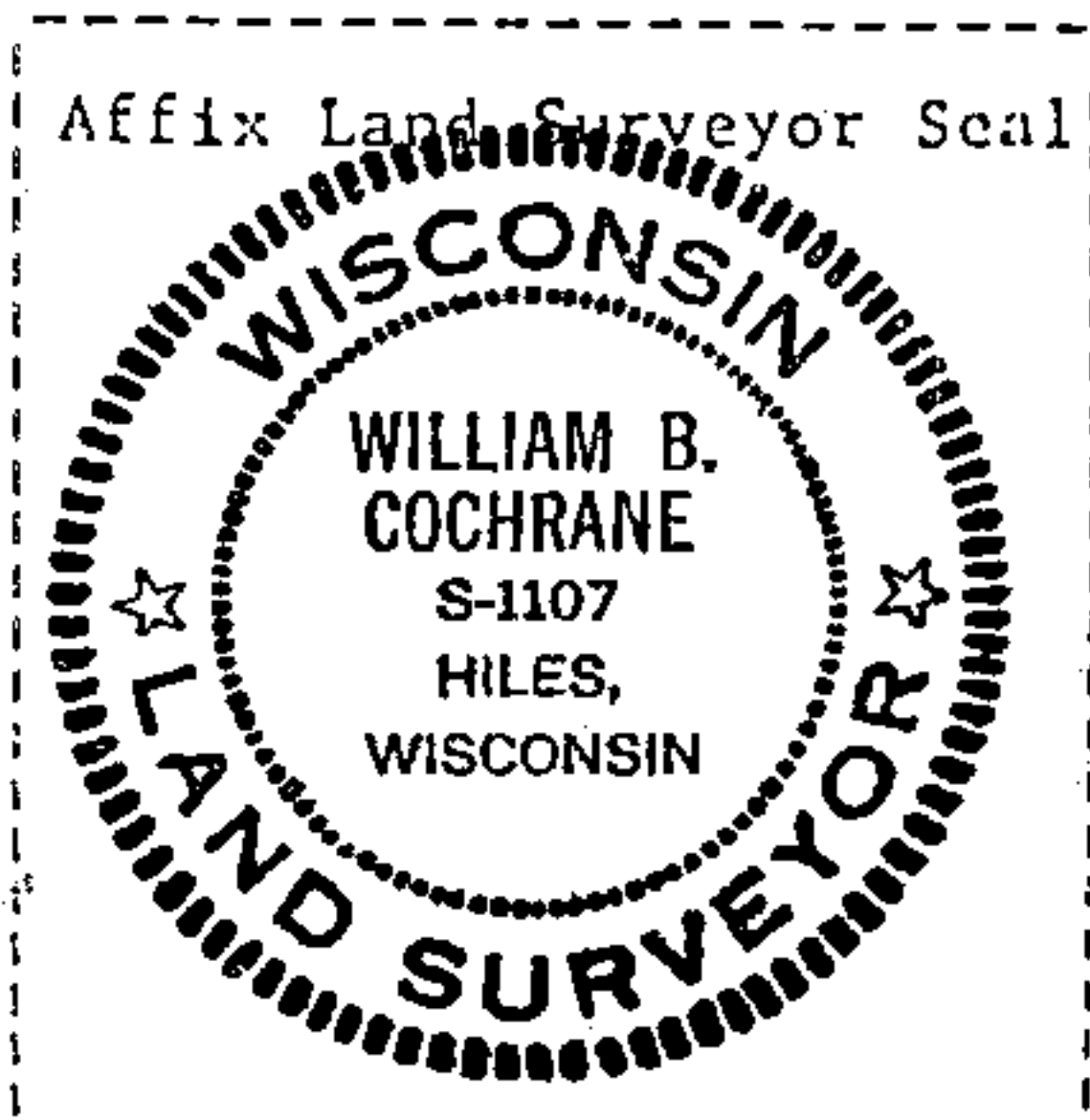
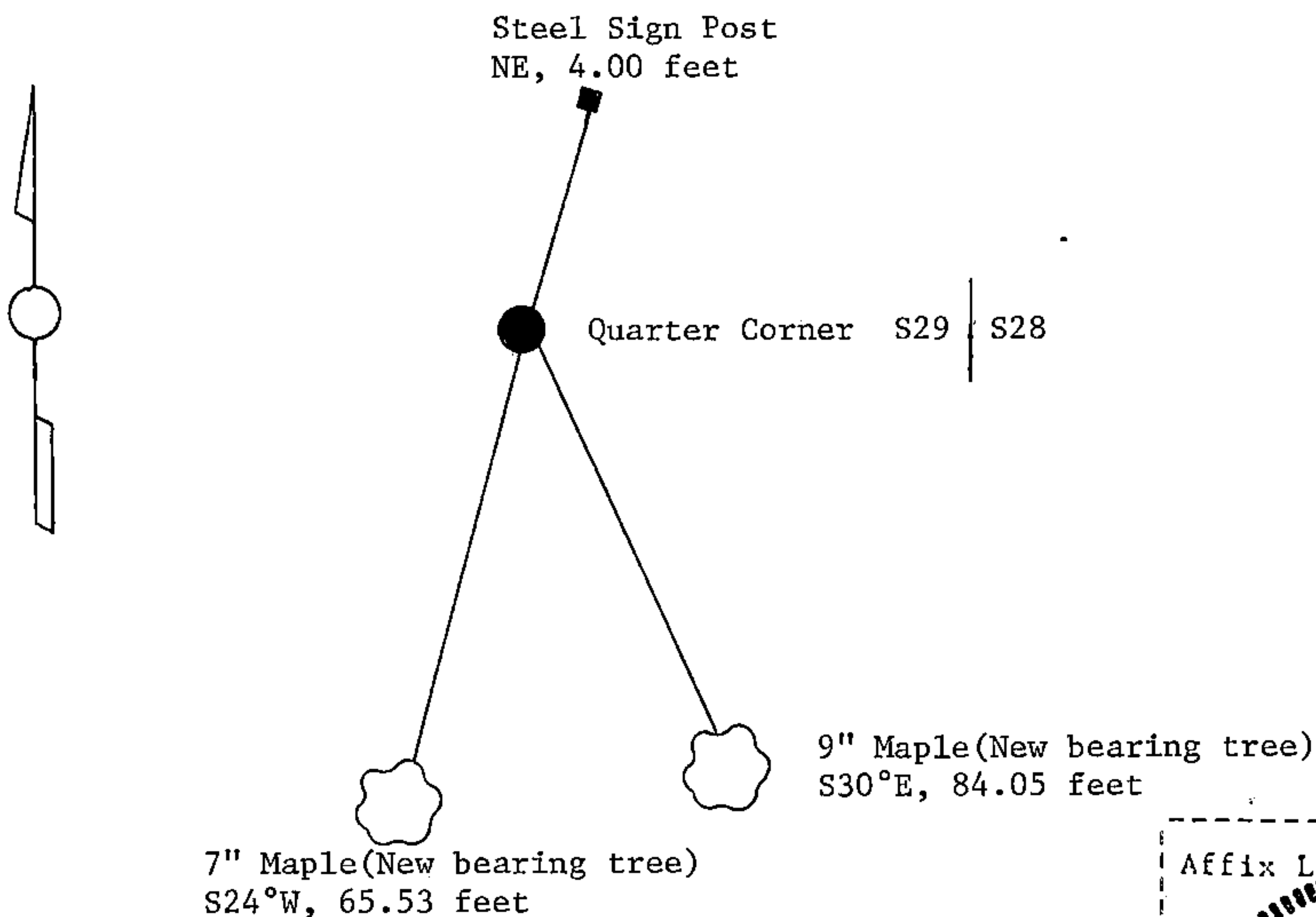

- (i) I, William B. Cochrane
(type or print name) certify that the corner location shown on this record was determined by me or under my direction and control and that this U.S. Public Land Survey Monument Record is correct and complete to the best of my knowledge and belief.

William B. Cochrane October 7, 1986
Signature Date

Survey requested by: Edward J. [Signature] 3-9-87
District Ranger Date