

CERTIFIED LAND CORNER RESTORATION

Index No. 782 7
V 7

State of Wisconsin }
 County of FOREST } ss.

I George V. Kapitiz, do hereby certify that on the 16 day of June, 19 61, I found evidence of the 1/4 corner of 29-32 Township 39, North, Range 11 East, Fourth Principal Meridian, as described hereon; and that from this evidence I established a new monument and accessories as described hereon to perpetuate the original location of this corner.

Resident witnesses:

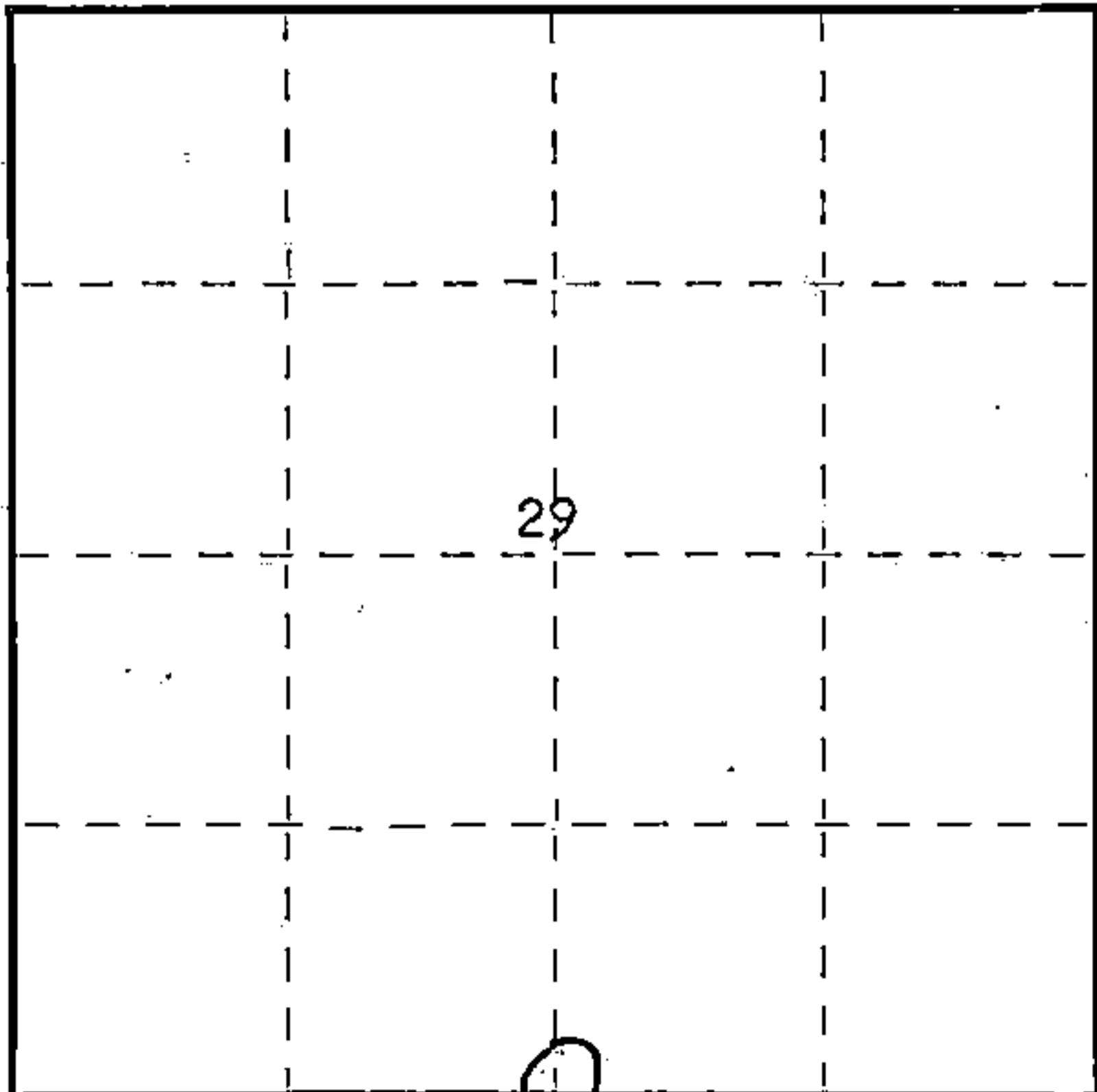

○ = Corner monument restored.

History of original corner establishment:

- 39.93 set 1/4 post
- Sugar 12" N 44° W 21 lks.
- Birch 15" S 86° E 28 lks.

Description of corner evidence found:

- 4" x 4" x 28" cedar post in place
- F.S. poster on balsam tree

Description of monument and accessories I established to perpetuate the original location of this corner.

Replaced 4" x 4" x 28" cedar post with 2" I.D. galvanized iron pipe 5' long filled with concrete 18" above ground capped with brass tablet, stamped to read:

Blazed and scribed the following bearing trees:

- 15 lks. W. Birch 8" N 88° E 50.0
- W. Spruce 5" S 43° W 24.3
- W. Spruce 7" N 50° W 24.0
- Hemlock 18" N 63° W 39.1

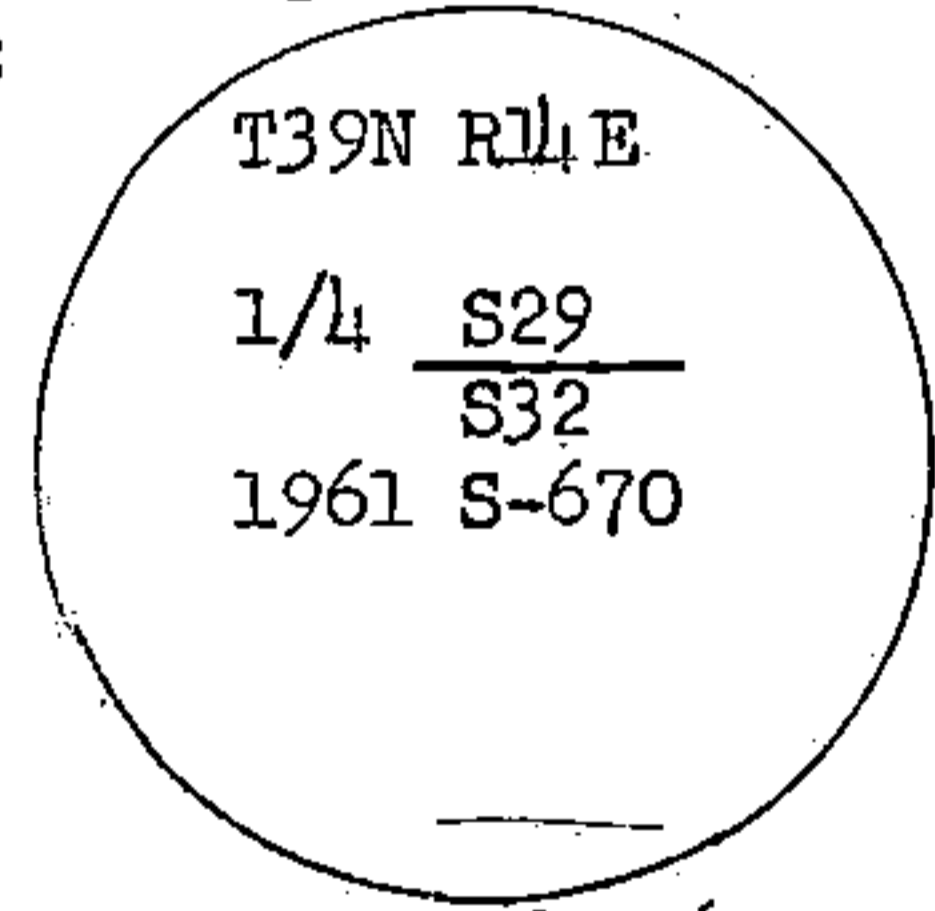

Dated at Crandon, Wis., this 24th day of January, 1962

Signature George V. Kapitiz Title Land Surveyor Registration No. S-670
 (County Surveyor, Registered Land Surveyor, or other duly authorized official)

Office of Register of Deeds, County of Forest, I hereby certify that the within instrument was filed in this office for record on the 24th day of January, 1962 at 9 o'clock A. M.

Anna Peterson i DOCUMENT NO. 85681
 (Register of Deeds)

By _____ Deputy

FORM 985 H. C. MILLER CO., MILWAUKEE

43914290020

U. S. PUBLIC LAND SURVEY MONUMENT RECORD

INSTRUCTIONS:

This record shall show the location of the corner and shall include all of the following nine elements (a through i).

- (a) Identify the corner by reference to the U.S. public land survey system.

○ = Corner monument restored.

Quarter Corner common to Sections 29 and 32, T39N, R14E, Forest County, Wisconsin

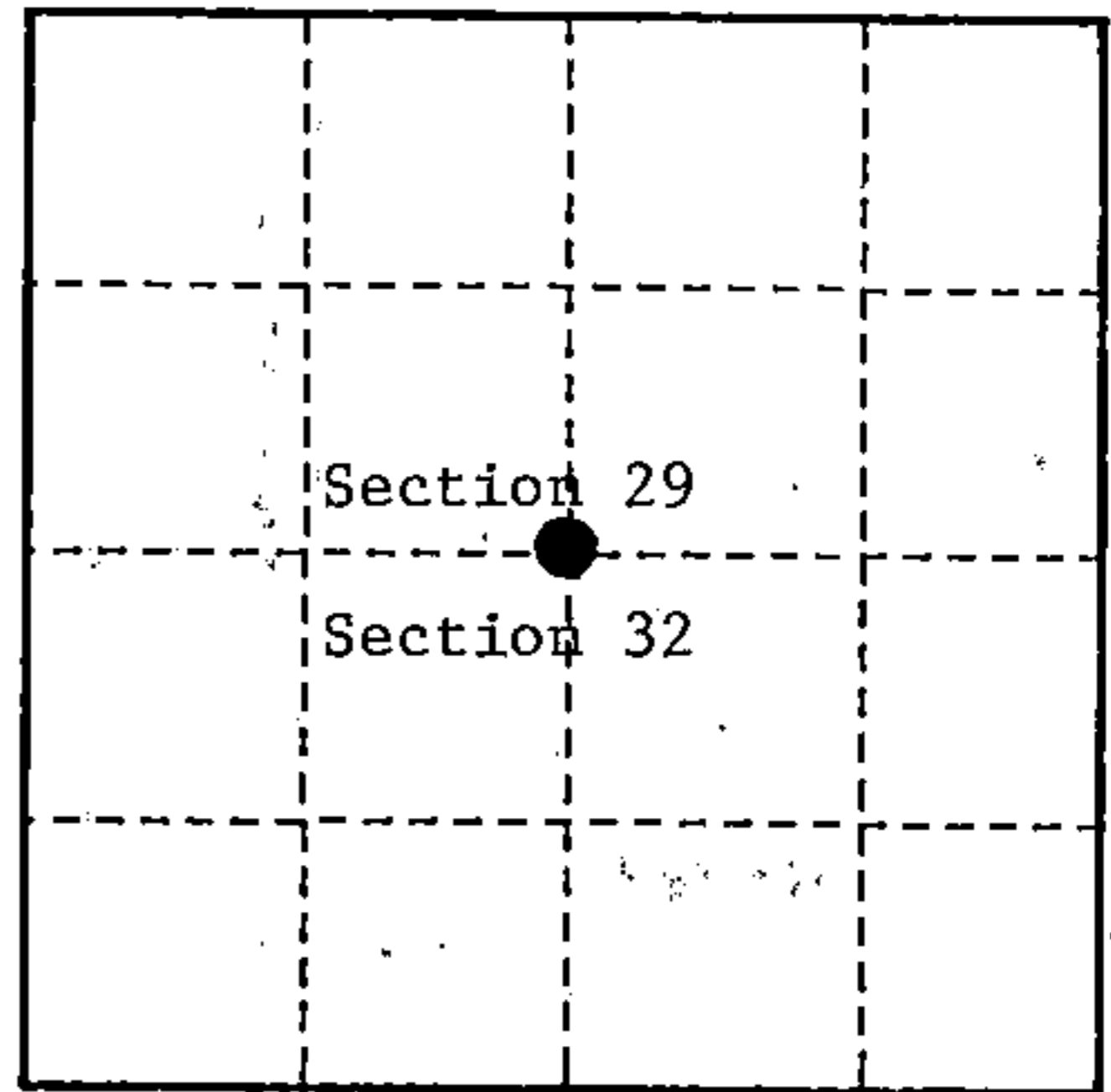

- (b) Describe any record evidence, monument evidence, occupational evidence, testimonial evidence or any other material evidence you considered, and whether the monument was found or placed. Original Government Survey in 1865 by William E. Daugherty and Alex McDill.

In 1961, George Kapitz, RLS, found a 4"x4"x28" cedar post in place. Also found a Forest Service poster on a Balsam tree. In place of post, set a 2" diameter galvanized iron pipe, 5 feet long, 18 inches above the ground, with a brass tablet stamped; T39N, R14E, 1/4, S29, S32, 1961, S-670. Blazed and scribed the following bearing trees;

White Birch	8"	N88°E	50.00 feet
White Spruce	5"	S43°W	24.30 feet
White Spruce	7"	N50°W	24.00 feet
Hemlock	18"	N63°W	39.10 feet

On 7-29-99, Gary L. Pisoni, RLS, found the monument as described above. Made new bearing trees as described below.

See previous Land Corner Certificate dated January 24, 1962.

- (c) In the plan view drawing below, provide reference ties to at least 4 witness monuments, or, if the location is within a municipality, to at least 2 witness monuments. (witness monuments shall be made of concrete, natural stone, iron or other equally durable material.)

- (d) Show a plan view drawing depicting the relevant monuments and reference ties which is sufficient in detail to enable accurate relocation of the corner monument if the corner monument is disturbed. Indicate north.

1. Popple, 5", N33°W, 53.24 feet (NBT)
2. Popple, 5", N21°E, 47.19 feet (NBT)
3. Popple, 6", S64°W, 41.33 feet (NBT)
4. Steel Sign Post, North, 1.00 feet

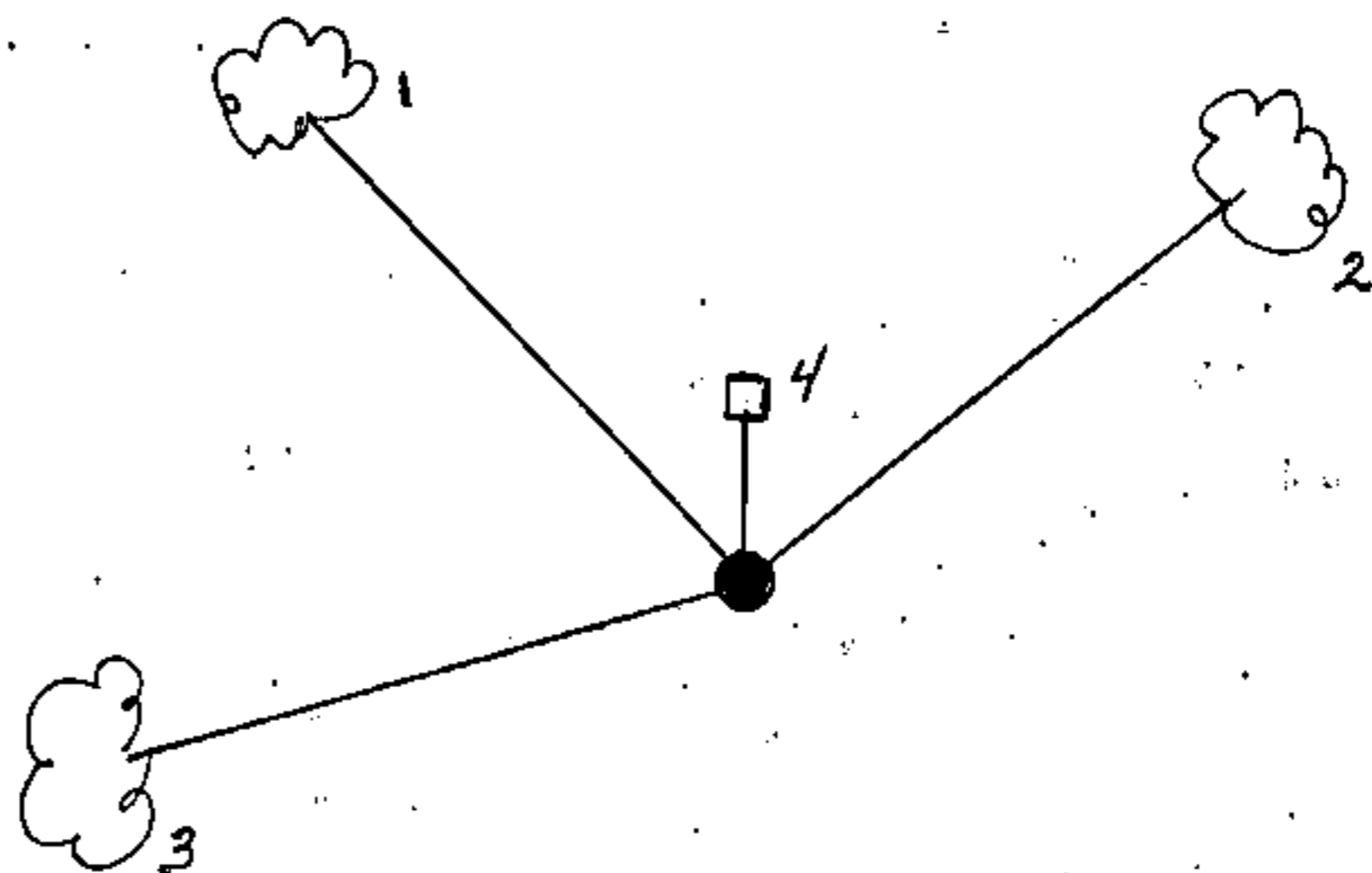

REGISTER'S OFFICE
 Forest County, Wis.
 Received for record this 27th day
 of October A.D., 1999 at
10:05 o'clock A.M. and recorded
 in Vol. Corner Restoration
 page V-7

Ray Swanson, Deputy
 Register of Deeds

V-7

43914 29 0020

V-7

(e) Describe any material discrepancy between the location of the corner as restored or reestablished and the location of that corner as previously restored or reestablished by distance and direction. Show the discrepancy on the plan view drawing under (d), above. Show the distances between the corner as previously restored or reestablished and (1) the corner as restored or reestablished, and (2) to at least 2 of the witness monuments shown on the drawing in (d), above.

None

(f) Was the corner restored through acceptance of (1) an obliterated evidence location, or, (2) a found perpetuated location?

Found perpetuated location.

(g & h) Was the corner reestablished through lost corner proportionate methods? If so, show the method, including the directions and distances to other public land survey corners used as evidence or used for proportioning in determining the corner location?

(1) I, Gary L. Pisoni
(type or print name) certify that the corner location shown on this record was determined by me or under my direction and control and that this U.S. Public Land Survey Monument Record is correct and complete to the best of my knowledge and belief.

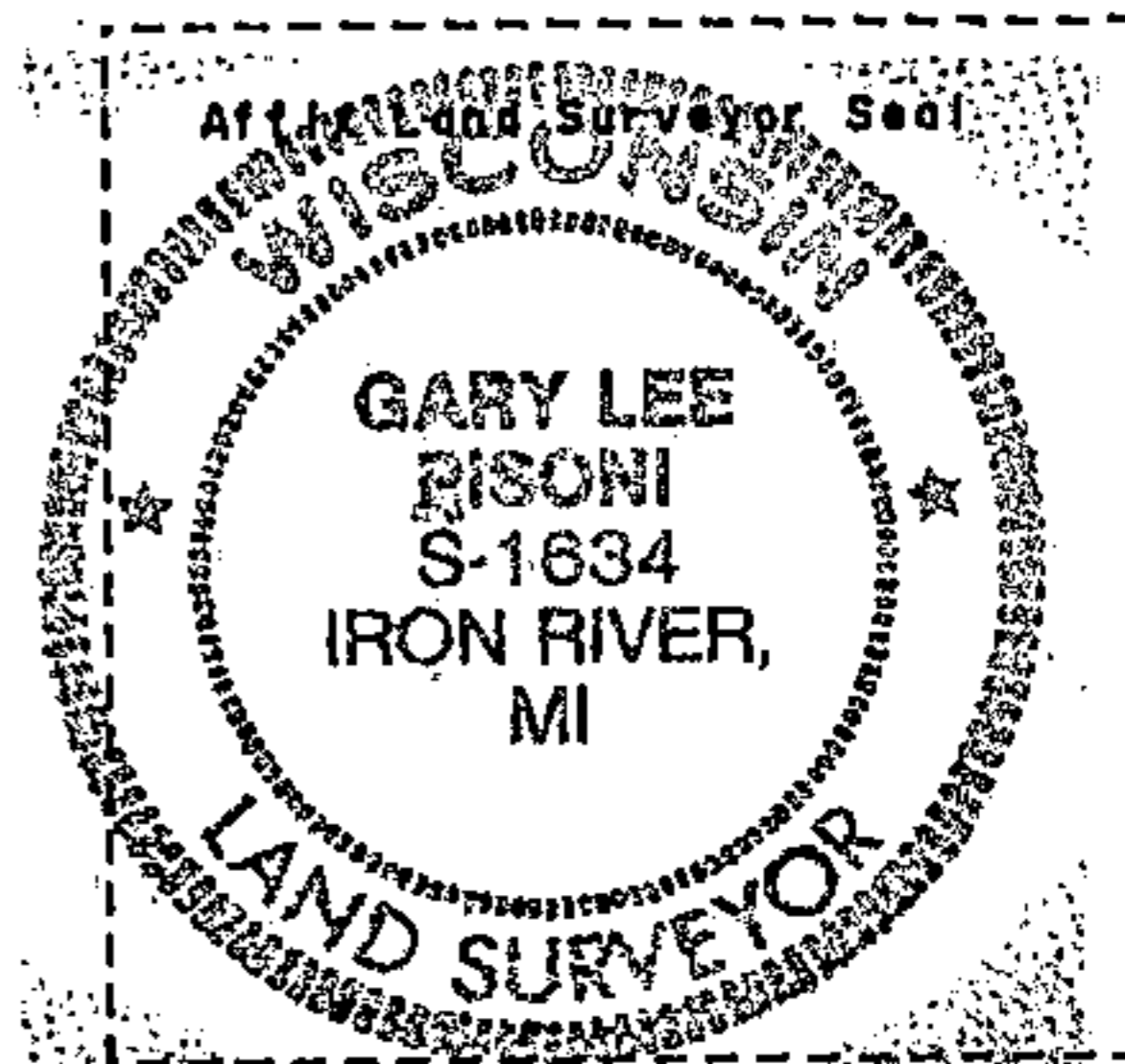

Gary L. Pisoni
Signature

10-2-99
Date

CERTIFICATE READY FOR FILING:

[Signature]
District Ranger