

ESTABLISHED  
CERTIFIED LAND CORNER RESTORATION

State of Wisconsin }  
County of Forest } ss.

I Jean F. Resvick, do hereby certify that on the 5th day of November, 1975, I found ~~no evidence of the~~ established the North Sixteenth corner ~~at~~ between Sections 25 and 26 Township 39 North, Range 14 East, Fourth Principal Meridian, as described hereon; and that from this evidence I established a new monument and accessories as described hereon to perpetuate the ~~original~~ location of this corner:

Description of original monument and accessories and subsequent restorations:

Township surveyed in 1865 by William E. Daugherty  
One sixteenth corners were not located by this original survey.

Description of corner evidence found:

No evidence or record of this corner having been established was found.

I established the location of this corner at the mid-point and on line between the east quarter corner of Section 26 and the Northeast Section corner of Section 26. This one sixteenth corner thus being located N0°24'11"W, 1317.11 feet from the east quarter corner of Section 26 and S0°24'11"E, 1317.12 feet from the northeast corner of Section 26.

Description of monument and accessories I established to perpetuate the location of this corner:

At the location established above, I set a 2 inch inside diameter, galvanized iron pipe, 3 feet long, filled with concrete, set 1.0 feet below the road surface, with brass cap stamped: T39N, R14E, N 1/16, S26, S25, 1975, S-802.  
Reference to the following blazed and scribed new bearing trees.  
White spruce 8, N73E, 59.18 feet  
Red pine 12, S65E, 62.38 feet  
Fence east, north, 15.0 feet

43914263000

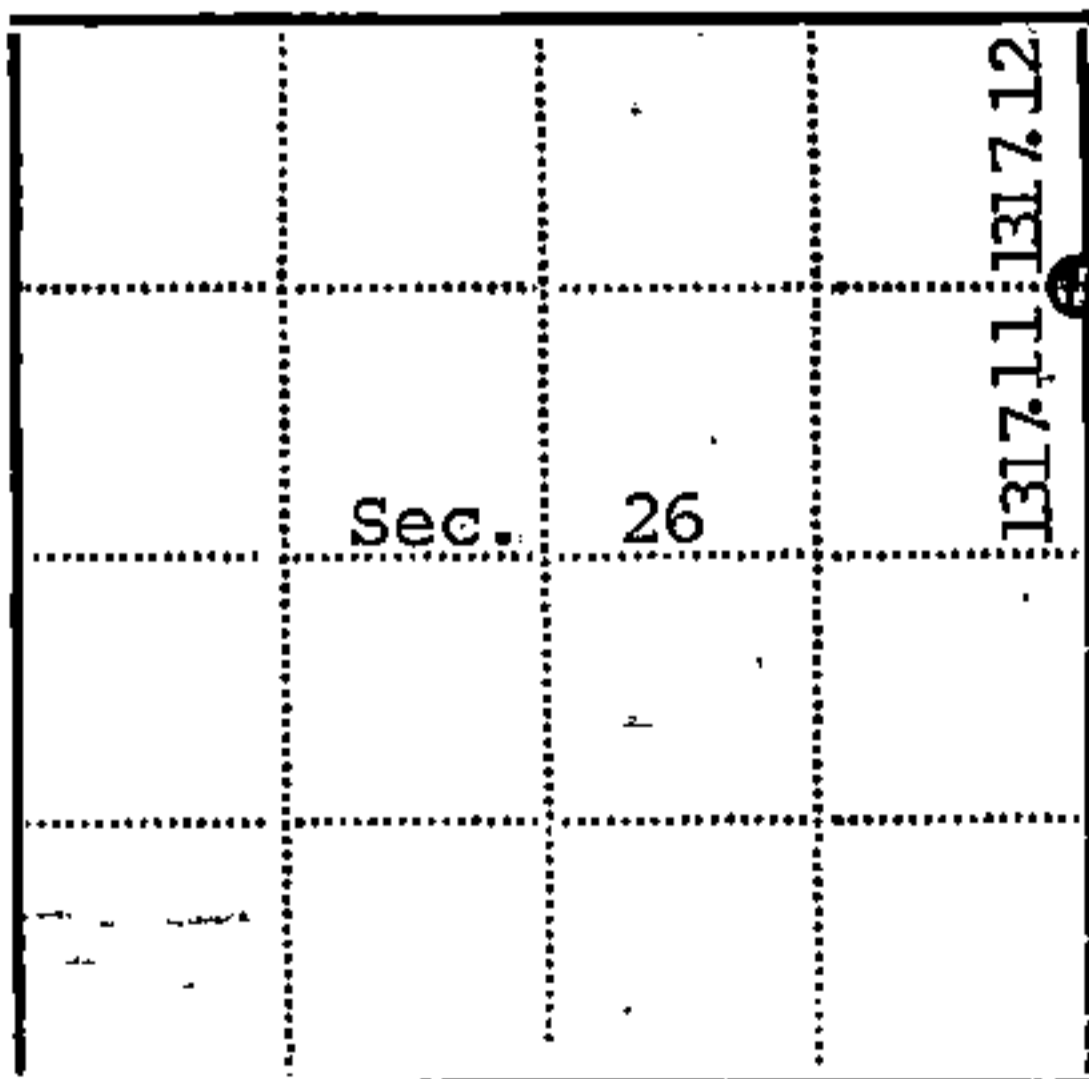
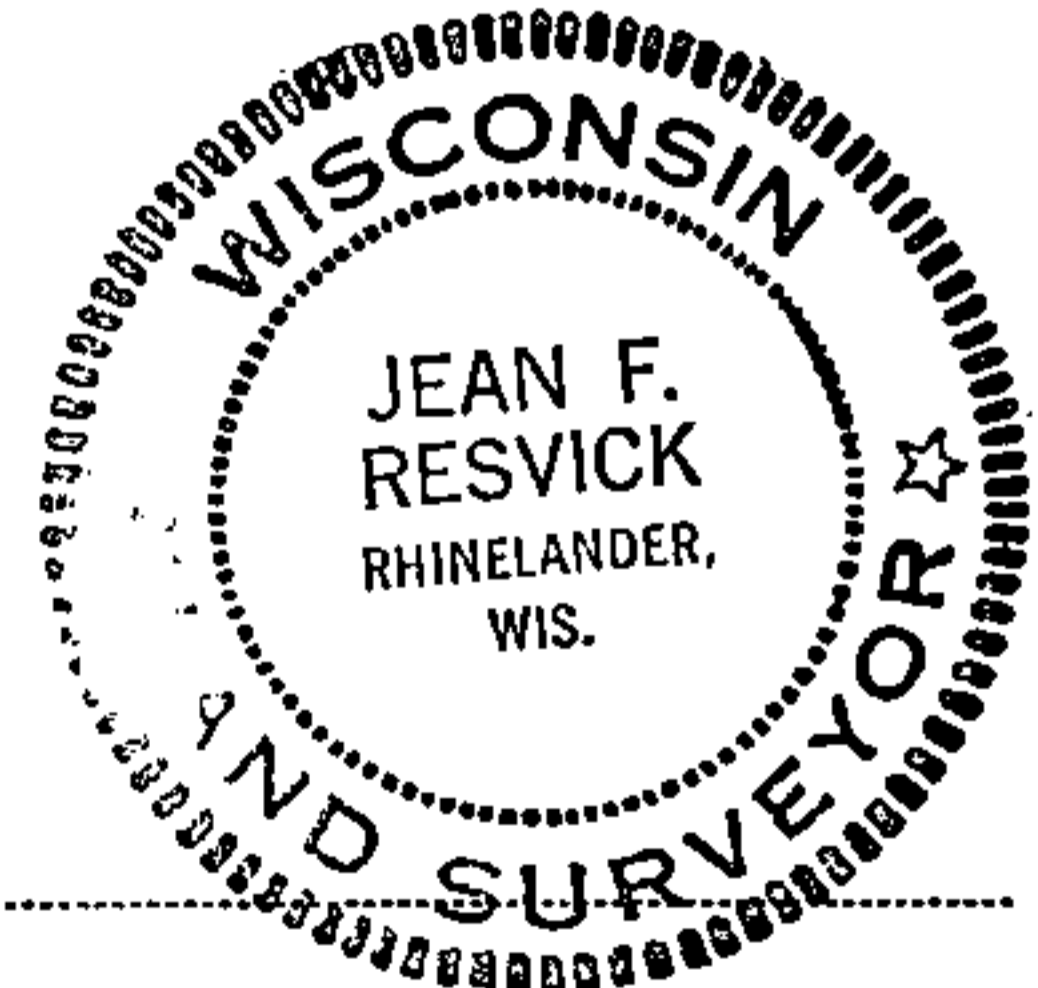

● - Corner monument restored  
□ -

Resident witnesses.....

Dated at Rhinelander Wisconsin, this 15 day of June 1976.

Signature Jean F. Resvick Title Land Surveyor  
(County Surveyor, Registered Land Surveyor, or other duly authorized official)

Surveyors Registration No. S-802 DOCUMENT NUMBER 109606

Office of Register of Deeds County of Forest

I hereby certify that the within instrument was filed in this office for record on the 2nd day of July 1976, and was filed in Book No. Page No. of County Records.

Signature Eugene Stutz Title Register of Deeds

Township 39 North, Range 14 East, Section 26, Index No. S-21, Page No.