

ESTABLISHED
CERTIFIED LAND CORNER RESTORATION

State of Wisconsin }
County of Forest } ss.

I Jean F. Resvick, do hereby certify that on the 7th day of November, 19 75,
~~found evidence of the~~ established the north sixteenth corner of between Sections 23 and 24
Township 39 North, Range 14 East, Fourth Principal Meridian, as described
hereon; and that from this evidence I established a new monument and accessories as described hereon to per-
petuate the ~~original~~ location of this corner:

Description of original monument and accessories and subsequent restorations:

Township surveyed in 1865 by William E. Daugherty
One sixteenth corners were not located by this original survey.

Description of corner evidence found:

No evidence or record of this corner having been established was found.

I established the location of this corner at the mid-point and on line
between the east quarter corner of Section 23 and the Northeast section
corner of Section 23. This one sixteenth corner thus being located
N0°10'35"W, 1354.50 feet from the east quarter corner of Section 23 and
S0°10'35"E, 1354.50 feet from the Northeast section corner of Section 23.

Description of monument and accessories I established to perpetuate the location of this corner:

At the location established above I set a 2 inch inside diameter galvanized
iron pipe, 3 feet long, filled with concrete, set 0.50 feet below the
surface of the road, with brass cap stamped:
T39N, R14E, N 1/16, S23, S24, 1975, S-802

Reference to the following blazed and scribed new bearing trees.
Red pine 6, S54W, 50.09 feet
Red pine 6, N65W, 41.56 feet
Fence line east at corner.

43914233000

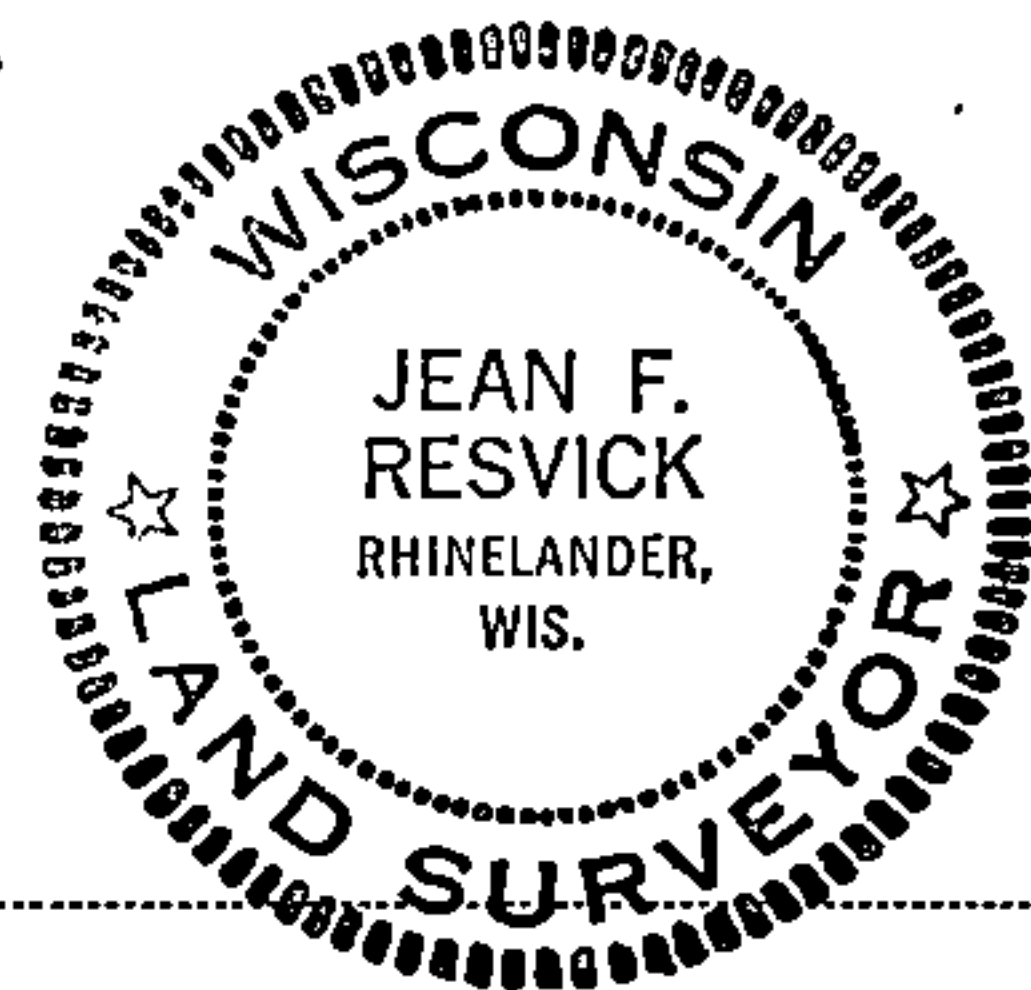
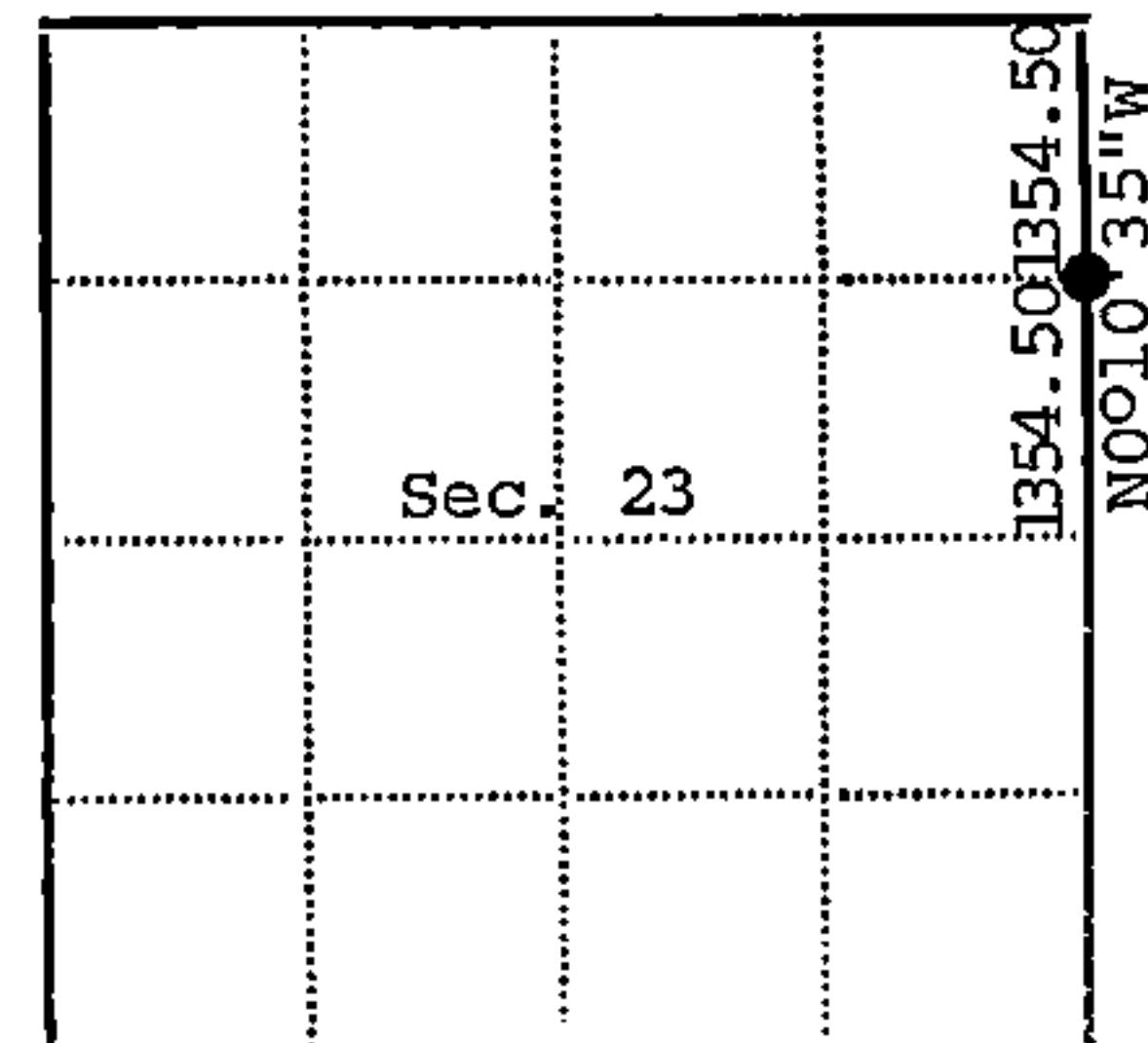

Resident witnesses.....

Dated at Rhineland Wisconsin, this 15 day of June
19 76....

Signature Jean F. Resvick Title Land Surveyor
(County Surveyor, Registered Land Surveyor, or other duly authorized official)

Surveyors Registration No. S-802 DOCUMENT NUMBER 109602

Office of Register of Deeds County of Forest

I hereby certify that the within instrument was filed in this office for record
on the 2nd day of July, 19 76., and was filed in Book
No. Page No. of County Records.

Signature Eugene Stutzman Title Register of Deeds

Township 39 North, Range 14 East, Section 23, Index No. 0-21, Page No.