

CERTIFIED LAND CORNER RESTORATION

State of Wisconsin }  
County of Forest } ss.

I William B. Cochrane, do hereby certify that on the 16th day of October, 1974, I found evidence of the South Quarter corner of Section 23 Township 39 North Range 14 East, Fourth Principal Meridian, as described hereon; and that from this evidence I established a new monument and accessories as described hereon to perpetuate the original location of this corner:

Description of original monument and accessories and subsequent restorations:

Surveyed in May 1865 by William E. Daugherty  
West corrected between Sections 23 and 26  
40.19 chains set 1/4 section post  
W. Pine, 40", S60°W, 18 lks.  
W. Pine, 30", N28°E, 11 lks.

Description of corner evidence found:

A W. Pine stump, 40" diameter, scribed. At a point N60°E, 18 lks from the stump found a W. Pine stump to bear N28°E, 11 lks. When digging a badly decayed post was found.

Description of monument and accessories I established to perpetuate the location of this corner:

At a point N60°E, 18 lks. from the scribed W. Pine stump, I set a 2 inch inside diameter, galvanized pipe, 3 feet long, filled with concrete with a brass cap stamped: T39N, R14E, 1/4, S23, S26, 1974, S-1107  
From which the following bear:  
W. Pine, 21", S8°E, 50.45 feet  
W. Pine, 18", S84°W., 67.65 feet  
Set a steel sign post West of the monument 0.50 feet.

43914230020

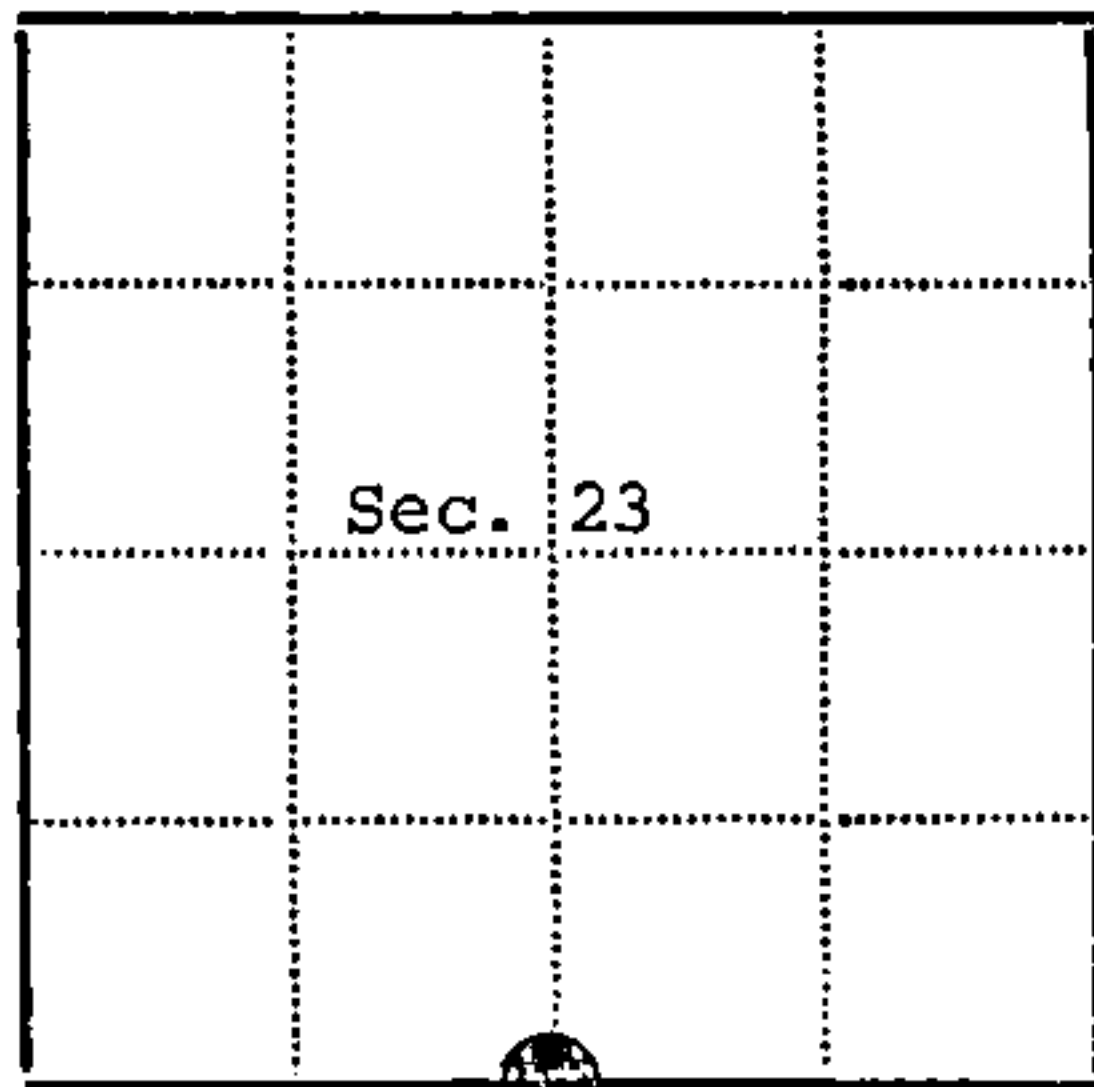
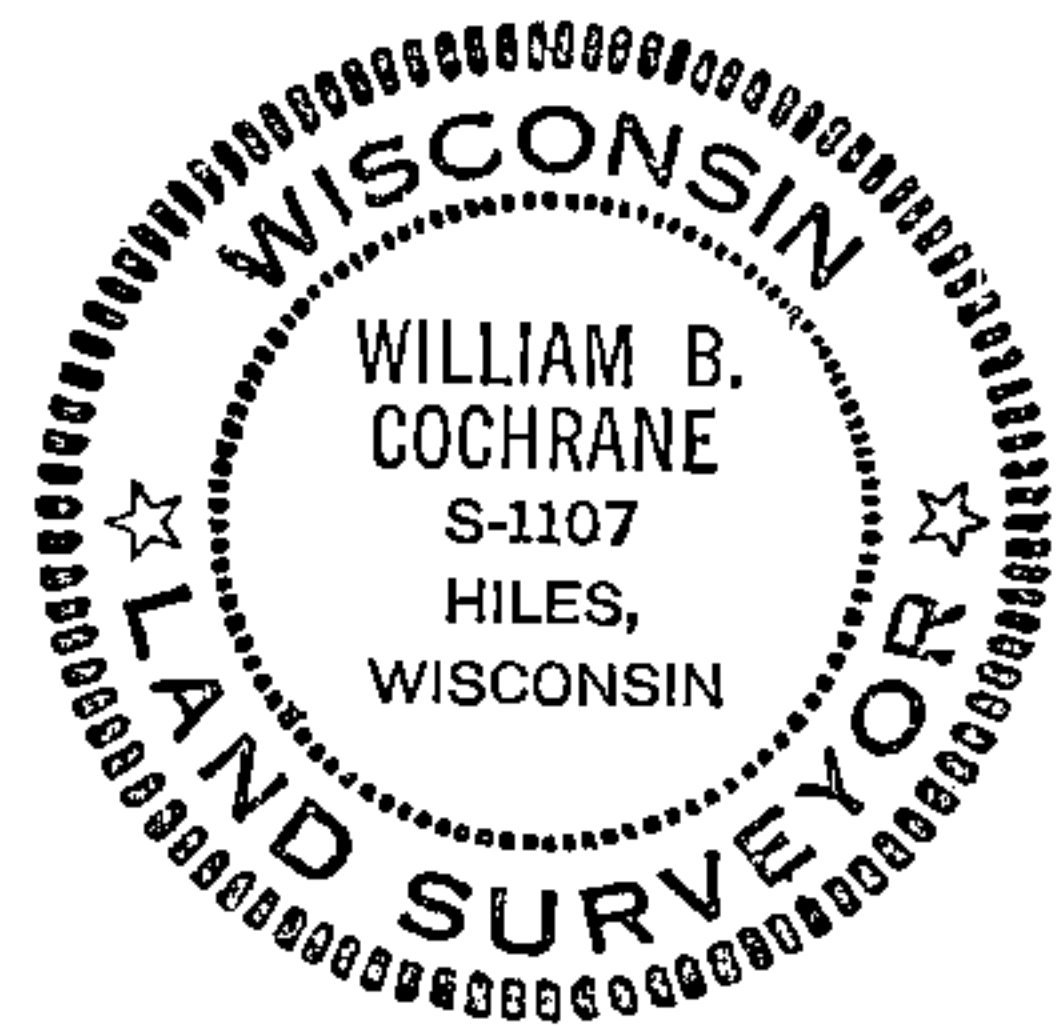

● - Corner monument restored  
□ -

Resident witnesses.....

Dated at Three Lakes Wisconsin, this 7th day of January 1976.

Signature William B. Cochrane Title Survey Technician  
(County Surveyor, Registered Land Surveyor, or other duly authorized official)

Surveyors Registration No. S-1107 DOCUMENT NUMBER 108559

Office of Register of Deeds County of Forest

I hereby certify that the within instrument was filed in this office for record on the 14th day of January 1976, and was filed in Book No. Page No. of County Records.

Signature Eugene Stutzman Title Register of Deeds

Township 39 North Range 14 East Section 23 Index No. R-19 Page No.

R1

U. S. PUBLIC LAND SURVEY MONUMENT RECORD

INSTRUCTIONS:

This record shall show the location of the corner and shall include all of the following nine elements (a through i).

- (a) Identify the corner by reference to the U.S. public land survey system.
- = Corner monument restored.

Quarter Corner common to Sections 23 and 26  
T39N, R14E, Forest County, Wisconsin

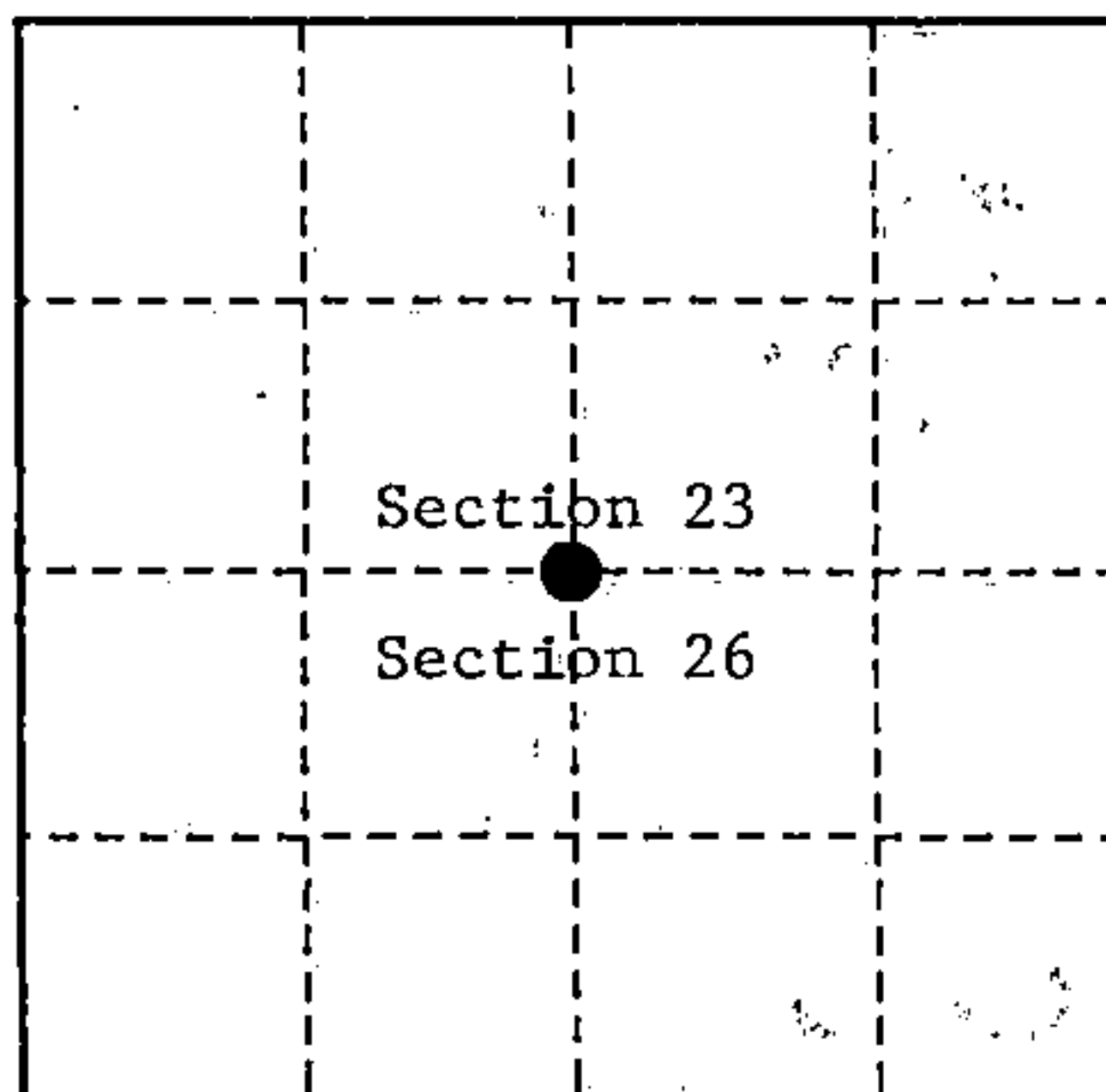

- (b) Describe any record evidence, monument evidence, occupational evidence, testimonial evidence or any other material evidence you considered, and whether the monument was found or placed.

Original Government Survey in 1865 by William E. Daugherty.

In 1974, William B. Cochrane, a Land Surveyor with the U.S. Forest Service, restored the corner position from a badly decayed post and the original bearing trees. In place of the decayed post, set a 2" diameter galvanized iron pipe, 3 feet long, with a brass cap stamped as follows: T39N, R14E, 1/4, S23, S26, 1974, S-1107, from which the following bear:

White Pine	26"	S 08°E	50.45 feet
White Pine	22"	S 84°W	67.65 feet
Steel sign post		West	0.50 feet

On 9/25/99, Gary L. Pisoni RLS found above monument and assessories as described below.

See previous Land Corner Certificate dated January 14, 1976, Document Number 106559.

- (c) In the plan view drawing below, provide reference ties to at least 4 witness monuments, or, if the location is within a municipality, to at least 2 witness monuments. (witness monuments shall be made of concrete, natural stone, iron or other equally durable material.)

- (d) Show a plan view drawing depicting the relevant monuments and reference ties which is sufficient in detail to enable accurate relocation of the corner monument if the corner monument is disturbed. Indicate north.

1. White Pine, 30", S 08°E, 50.45 feet
2. White Pine, 25", S 84°W, 67.65 feet
3. Steel sign post, West, 0.50 feet
4. White Pine, 15", N 50°W, 20.79 feet (NBT)

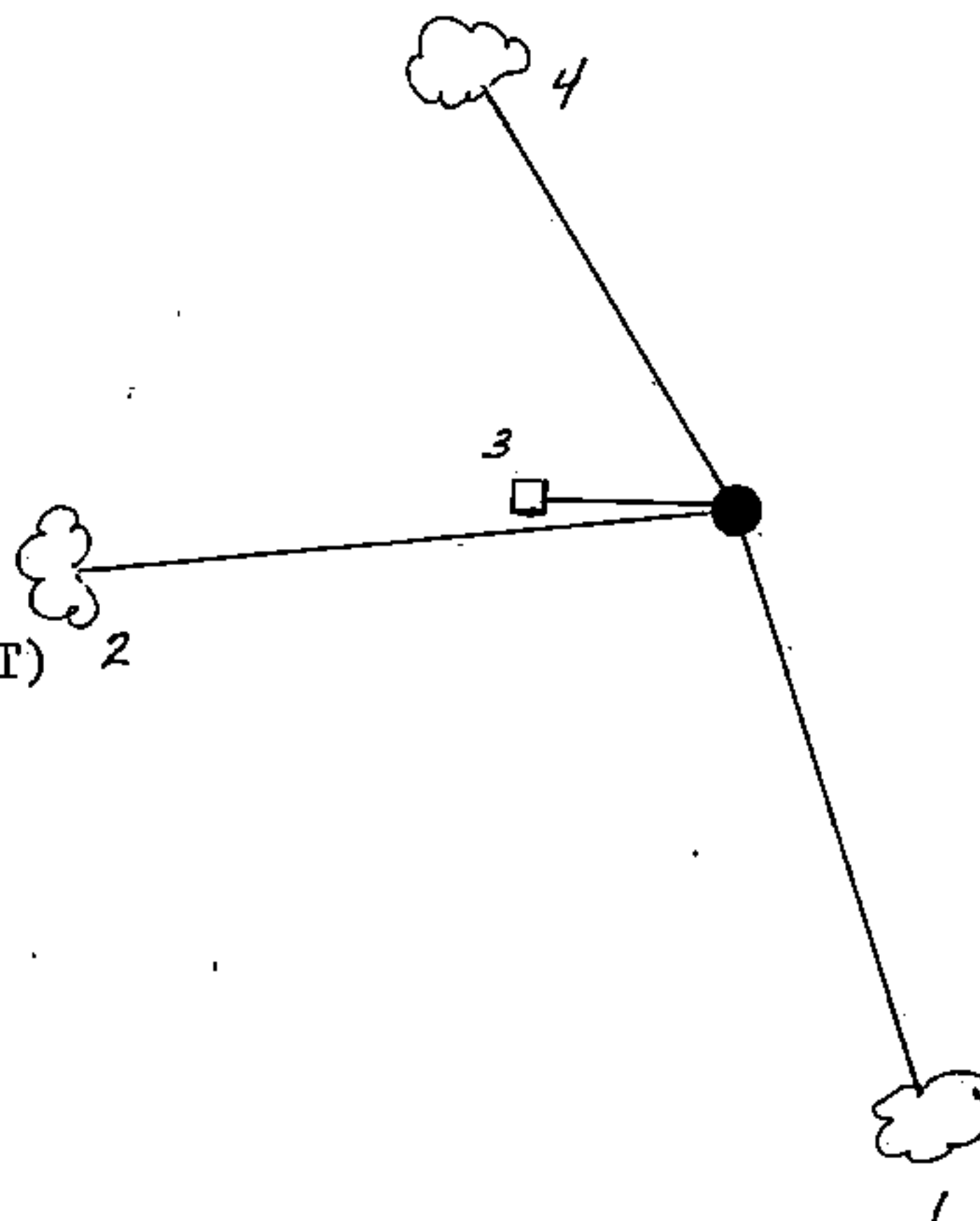

REGISTER'S OFFICE }  
Forest County, Wis. }  
Received for record this 27<sup>th</sup> day  
of October A.D., 1999 at  
10:05 o'clock A.M. and recorded  
in Vol Corner Restoration  
page R-19  
Kay Swanson, Deputy  
Register of Deeds

43914 23 0020

R-19

(e) Describe any material discrepancy between the location of the corner as restored or reestablished and the location of that corner as previously restored or reestablished by distance and direction. Show the discrepancy on the plan view drawing under (d), above. Show the distances between the corner as previously restored or reestablished and (1) the corner as restored or reestablished, and (2) to at least 2 of the witness monuments shown on the drawing in (d), above.

None

(f) Was the corner restored through acceptance of (1) an obliterated evidence location, or, (2) a found perpetuated location?

Restored from accepted evidence.

(g & h) Was the corner reestablished through lost corner proportionate methods? If so, show the method, including the directions and distances to other public land survey corners used as evidence or used for proportioning in determining the corner location?

(1) I, Gary L. Pisoni

(type or print name) certify that the corner location shown on this record was determined by me or under my direction and control and that this U.S. Public Land Survey Monument Record is correct and complete to the best of my knowledge and belief.

Gary L. Pisoni  
Signature

10-1-99  
Date

CERTIFICATE READY FOR FILING:

[Signature]  
District Ranger

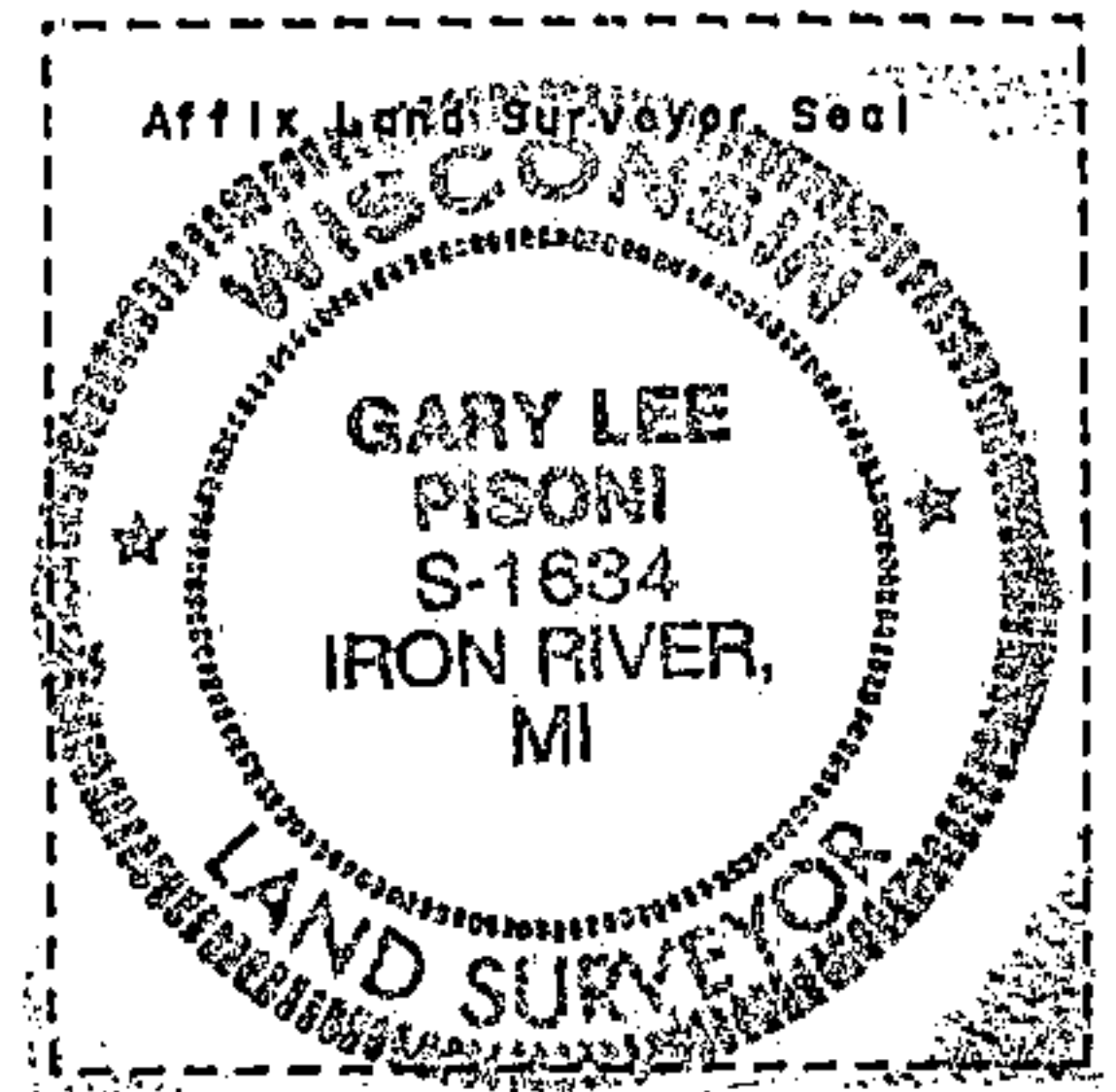

Stock No. 26273