

CERTIFIED LAND CORNER RESTORATION

State of Wisconsin }
County of Forest } ss.

I Jean F. Resvick, do hereby certify that on the 5th day of March, 1974, I found evidence of the Northeast section corner of Section 27 Township 39 North, Range 14 East, Fourth Principal Meridian, as described hereon; and that from this evidence I established a new monument and accessories as described hereon to perpetuate the original location of this corner:

Description of original monument and accessories and subsequent restorations:

Surveyed in 1865 by William E. Daugherty and Alex McDill
80.00 chains north between Sections 26 and 27
Set post
Linn 16, S78E, 47 lks.
Sugar 12, N27W, 29 lks.

Description of corner evidence found:

Fence corner, fences south and west
6 x 6 squared cedar post, scribed, 30 to 40 years old
From cedar post, S78E, 47 lks. two linn 16" and 17" diam growing from old linn stump.
From cedar post, N27W, 29 lks., Maple stump, maple stumps in area in rapid decay.

Description of monument and accessories I established to perpetuate the location of this corner:

Replaced 6 x 6 post with 2 inch inside diameter galvanized iron pipe 3 feet long filled with concrete, with brass cap stamped T39N, R14E, S22, S23, S27, S26, 1974, S-802

From which the following blazed and scribed new bearing trees bear
Maple 10, N70E, 36.92 ft.
Maple 11, S62E, 24.44 ft.
Maple 7, S74W, 17.29 ft.
Maple 5, N21W, 36.91 ft.
Set steel sign post 1 ft. NE of monument

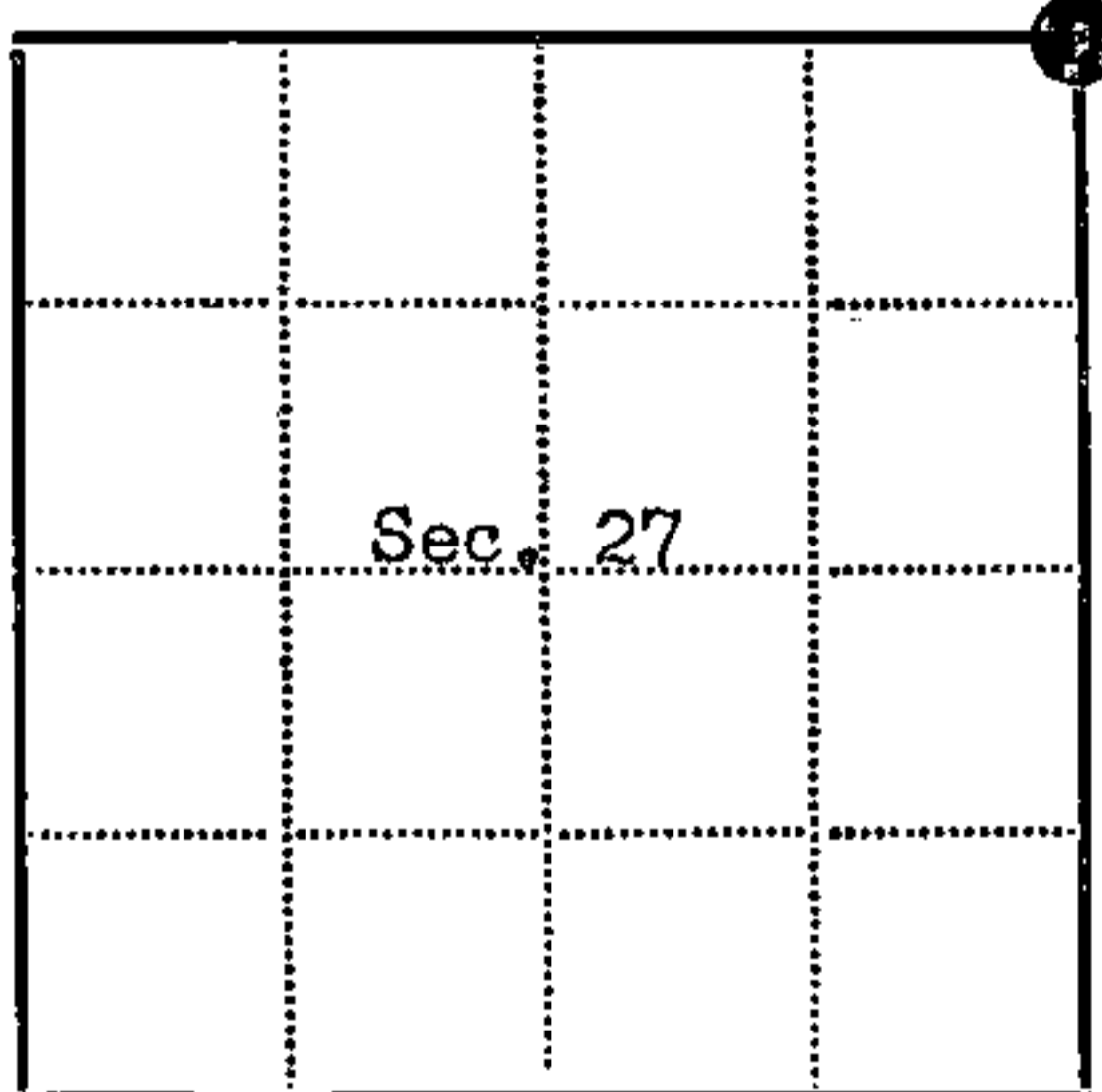
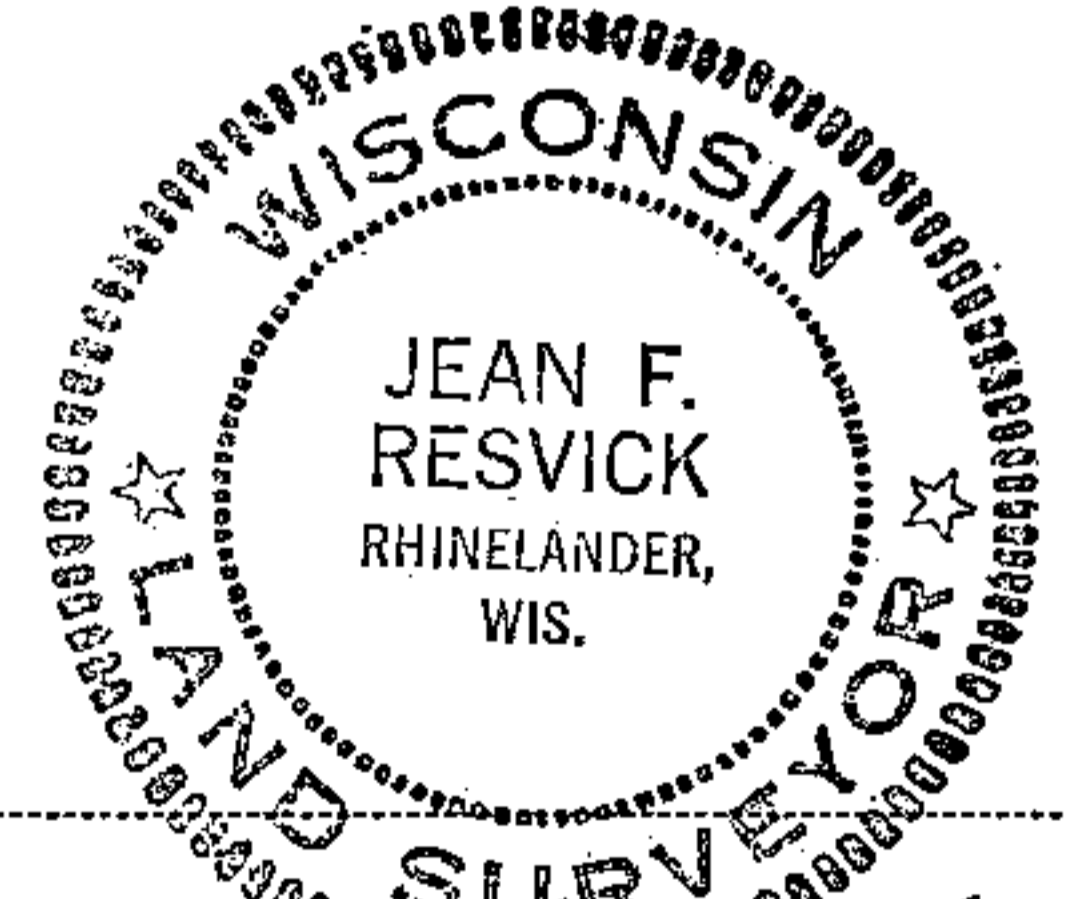

● = Corner monument restored
□ =

Resident witnesses.....

Dated at Rhinelander Wisconsin, this 5th day of March 1974.

Signature *Jean F. Resvick* Title Land Surveyor
(County Surveyor, Registered Land Surveyor, or other duly authorized official)

Surveyors Registration No. S-802 DOCUMENT Number 105103

Office of Register of Deeds County of Forest

I hereby certify that the within instrument was filed in this office for record on the 5th day of April 1974, and was filed in Book No. Page No. of County Records.

Signature *Eugene Stutzman* Title Register of Deeds

Township 39 North, Range 14 East, Section 27, Index No. R-17, Page No.

43914220000

R17