

CERTIFIED LAND CORNER RESTORATION

State of Wisconsin }
County of Forest } ss.

I William B. Cochrane, do hereby certify that on the 7 day of June, 1977, I found evidence of the East quarter corner of Section 8 Township 39 North, Range 14 East, Fourth Principal Meridian, as described hereon; and that from this evidence I established a new monument and accessories as described hereon to perpetuate the original location of this corner:

Description of original monument and accessories and subsequent restorations:

Surveyed in 1865 by William Daugherty
40.0 chains North between Sections 8 and 9, set post
Fir 10, S62W, 49 lks.
Fir 10, N81E, 36 lks.
10.00 chains North enter cedar swamp, bears East

Description of corner evidence found:

Chain North from section corner, 40 chains found wood post by tree
No evidence found of bearing trees.
Unable to determine where post was set, set corner position
a proportionate distance between section corners.

Description of monument and accessories I established to perpetuate the location of this corner:

At proportionate distance between section corners
set a 2 inch inside diameter, galvanized iron pipe, 3 feet long,
filled with concrete with a brass cap stamped:
T39N, R14E, 1/4, S8, S9, 1977, S-1107
Blazed and scribed the following new bearing trees
Hemlock 22, N65E, 18.23 ft.
Hemlock 21, S24W, 10.48 ft.
Set steel sign post 0.3 ft. east of monument.

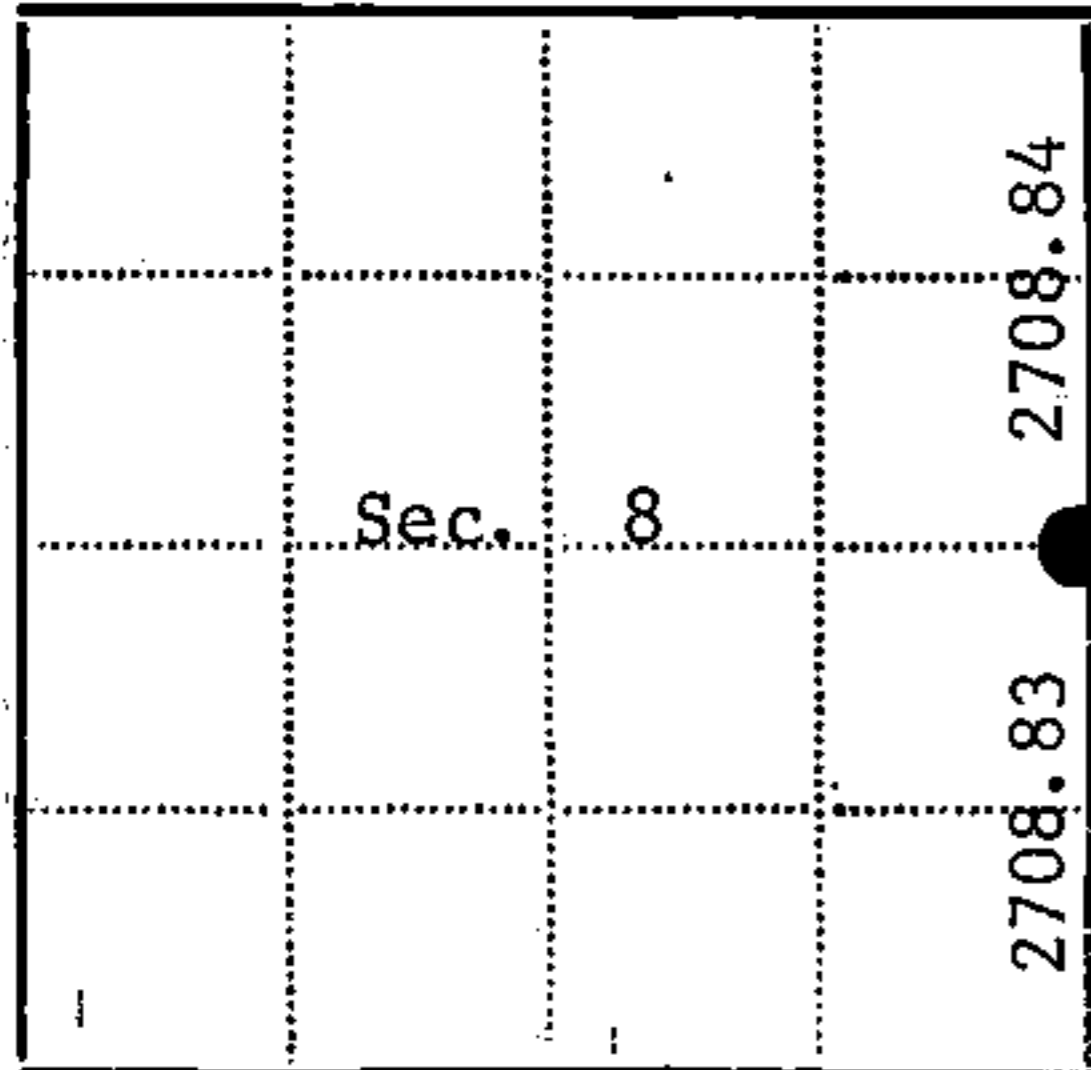
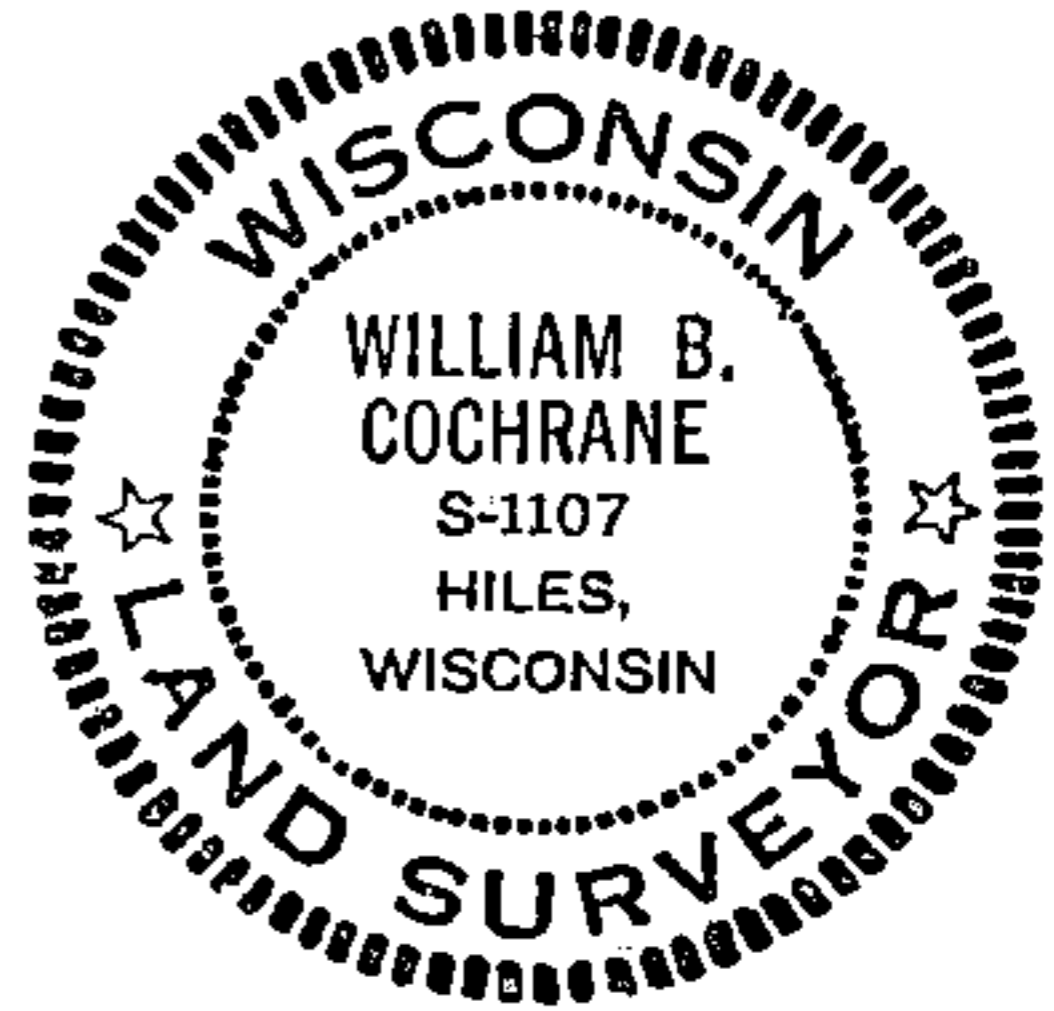

● - Corner monument restored
□ -

Resident witnesses.....

Dated at Laona Wisconsin, this 21 day of July 1977.

Signature William B. Cochrane Title Survey Technician
(County Surveyor, Registered Land Surveyor, or other duly authorized official)

Surveyors Registration No. S-1107 DOCUMENT NUMBER 113309

Office of Register of Deeds County of Forest

I hereby certify that the within instrument was filed in this office for record on the 13th day of February 1978, and was filed in Book No. Page No. of County Records.

Signature Eugene Stutzny Title Register of Deeds

Township 39 North, Range 14 East, Section 8, Index No. G-9, Page No.

43914082000

G
6

U.S. PUBLIC LAND SURVEY MONUMENT RECORD

Index No. G-9

State of Wisconsin }
County of Forest } ss.

I, William B. Cochrane, do hereby certify that on the 5th day of August, 1985, I found evidence of the East Quarter corner of Section 8 Township 39 North, Range 14 East, Fourth Principal Meridian, as described hereon; and that from this evidence I established a new monument and accessories as described hereon to perpetuate the original location of this corner.

Resident witnesses:

Tony Tillman

State Plane Co-ordinates
N- 260.578.8280
E-2,316,435.4100

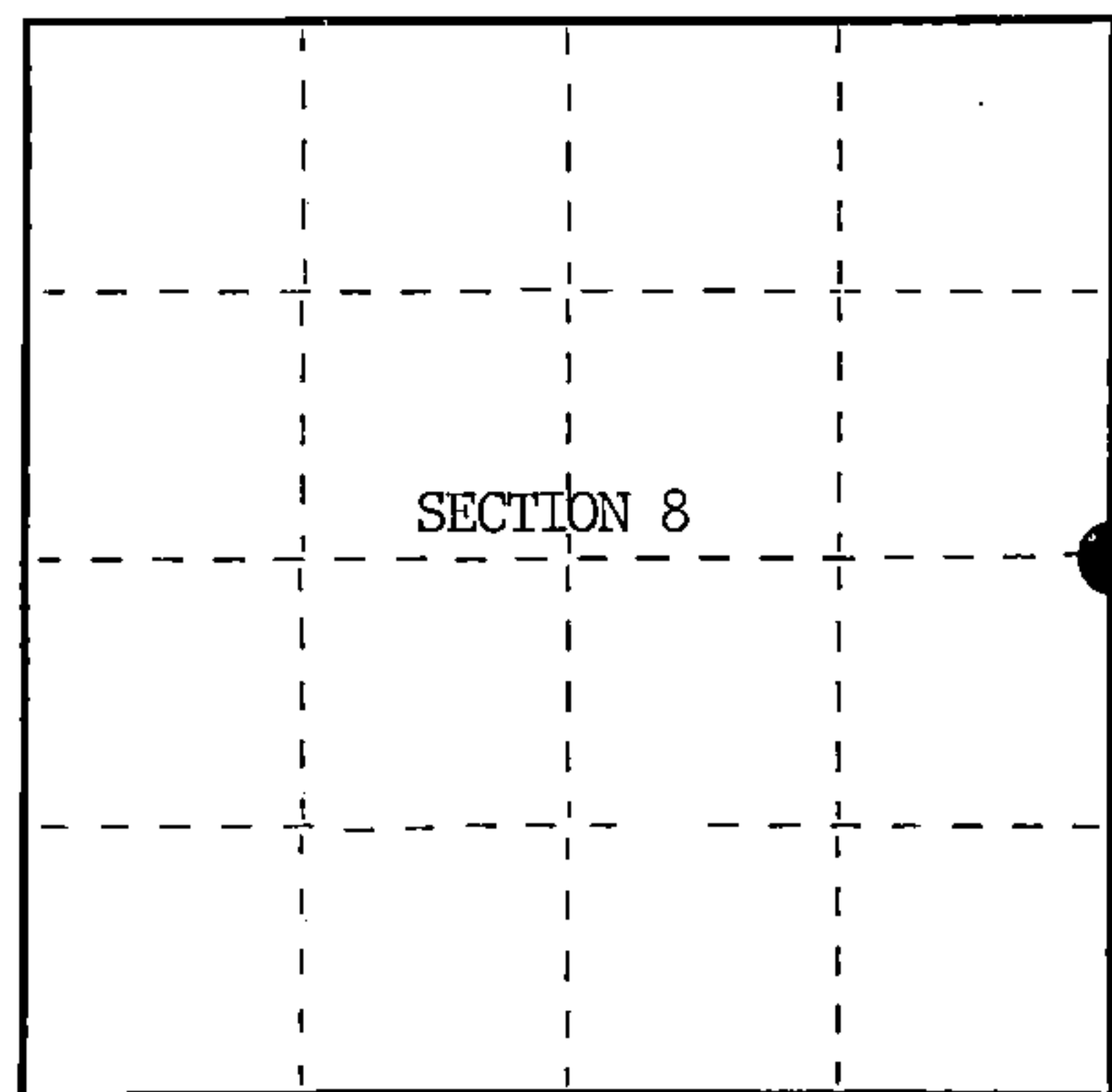

○ = Corner monument restored.

History of original corner establishment:

Original Government Survey in 1865 by William E. Daugherty and Alex McDill.

Corner restored on June 7th, 1977, by William B. Cochrane, a Registered Land Surveyor with the U.S. Forest Service.

See Certified Land Corner Restoration Certificate, #113309, filed in the Registrar of Deeds Office, in the Forest County Courthouse.

Description of corner evidence found:

Found monument as described and in place, from which the following bear;

Hemlock	22"	N65°E	18.23 feet
Hemlock	21"	S24°W	10.48 feet
Steel Sign Post		East	0.30 feet

All of the above bearing trees were cut down for the Aerial Photo Project.

Description of monument and accessories I established to perpetuate the original location of this corner.

Blazed and scribed the following new bearing trees;

Maple	8"	N57°W	70.76 feet
Maple	12"	S36°W	67.65 feet

Dated at Hiles, Wis., this 6th day of February, 1986

Signature William B. Cochrane Title Land Surveyor Registration No. S-1107
(County Surveyor, Registered Land Surveyor, or other duly authorized official)

Office of Register of Deeds, County of Forest, I hereby certify that the within instrument was filed in this office for record on the 11th day of March, 1987 at 3:30 o'clock P. M.

Paul Aschenbrenner
(Register of Deeds)

By Deputy

FORM NO. 985-A

H.C. Miller Company

Stock No. 26273

DOCUMENT NUMBER 132336

43914082000

(e) Describe any material discrepancy between the location of the corner as restored or reestablished and the location of that corner as previously restored or reestablished by distance and direction. Show the discrepancy on the plan view drawing under (d), above. Show the distances between the corner as previously restored or reestablished and (1) the corner as restored or reestablished, and (2) to at least 2 of the witness monuments shown on the drawing in (d), above.

See drawing below.

(f) Was the corner restored through acceptance of (1) an obliterated evidence location, or, (2) a found perpetuated location?

Restored through acceptance of a found perpetuated location.

(g&h) Was the corner reestablished through lost corner proportionate methods? If so, show the method, including the directions and distances to other public land survey corners used as evidence or used for proportioning in determining the corner location?

8" Maple (New bearing tree)
N57°W, 70.76 feet

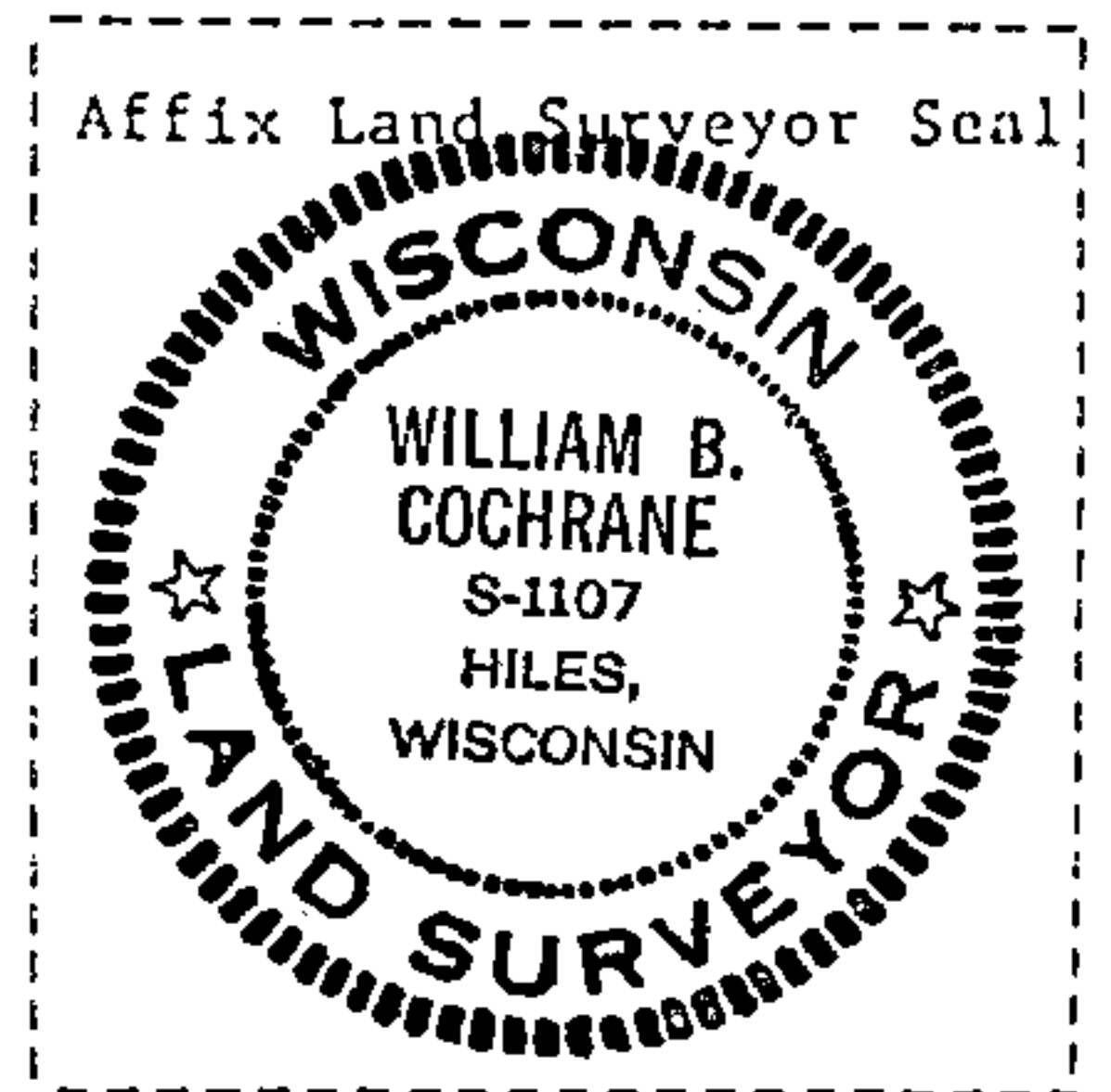
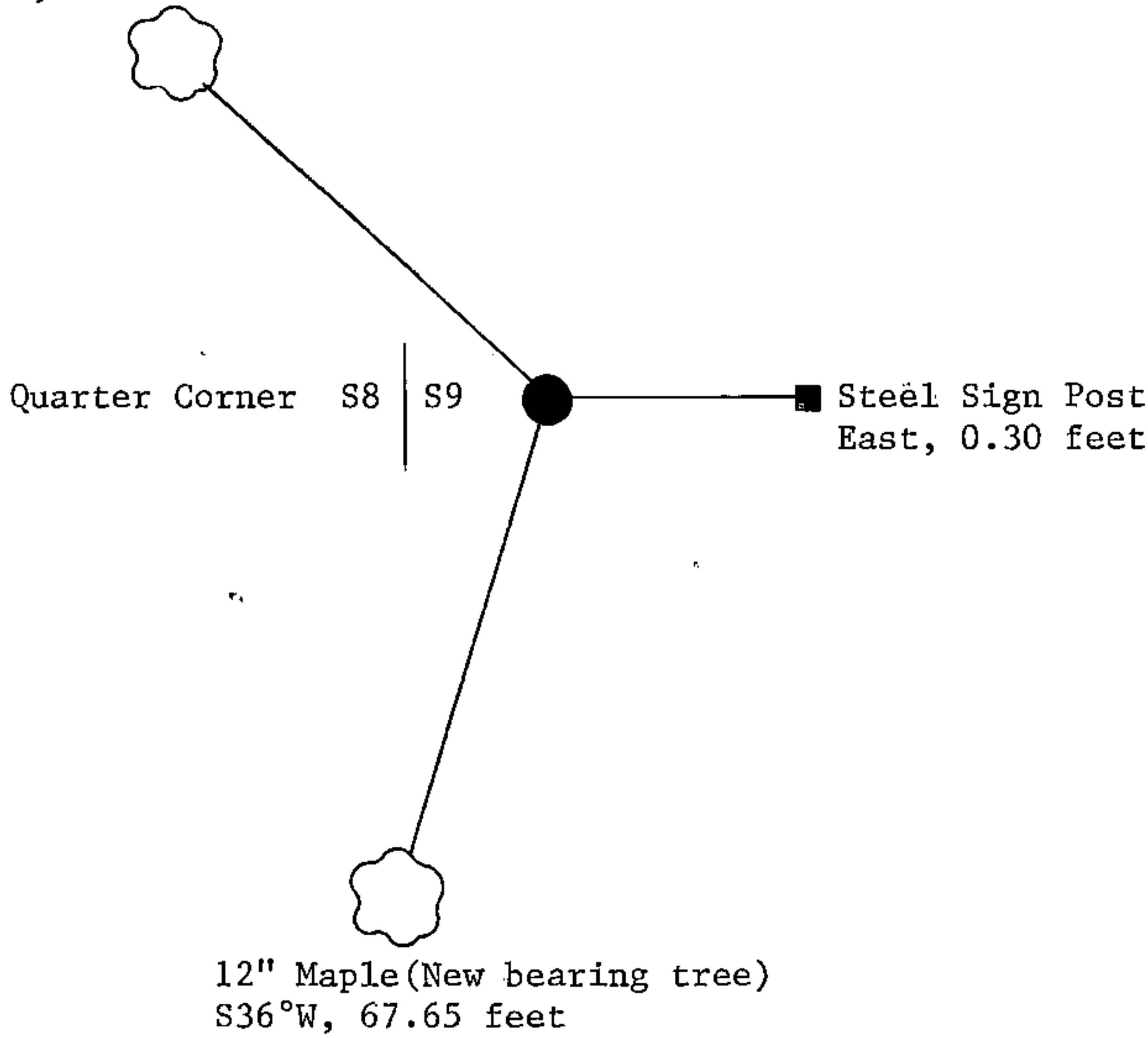

(i) William B. Cochrane
(type or print name) certify that the corner location shown on this record was determined by me or under my direction and control and that this U.S. Public Land Survey Monument Record is correct and complete to the best of my knowledge and belief.

William B. Cochrane October 7, 1986
Signature Date

Survey requested by: [Signature] 3-9-87
District Ranger Date