

CERTIFIED LAND CORNER RESTORATION

State of Wisconsin }
County of Forest } ss.

I William B. Cochrane, do hereby certify that on the 7th day of May, 1974, I found evidence of the East Quarter corner of Section 6 Township 39 North, Range 14 East, Fourth Principal Meridian, as described hereon; and that from this evidence I established a new monument and accessories as described hereon to perpetuate the ~~original~~ location of this corner:

Description of original monument and accessories and subsequent restorations:

Surveyed in 1865 by Wm. E. Daugherty.
South corrected between Sections 5 and 6. 39.46 chains set quarter section post.
Cedar, 9", N.18°W, 60 lks.
Cedar, 12", S43°E, 16 lks.
9.0 chains north, leave swamp, bears E & W

Description of corner evidence found:

6 x 6 scribed cedar post tipped over. From the post hole a scribed cedar, 7", S45°E, 20 lks., a scribed cedar, 8", bears N25°W, 10 lks. This post and bearing trees were set by an unknown surveyor, about 40 years ago.
This position is 39.5 chains south of the township corner. 6.5 chains north leave swamp. South 40.0 chains found the section corner common to sections 5, 6, 7 and 8.

Description of monument and accessories I established to perpetuate the location of this corner:

I replaced the post with a 2 inch inside diameter, galvanized pipe, 5 feet long, filled with concrete with a brass cap stamped: T39N, R14E, 1/4, S5, S6, 1975, S-1107.
From which the following bear:
Cedar, 9", S82°E, 22.38 feet (new bearing tree)
Cedar, 7", S45°E, 13.42 feet (bearing tree found. Tree is dead.)
Cedar, 8", N25°W, 7.02 feet (bearing tree found)
Set a steel sign post, south of the monument, 0.50 feet.

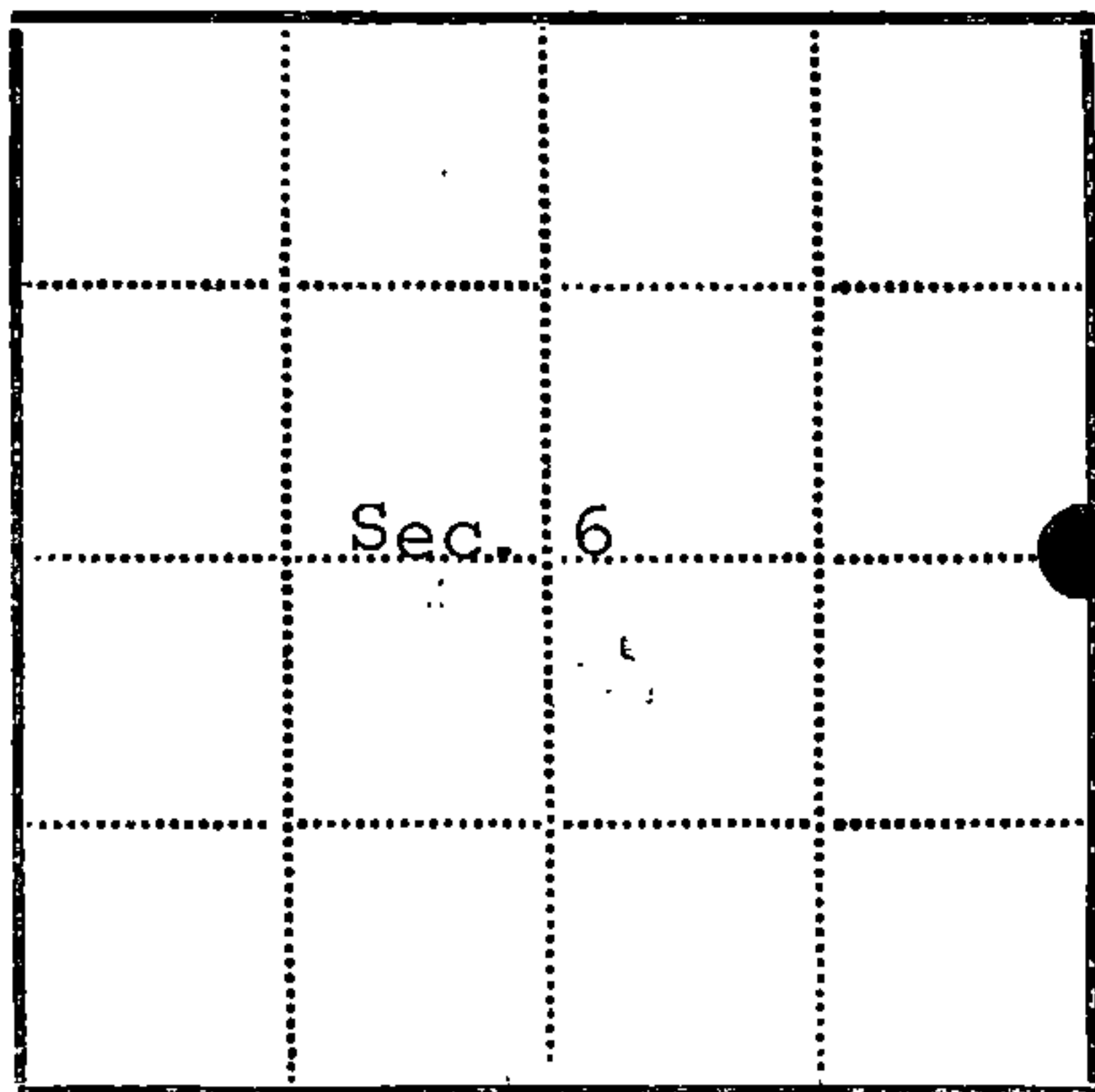
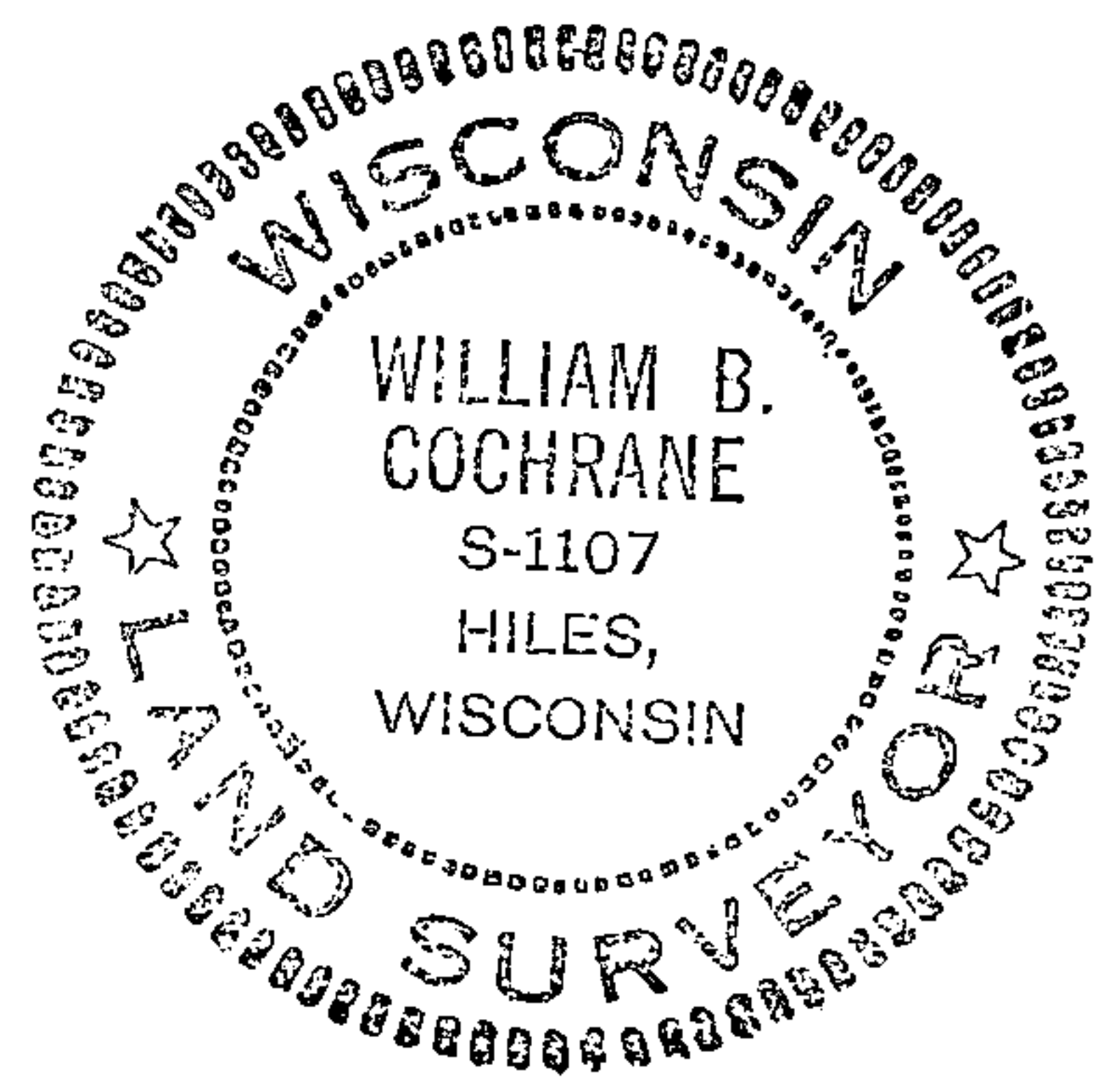

● = Corner monument restored
□ =

Resident witnesses.....

Dated at Three Lakes Wisconsin, this 12th day of June 1975.

Signature William B. Cochrane Title Survey Technician
(County Surveyor, Registered Land Surveyor, or other duly authorized official)

Surveyors Registration No. S-1107 DOCUMENT NUMBER 107230

Office of Register of Deeds County of Forest

I hereby certify that the within instrument was filed in this office for record on the 16th day of June 1975, and was filed in Book No. Page No. of County Records.

Signature Eugene Stutz Title Register of Deeds

Township 39 North, Range 14 East, Section 6, Index No. C-5, Page No.

43914 062000

65

U.S. PUBLIC LAND SURVEY MONUMENT RECORD

Index No. C-5

State of Wisconsin }
County of Forest } ss.

I, William B. Cochrane, do hereby
certify that on the 30th day
of July, 1985, I found
evidence of the East Quarter
corner of Section 6
Township 39, North, Range
14 East, Fourth Principal Meridian,
as described hereon; and that from this evidence
I established a new monument and accessories
as described hereon to perpetuate the original
location of this corner.

Resident witnesses:

Tony Tillman

State Plane Co-ordinates
N- 265,761.1500
E-2,311,159.2500

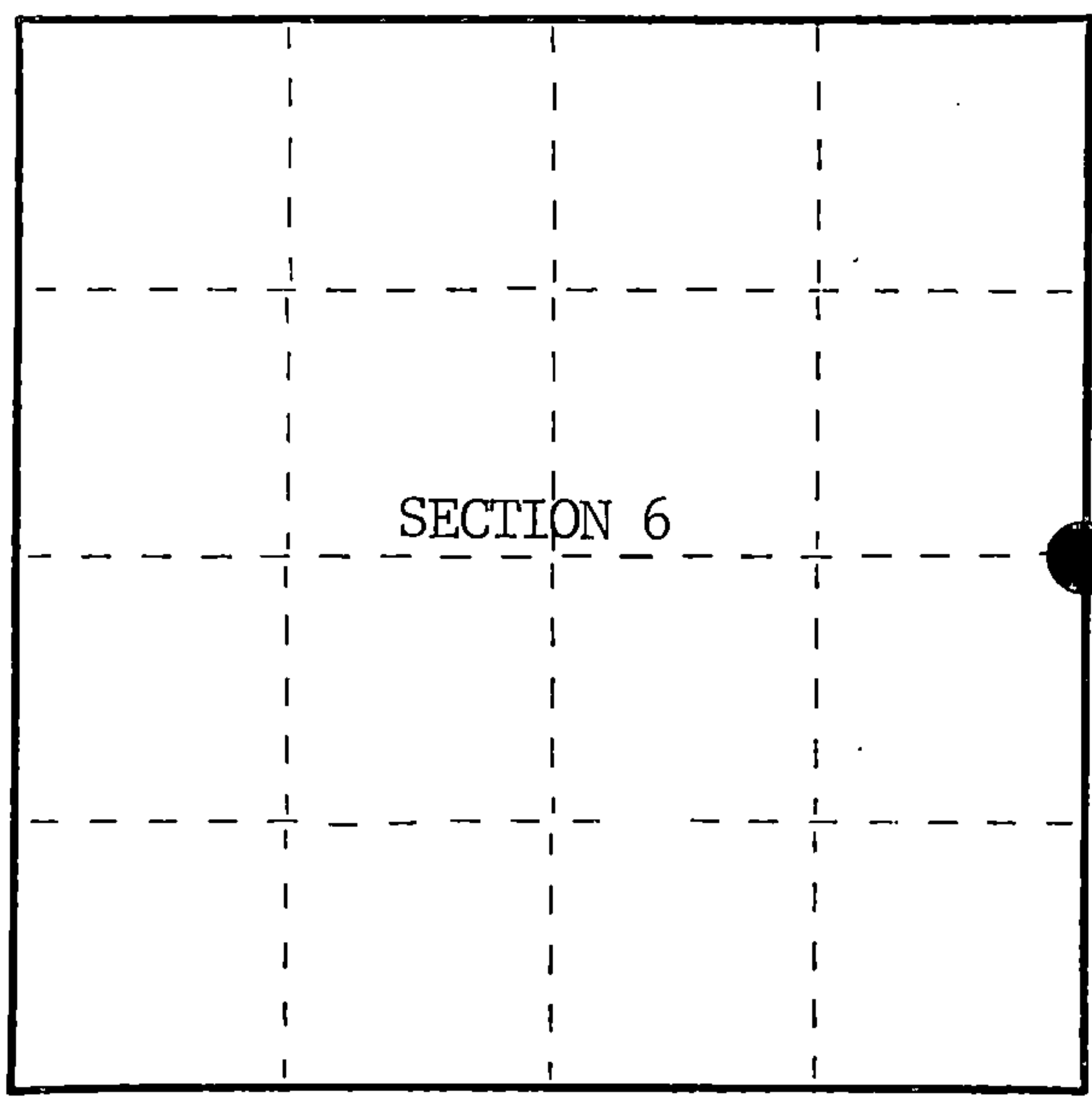

○ = Corner monument restored.

History of original corner establishment:

Original Government Survey in 1865 by William E. Daugherty and Alex McDill.

Corner restored on May 7th, 1974, by William B. Cochrane, a Registered
Land Surveyor with the U.S. Forest Service.

See Certified Land Corner Restoration Certificate #107230, filed in the
Registrar of Deeds Office, in the Forest County Courthouse.

Description of corner evidence found:

Found monument as described and in place, from which the following bear;

Cedar	9"	S82°E	22.38 feet
Cedar (Dead)	7"	S45°E	13.42 feet
Cedar	8"	N25°W	7.02 feet
Steel Sign Post		South	0.50 feet

Description of monument and accessories I established to perpetuate the original location of this corner.

Blazed and scribed the following new bearing trees;

Cedar	12"	N 4°W	69.24 feet
Cedar	12"	S41°W	55.03 feet

Re-set Steel Sign Post SE 0.50 feet

Dated at Hiles, Wis., this 23rd day of February, 1986

Signature William B. Cochrane Title Land Surveyor Registration No. S-1107
(County Surveyor, Registered Land Surveyor, or other duly authorized official)

Office of Register of Deeds, County of Forest, I hereby certify that the within
instrument was filed in this office for record on the 11th day of March, 1987
at 3:30 o'clock P. M.

Paul Aschenbrenner
(Register of Deeds)

By Deputy

FORM NO. 985-A
H.C. Miller Company
MILWAUKEE, WISCONSIN

Stock No. 26273

DOCUMENT NUMBER 132318

43914062000

(e) Describe any material discrepancy between the location of the corner as restored or reestablished and the location of that corner as previously restored or reestablished by distance and direction. Show the discrepancy on the plan view drawing under (d), above. Show the distances between the corner as previously restored or reestablished and (1) the corner as restored or reestablished, and (2) to at least 2 of the witness monuments shown on the drawing in (d), above.

See drawing below.

(f) Was the corner restored through acceptance of (1) an obliterated evidence location, or, (2) a found perpetuated location?

Restored through acceptance of a found perpetuated location.

(g&h) Was the corner reestablished through lost corner proportionate methods? If so, show the method, including the directions and distances to other public land survey corners used as evidence or used for proportioning in determining the corner location?

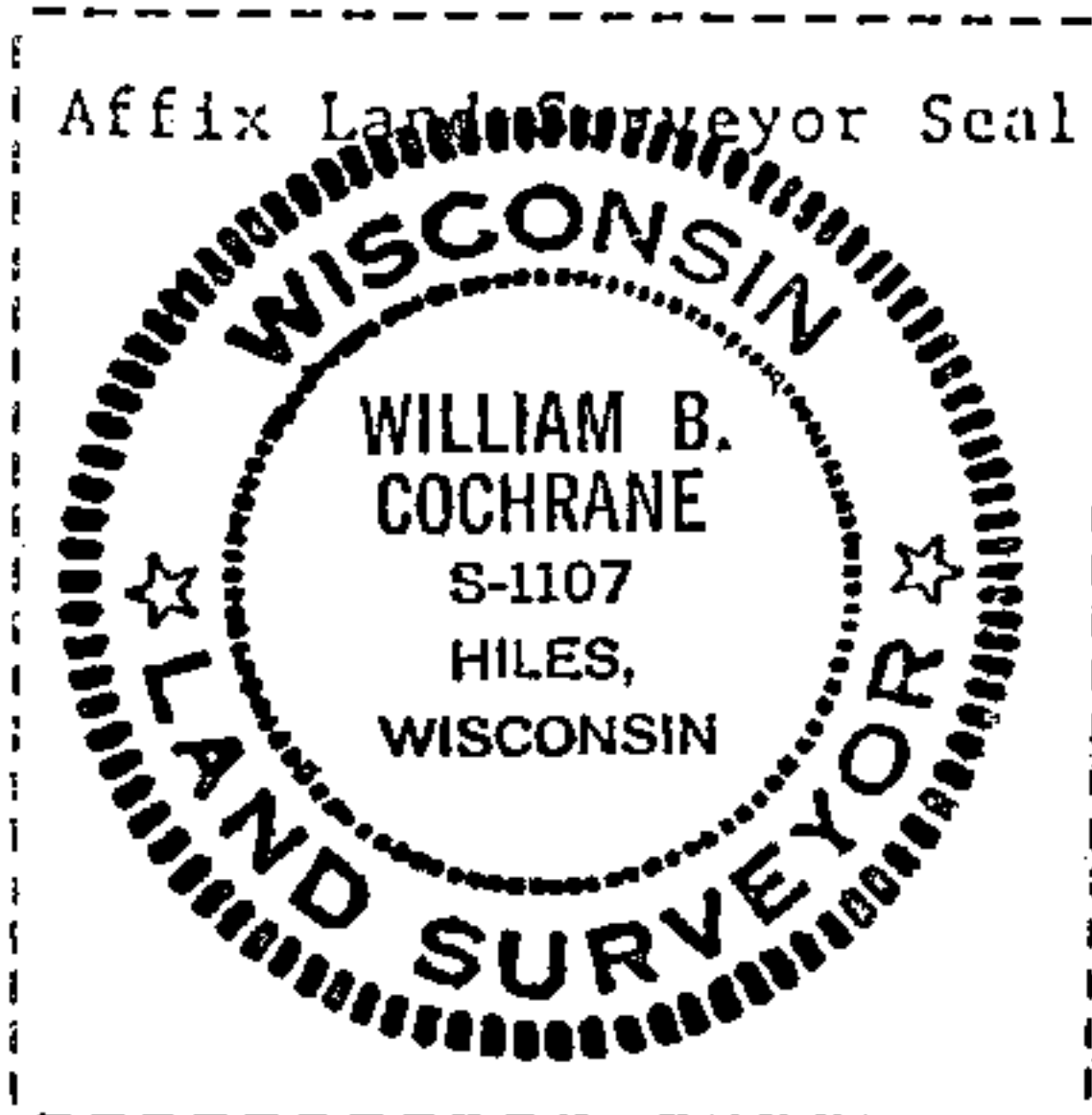
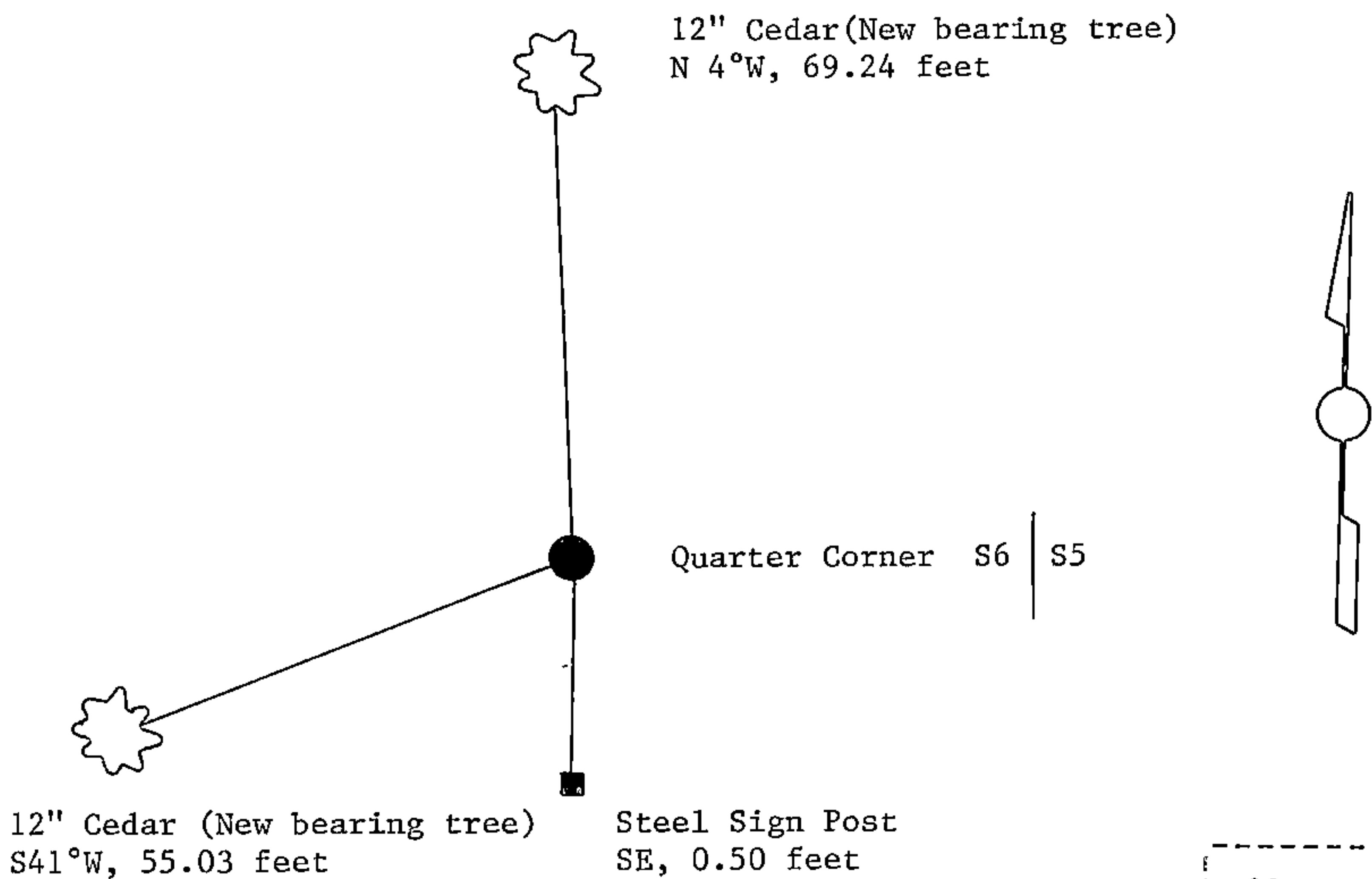

(i) I, William B. Cochrane
(type or print name) certify that the corner location shown on this record was determined by me or under my direction and control and that this U.S. Public Land Survey Monument Record is correct and complete to the best of my knowledge and belief.

William B. Cochrane October 7, 1986
Signature Date

Survey requested by; Edward Seeger 3-9-87
District Ranger Date