

Stock No. 26273

156580

State of Wisconsin

County of Forest

ss.

I, William B. Cochrane, do hereby  
 certify that on the 2<sup>nd</sup> day  
 of August, 1994, I found  
 evidence of the West Quarter  
 corner of Section 28  
Township 39, North, Range  
13 East, Fourth Principal Meridian,  
 as described hereon; and that from this evidence  
 I established a new monument and accessories  
 as described hereon to perpetuate the original  
 location of this corner.

Resident witnesses:

.....  
 .....  
 .....

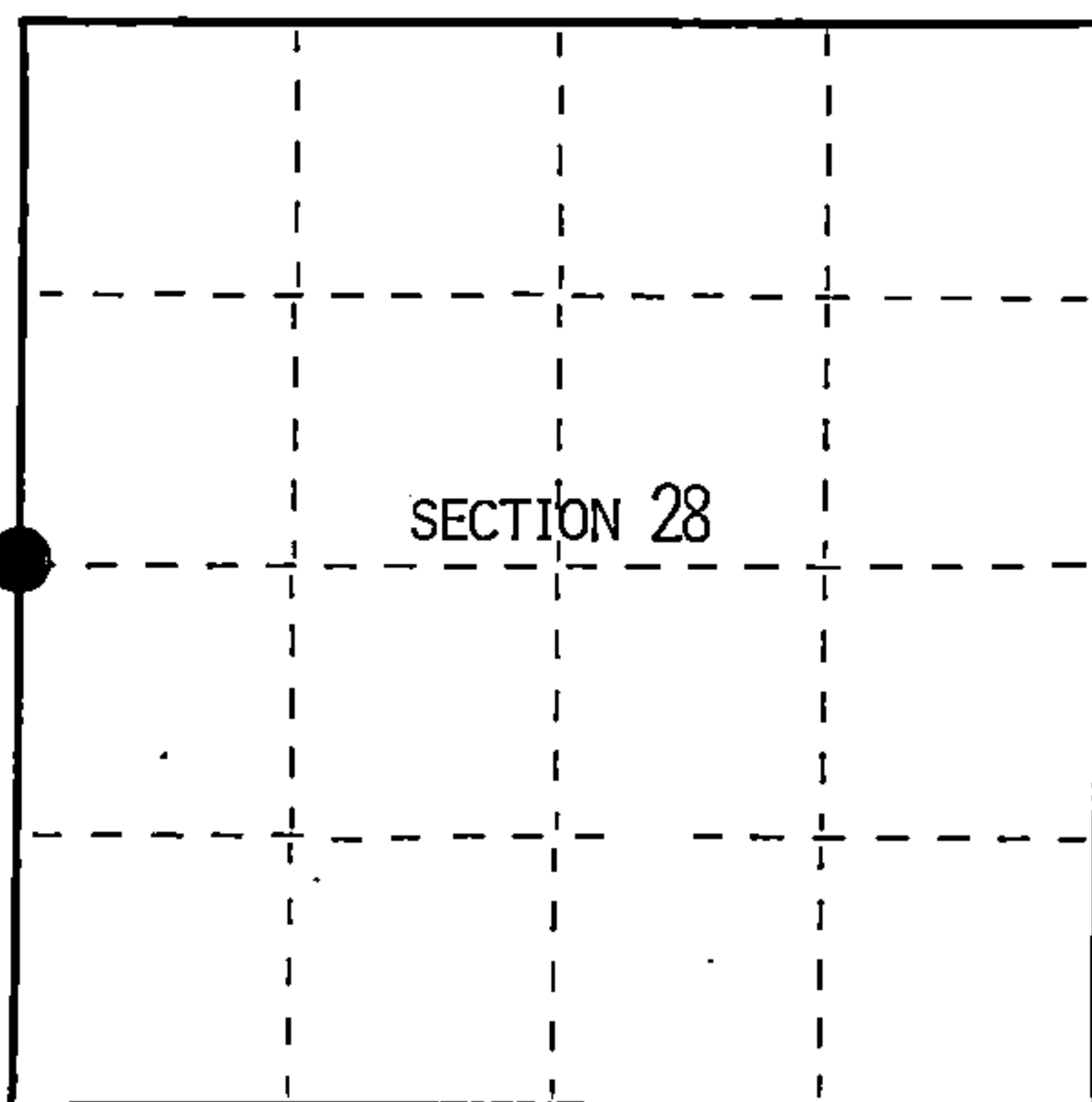

● = Corner monument restored.

## CERTIFIED LAND CORNER RESTORATION

Index No. T-9

## History of original corner establishment:

Original Government Survey by William E. Daugherty in 1865.  
 North between sections 28 and 29 at 40 chains set post. from which:  
 Sugar 12" S75°E 30 lks  
 Sugar 15" N88°W 22 lks

## Description of corner evidence found:

No original corner evidence found, no other corner evidence found.

Re-establish the corner position at proportionate distance and on line between the  
 Northwest and Southwest section corners of section 28.

## Description of monument and accessories I established to perpetuate the original location of this corner.

At the corner position, set a 2½"X36" aluminum pipe monument 2½ feet in the ground  
 with an aluminum cap stamped: T39N, R13E, 1/4, S28, S29, 1994 S-1107. From which:

Aspen	4"	N11°E	19.48 feet
Aspen	4"	N76°W	22.15 feet
Steel sign post		South	1.00 feet

Dated at Hiles, Wis., this 20<sup>th</sup> day of December, 1994

Signature William B. Cochrane Title Land Surveyor Registration No. S-1107  
 (County Surveyor, Registered Land Surveyor, or other duly authorized official)

Office of Register of Deeds, County of Forest, I hereby certify that the within  
 instrument was filed in this office for record on the 23<sup>rd</sup> day of August, 1994  
 at 2:30 o'clock P M.

(Register of Deeds)

By Paul Jenkins Deputy

43913292000

a) Describe any material discrepancy between the location of the corner as restored or reestablished and the location of that corner as previously restored or reestablished by distance and direction. Show the discrepancy on the plan view drawing under (d), above. Show the distances between the corner as previously restored or reestablished and (1) the corner as restored or reestablished, and (2) to at least 2 of the witness monuments shown on the drawing in (d), above.

See drawing below.

(f) Was the corner restored through acceptance of (1) an obliterated evidence location, or, (2) a found perpetuated location?

Re-established through lost corner proportionate methods.

(gkh) Was the corner reestablished through lost corner proportionate methods? If so, show the method, including the directions and distances to other public land survey corners used as evidence or used for proportioning in determining the corner location?

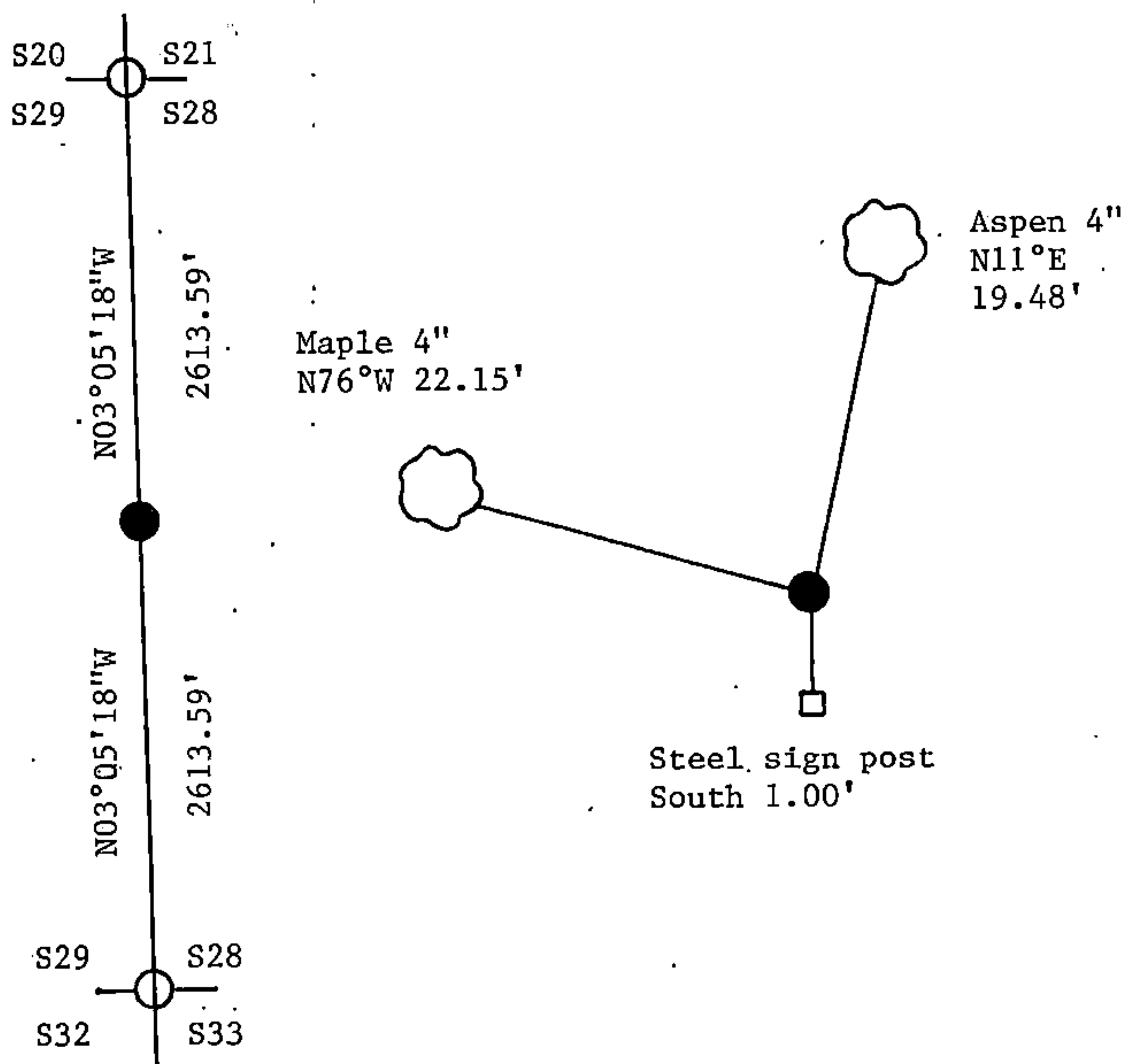

William B. Cochrane

(i) I, William B. Cochrane (type or print name) certify that the corner location shown on this record was determined by me or under my direction and control and that this U.S. Public Land Survey Monument Record is correct and complete to the best of my knowledge and belief.

Signature

Date

Survey requested by:

District Ranger

Date

