

CERTIFIED LAND CORNER RESTORATION

State of Wisconsin

County of Forest

SS.

I, Jean F. Resvick, do hereby certify that on the 14th day of August, 1972, I found evidence of the Northwest Section corner of Section 3 Township 37 North, Range 15 East, Fourth Principal Meridian, as described hereon; and that from this evidence I established a new monument and accessories as described hereon to perpetuate the original location of this corner:

Description of original monument and accessories and subsequent restorations:

Surveyed in 1857 by Artemas Curtis. 80.0 chains West between Sections 3 and 34 and set post.

Sugar 14, bears N13W, 50 lks.
 Elm, 12, bears N 6E, 15 lks.
 Sugar 16, bears S56E, 44 lks.
 Sugar 14, bears S55W, 40 lks.

Description of corner evidence found:

Point of old wood post from which:

Sugar stump bears N13W, 50 lks.

Elm stump, 24", recently cut, bears N6E, 15 lks. No scribing visible center is rotten

Sugar stump hole, bears S56E, 44 lks.

Sugar stump hole, bears S55W, 40 lks.

1/2 in. diam. steel pipe bears S15E, 1.5 lks.

Description of monument and accessories I established to perpetuate the original location of this corner:

Replaced post point found with a 2 inch inside diameter, galvanized wrought iron pipe, 5 feet long, filled with concrete with a brass cap stamped:

T38N R15E

S33 | S34
 S4 | S3
 T37N
 1972
 S-802

From which the following blazed and scribed new bearing trees bear:

Maple, 5", N83E, 20.96 feet
 Hemlock 14", S9E, 25.24 feet
 Hemlock 8", S76W, 28.14 feet
 Maple, 5", N73W, 9.18 feet
 Iron post, SW, 1.0 feet

Resident witnesses

Dated at Rhinelanders Wisconsin, this 26th day of September 1972.

Signature *Jean F. Resvick* Title Land Surveyor
 (County Surveyor, Registered Land Surveyor, or other duly authorized official)

Surveyors Registration No. S-802

Office of Register of Deeds County of Forest

I hereby certify that the within instrument was filed in this office for record on the 18th day of October 9:30 AM 1972, and was filed in Book No. I Page No. A-13 of County Records.

Signature *Eugene Stetson* Title Register of Deeds

Township 37 North, Range 15 East, Section 3, Index No. A-13, Page No.

43815330000

DOCUMENT NUMBER 102403

A 13

U.S. PUBLIC LAND SURVEY MONUMENT RECORD

Index No. **A-13**

State of Wisconsin }
County of Forest } ss.

I William B. Cochran, do hereby
certify that on the 27th day
of February, 1985, I found
evidence of the Northeast Section
corner of Section 4
Township 37, North, Range
15 East, Fourth Principal Meridian,
as described hereon; and that from this evidence
I established a new monument and accessories
as described hereon to perpetuate the original
location of this corner.

Resident witnesses:

David Brownell

History of original corner establishment:
Original Government Survey in 1857 by Artemas Curtis. In 1972, Jean Resvick, a Land
Surveyor with the U.S. Forest Service, found a post point in concurrence with original
B.T. evidence. In place of post point, set a 2" diameter galvanized iron pipe, 5 feet
long, with a brass cap stamped: T38N R15E, S3, S4, S33, S34, T37N, 1972, S-802. From
which the following bear:
Maple 5" N83°E 20.96 feet
Hemlock 14" S 9°E 25.24 feet
Hemlock 8" S76°W 28.14 feet
Maple 5" N73°W 9.18 feet Iron sign post, SW, 1.00 feet

Description of corner evidence found:
Monument as described and in place, from which the following bear:
Maple 6" N83°E 20.96 feet
Hemlock 15" S 9°E 25.24 feet
Hemlock 8" S76°W 28.14 feet
Maple 9" N73°W 9.18 feet
Iron Sign post SW 1.00 feet

Description of monument and accessories I established to perpetuate the original location of this corner.
None

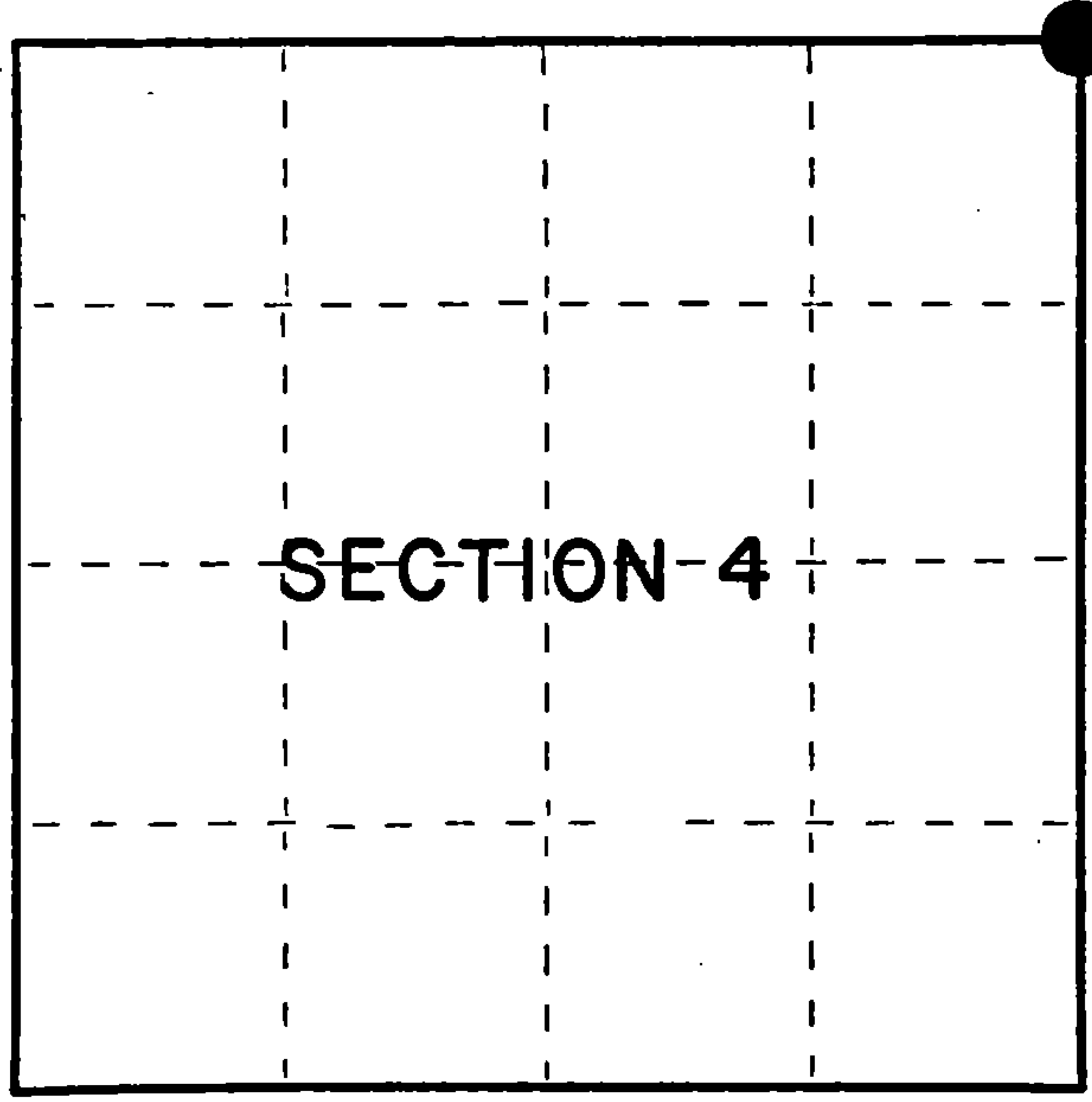

○ = Corner monument restored.

Dated at Hiles, Wis., this 12th day of March, 1985
Signature William B. Cochran Title Land Surveyor Registration No. S-1107
(County Surveyor, Registered Land Surveyor, or other duly authorized official)
Office of Register of Deeds, County of Forest, I hereby certify that the within
instrument was filed in this office for record on the 24th day of April, 1985
at 1:00 o'clock P. M.
Paul Aschenbrenner
(Register of Deeds)

By _____ Deputy

FORM NO. 985-A
H.C. Miller Company
Stock No. **26273**
Document Number **127866**

43815330000

(e) Describe any material discrepancy between the location of the corner as restored or reestablished and the location of that corner as previously restored or reestablished by distance and direction. Show the discrepancy on the plan view drawing under (d), above. Show the distances between the corner as previously restored or reestablished and (1) the corner as restored or reestablished, and (2) to at least 2 of the witness monuments shown on the drawing in (d), above.

See drawing below.

(f) Was the corner restored through acceptance of (1) an obliterated evidence location, or, (2) a found perpetuated location?

Restored through acceptance of a found perpetuated location.

(g&h) Was the corner reestablished through lost corner proportionate methods? If so, show the method, including the directions and distances to other public land survey corners used as evidence or used for proportioning in determining the corner location?

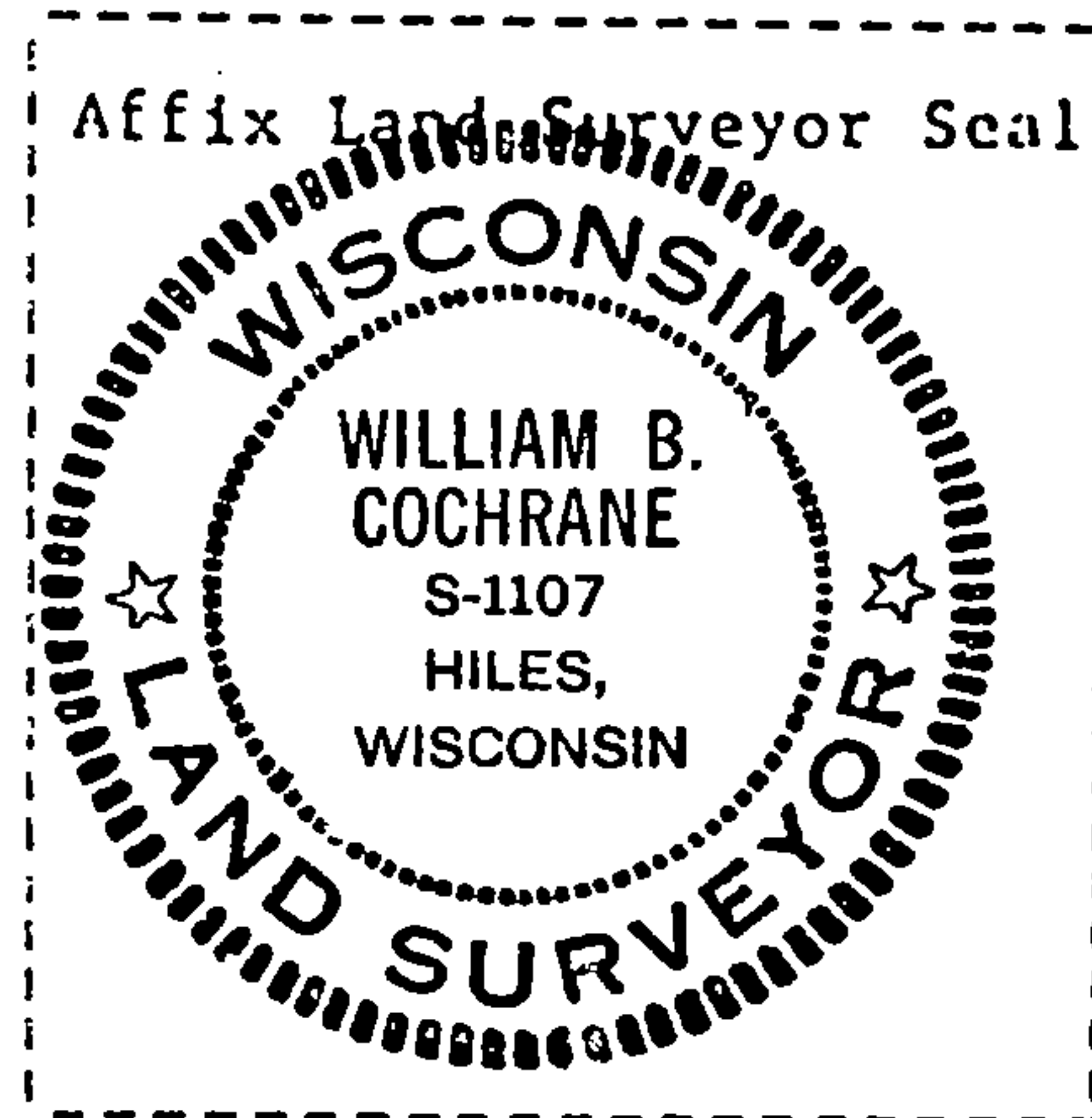
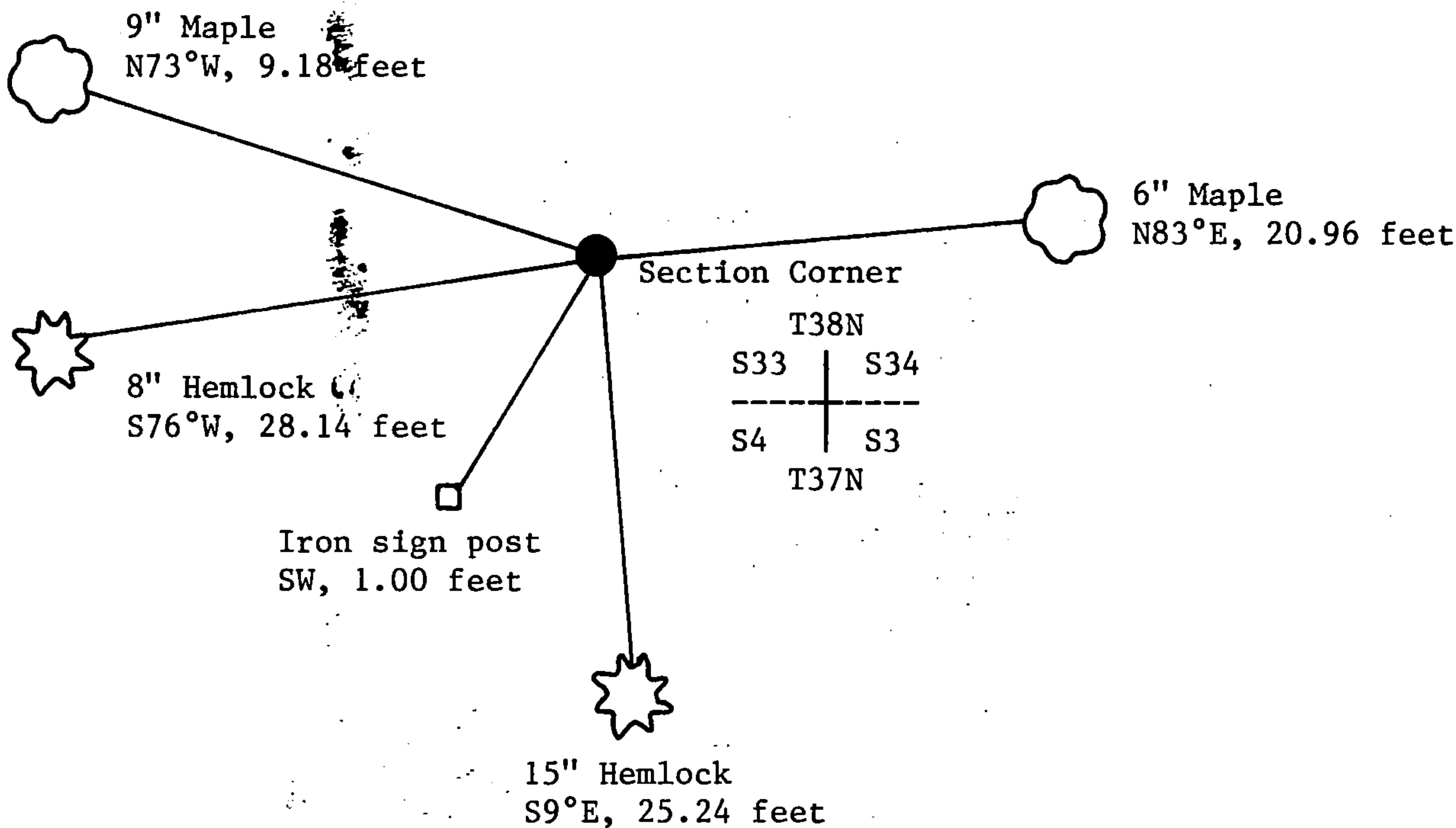

(i) I, William B. Cochrane
(type or print name) certify that the corner location shown
on this record was determined by me or under my direction and
control and that this U.S. Public Land Survey Monument Record is
correct and complete to the best of my knowledge and belief.

William B. Cochrane March 18, 1985
Signature Date