

CERTIFIED LAND CORNER RESTORATION

Index No. S-4  
**S 4**

State of Wisconsin }  
County of Forest } ss.

I, Glen Barker, do hereby  
certify that on the 8th day  
of January, 1985, I found  
~~evidence of the~~ NE 1/16  
corner of Section 30  
Township 38, North, Range  
14 East, Fourth Principal Meridian,  
as described hereon; and that from this evidence  
I established a new monument and accessories  
as described hereon to perpetuate the original  
location of this corner.

Resident witnesses:

N. Spiess  
R. Lundt

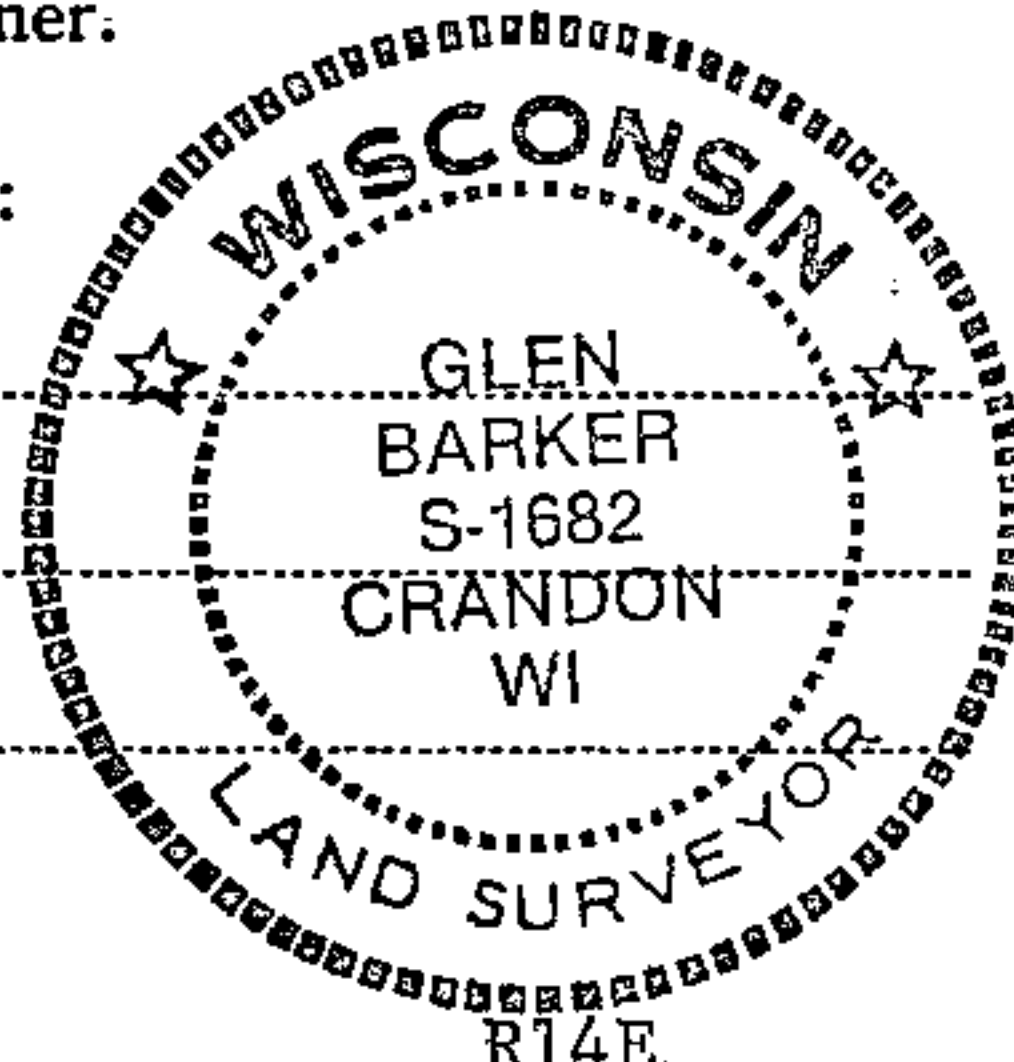

T38N

R14E

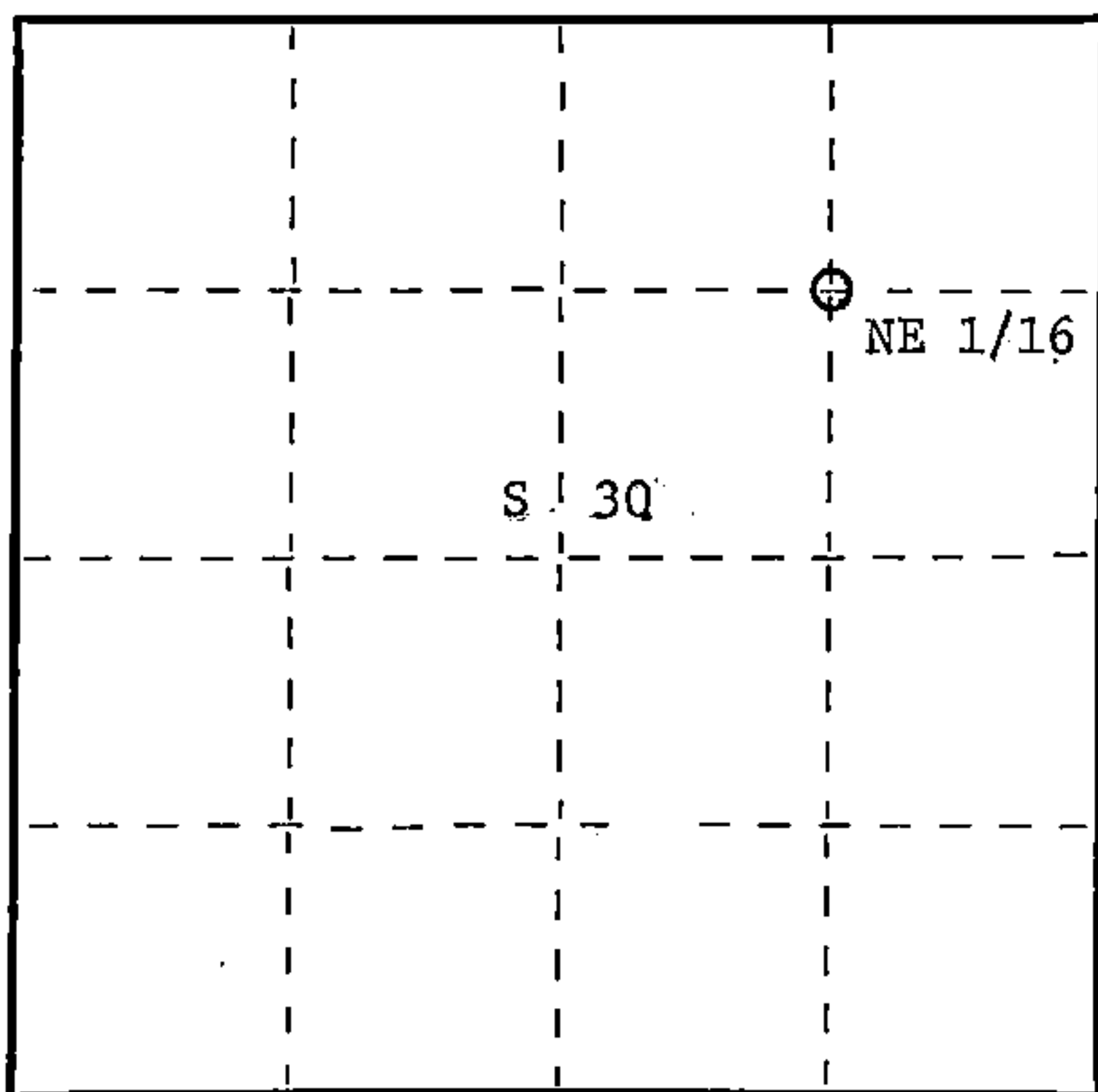

○ = Corner monument restored.

History of original corner establishment:

No evidence of any previous corner.

Description of corner evidence found:

Corner established by subdivision of NE 1/4 Section 30.  
Location of NE 1/16 is 1300.46' of NC 1/16 and 1311.85' of EC 1/16.

Description of monument and accessories I established to perpetuate the original location of this corner.

Set a 1" iron pipe with 2" diameter alloy cap stamped:	S1682
Monument projects 18" above ground.	T38N
Marked NBTs:	
Cedar 5" N45W 12.43'	NE 1/16 S 30
Cedar 10" S20E 46.34'	
	R14E
	CPI - 1985

Dated at Wineland, Wis., this 6th day of February, 1985.

Signature Glen Barker Title Registered Land Surveyor Registration No. 1682  
(County Surveyor, Registered Land Surveyor, or other duly authorized official)

Office of Register of Deeds, County of Forest, I hereby certify that the within  
instrument was filed in this office for record on the 22nd day of February, 1985  
at 2:15 o'clock P. M.

Paul Aschenbrenner  
(Register of Deeds)

By \_\_\_\_\_ Deputy

Document Number **127514**

FORM 985 H. C. MILLER CO., MILWAUKEE

43814303010