

CERTIFIED LAND CORNER RESTORATION

State of Wisconsin }
County of Forest } ss.

I, Jean F. Resvick, do hereby certify that on the 18th day of August, 1967, I found evidence of the West quarter corner of Section 21 Township 38 North, Range 14 East, Fourth Principal Meridian, as described hereon; and that from this evidence I established a new monument and accessories as described hereon to perpetuate the original location of this corner:

Description of original monument and accessories and subsequent restorations:

Surveyed in 1865 by James L. Nowlin.
Set post for quarter corner between Sections 20 and 21

Tamarack 8, N21°W, 23 lks.
Tamarack 8, S87E, 20 lks.

Description of corner evidence found:

Squared cedar post.
Squared spruce post on north side of cedar post.
Tamarack stump, scribed bears S87°E, 13.20 ft. from cedar post.
Tamarack stump, bears N21°W, 15.2 ft. from cedar post.

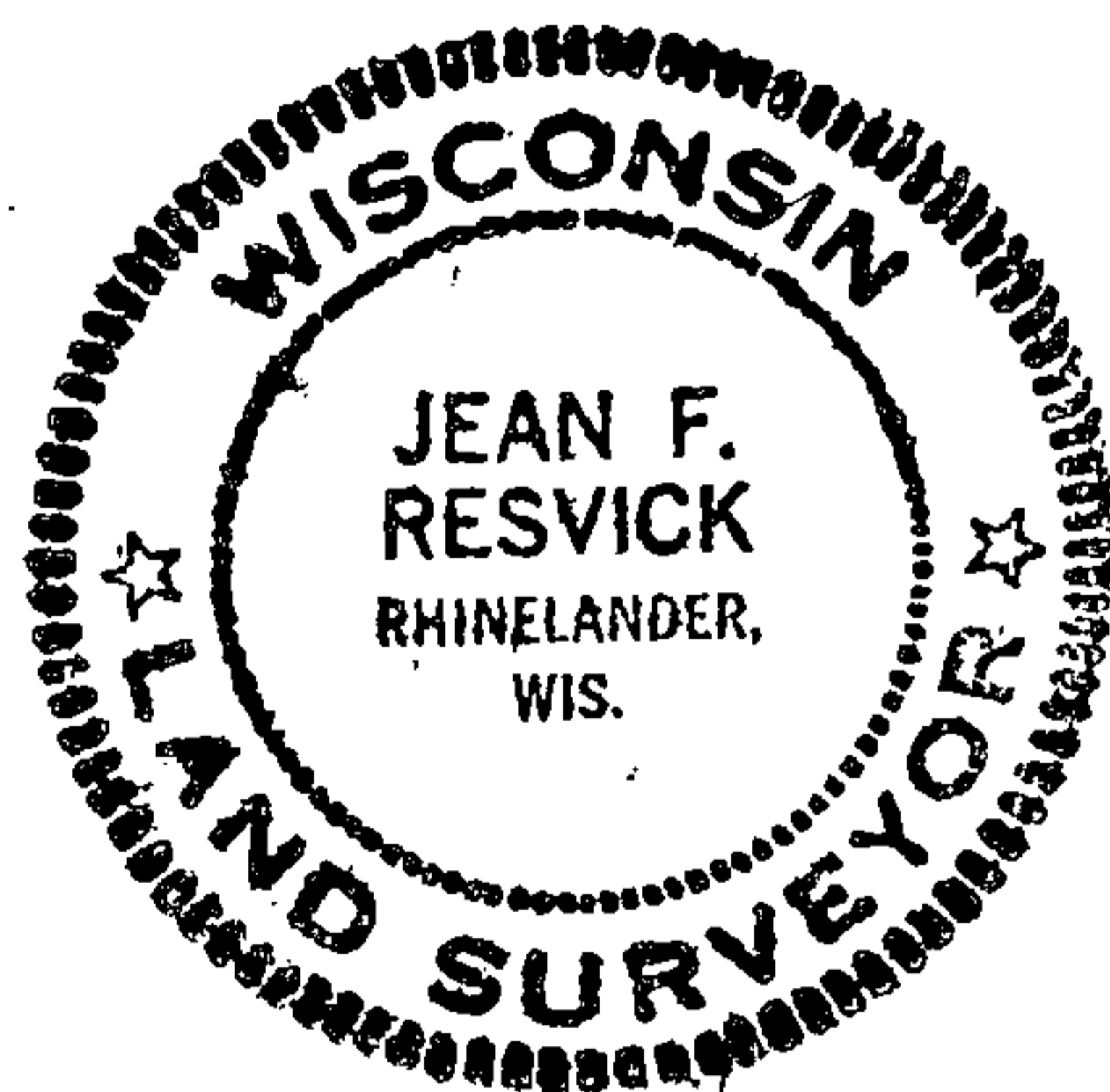

Description of monument and accessories I established to perpetuate the original location of this corner:

Replaced squared cedar post with a 2-inch inside diameter, galvanized wrought iron pipe, 5 feet long, filled with concrete, with brass cap stamped:

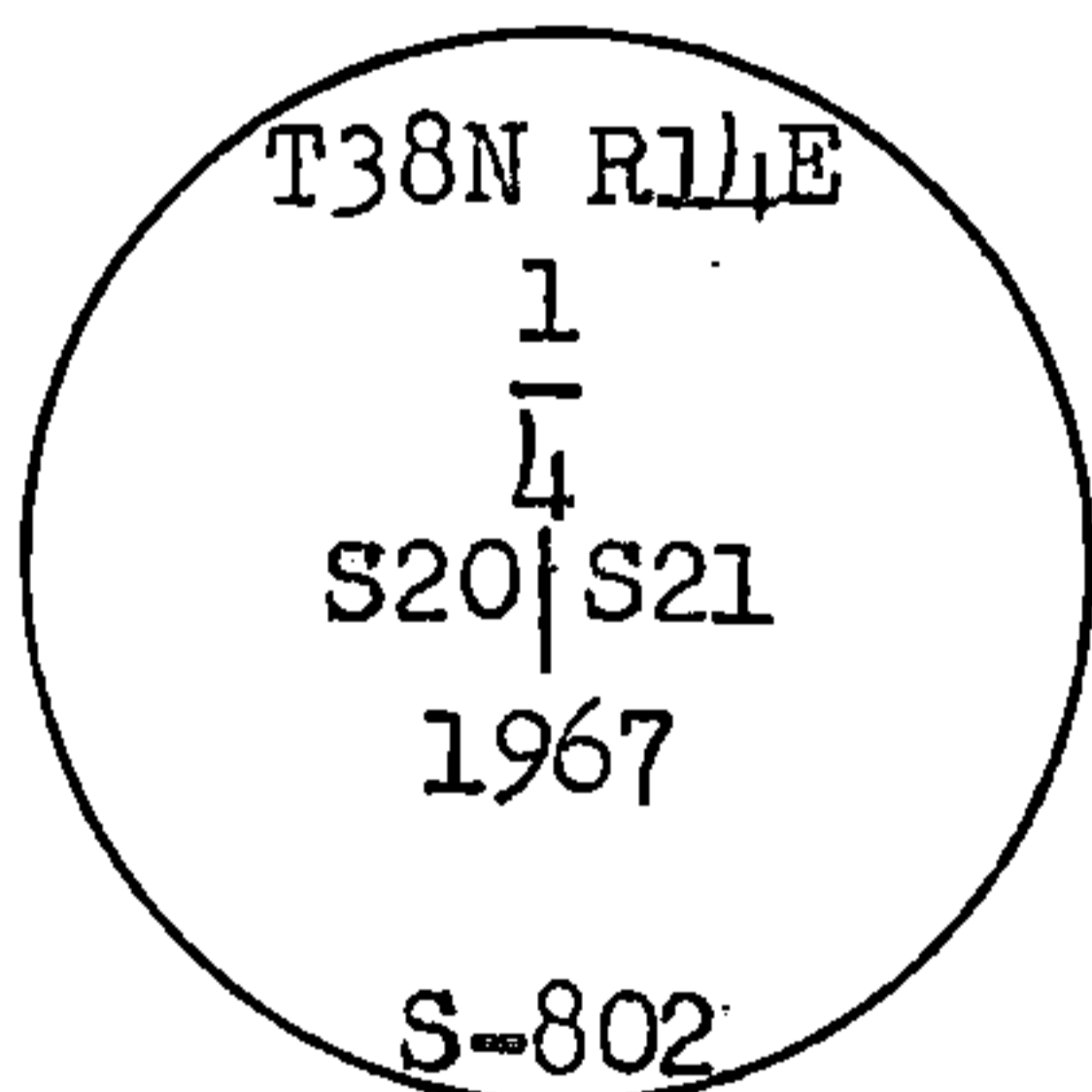

from which the following blazed and scribed new bearing trees bear:

Tamarack 7", N50°E, 56.20 ft. or 85.151 lks.
Cedar 3", S34°E, 27.83 ft. or 42.166 lks.
Tamarack 4", N65°W, 18.04 ft. or 27.333 lks.

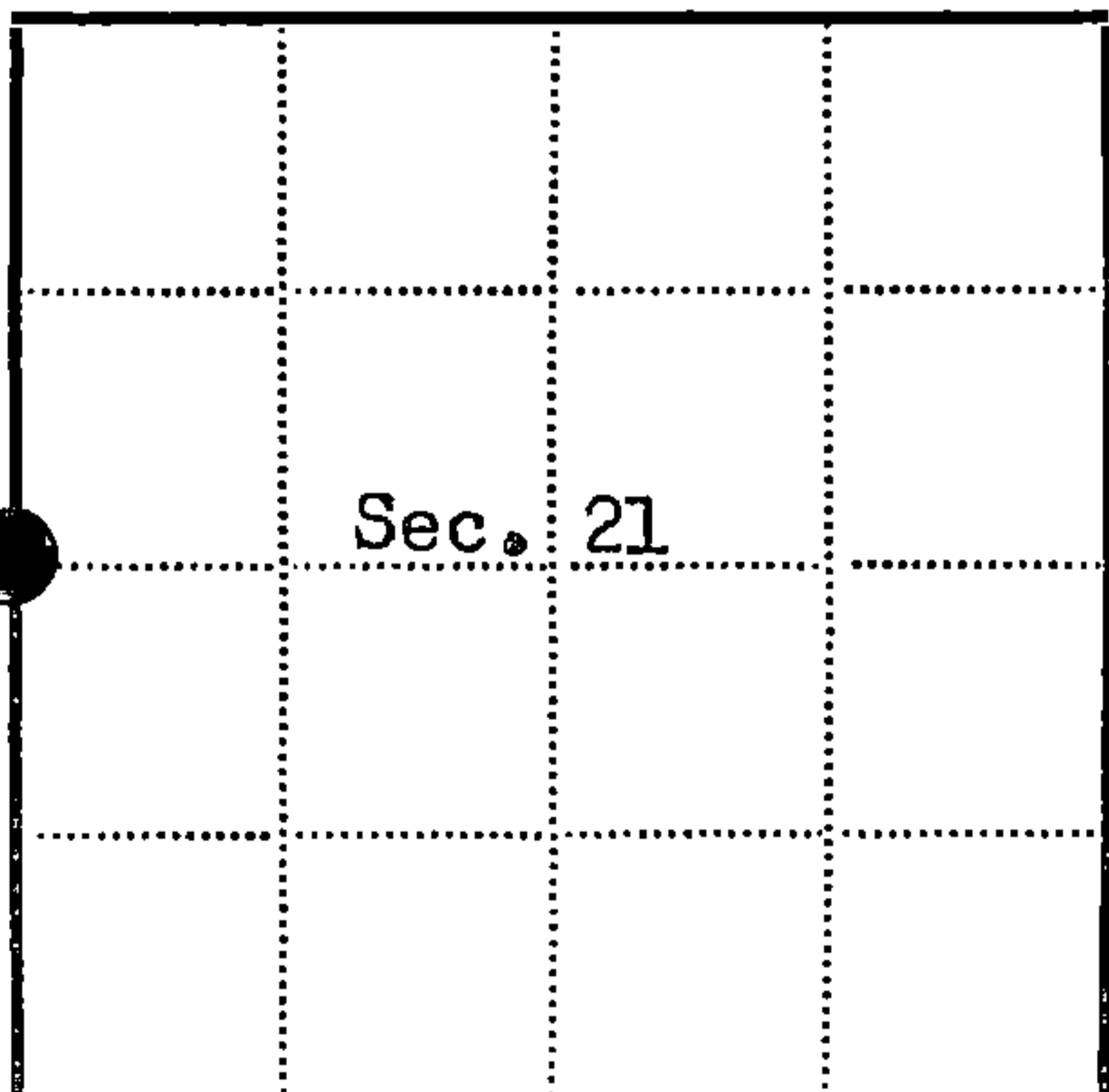

● = Corner monument restored
□ =

Resident witnesses.....

Dated at Rhinelander Wisconsin, this 29th day of March 1968.

Signature Jean F. Resvick Title Cadastral Surveyor
(County Surveyor, Registered Land Surveyor, or other duly authorized official)

Surveyors Registration No. S-802 DOCUMENT # 94555

Office of Register of Deeds County of Forest

I hereby certify that the within instrument was filed in this office for record on the 14th day of May 1968, and was filed in Book No. I Page No. P-9 of County Records. at 10:00 AM

Signature Eugene Staszny Title Register of Deeds

Township 38 North, Range 14 East, Section 21, Index No. P-9, Page No.

U. S. PUBLIC LAND SURVEY MONUMENT RECORD

INSTRUCTIONS:

This record shall show the location of the corner and shall include all of the following nine elements (a through I).

- (a) Identify the corner by reference to the U.S. public land survey system.
 ○ = Corner monument restored.

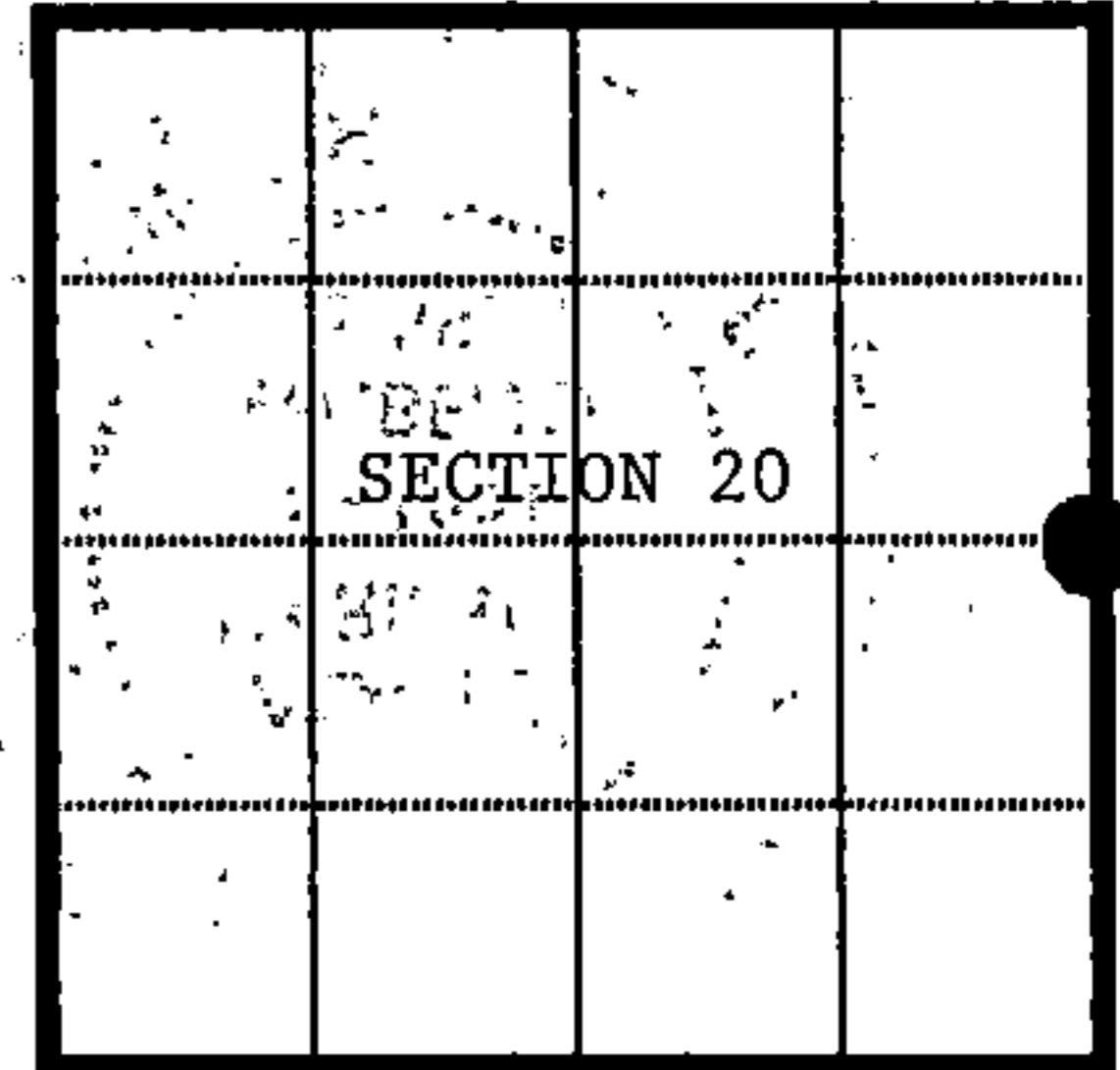

Quarter Corner to Sections 20 and 21, T.38N., R.14E.,
 Forest County, Wisconsin

State Plane Coordinates:
 N = 218712.489
 E = 2285373.804

REGISTER'S OFFICE }
 Forest County, Wis. }
 Received for record this 21ST day
 of March A.D., 2001 at
9:30 o'clock, A.M. and recorded
 in Vol. Corner Restoration
 page P-9
Kay Swanson, Deputy
 Register of Deeds

Geographic Coordinates:
 N = 45-45-34.821
 W = 88-45-30.419

- (b) Describe any record evidence, monument evidence, occupational evidence, testimonial evidence or any other material evidence you considered, and whether the monument was found or placed.

Original Government Survey in 1865 by H. & J.L. Nowlin. Set wood post from which the following bear;
 Tamarack, 8", N.21°W., 23 links, Tamarack, 8", S.87°E. 20 links.

In 1967, Jean Resvick, RLS with the U.S. Forest Service found a squared cedar post and original bearing tree evidence. Set a 2 inch diameter galvanized iron pipe 5 feet long with a brass cap marked; T38N., R14E., S20, S21, 1967, S - 802. Blazed and scribed the following; Tamarack, 7", N.50°E., 56.20 feet, Cedar, 3", S.34°E. 27.83 feet, Tamarack, 4", N.65°W., 18.04 feet.

In 1989, Gary Pisoni, RLS, blazed and scribed 1 new bearing tree; Cedar, 8", S.61°W. 5.65 feet.

On 9-22-97, Alan Harrison, RLS with the U.S. Forest Service, found monument and accessories as set above. Cut down all but Northeast bearing tree for GPS observations. Blazed and scribed new bearing trees as noted below.

- (c) In the plan view drawing below, provide reference ties to at least 4 witness monuments, or If the location is within a municipality, to at least 2 witness monuments. (witness monuments shall be made of concrete, natural stone, iron or other equally durable material.)

- (d) Show a plan view drawing depicting the relevant monuments and reference ties which is sufficient in detail to enable accurate relocation of the corner monument if the corner monument is disturbed. Indicate north.

- 1.) 2" diameter iron pipe w/brass cap stamped to identify corner.
- 2.) Tamarack, 12", N.50°E., 56.20 feet
- 3.) Tamarack, 8", N.21°E., 43.47 feet (new)
- 4.) Tamarack, 10", N.88°E., 48.02 feet (new)
- 5.) Cedar, 7", S.16°W., 46.20 feet (new)
- 6.) Wood sign post, Northeast, 1.00 feet

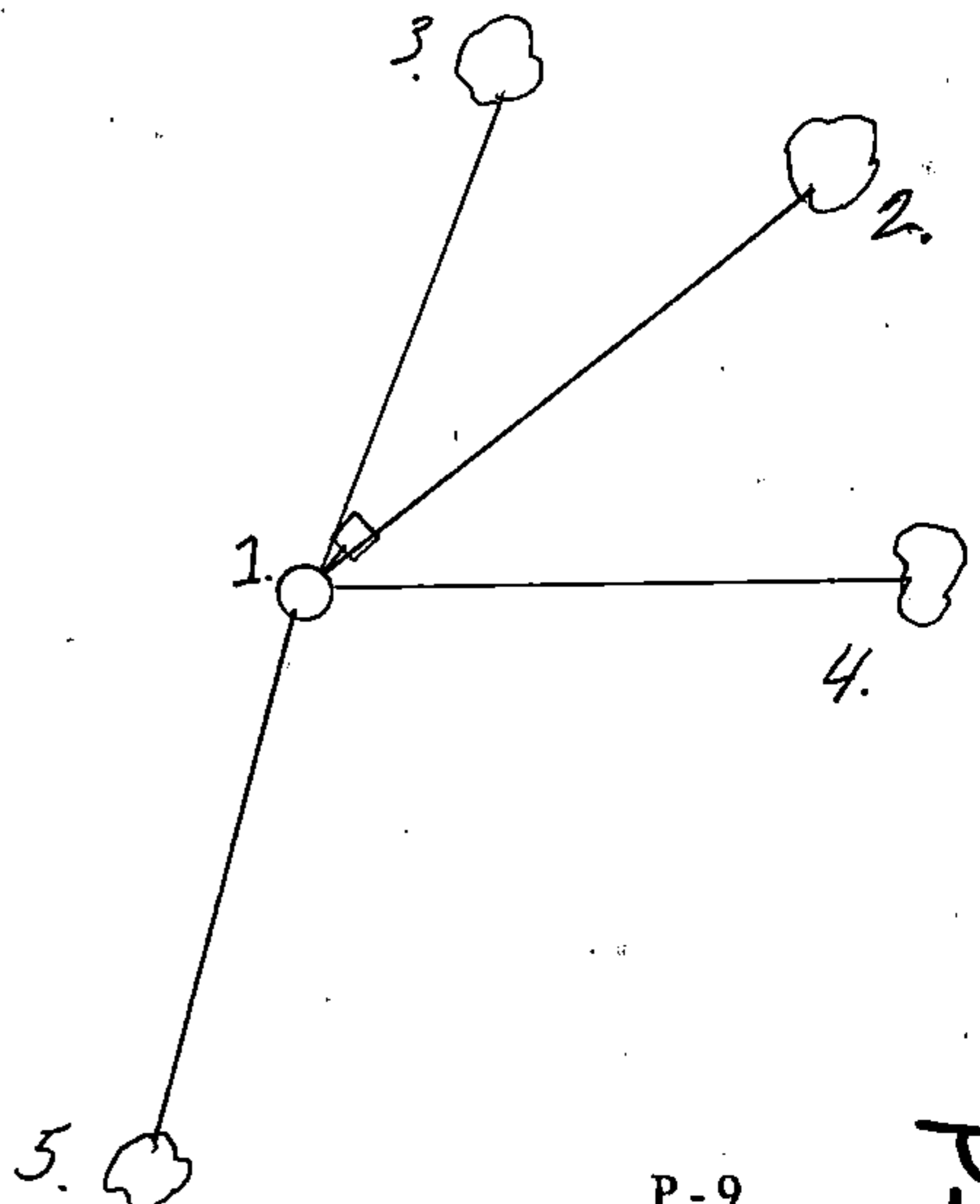

(e) Describe any material discrepancy between the location of the corner as restored or reestablished and the location of that corner as previously restored or reestablished by distance and direction. Show the discrepancy on the plan view drawing under (d), above. Show the distances between the corner as previously restored or reestablished and (1) the corner as restored or reestablished, and (2) to at least 2 of the witness monuments shown on the drawing in (d), above.

None

(f) Was the corner restored through acceptance of (1) an obliterated evidence location, or, (2) a found perpetuated location?

2.) found perpetuated location.

(g & h) Was the corner reestablished through lost corner proportionate methods? If so, show the method, including the directions and distances to other public land survey corners used as evidence or used for proportioning in determining the corner location?

No

(I) I, Alan D. Harrison
(type or print name) certify that the corner location shown on this record was determined by me or under my direction and control and that this U. S. Public Land Survey Monument Record is correct and complete to the best of my knowledge and belief.

Alan D. Harrison 3/13/01
Signature Date

CERTIFICATE READY FOR FILING: David Eger
District Ranger

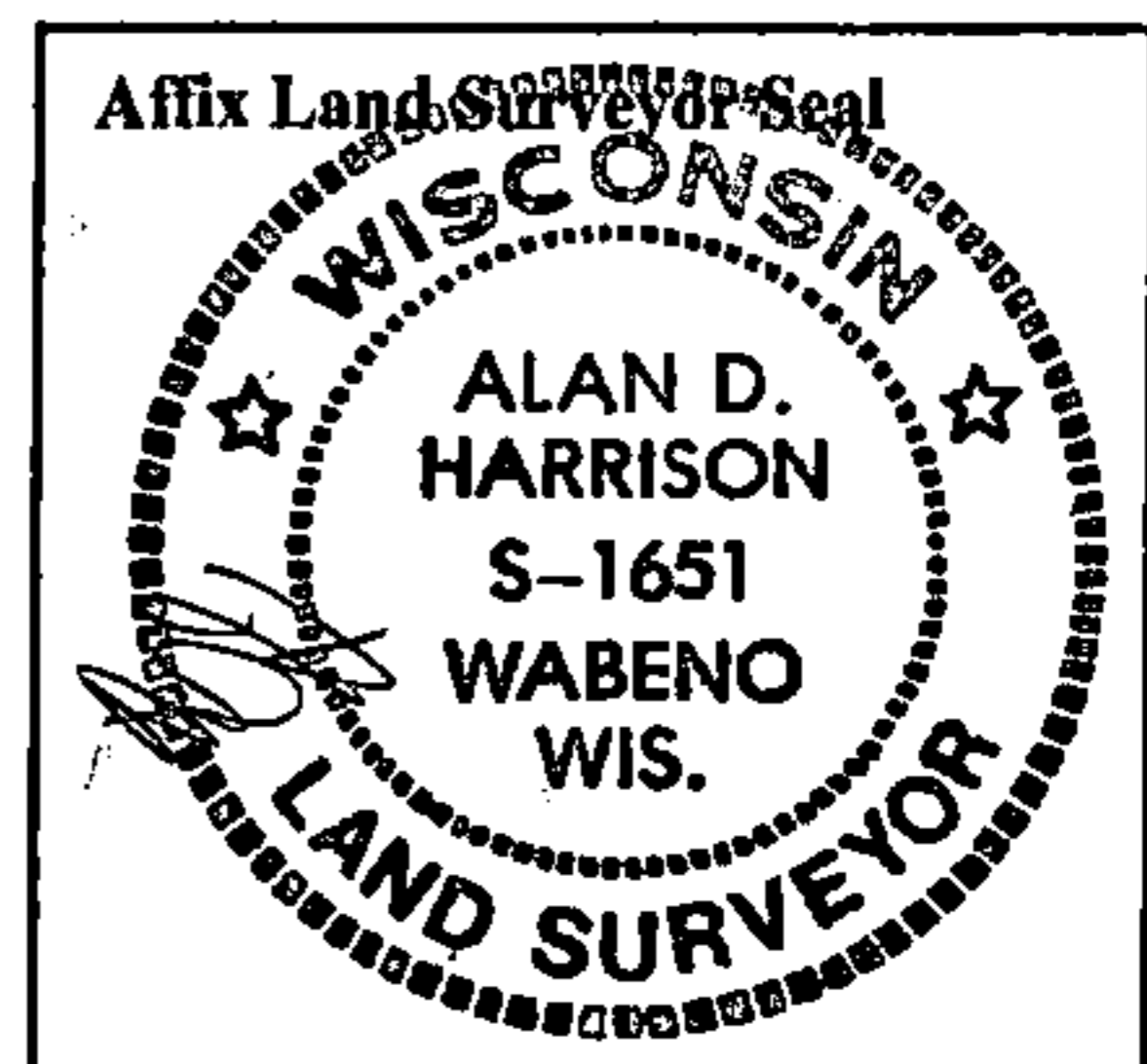

U.S. PUBLIC LAND SURVEY MONUMENT RECORD

Index No. P-9

State of Wisconsin }
County of Forest } ss.

I, Gary L. Pisoni, do hereby certify that on the 21st day of March, 1989, I found evidence of the West quarter corner of Section 21 Township 38 North, Range 14 East, Fourth Principal Meridian, as described hereon; and that from this evidence I established a new monument and accessories as described hereon to perpetuate the original location of this corner.

Resident witnesses:

.....
.....
.....

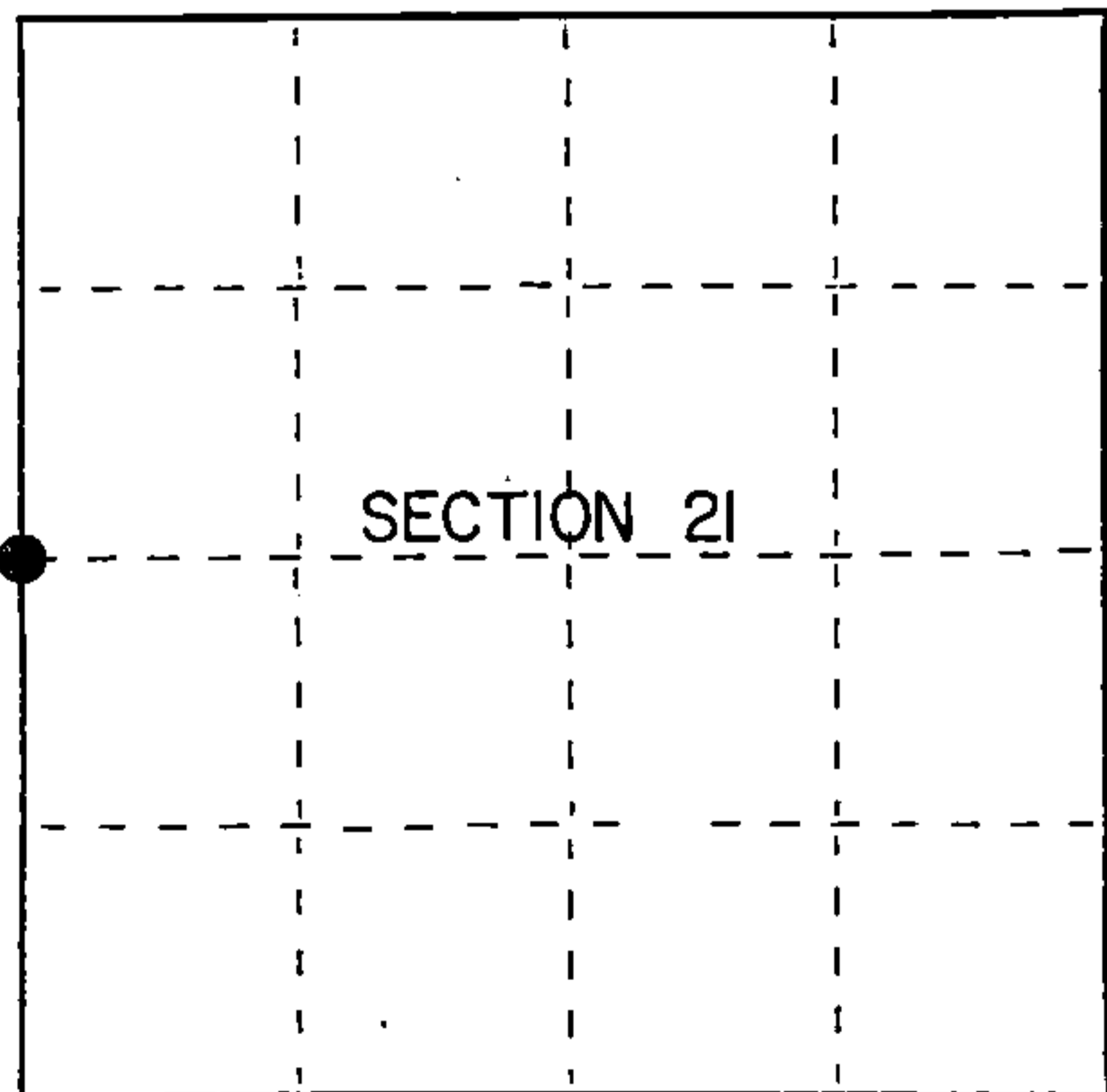

● = Corner monument restored.

History of original corner establishment:

Original Government survey in 1865 by James L. Nowlin.

In 1967, Jean Resvick, surveyor for U.S.F.S. found a squared cedar post marking corner position. Replaced squared cedar post with a 2"x5' long galvanized iron pipe filled with concrete, with brass cap stamped: T38N, R14E, 1/4, S-20, S-21, 1967, S-802 from which the following bear:

Tamarack	7"	N 50° E	56.20 feet
Cedar	3"	S 34° E	27.83 feet
Tamarack	4"	N 65° W	18.04 feet

Description of corner evidence found:

Found monument as described above from which the following bear:

Cedar	7"	S 34° E	27.47 feet
Tamarack	9"	N 64° W	17.77 feet
Wood sign post		N 55° E	1.0 feet

Description of monument and accessories I established to perpetuate the original location of this corner.

Blazed and scribed the new bearing trees: (measurements are all taken to a nail in the side of tree)

Cedar	8"	S 61° W	5.65 feet
-------	----	---------	-----------

Dated at Iron River, MI, Wis, this 18th day of December, 1989.

Signature: *Gary L. Pisoni* Title: Land Surveyor Registration No. S-1634
(County Surveyor, Registered Land Surveyor, or other duly authorized official)

Office of Register of Deeds, County of Forest, I hereby certify that the within instrument was filed in this office for record on the 20th day of September, 1990 at 10:45 o'clock A.M.

(Register of Deeds)

By: *Harb Clitho* Deputy

FORM NO. 985-A

H.C. Miller Company

Stock No. 26273

DOCUMENT NUMBER

140462

438147202000

e) Describe any material discrepancy between the location of the corner as restored or reestablished and the location of that corner as previously restored or reestablished by distance and direction. Show the discrepancy on the plan view drawing under (d), above. Show the distances between the corner as previously restored or reestablished and (1) the corner as restored or reestablished, and (2) to at least 2 of the witness monuments shown on the drawing in (d), above.

See drawing below.

(f) Was the corner restored through acceptance of (1) an obliterated evidence location, or, (2) a found perpetuated location?

Restored through acceptance of a found perpetuated location.

(g&h) Was the corner reestablished through lost corner proportionate methods? If so, show the method, including the directions and distances to other public land survey corners used as evidence or used for proportioning in determining the corner location?

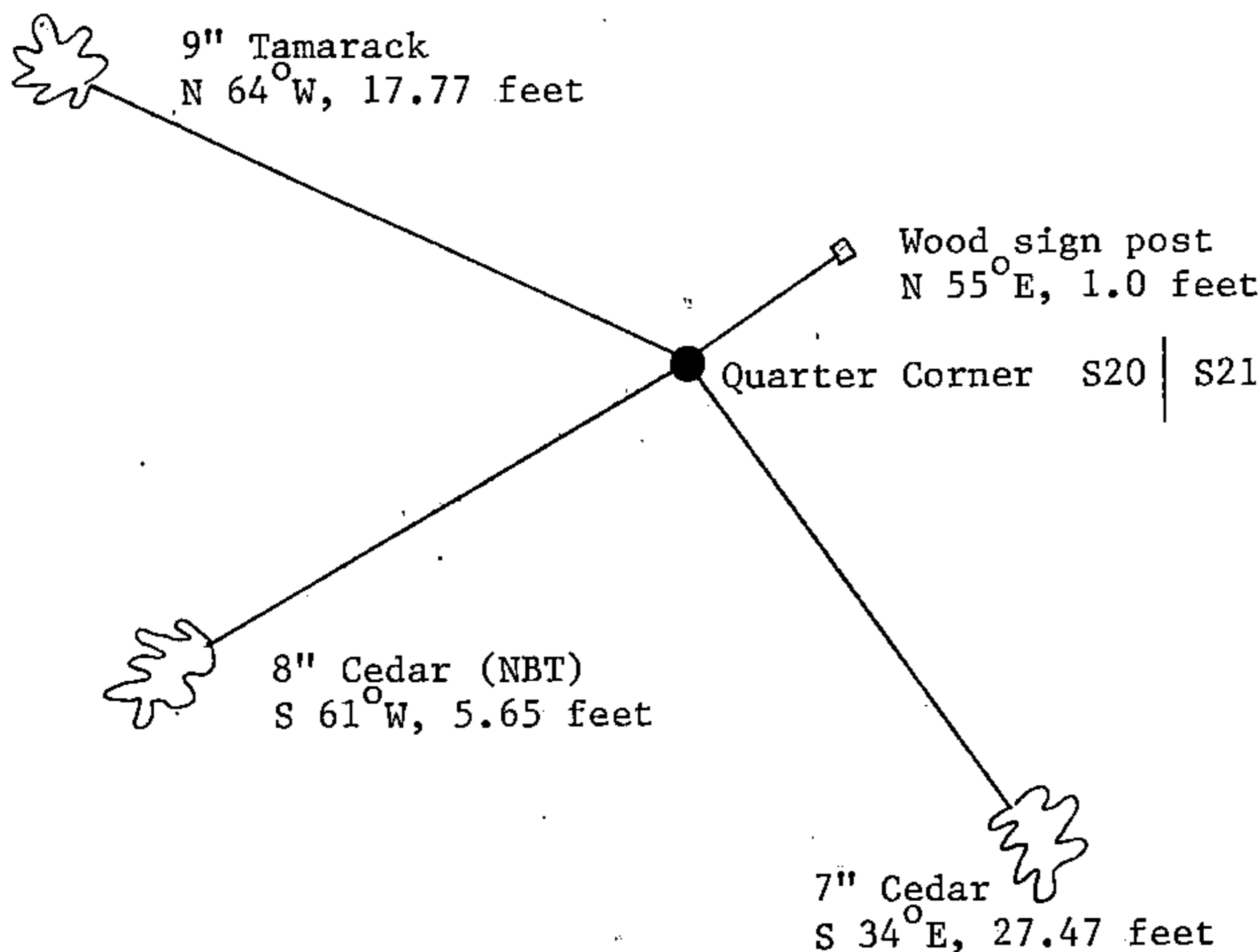

Gary L. Pisoni

(i) I, Gary L. Pisoni (type or print name) certify that the corner location shown on this record was determined by me or under my direction and control and that this U.S. Public Land Survey Monument Record is correct and complete to the best of my knowledge and belief.

Signature Gary L. Pisoni Date Jan 19 1990

Survey requested by: [Signature] District Ranger Date 9-18-90