

State of Wisconsin }  
County of Forest } ss.

I Robert E. Bandow, do hereby  
certify that on the 11th day  
of November, 1959, I found  
evidence of the South-East  
corner of Section 9  
Township 38, North, Range  
14 East, Fourth Principal Meridian,  
as described hereon; and that from this evidence  
I established a new monument and accessories  
as described hereon to perpetuate the original  
location of this corner.

Resident witnesses:

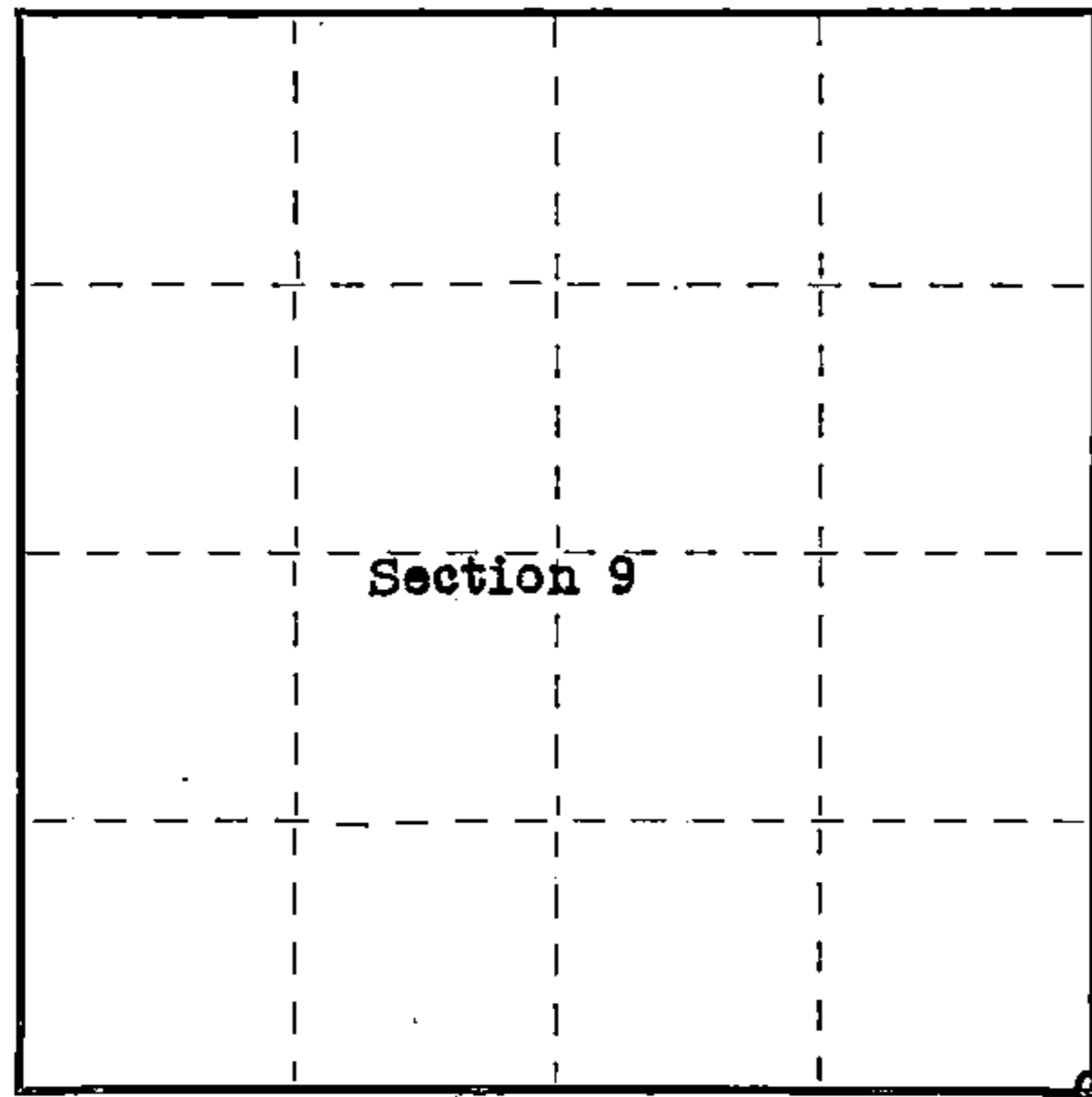

○ = Corner monument restored.

# CERTIFIED LAND CORNER RESTORATION

83258

Index No. 271

History of original corner establishment:

Original corner established in 1865 by James D. Nowlin, Government  
Deputy Surveyor.

Original bearing trees: Birch 12" N7°W 12 lks.  
White Pine 24" N57°E 33 lks.

Description of corner evidence found:

Iron pipe and 4"x4" scribed wood post.

Wood post was cut from native hemlock approximately  
25 years ago, and scribed with standard surveyor's  
timber scribe. Corner is accepted locally as being  
in it's proper position. 1" diameter iron pipe was  
removed and brass cap monument described below set in  
it's place. Iron pipe was set approximately 20 years ago.

Description of monument and accessories I established to perpetuate the original location of this corner.  
Set 2"x5' galvanized iron pipe filled with concrete, capped with brass cap and  
stamped as follows:

T38N R14E  
S9 S10  
S16 S15  
1959

RLS No. S-104

Blazed and scribed the following bearing trees: Cedar 12" N48°00'W 38.5 feet.  
Hemlock 22" S58°00'W 9.2 feet.  
Maple 11" S36°30'E 48 feet.

Genisot Engineering Co.

Dated at Rhineland, Wis., this 3rd day of December, 19 59.

Signature Robert E. Bandow Title Registered Land Surveyor Registration No. S-104  
(County Surveyor, Registered Land Surveyor, or other duly authorized official)

Office of Register of Deeds, County of Forest, I hereby certify that the within  
instrument was filed in this office for record on the 21st day of March, 19 60  
at 9:00 o'clock A.M.

Anna Peterson  
(Register of Deeds)

By \_\_\_\_\_ Deputy

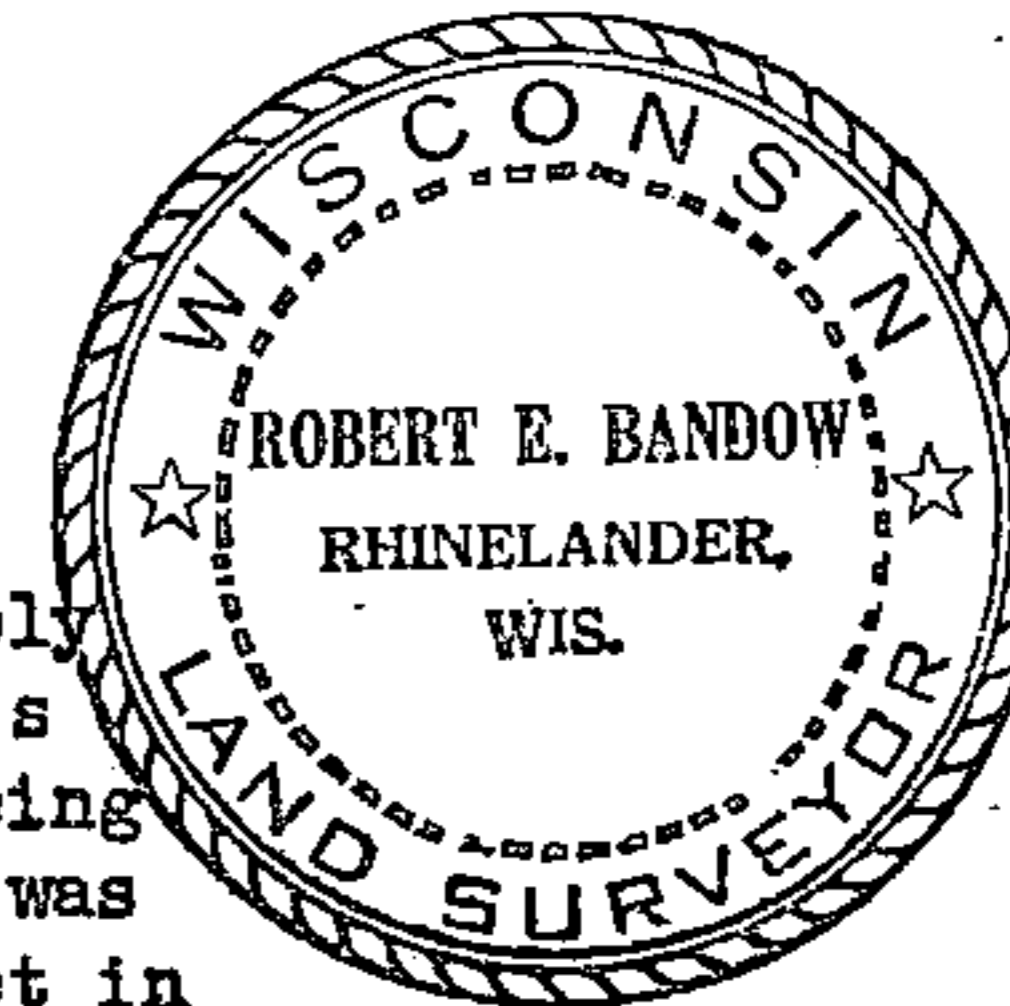

Subscribed and sworn to before me this 22nd day of  
December 1959. Joseph E. Dier Notary Public,  
Oneida County, Wisconsin.  
My Commission expires May 1, 1960

4381409 0000

# U.S. PUBLIC LAND SURVEY MONUMENT RECORD

Index No. J-13

State of Wisconsin }  
County of FOREST } ss.

I, John C. Schulke, do hereby certify that on the 6th day of May, 1988, I found evidence of the Section corner of 9, 10, 15 and 16, Township 38 North, Range 14 East, Fourth Principal Meridian, as described hereon; and that from this evidence I established a new monument and accessories as described hereon to perpetuate the original location of this corner.

Resident witnesses:

History of original corner establishment:

The original Government Survey of the subdivision of the township was done in 1865 by J. L. Nowlin. Set a wooden post with the following bearing trees:

Birch	12"	N07°W	12 lks.
White Pine	24"	N57°E	33 lks.

In 1959, Robert Badow recovered corner as described on the Certified Land Corner Restoration form filed in the Forest County Register of Deed's Office, Document #83258.

Description of corner evidence found:

In 1988, John Schulke recovered monument in place and found the following bearing trees:

Cedar	16"	N49°W	38.35 feet
Hemlock stub	22"	S58°W	9.2 feet
Maple stub	12"	S38°E	47.9 feet

REGISTER'S OFFICE  
Forest County, Wis.

Received for record this 9th day of December, A.D., 1988 at 10:10 o'clock A.M. and recorded in Vol. CORNER RESTORATIONS page J-13.

Paul Achenbrenner  
Register of Deeds

Description of monument and accessories I established to perpetuate the original location of this corner.

From the recovered corner monument established the following corner references:

Red Maple	10"	N08°E	24.48 feet
Sugar Maple	10"	S69°E	31.09 feet
Red Maple	12"	S17°W	25.00 feet
Twin Red Maple	10"	N23°W	57.18 feet
Steel sign post		NW	1.0 feet

Dated at Cable, Wis., this 15th day of October, 1988.

Signature John C. Schulke Title Register Land Surveyor Registration No S-1665  
(County Surveyor, Registered Land Surveyor, or other duly authorized official)

Office of Register of Deeds, County of Forest, I hereby certify that the within instrument was filed in this office for record on the 9th day of December, 1988 at 10:10 o'clock A.M.

Paul Achenbrenner  
(Register of Deeds)

By Deputy

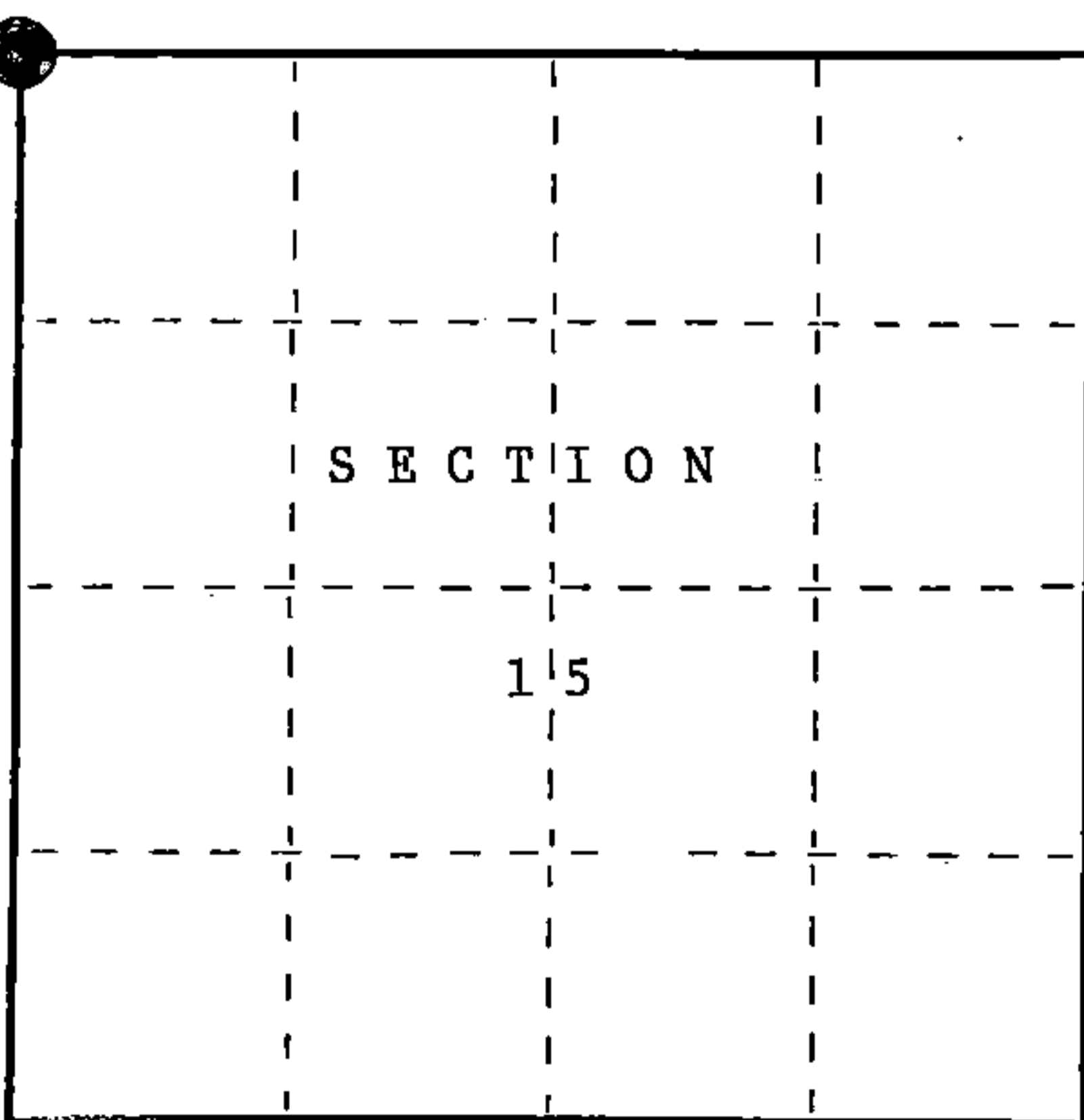

○ = Corner monument restored.

FORM NO. 985-A

H.C. Miller Company

Stock No. 26273

DOCUMENT NUMBER 136595

4381409000

(e) Describe any material discrepancy between the location of the corner as restored or reestablished and the location of that corner as previously restored or reestablished by distance and direction. Show the discrepancy on the plan view drawing under (d), above. Show the distances between the corner as previously restored or reestablished and (1) the corner as restored or reestablished, and (2) to at least 2 of the witness monuments shown on the drawing in (d), above.

No discrepancy, restored existing corner.

RECEIVED  
OCT 15 1988  
U.S. DEPT. OF AGRICULTURE  
BUREAU OF LAND MANAGEMENT  
DENVER, COLORADO

(f) Was the corner restored through acceptance of (1) an obliterated evidence location, or, (2) a found perpetuated location?

Found perpetuated location.

(g&h) Was the corner reestablished through lost corner proportionate methods? If so, show the method, including the directions and distances to other public land survey corners used as evidence or used for proportioning in determining the corner location?

SECTION CORNER

S9	S10
S16	S15

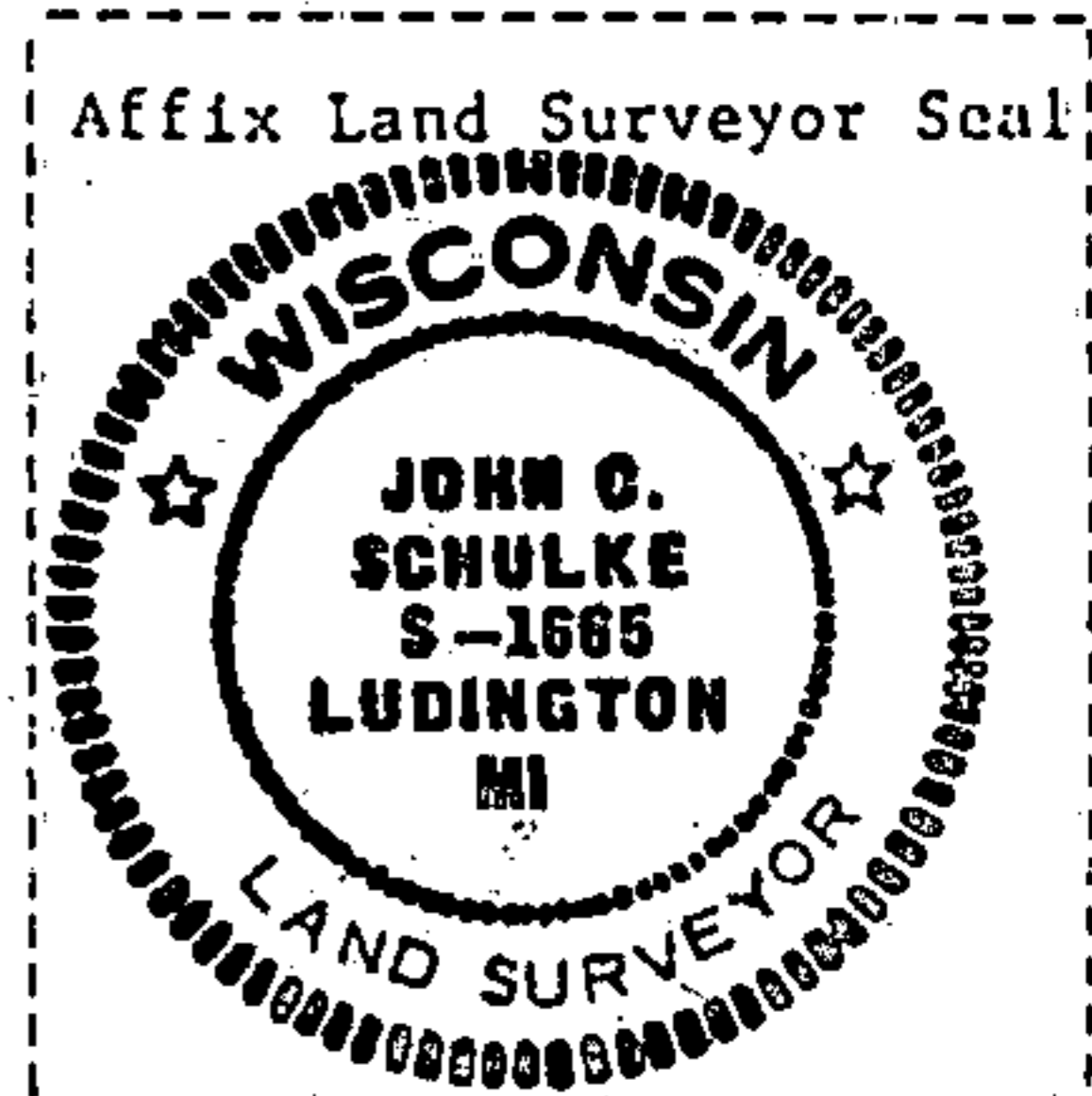
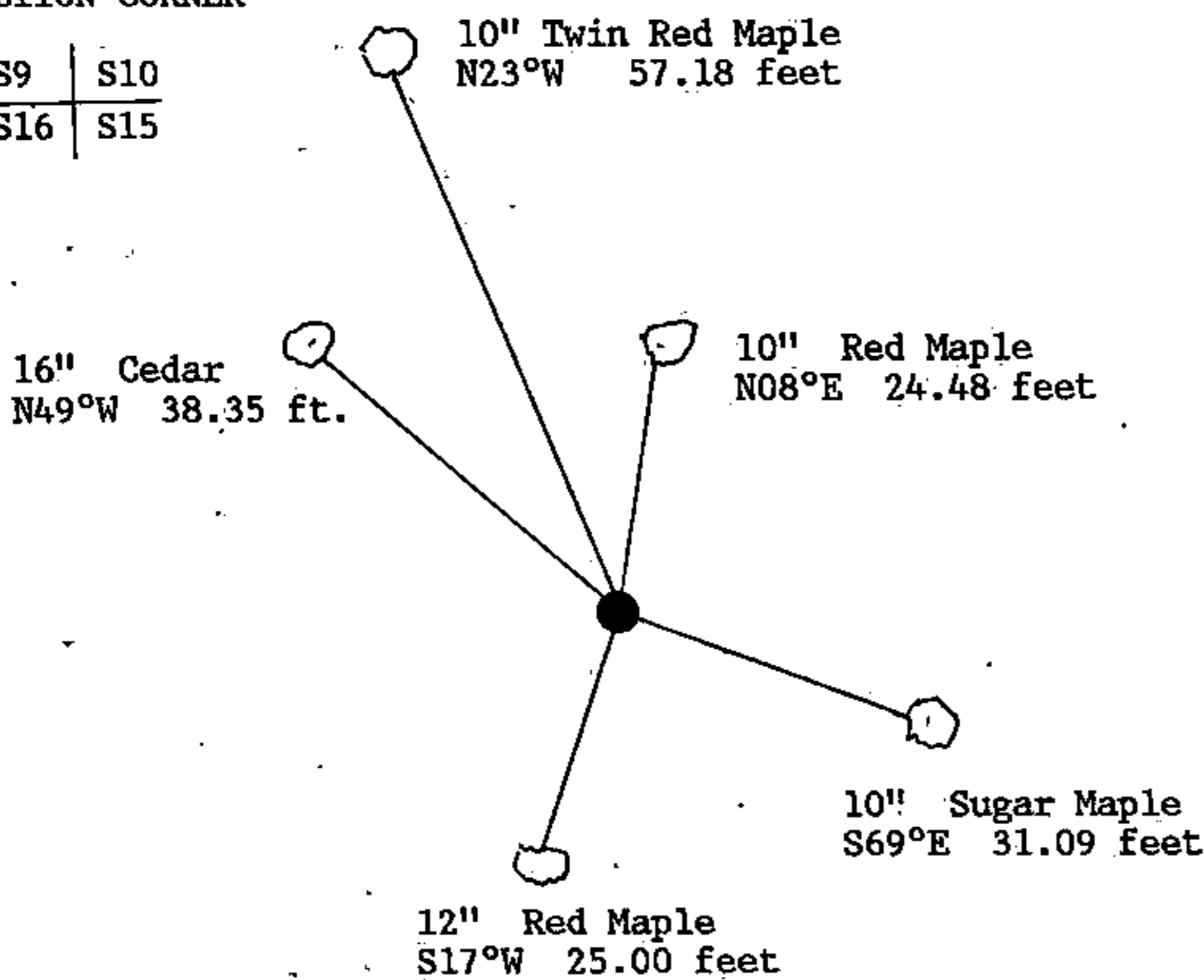

(i) I, John Schulke  
(type or print name) certify that the corner location shown on this record was determined by me or under my direction and control and that this U.S. Public Land Survey Monument Record is correct and complete to the best of my knowledge and belief.

John C. Schulke Oct 15, 1988  
Signature Date

Survey requested by: [Signature] 10-25-88  
District Ranger Date