

State of Wisconsin }  
County of Forest } ss.

I Robert E. Bandow, do hereby  
certify that on the 11th day  
of November, 19 59, I found  
evidence of the North-East  
corner of Section 8  
Township 38, North, Range  
14 East, Fourth Principal Meridian,  
as described hereon; and that from this evidence  
I established a new monument and accessories  
as described hereon to perpetuate the original  
location of this corner.

Resident witnesses:

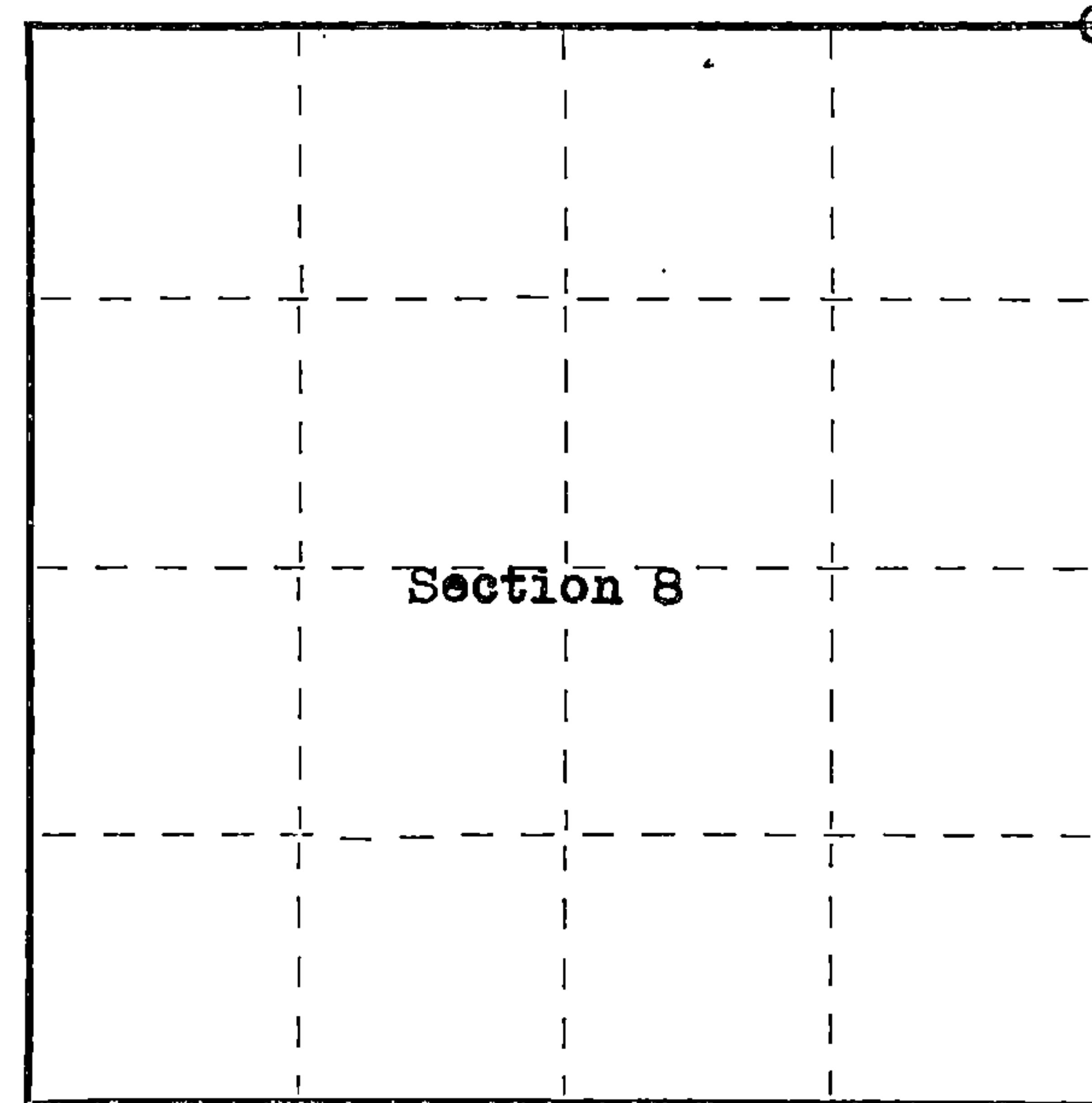

○ = Corner monument restored.

# CERTIFIED LAND CORNER RESTORATION

83257

Index No. 24

History of original corner establishment:

Original corner established in 1865 by James D. Nowlin, Government Deputy Surveyor.  
Original bearing trees: Fir 12" N4°E 210 lks.  
Fir 8" N6°W 200 lks.

Description of corner evidence found:

4"x4" Scribed wood post in swamp.

Wood post was cut from native cedar  
approximately 30 years ago. Scribing  
accomplished with standard surveyors timber  
scribe. Corner is 0.30 chains West and  
1.00 chains North of the Popple River as  
recorded in original Government notes.

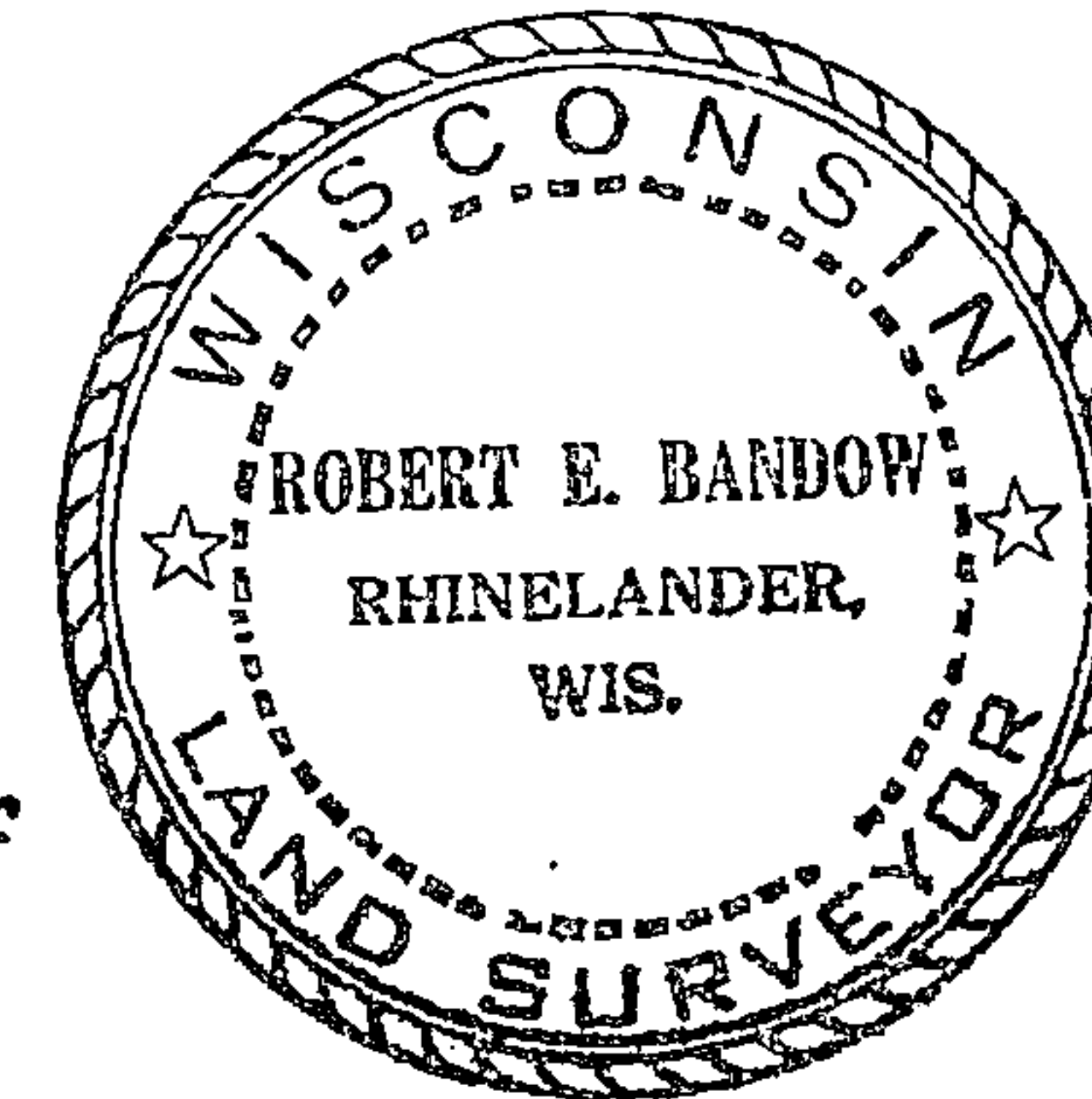

Description of monument and accessories I established to perpetuate the original location of this corner.  
Set 2"x5' galvanized iron pipe filled with concrete, capped with brass cap, stamped  
as follows:

T38N R14E  
S5/S4  
S8/S9  
1959

RLS No. S-104

Blazed and scribed the following bearing trees: Elm 21" S74°30'W 47.9 feet.  
Elm 9" N 2°30'W 60.2 feet.  
Cedar 17" N62°00'W 85.8 feet.

Rhineland, Wis.

Dated at Genisot Engineering Co., Wis., this 3rd day of December, 19 59.

Signature Robert E. Bandow Title Registered Land Surveyor Registration No. S-104  
(County Surveyor, Registered Land Surveyor, or other duly authorized official)

Office of Register of Deeds, County of Forest, I hereby certify that the within  
instrument was filed in this office for record on the 21st day of March, 19 60  
at 9:00 o'clock A. M.

Anna Peterson  
(Register of Deeds)

By \_\_\_\_\_ Deputy

Subscribed and sworn to before me this 29th day of  
December 1959. Joseph C. Hilkey Notary Public,  
Oneida County, Wis.  
My Commission expires May 1, 1960

43814050000



U.S. PUBLIC LAND SURVEY MONUMENT RECORD

Index No. E-9

State of Wisconsin }  
County of FOREST } ss.

I John C. Schulke, do hereby  
certify that on the 20th day  
of May, 1988, I found  
evidence of the Section  
corner of 4, 5, 8 and 9.  
Township 38, North, Range  
14 East, Fourth Principal Meridian,  
as described hereon; and that from this evidence  
I established a new monument and accessories  
as described hereon to perpetuate the original  
location of this corner.

Resident witnesses:

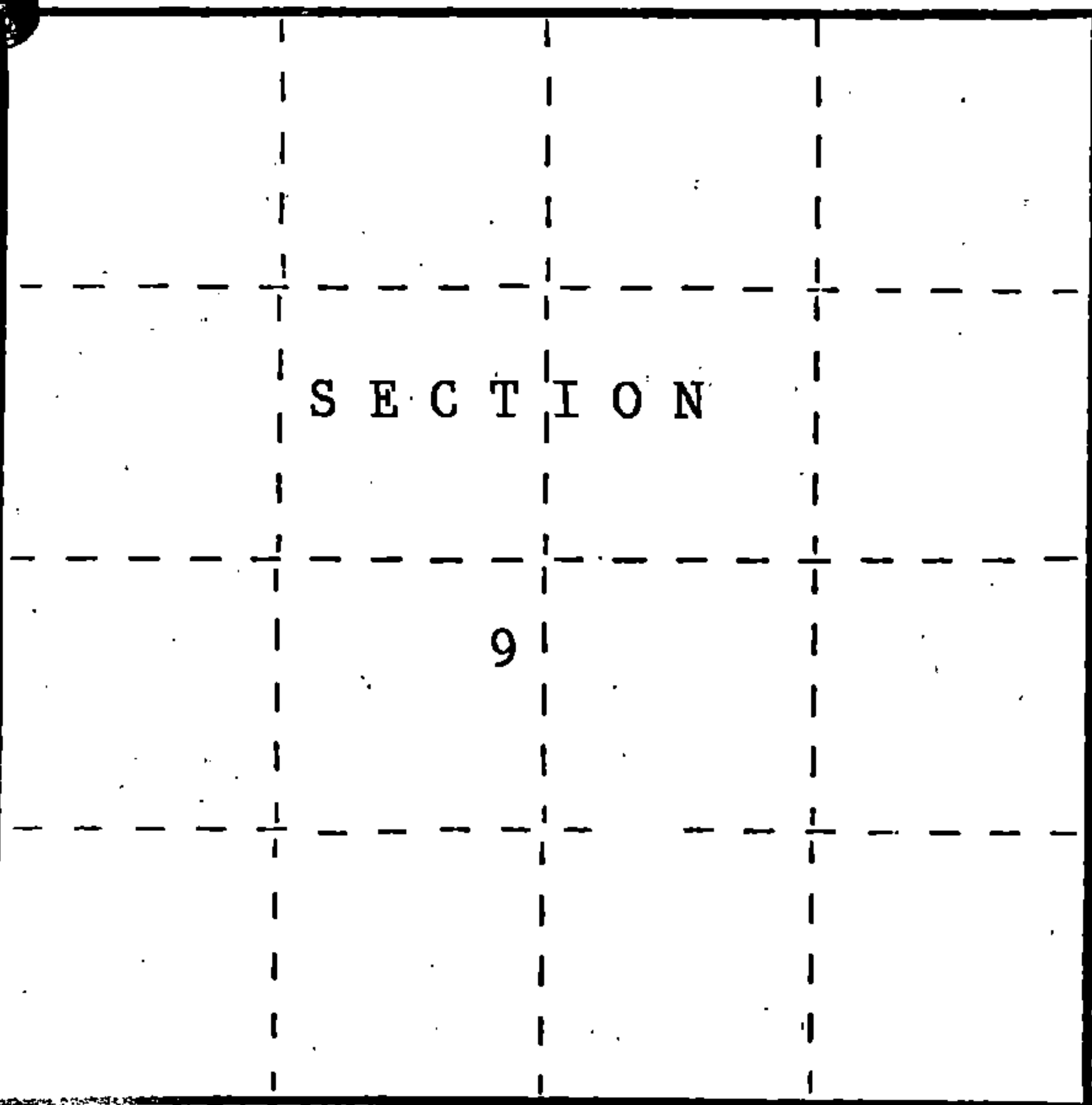

○ = Corner monument restored.

History of original corner establishment:

The original Government Survey of the subdivision of the township was done in 1865  
by J. L. Nowlin. Set a wooden post with the following bearing trees:  
Sugar 10" S39°E 85 lks.  
Hemlock 8" N32°W 22 lks.

In 1959, Robert Badow recovered corner as described on the U.S. Public  
Land Survey Monument Record form filed in the Forest County Register  
of Deed's Office, Document #83257.

Description of corner evidence found:

In 1988, John Schulke recovered monument in place but loose and found  
the following bearing trees: Dead Elm 28" S78°W 47.62 feet  
Elm stub 18" N03°W 59.72 feet  
Cedar 20" N58°W 85.11 feet

Description of monument and accessories I established to perpetuate the original location of this corner.

Reset monument firmly in the ground in a mound of stones. Set a steel sign post 0.8 feet  
West. The following new corner references:

Red Maple	5"	N07°E	43.54 feet
Red Maple	20"	N85°W	71.71 feet
chiseled "X" on boulder	5'X5'	N70°W	58.87 feet

Dated at Cable, Wis., this 15th day of October, 1988

Signature John C. Schulke Title Register Land Surveyor Registration No S-1665  
(County Surveyor, Registered Land Surveyor, or other duly authorized official)

Office of Register of Deeds, County of Forest, I hereby certify that the within  
instrument was filed in this office for record on the 9th day of December, 1988  
at 10:10 clock A. M.

Paul Aschenbrenner  
(Register of Deeds)

By Deputy

REGISTER'S OFFICE  
Forest County, Wis.  
Received for record this 9th day  
of December, A.D., 1988 at  
10:10 o'clock A. M. and recorded  
in Vol. CORNER RESTORATION  
page E-9  
Paul Aschenbrenner  
Register of Deeds

FORM NO. 985-A

H.C. Miller Company  
Milwaukee, Wisconsin

Stock No. 26273

DOCUMENT NUMBER 136589

43814050000

(e) Describe any material discrepancy between the location of the corner as restored or reestablished and the location of that corner as previously restored or reestablished by distance and direction. Show the discrepancy on the plan view drawing under (d), above. Show the distances between the corner as previously restored or reestablished and (1) the corner as restored or reestablished, and (2) to at least 2 of the witness monuments shown on the drawing in (d), above.

No discrepancy, restored existing corner.

(f) Was the corner restored through acceptance of (1) an obliterated evidence location, or, (2) a found perpetuated location?  
found perpetuated location.

(g&h) Was the corner reestablished through lost corner proportionate methods? If so, show the method, including the directions and distances to other public land survey corners used as evidence or used for proportioning in determining the corner location?

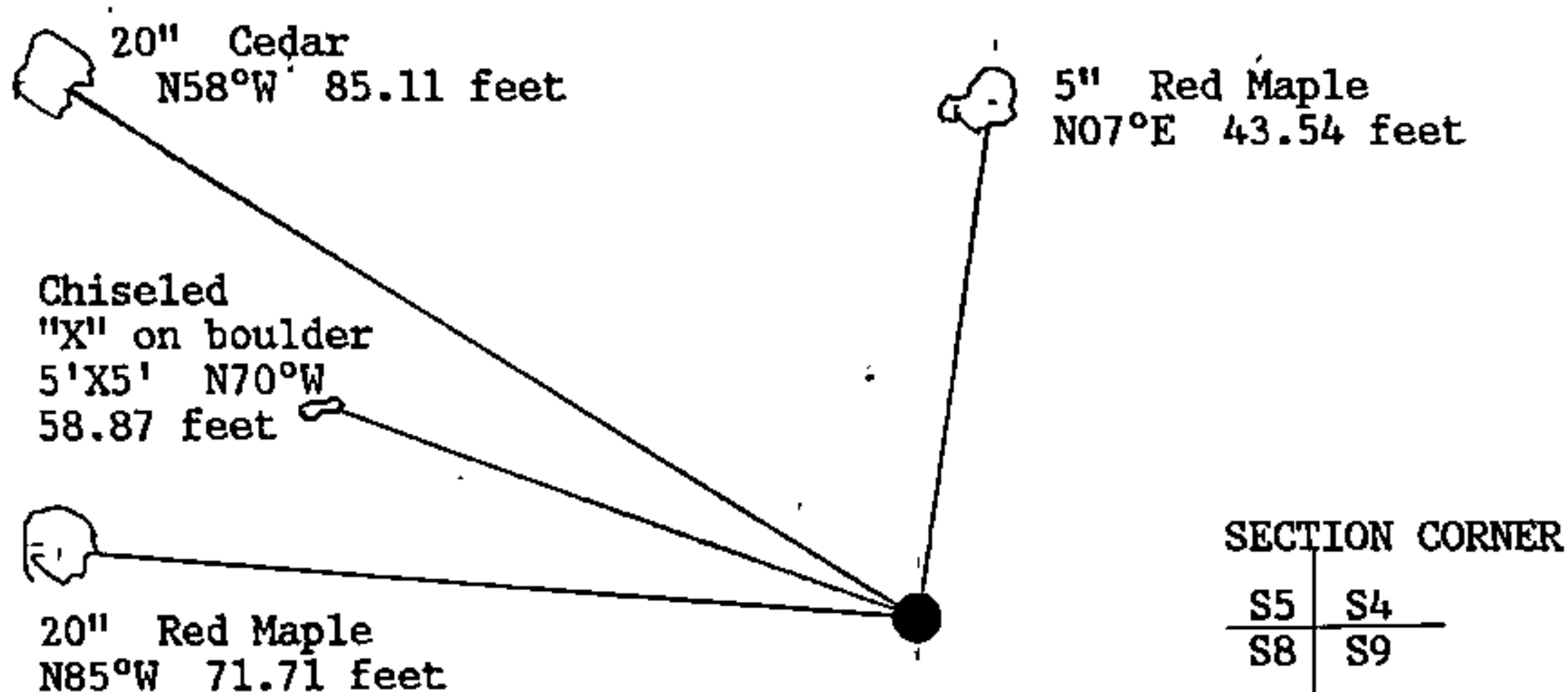

Affix Land Surveyor Seal



(i) I, John Schulke  
(type or print name) certify that the corner location shown on this record was determined by me or under my direction and control and that this U.S. Public Land Survey Monument Record is correct and complete to the best of my knowledge and belief.

John C. Schulke Oct 15th, 1988  
Signature Date

Survey requested by: Edmond A. [Signature] 10-25-88  
District Ranger Date