

CERTIFIED LAND CORNER RESTORATION

Index No. S-1

S 1

State of Wisconsin }
County of Forest } ss.

I Glen Barker, do hereby
certify that on the 11th day
of December, 19 84, I ~~found~~
~~relocated~~ established the N 1/16
corner of Sections 25 & 30
Township 38, North, Range
13 & 14 East, Fourth Principal Meridian,
as described hereon; and that from this evidence
I established a new monument and accessories
as described hereon to perpetuate the original
location of this corner.

Resident witnesses:

N. Spiess

R. Lundt

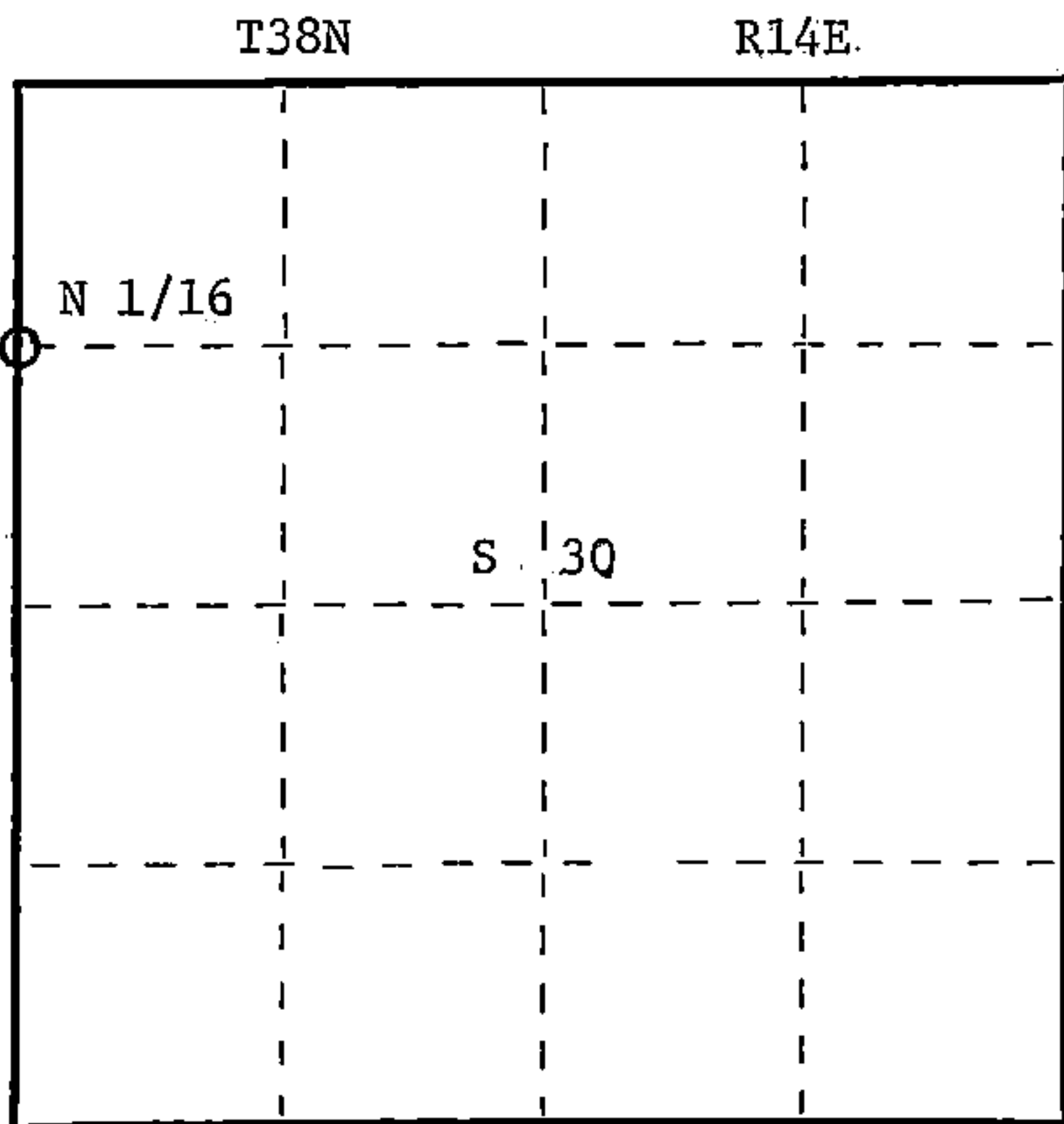
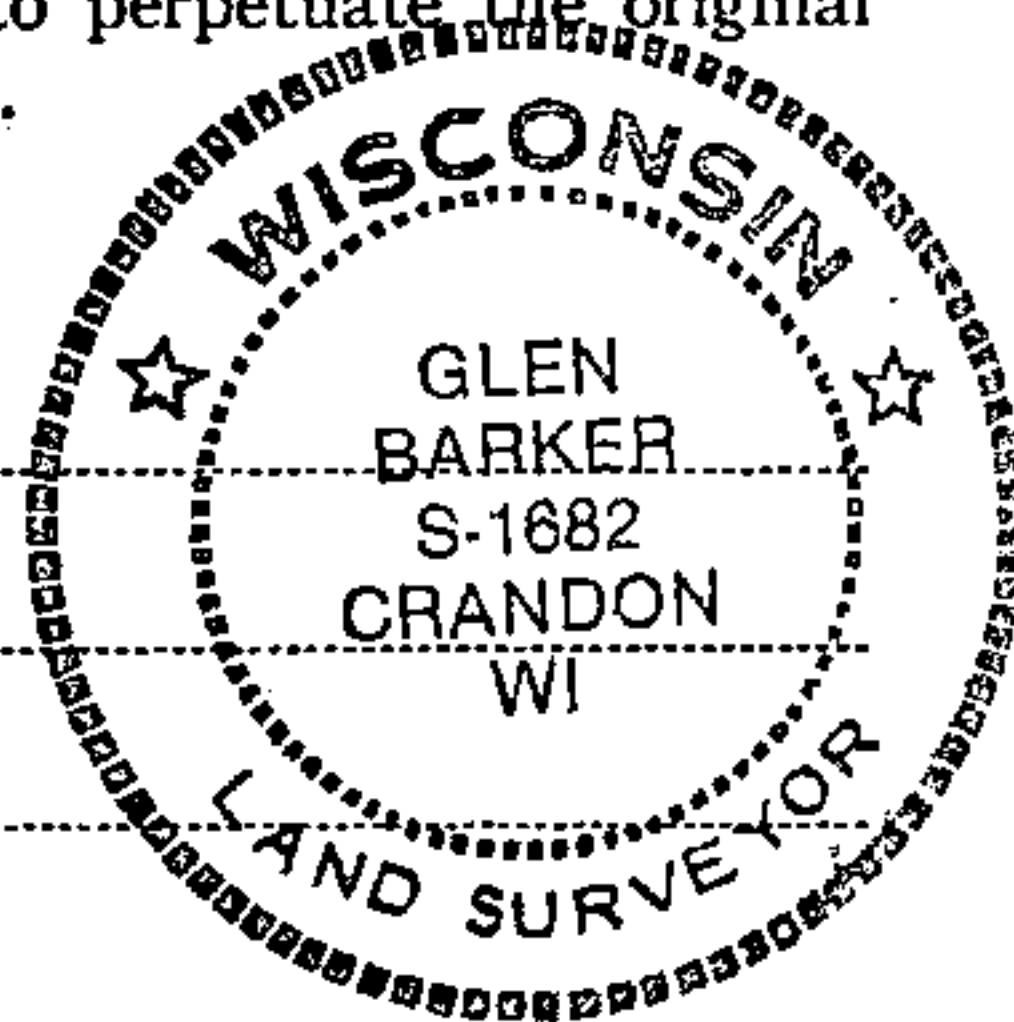

○ = Corner monument restored.

History of original corner establishment:

No evidence of any previous corner.

Description of corner evidence found:

Total distance from section corner 24-25-19-30 T38N R13&14E to 1/4 corner between sections 25 & 30 is 2620.72'.
Set N 1/16 1310.36' intermediate.

Description of monument and accessories I established to perpetuate the original location of this corner.

Set a 1" iron pipe projecting 6" above ground.

NBTs:

Cedar 8" N7°W 23.85'
Hemlock 10" S76E 19.16'

Dated at Rhineland, Wis., this 6th day of February, 1985.

Signature: Glen Barker Title Registered Land Surveyor Registration No. 1682
(County Surveyor, Registered Land Surveyor, or other duly authorized official)

Office of Register of Deeds, County of Forest, I hereby certify that the within instrument was filed in this office for record on the 22nd day of February, 1985 at 2:15 o'clock P. M.

Paul Aschenbrenner
(Register of Deeds)

By _____ Deputy

Document Number **127511**

FORM 985 X. E. MILLER CO., MILWAUKEE

43813363000