

U.S. PUBLIC LAND SURVEY MONUMENT RECORD

Index No. V-11

State of Wisconsin }
County of Forest } ss.

I, William B. Cochran, do hereby certify that on the 15th day of June, 1990, I found evidence of the North Quarter corner of Section 33 Township 38 North, Range 13 East, Fourth Principal Meridian, as described hereon; and that from this evidence I established a new monument and accessories as described hereon to perpetuate the original location of this corner.

Resident witnesses:

.....
.....
.....

History of original corner establishment:

Original Government Survey in 1865 by H. & J.L. Nowlin. West corrected between Sections 28 and 33, at 39.75 chains, set Quarter Section Post to Sections 28 and 33, from which the following bear;

Hemlock 14" N39°E 10 lks.
Hemlock 7" S45°W 10 lks.

Description of corner evidence found:

No corner evidence was recovered.

I re-established the corner position at proportionate distance and on line between the Northeast and Northwest Section Corners of Section 33.

Corner position falls in a beaver pond, therefore witnessed as described below.

Description of monument and accessories I established to perpetuate the original location of this corner.

At a point N82°-50'-21"E a distance of 230.62 feet, set a witness corner monument, 2½ inches in diameter, 3 feet long, 2½ feet in the ground with an aluminum cap stamped; T38N, R13E, Witness Corner, S82°-50'-21"W, 230.62 feet, 1/4, S28, S33, 1990, S-1107. From which the following new blazed and scribed bearing trees bear;

Hemlock 18" N10°E 73.53 feet
Cedar 20" N65°E 94.41 feet
Steel Sign Post NW 0.50 feet

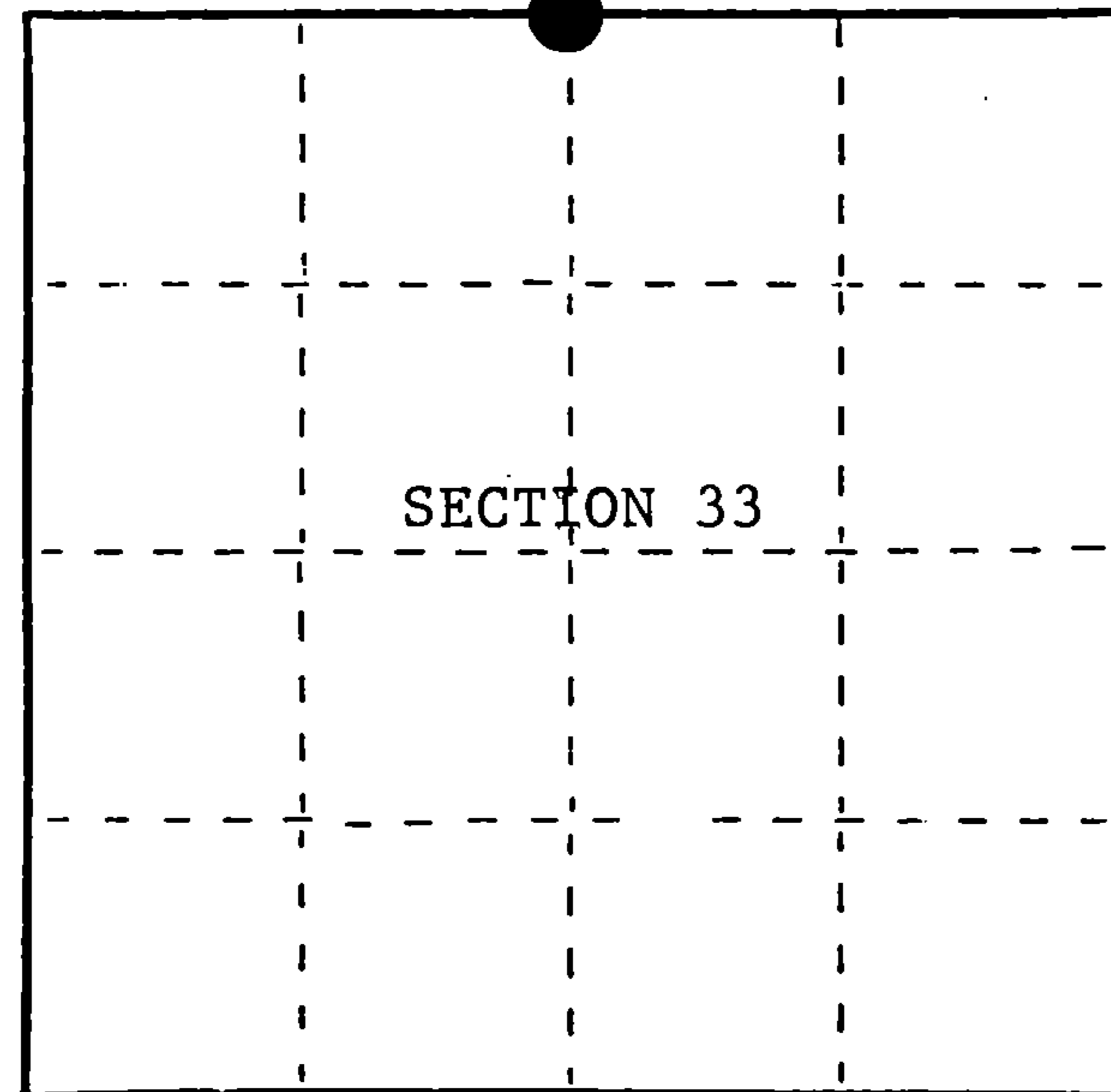

● = Corner monument restored.

Dated at Hiles, Wis., this 14th day of February, 1991

Signature: William B. Cochran, Land Surveyor, Registration No. S-1107
(County Surveyor, Registered Land Surveyor, or other duly authorized official)

Office of Register of Deeds, County of Forest, I hereby certify that the within instrument was filed in this office for record on the 31st day of August, 1992 at 10:15 o'clock A.M.

Paul Achenbrenner
(Register of Deeds)

By _____ Deputy

FORM NO. 985-A

H.C. Miller Company

Stock No. 26273

DOCUMENT NUMBER

145345

43813280020

(e) Describe any material discrepancy between the location of the corner as restored or reestablished and the location of that corner as previously restored or reestablished by distance and direction. Show the discrepancy on the plan view drawing under (d), above. Show the distances between the corner as previously restored or reestablished and (1) the corner as restored or reestablished, and (2) to at least 2 of the witness monuments shown on the drawing in (d), above.

See drawing below.

(f) Was the corner restored through acceptance of (1) an obliterated evidence location, or, (2) a found perpetuated location?

(g&h) Was the corner reestablished through lost corner proportionate methods? If so, show the method, including the directions and distances to other public land survey corners used as evidence or used for proportioning in determining the corner location?

Re-established through lost corner proportionate methods.

S29 | S28 G.L.O. 39.75 chs. 1/4 G.L.O. 39.75 chs. S28 | S27
S32 | S33 N88°-11'-51"E 2648.27' N88°-11'-51"E 2648.27' S33 | S34

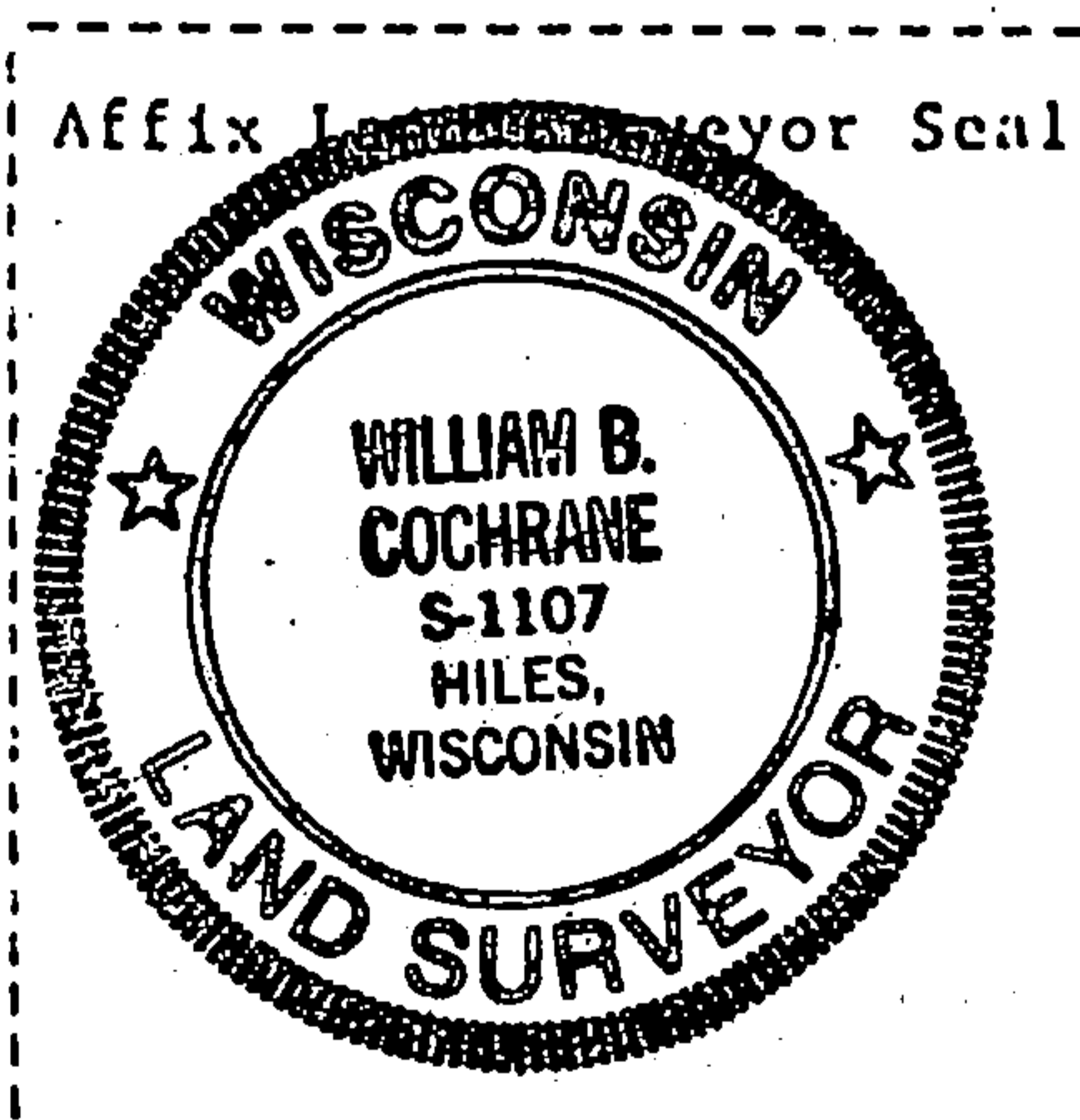
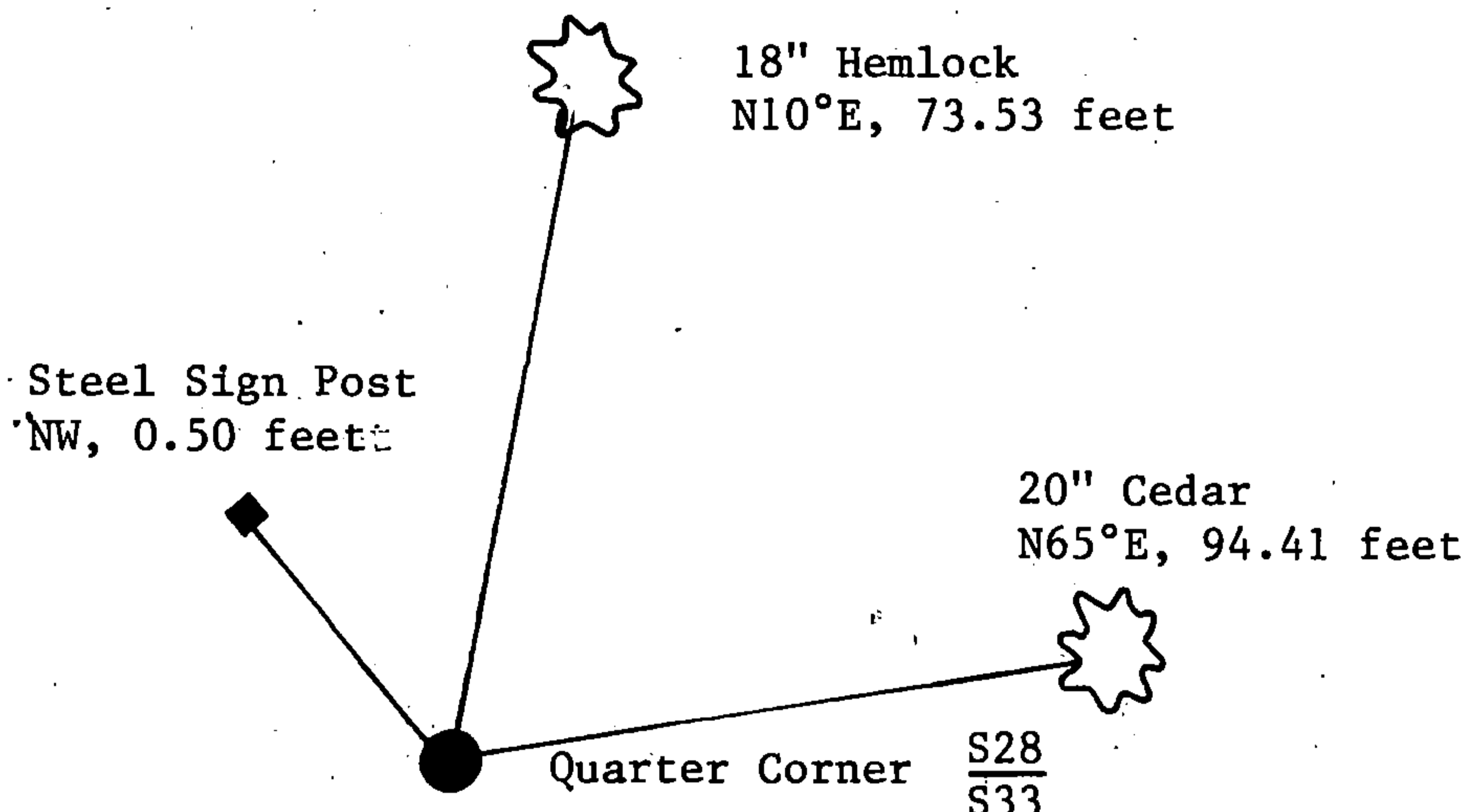

(i) I, William B. Cochrane
(type or print name) certify that the corner location shown on this record was determined by me or under my direction and control and that this U.S. Public Land Survey Monument Record is correct and complete to the best of my knowledge and belief.

William B. Cochrane 1/21/92
Signature Date

Survey requested by: Carole York 1/22/92
District Ranger Date