

CERTIFIED LAND CORNER RESTORATION

Index No. R-1

State of Wisconsin }
County of Forest } ss.

I Philip T. Hansen, do hereby certify that on the 14th day of December, 1977, I found evidence of the Section corner of Sec. 24, 25, 19 & 30 Township 38, North, Range 13 & 14 East, Fourth Principal Meridian, as described hereon; and that from this evidence I established a new monument and accessories as described hereon to perpetuate the original location of this corner.

Resident witnesses:

Glen Barker
Jim Claflin
Herb Wagoner



FORM 985 R. C. MILLER CO., MILWAUKEE

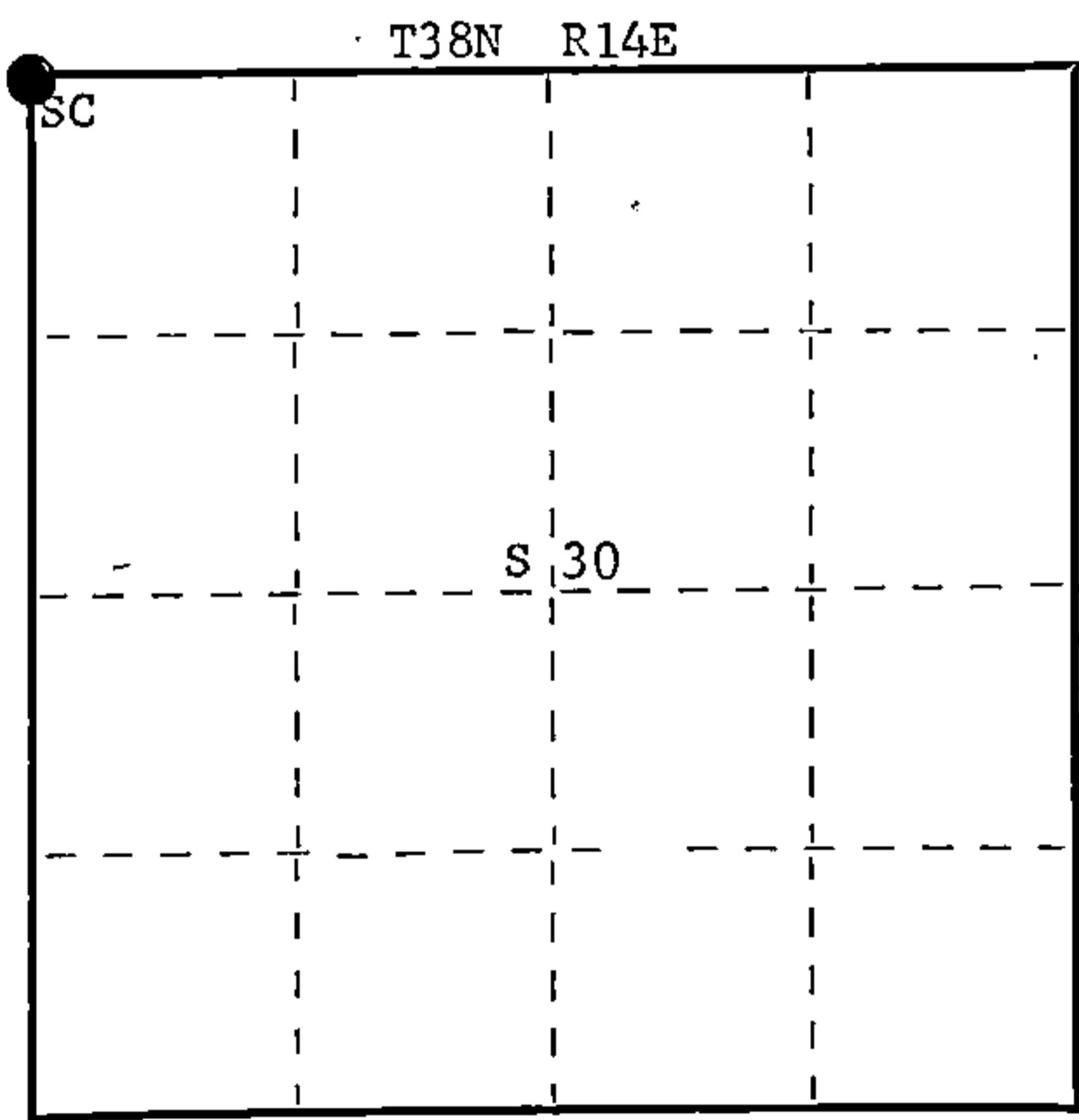

○ = Corner monument restored.

History of original corner establishment:

Original corner established by Alfred Millard, Deputy Surveyor, in 1857, from which spruce 6" bears N58°W, 18 links; Spruce 7" bears N15°E, 24 links; Tamarack 14" bears S24°E, 8 links; Tamarack 12" bears S24°W, 26 links.

Description of corner evidence found:

Recovered very old 3" squared cedar post standing and projecting 3' above ground. No evidence of any scribe marks remain as it was decayed. Searched for but couldn't find evidence of any BTs.

Description of monument and accessories I established to perpetuate the original location of this corner.

Replaced cedar post with 2½" Berntsen A-1 Federal Monument projecting 10" above ground. Cap stamped:

Marked NBTs - Cedar 10" S76°W, 20.3 links
Cedar 5" S22°W, 40.0 links
Cedar 6" N30°W, 38.3 links
Cedar 9" S62°E, 49.24 links
All scribed SC BT.

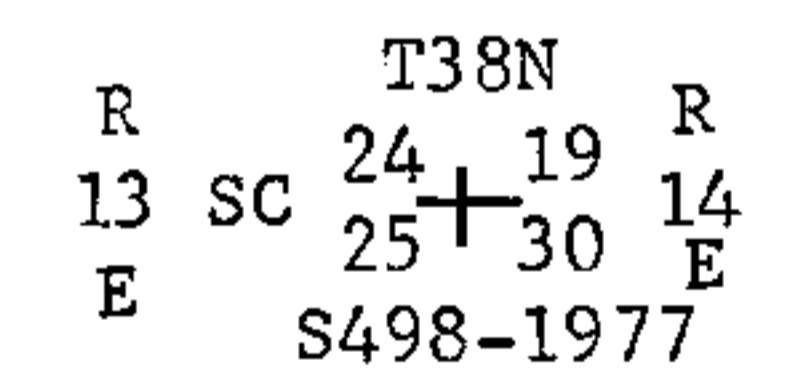

Dated at Rhineland, Wis., this 19th day of December, 1977.

Signature Philip T. Hansen Title Registered Land Surveyor Registration No. S-498
(County Surveyor, Registered Land Surveyor, or other duly authorized official)

Office of Register of Deeds, County of Forest, I hereby certify that the within instrument was filed in this office for record on the 28th day of December, 1977 at 4:00 o'clock P. M.

Eugene Staszny
(Register of Deeds)
By _____ Deputy

DOCUMENT NUMBER **113054**

43813240000

U.S. PUBLIC LAND SURVEY MONUMENT RECORD

Index No. R-25.....

State of Wisconsin }
County of Forest } ss.

I, Milo E. Stefan, do hereby certify that on the 9th day of June, 1990, I found evidence of the Section corner of Sections 24, 25, 19 & 30 Township 38 North, Range 13 & 14 East, Fourth Principal Meridian, as described hereon; and that from this evidence I established a new monument and accessories as described hereon to perpetuate the original location of this corner.

Resident witnesses:

None

History of original corner establishment:

Original corner established by Alfred Millard, Deputy Surveyor, in 1857, from which spruce 6" bears N58°W, 18 links; Spruce 7: bears N15°E, 24 links; Tamarack 14" bears S24°E, 8 links; Tamarack 12" bears S24°W, 26 links.

Description of corner evidence found: 12/14/77 by Philip T. Hansen

Recovered very old 3" squared cedar post standing and projecting 3' above ground. No evidence of any scribe marks remain as it was decayed. Searched for but couldn't find evidence of any BTs.

6/9/1990 - We found Forest County monument in loose soil and very unstable. Hansen's BTs all in good condition:

- 9" Cedar, S62°E, 49.24 Links
- 5" Cedar, S22°W, 40.0 Links
- 10" Cedar, S76°W, 20.3 Links
- 6" Cedar, N30°W, 38.3 Links

Description of monument and accessories I established to perpetuate the original location of this corner.

Replaced Forest County monument with a 2" x 60" aluminum monument and set steel sign post:

- 9" Cedar, S62°E, 32.80'
- 5" Cedar, S22°W, 26.60'
- 6" Cedar, N30°W, 25.78'
- 10" Cedar, S76°W, 14.05'
- 6" Steel Sign Post, Northwest, 1.0'

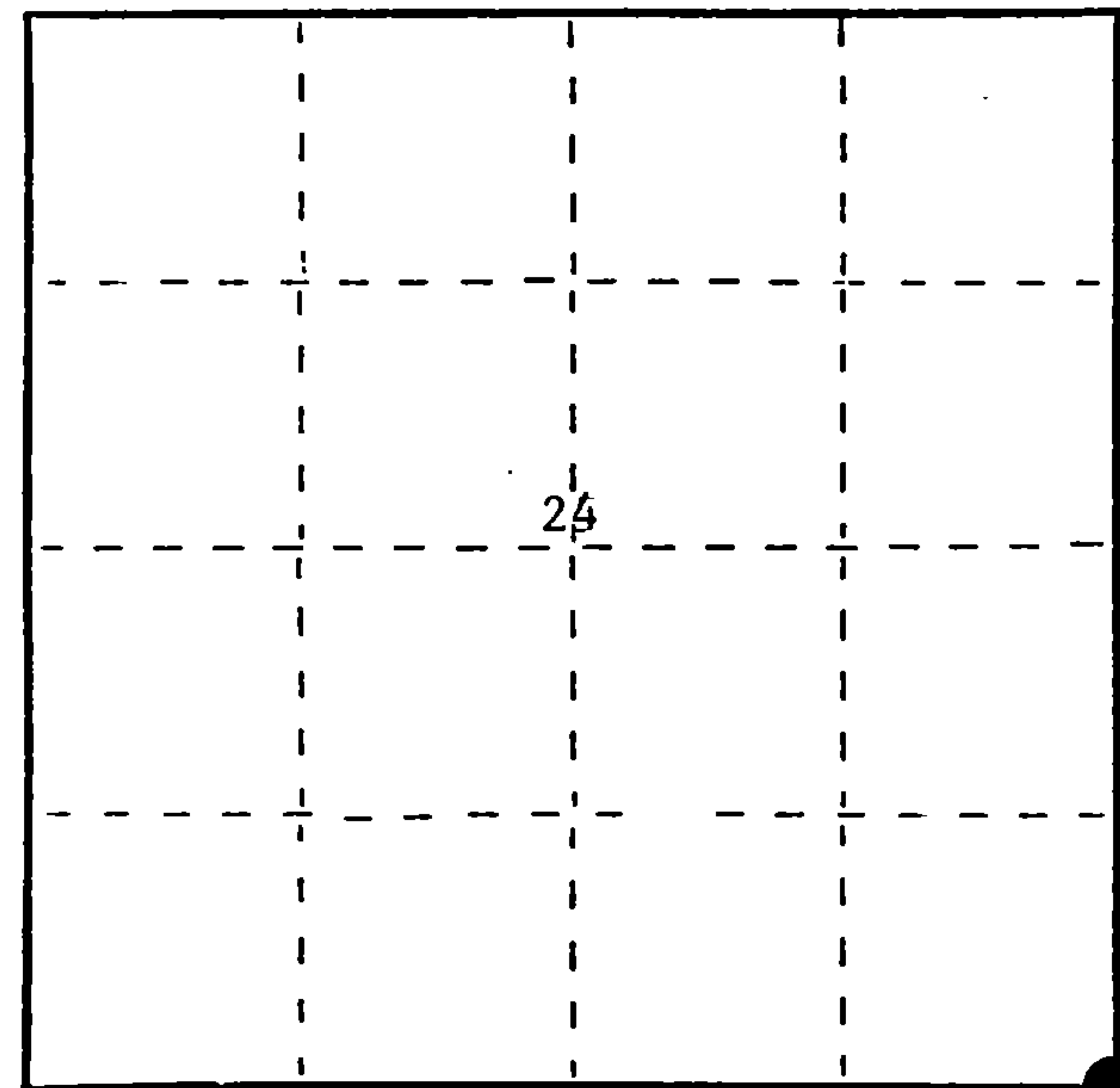

● = Corner monument restored.

Dated at Rhinelander, Wis., this 9th day of July, 1990

Signature: Milo E. Stefan Title: Land Surveyor Registration No. 1558
(County Surveyor, Registered Land Surveyor, or other duly authorized official)

Office of Register of Deeds, County of Forest, I hereby certify that the within instrument was filed in this office for record on the 10th day of December, 1991 at 10:15 o'clock A.M.

(Register of Deeds)
By: [Signature] Deputy

FORM NO. 985-A

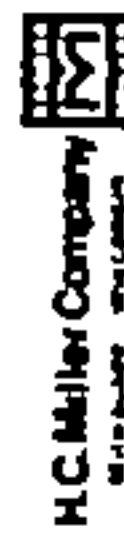

Stock No. 26273
DOCUMENT NUMBER

143395

43813240000

e) Describe any material discrepancy between the location of the corner as restored or reestablished and the location of that corner as previously restored or reestablished by distance and direction. Show the discrepancy on the plan view drawing under (d), above. Show the distances between the corner as previously restored or reestablished and (1) the corner as restored or reestablished, and (2) to at least 2 of the witness monuments shown on the drawing in (d), above.

None

(f) Was the corner restored through acceptance of (1) an obliterated evidence location, or, (2) a found perpetuated location?

A found perpetuated location.

(g&h) Was the corner reestablished through lost corner proportionate methods? If so, show the method, including the directions and distances to other public land survey corners used as evidence or used for proportioning in determining the corner location?

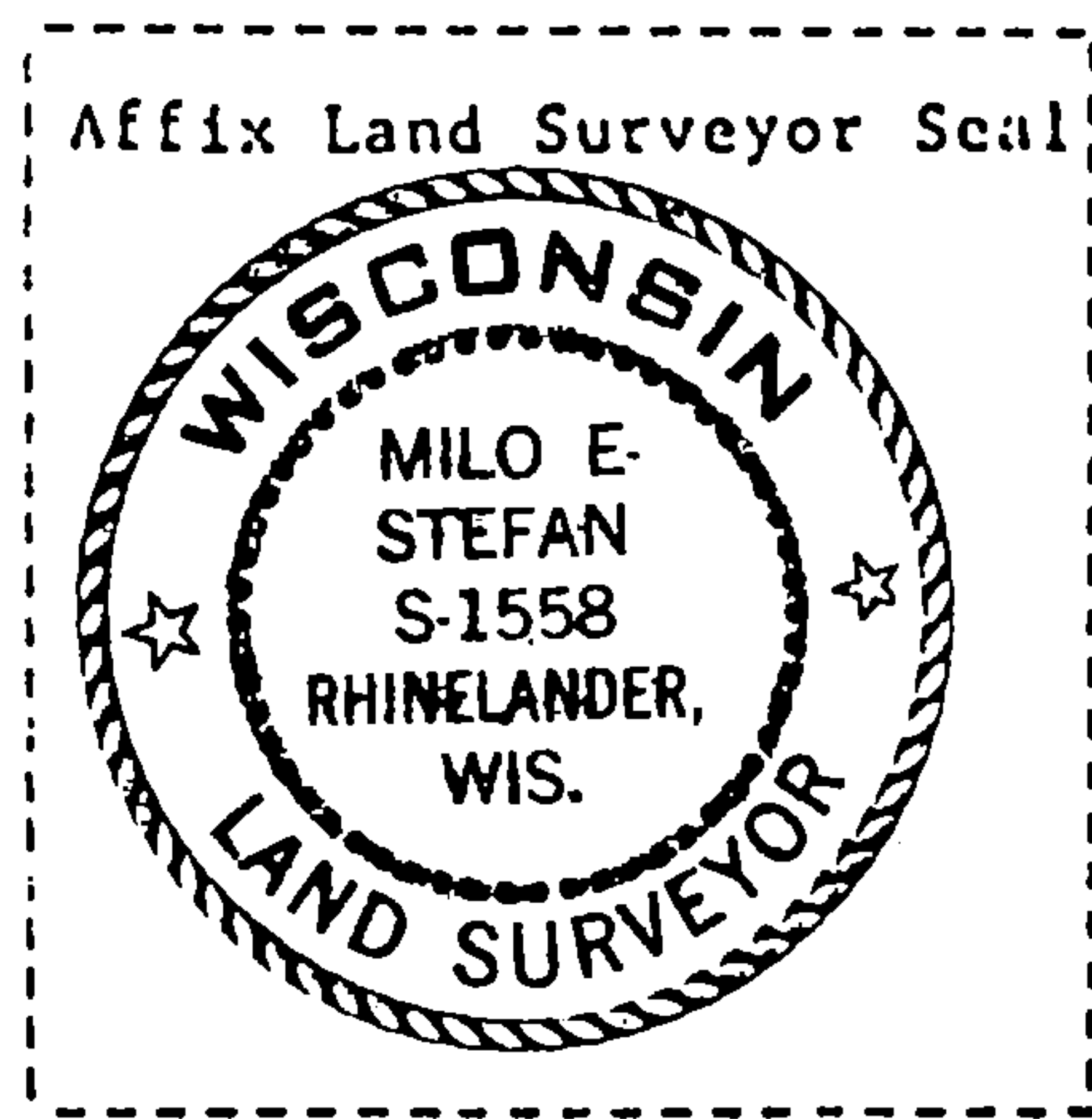
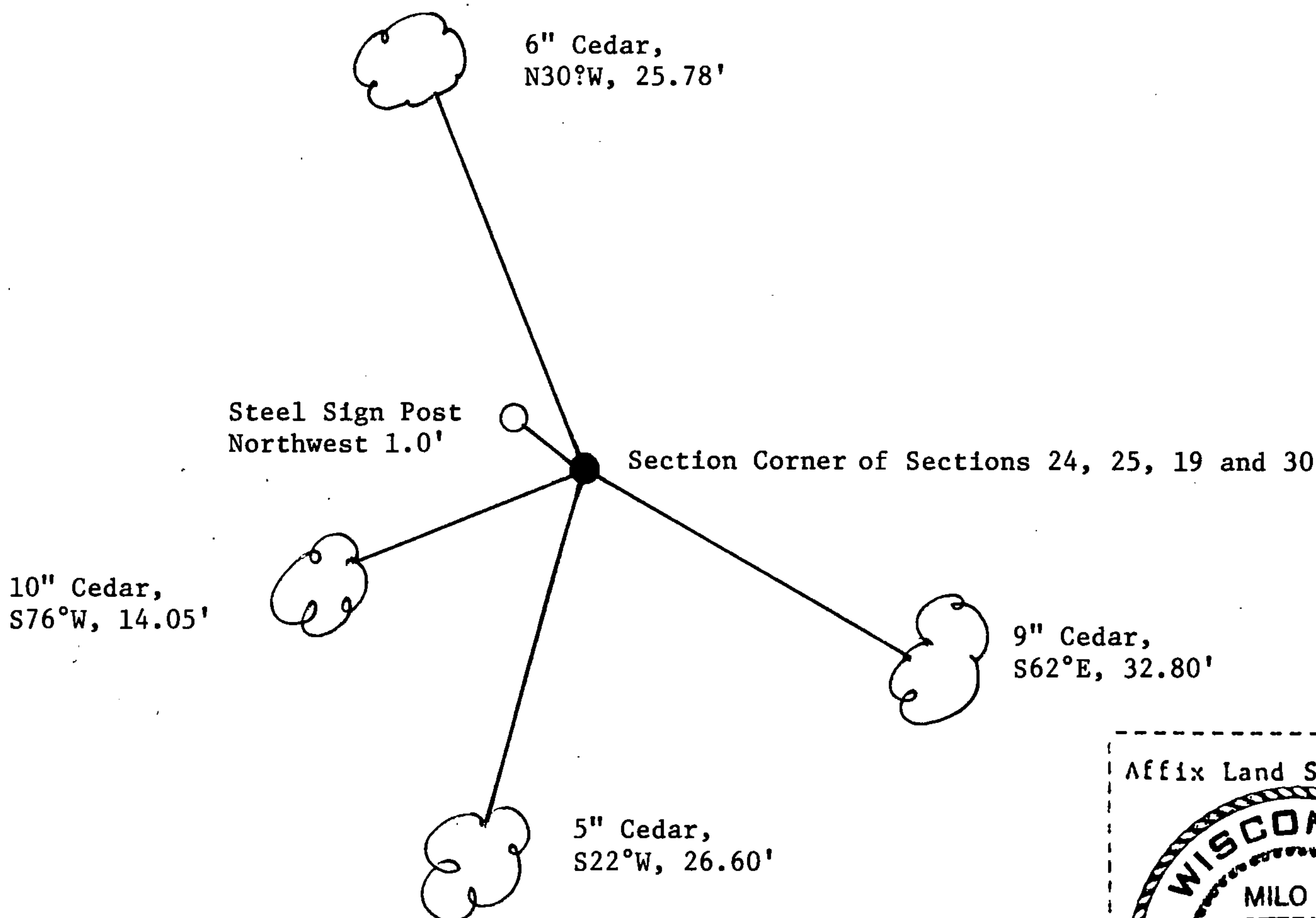

(i) 1. Milo E. Stefan
 (type or print name) certify that the corner location shown on this record was determined by me or under my direction and control and that this U.S. Public Land Survey Monument Record is correct and complete to the best of my knowledge and belief.

Milo E. Stefan
 Signature

7/9/1990
 Date

Survey requested by: Dale Staege
 District Ranger

6/4/91
 Date