

CERTIFIED LAND CORNER RESTORATION

State of Wisconsin }
 County of Forest } ss.

I, Jean F. Resvick, do hereby certify that on the 18 day of July, 19 67, I found evidence of the North quarter corner of Section 18 Township 38 North, Range 12 East, Fourth Principal Meridian, as described hereon; and that from this evidence I established a new monument and accessories as described hereon to perpetuate the original location of this corner:

Description of original monument and accessories and subsequent restorations:

Surveyed in 1859 by William E. Daugherty. Dependent resurvey by Wesson Cook in 1937. From the remains of the original bearing trees, set an iron post, 3 ft. long, 2 in. dia., 26 ins. in ground for the 1/4 section corner with brass cap marked: 1/4, S7, S18, 1937, from which:
 A tamarack, 14 in. stump, N52°W, 10 lks.
 A tamarack, 14 in. fallen, S55°E, 8 lks.
 A cedar, 5 in. N36° 15'E, 27 lks.
 A cedar, 5 in. S58° 15'E, 32 lks.

Description of corner evidence found:

Monument as described above in place.
 A cedar, 7 in., N36°E, 18.0 ft. or 27.27 lks.
 A cedar, 9 in., S58°W, 21.0 ft. or 31.81 lks.

Description of monument and accessories I established to perpetuate the original location of this corner:

Set 4 x 4 cedar post 4' above ground NW of monument.

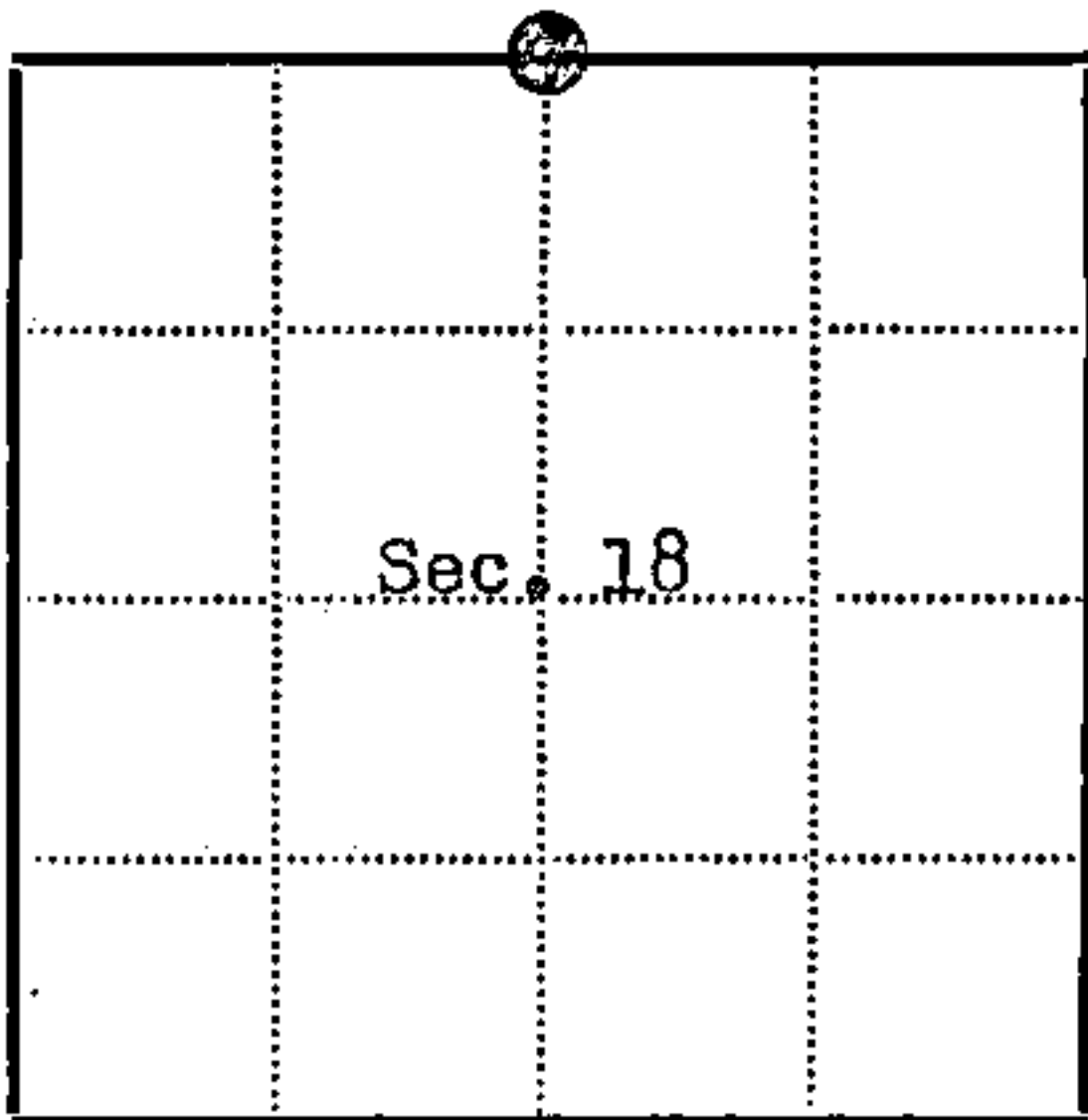
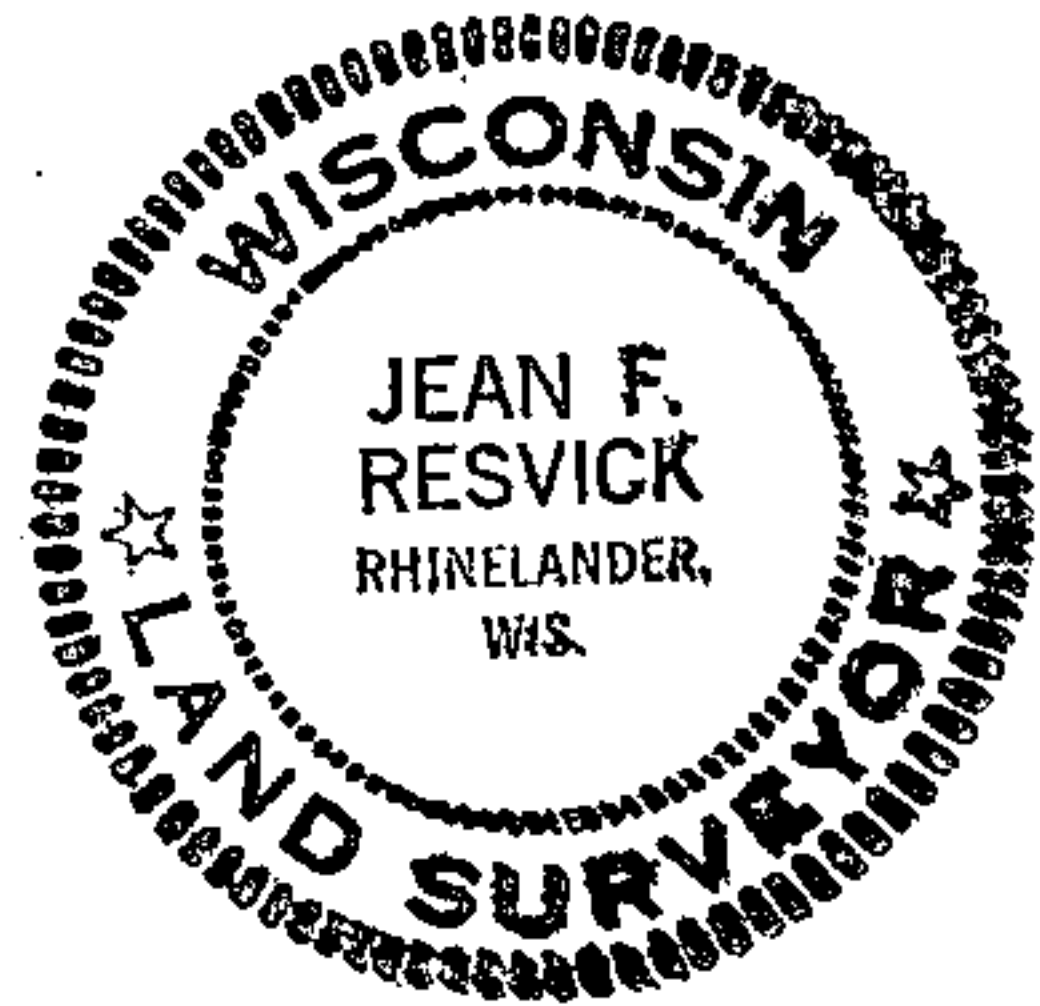

● = Corner monument restored
 □ =

Resident witnesses.....

Dated at Rhinelander Wisconsin, this 21st day of Feb. 19 68.

Signature Jean F. Resvick Title Cadastral Surveyor
 (County Surveyor, Registered Land Surveyor, or other duly authorized official)

Surveyors Registration No. S-802 DOC. NO. 94223

Office of Register of Deeds County of Forest

I hereby certify that the within instrument was filed in this office for record on the 27th day of February, 19 68, and was filed in Book No. I Page No. _____ of County Records.

Signature Eugene Stately Title Register of Deeds

Township 38 North, Range 12 East, Section 18, Index No. J-3, Page No. _____

43812070020

U.S. PUBLIC LAND SURVEY MONUMENT RECORD

Index No. J-3

State of Wisconsin }
County of Columbia } ss.

I, James R. Grothman, do hereby certify that on the 20th day of October, 1986, I found evidence of the One Quarter corner of Sections 7 and 18 Township 38 North, Range 12 East, Fourth Principal Meridian, as described hereon; and that from this evidence I established a new monument and accessories as described hereon to perpetuate the original location of this corner.

Resident witnesses:

East

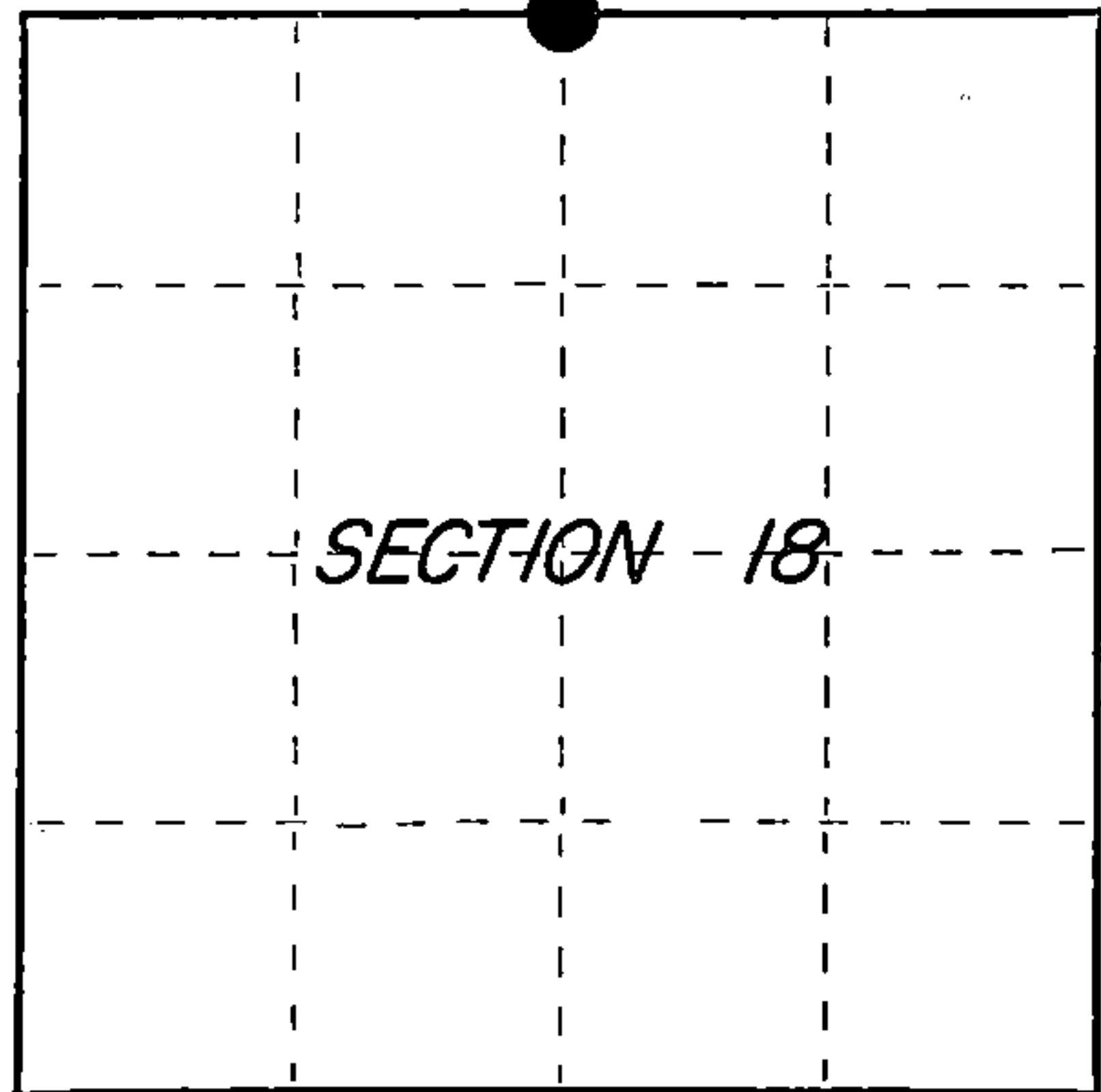

○ = Corner monument restored.

History of original corner establishment: Original survey in 1859 by William E. Daugherty. Dependent resurvey in 1937 by Wesson Cook. Set an iron post 3 feet long, 2 inch diameter, 26 inches in the ground with brass cap marked:

1/4	S7	From which the following bear:			
	S18				
1937	Tamarack stump	14"	N52°W	6.60	feet
	Tamarack fallen	14"	S55°E	5.28	feet
	Cedar	7"	N36°15'E	18.00	feet
	Cedar	9"	S58°15'E	21.00	feet

Dependent resurvey in 1968 by Jean F. Resvick. Set a 4"x4" cedar post 4 inches above ground northwest of monument. Description of corner evidence found:

G.L.O. Monument as described above in place. The following bearing tree:

Cedar	8"	N36°E	18.00	feet
-------	----	-------	-------	------

Description of monument and accessories I established to perpetuate the original location of this corner.

Corner in good condition. Blazed, scribed, painted, and posted the following bearing trees:

Cedar	7"	N66°W	13.61	feet
Cedar	10"	S51°E	8.70	feet
Spruce	6"	N8°E	7.12	feet
Steel Sign Post		East	1.00	foot +

Dated at PORTAGE, Wis., this 30 day of OCTOBER, 19 86

Signature James R. Grothman Title RLS Registration No. 1321
(County Surveyor, Registered Land Surveyor, or other duly authorized official)

Office of Register of Deeds, County of Forest, I hereby certify that the within instrument was filed in this office for record on the 24th day of February, 19 87 at 2:00 o'clock P. M.

Paul Hochendrenner
(Register of Deeds)

By Deputy

REGISTER'S OFFICE
Forest County, Wis.

Received for record this 24th day of February A.D. 1987 at 2:00 o'clock P.M. and recorded in Vol. CORNER RESTORATIONS page 13

Paul Hochendrenner
Register of Deeds

FORM NO. 985-A

H.C. Miller Company

Stock No. 26273

FOREST COUNTY

DOCUMENT NUMBER
132153

43812670020

(e) Describe any material discrepancy between the location of the corner as restored or reestablished and the location of that corner as previously restored or reestablished by distance and direction. Show the discrepancy on the plan view drawing under (d), above. Show the distances between the corner as previously restored or reestablished and (1) the corner as restored or reestablished, and (2) to at least 2 of the witness monuments shown on the drawing in (d), above.

See drawing below

(f) Was the corner restored through acceptance of (1) an obliterated evidence location, or, (2) a found perpetuated location?

Corner was restored through acceptance of a found perpetuated location.

(g&h) Was the corner reestablished through lost corner proportionate methods? If so, show the method, including the directions and distances to other public land survey corners used as evidence or used for proportioning in determining the corner location?

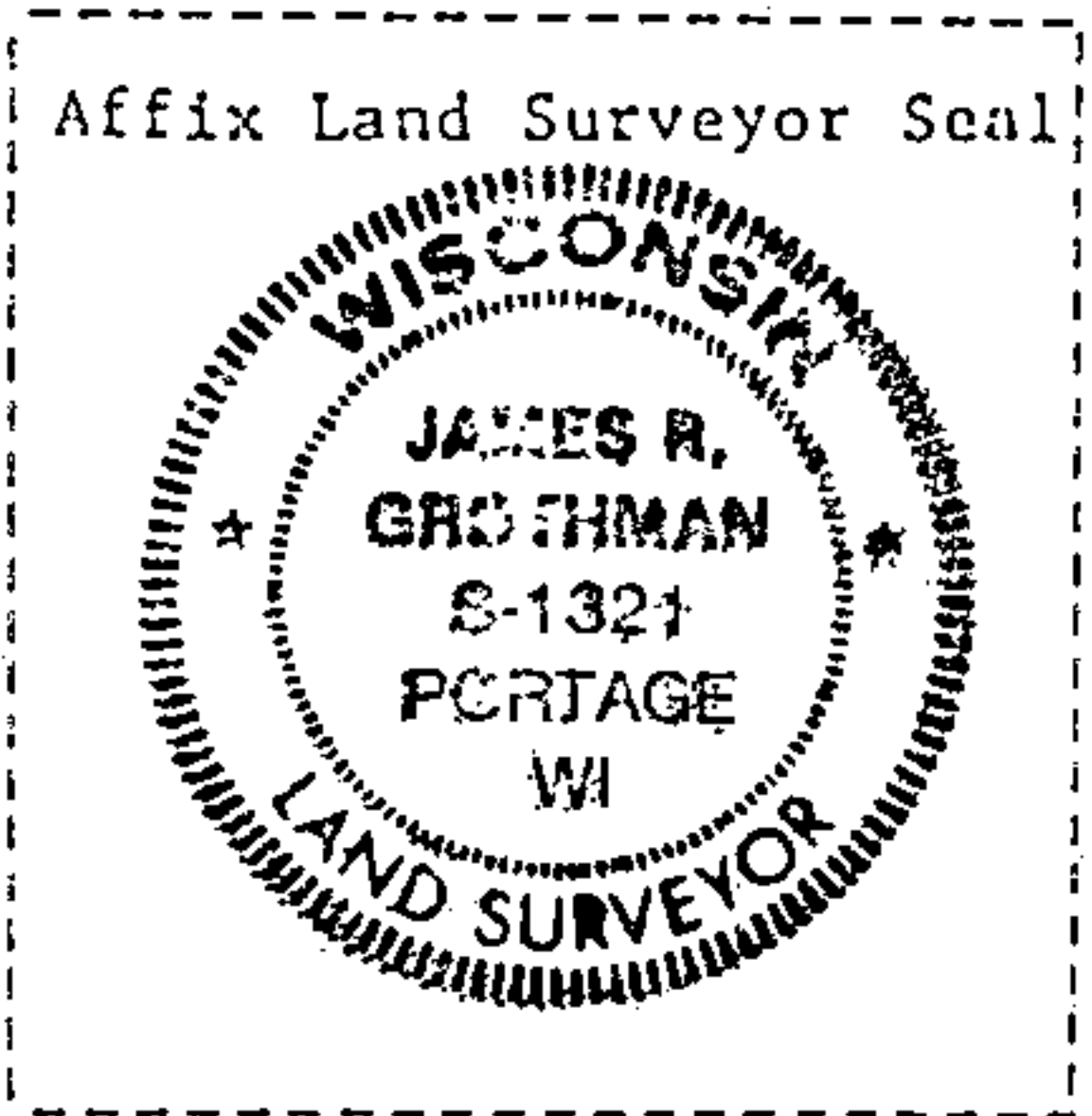
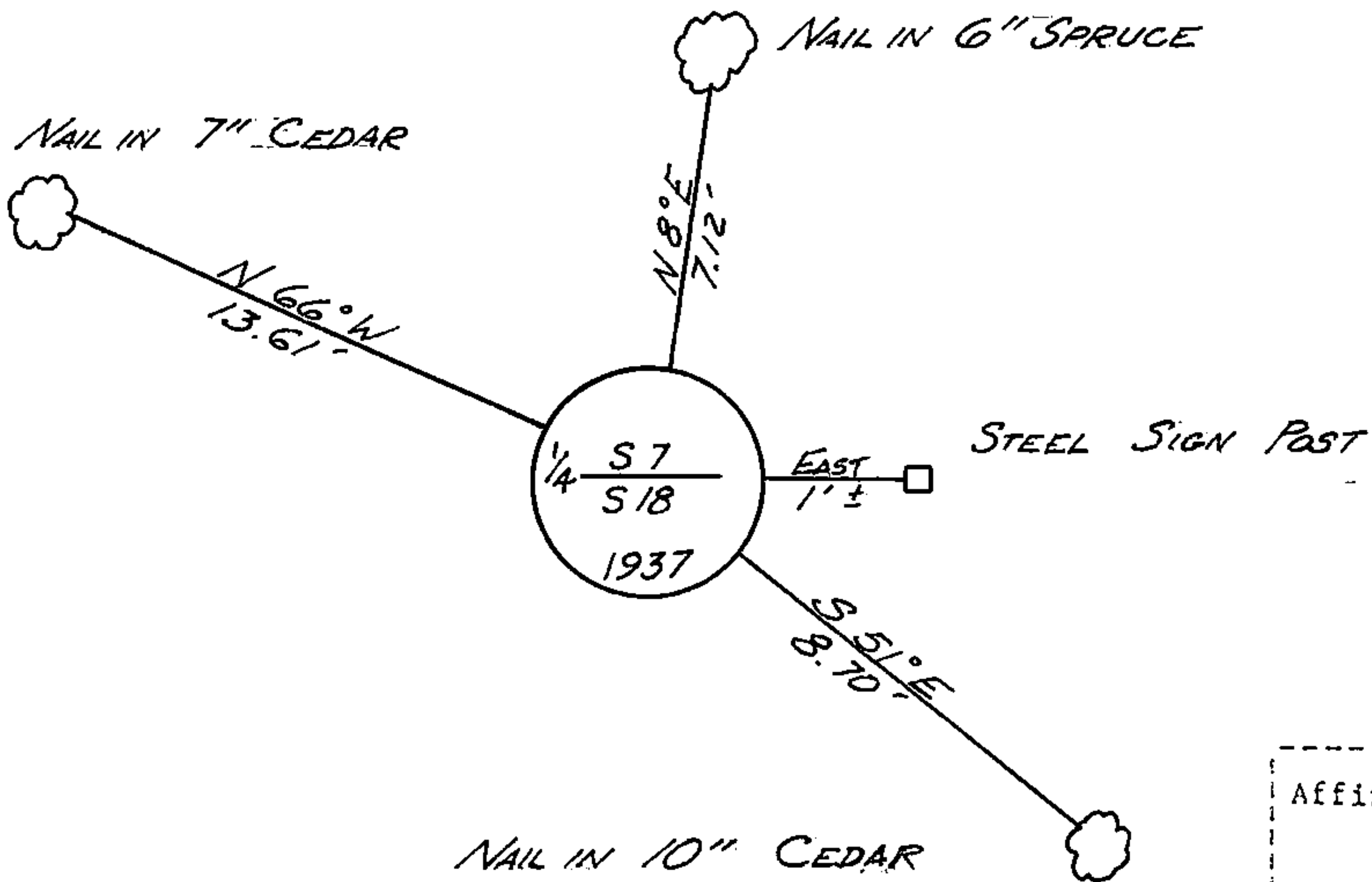

(i) I, JAMES R. GROTHMAN, Registered Land Surveyor No. 1321
 (type or print name) certify that the corner location shown on this record was determined by me or under my direction and control and that this U.S. Public Land Survey Monument Record is correct and complete to the best of my knowledge and belief.

James R. Grothman 10/30/86
 Signature Date

Certificate ready for filing: M. Brenda Huber 1/6/87
 District Ranger Date