

State of Wisconsin }  
County of Forest } ss.

I, Gary L. Pisoni, do hereby  
certify that on the 1st day  
of April, 1994, I found  
evidence of the West Quarter  
corner of Section 35  
Township 37, North, Range  
15 East, Fourth Principal Meridian,  
as described hereon; and that from this evidence  
I established a new monument and accessories  
as described hereon to perpetuate the original  
location of this corner.

Resident witnesses:  
\_\_\_\_\_  
\_\_\_\_\_  
\_\_\_\_\_

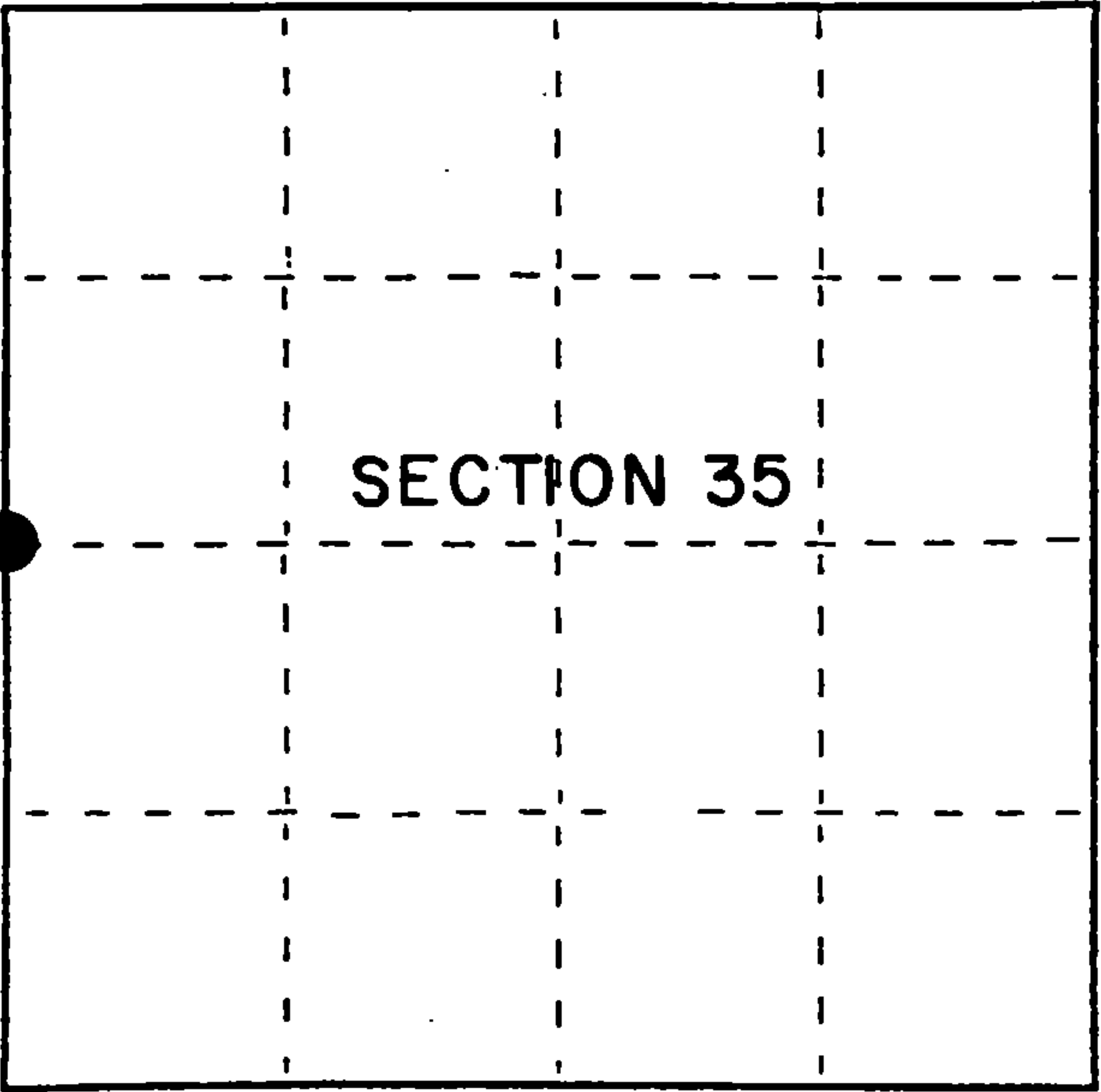

● = Corner monument restored.

History of original corner establishment:

Original Government Survey in 1865 by J. L. Nowlin, deputy surveyor.

In 1981, Milo E. Stefan RLS U.S.F.S. recovered a wood post marking the corner position. He accepted the wood post as the best available evidence for restoring the corner position. Replaced old post with a 2"x30" aluminum capped pipe monument from which the following bear:

Sugar	5"	N 65° E	20.84 feet	Sugar	6"	N 09° W	38.75 feet
Sugar	8"	S 89° W	13.22 feet	Steel sign post	South	1.4 feet	

Description of corner evidence found:

Found the monument and bearing trees as described above:

Sugar	11"	N 65° E	20.84 feet
Sugar	13"	S 89° W	13.22 feet
Sugar	12"	N 09° W	38.75 feet
Steel sign post	South	1.4 feet	

Description of monument and accessories I established to perpetuate the original location of this corner.

Dated at Iron River, MI, ~~Wis.~~, this 13th day of May, 1995

Signature Gary L. Pisoni Title Land Surveyor Registration No. S-1634  
(County Surveyor, Registered Land Surveyor, or other duly authorized official)

Office of Register of Deeds, County of Forest, I hereby certify that the within  
instrument was filed in this office for record on the 10th day of March, 1997  
at 1:30 o'clock P M.

\_\_\_\_\_  
(Register of Deeds)  
By Paul J. Tamburino Deputy

FORM NO. 985-A  
H.C. Miller  
Stock No. 26273  
158142

45715 342000

- (e) Describe any material discrepancy between the location of the corner as restored or reestablished and the location of that corner as previously restored or reestablished by distance and direction. Show the discrepancy on the plan view drawing under (d), above. Show the distances between the corner as previously restored or reestablished and (1) the corner as restored or reestablished, and (2) to at least 2 of the witness monuments shown on the drawing in (d), above.

None

- (f) Was the corner restored through acceptance of (1) an obliterated evidence location, or, (2) a found perpetuated location?

Restored through acceptance of a found perpetuated location.

- (g&h) Was the corner reestablished through lost corner proportionate methods? If so, show the method, including the directions and distances to other public land survey corners used as evidence or used for proportioning in determining the corner location?

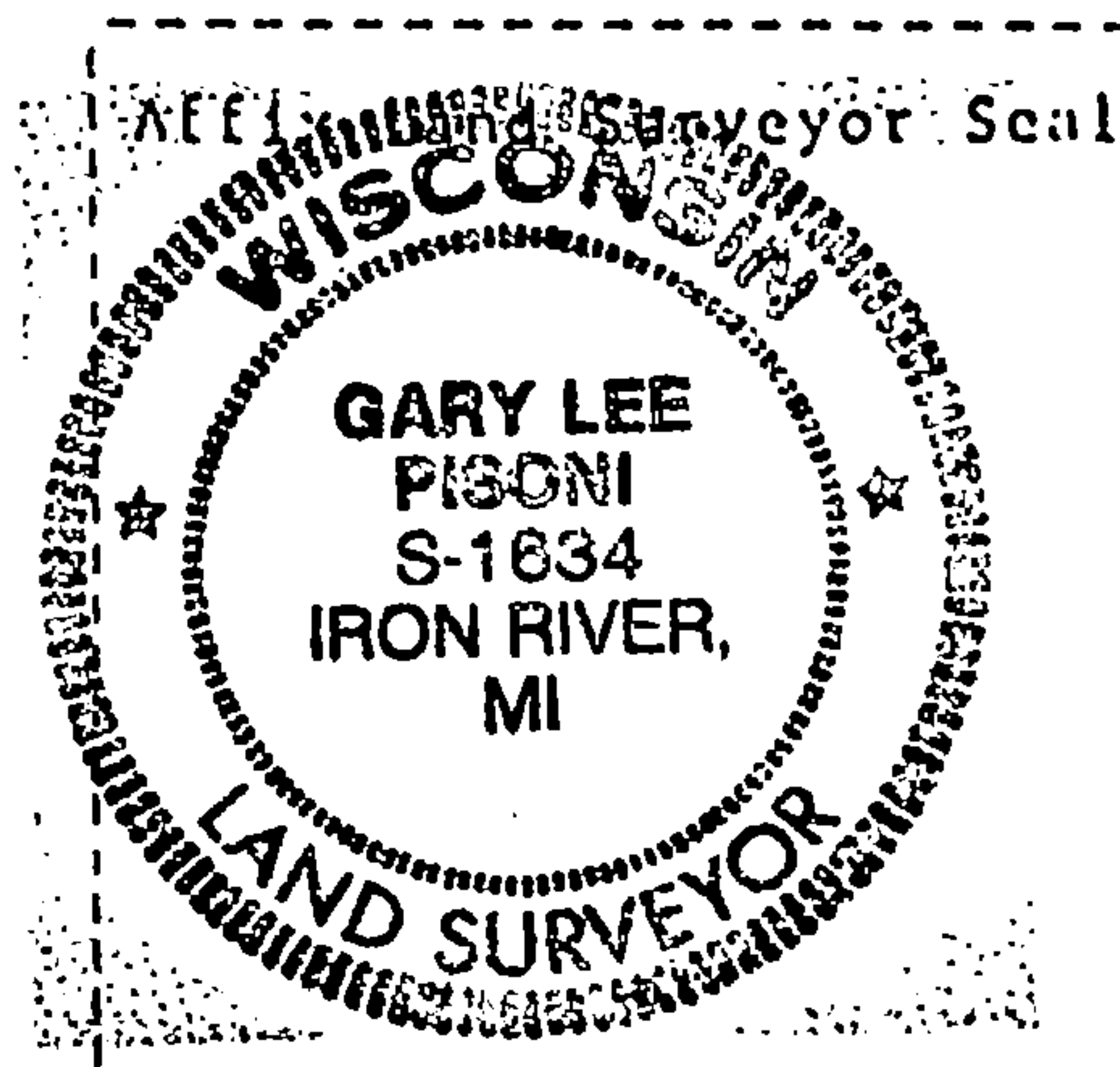
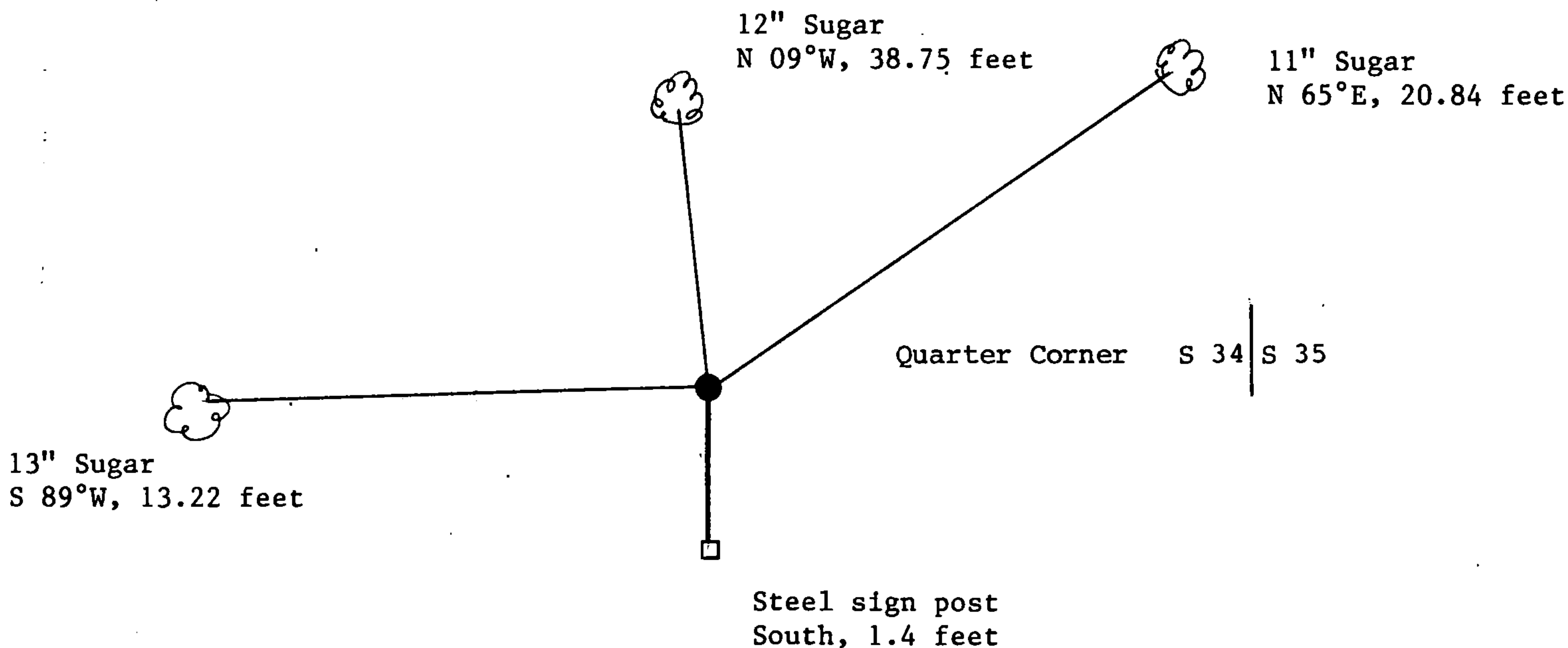

- (i) I, Gary L. Pisoni  
(type or print name) certify that the corner location shown on this record was determined by me or under my direction and control and that this U.S. Public Land Survey Monument Record is correct and complete to the best of my knowledge and belief.

Signature

Date

5-24-96