

CERTIFIED LAND CORNER RESTORATION

Index No. **T-33**

State of Wisconsin }  
County of Forest } ss.

I Daniel K. Pleoger, do hereby certify that on the 30 day of June, 19 81, I found evidence of the C 1/4 corner of Section 30 Township 37 North, Range 15 East, Fourth Principal Meridian, as described hereon; and that from this evidence I established a new monument and accessories as described hereon to perpetuate the original location of this corner.

Resident witnesses:

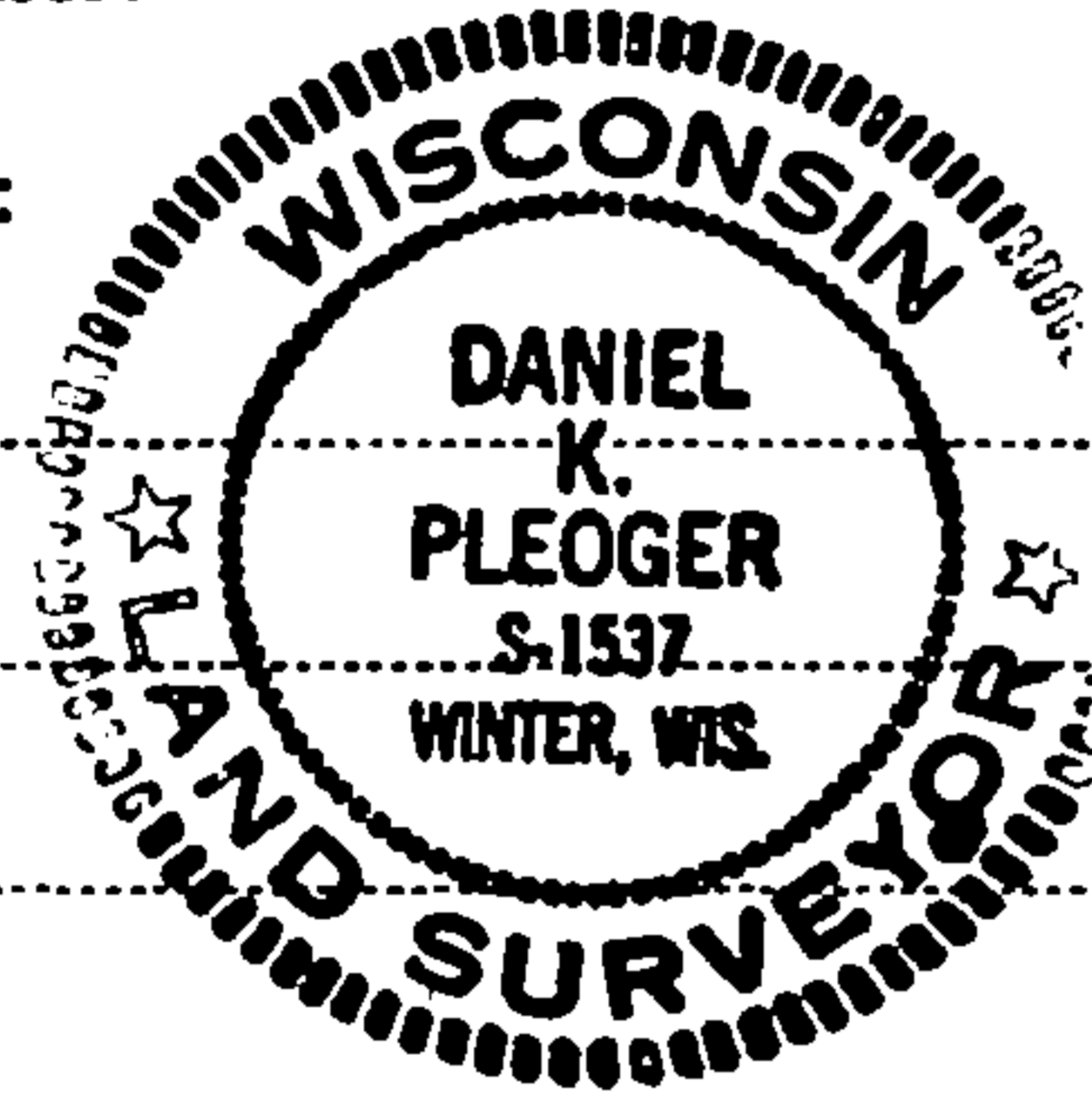

History of original corner establishment:  
No evidence of any previous corner

Description of corner evidence found:

Corner established by subdivision of Section 30.  
Corner sets S0-48-10E 2791.891 ft. of N 1/4 corner  
S85-23-52W 2586.313 ft. of E 1/4 corner  
N0-48-10W 26.06.549 ft. of S 1/4 corner and  
N85-23-52E 2436.996 ft. of W 1/4 corner.

Description of monument and accessories I established to perpetuate the original location of this corner.

Set a 2 1/2" aluminum pipe with alloy cap stamped:  
Monument projects 24" above ground

Marked NBTs

Sugar 6" N80E 14.72 ft.  
Sugar 8" S28E 1.12 ft. - Scribed C 1/4 - B.T.  
Sugar 12" N50W 27.85 ft.

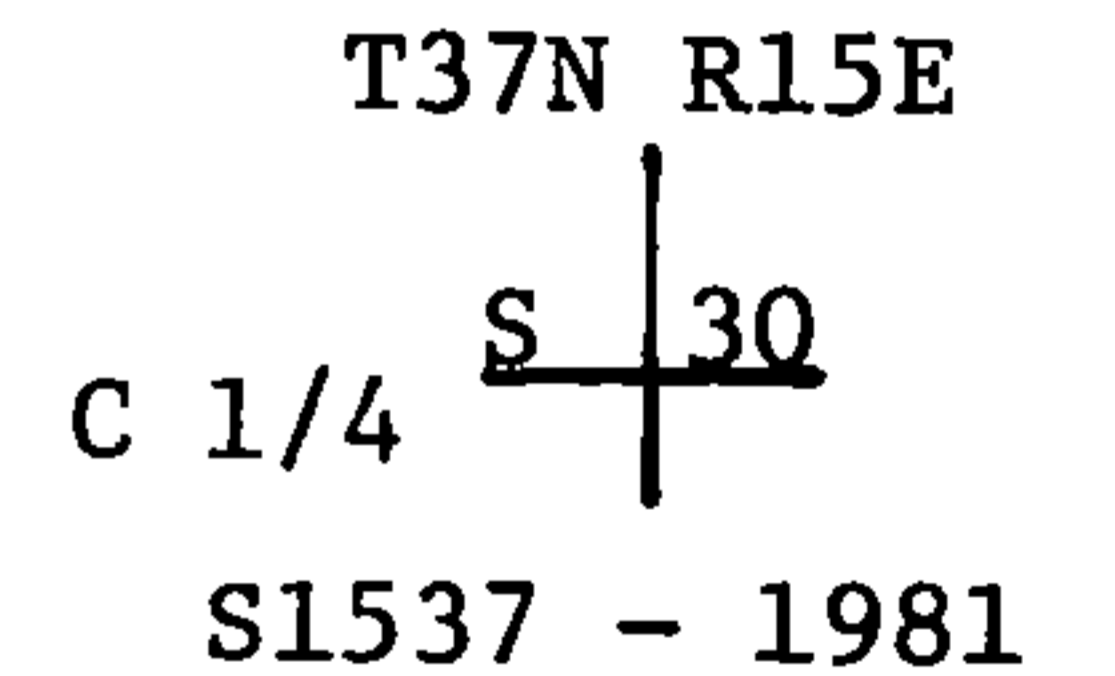

FORM 985 H. C. MILLER CO., MILWAUKEE

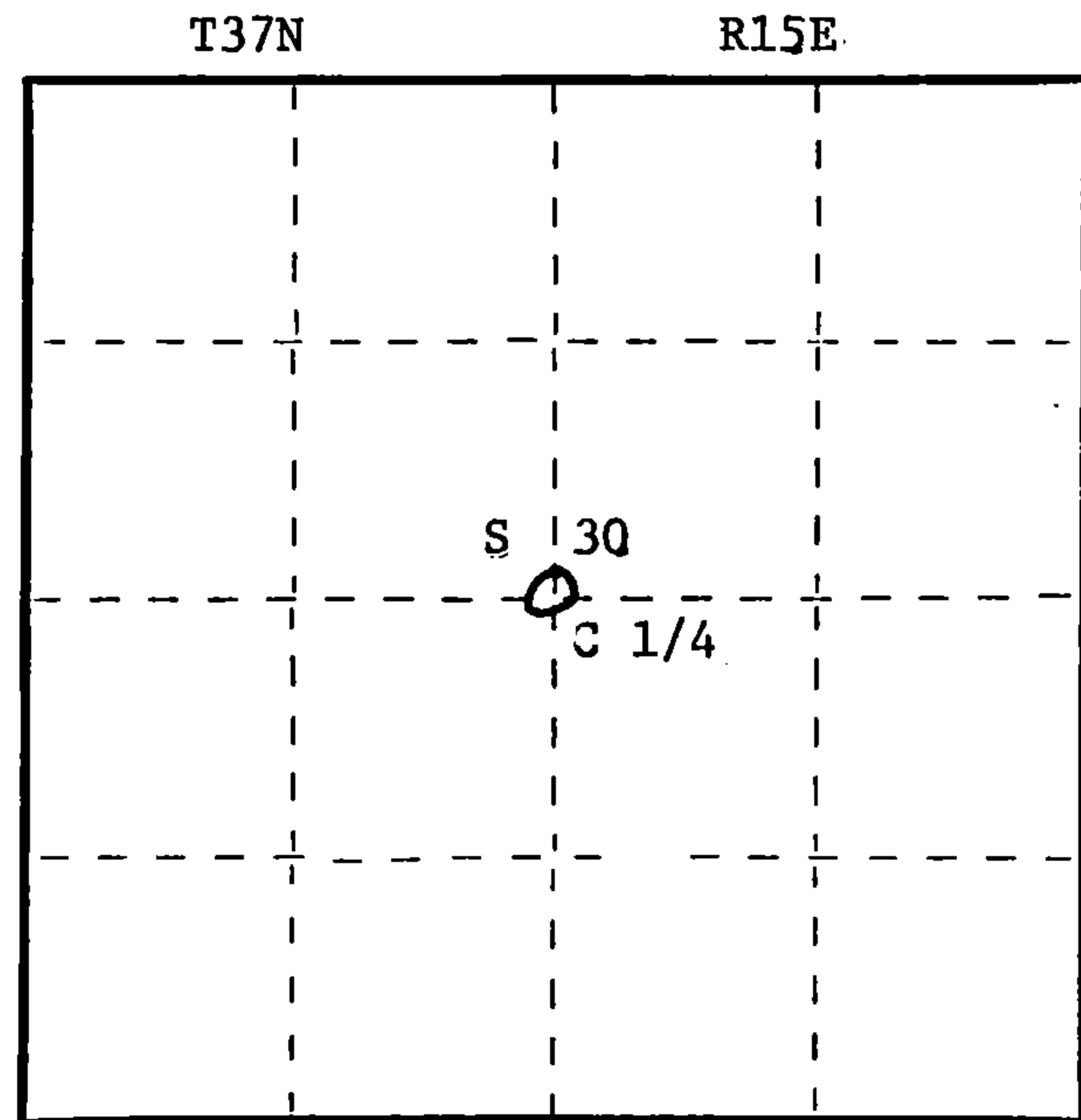

○ = Corner monument restored.

Dated at Rhinelander, Wis., this 21 day of September, 19 81

Signature Daniel K. Pleoger Title Registered Land Surveyor Registration No. 1537  
(County Surveyor, Registered Land Surveyor, or other duly authorized official)

Office of Register of Deeds, County of Forest, I hereby certify that the within instrument was filed in this office for record on the 25th day of September, 19 81 at 2:00 o'clock P. M.

Eugene Staszynski (Register of Deeds)  
By Deputy

DOCUMENT NO. 120534

4371530 2020

FIELD SURVEY NOTES  
**PRESERVATION OF LANDMARKS**  
(Pursuant to Section 59.635(7) Wisconsin Statutes)

Wisconsin Department of Transportation  
E-D-707-67

COUNTY <i>Forest</i>		
TOWN <i>Caswell</i>		
HIGHWAY <i>C.T.H. 'G'</i>		
SECTION <i>30</i>	TOWNSHIP <i>37 N</i>	RANGE <i>15 E</i>
TYPE OF LANDMARK <i>Property Corner</i>		

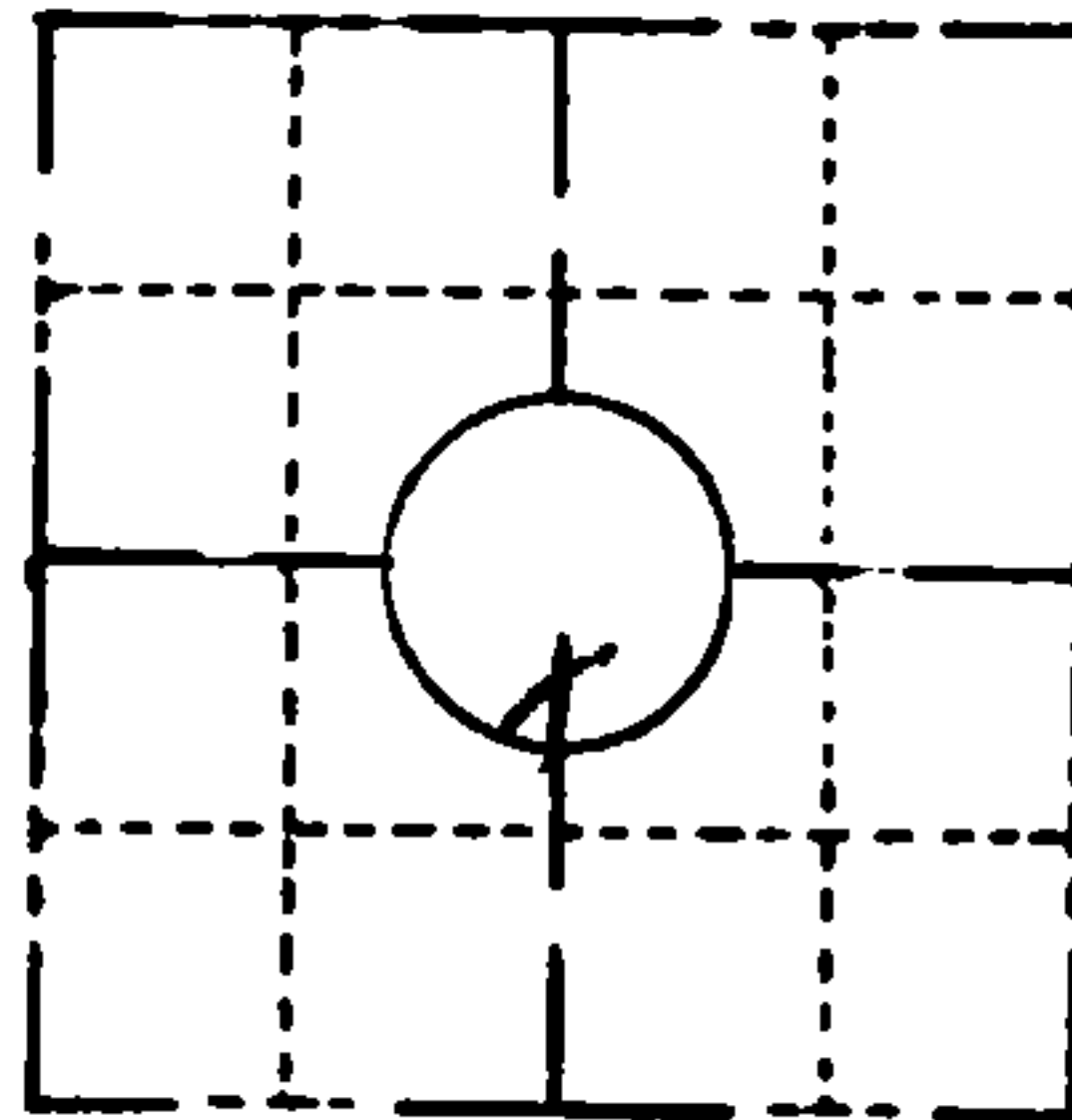

**LOCATION SKETCH**  
(Location of landmark indicated by "x")

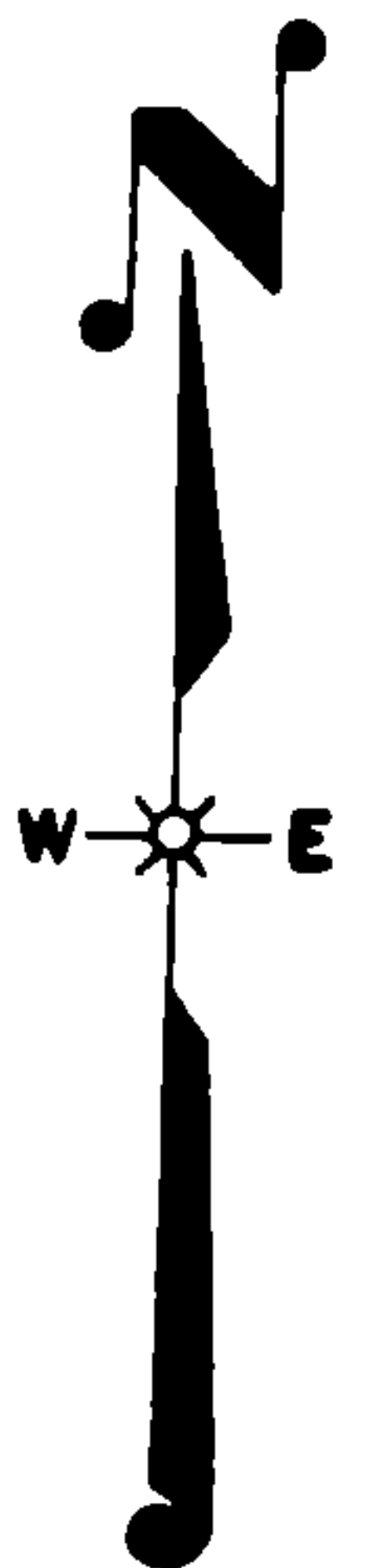

This space for copy of field notes or ties to the above described landmarks

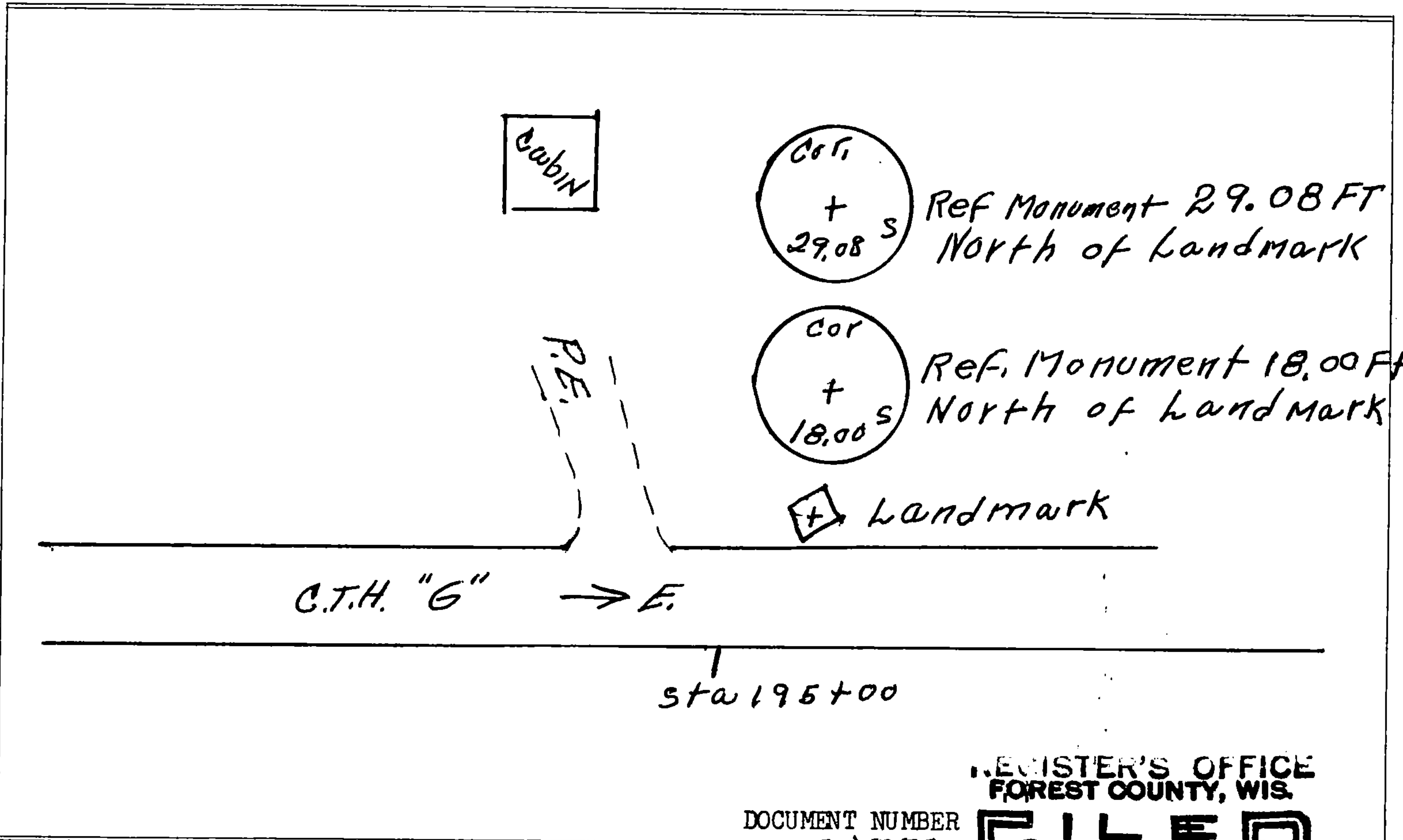

REGISTER'S OFFICE  
FOREST COUNTY, WIS.

DOCUMENT NUMBER

**97550**

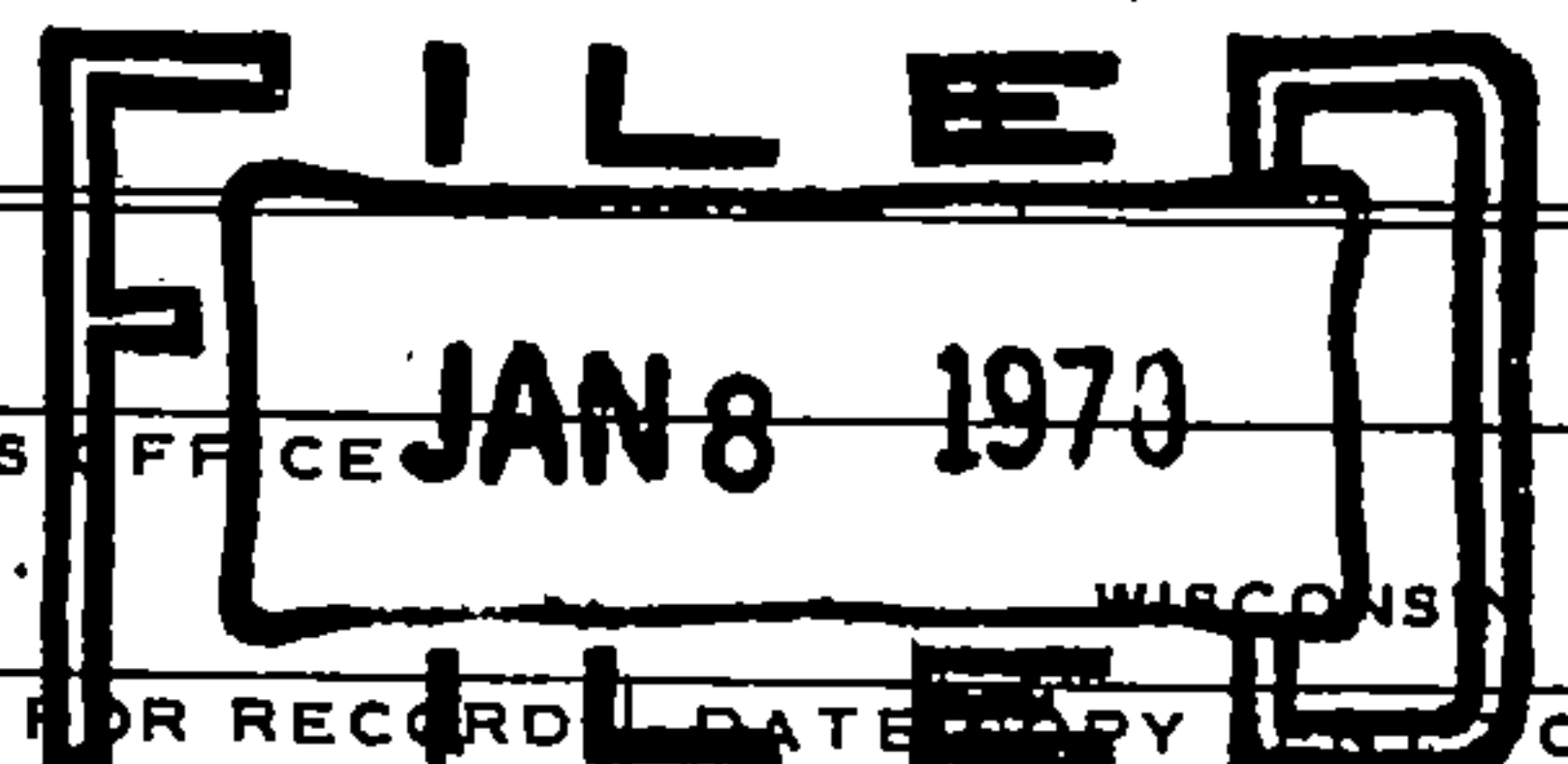

FILED UNDER PROJECT NUMBER <i>S 0710 (3) 9333-1-70</i>		
SHC DISTRICT OFFICE NUMBER <i>7</i>	CITY <i>Rhinelander</i>	COUNTY <i>Oneida</i>
LOCATED OR ESTABLISHED BY NAME <i>James Martinson</i> TITLE <i>Prof. Eng.</i> DATE <i>11-18-69</i>		

COUNTY CLERK'S OFFICE	WISCONSIN
COUNTY OF	SS
DATE RECEIVED FOR RECORD	DATE BY
<i>1/8/70</i>	<i>At 3:15 P.M. 1/8/70</i>
SIGNATURE OF COUNTY CLERK <i>Kenneth Conway</i>	

PRESERVATION OF LANDMARKS

PAGE \_\_\_\_\_

43715302020

703