

CERTIFIED LAND CORNER RESTORATION

Index No. **V-2**

State of Wisconsin }
County of Forest } ss.

I Daniel K. Pleoger, do hereby certify that on the 29 day of June, 19 81, I found evidence of the W 1/16 corner of Sections 30 & 31 Township 37 North, Range 15 East, Fourth Principal Meridian, as described hereon; and that from this evidence I established a new monument and accessories as described hereon to perpetuate the original location of this corner.

Resident witnesses:

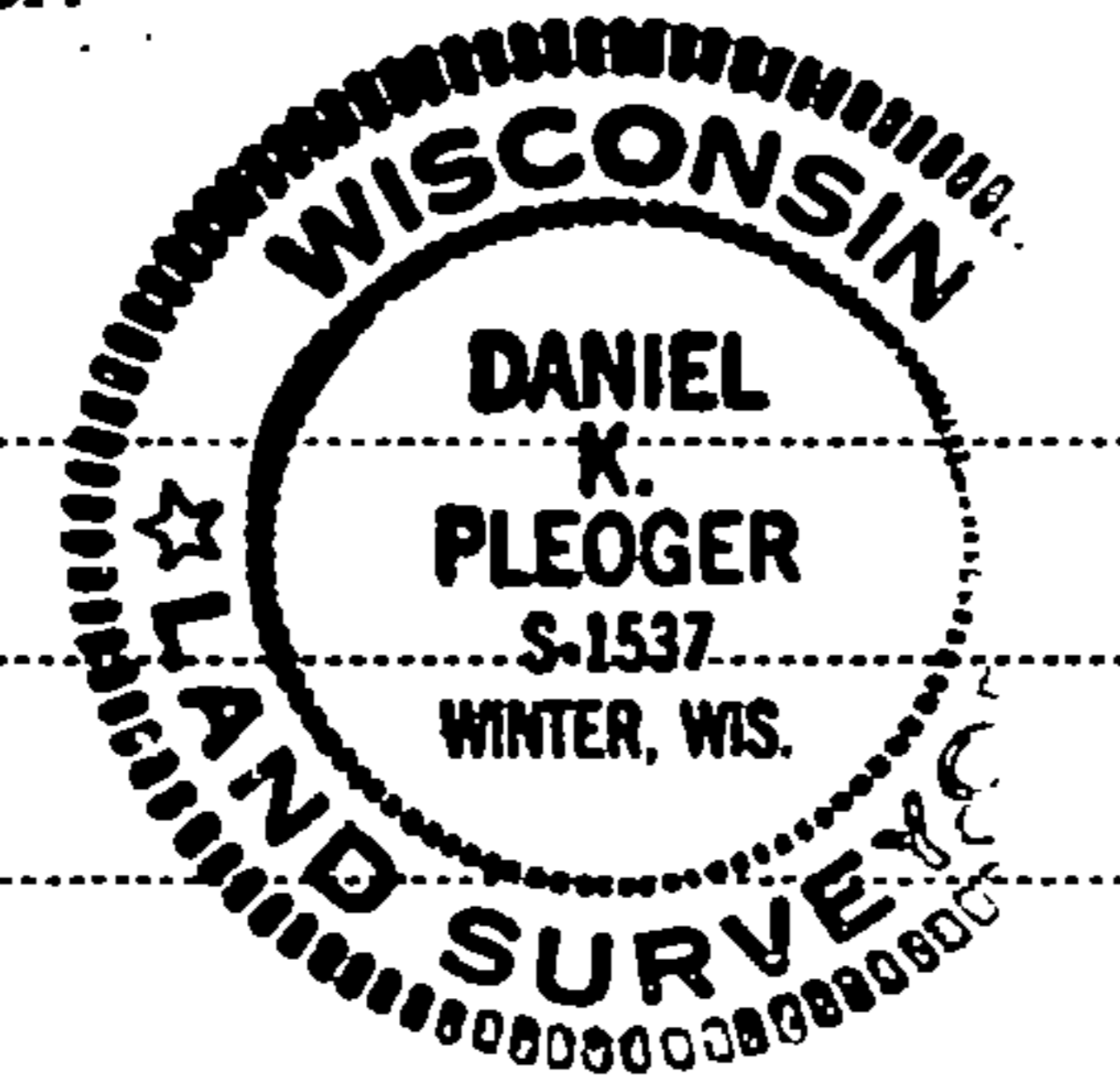

FORM 985 H. C. MILLER CO., MILWAUKEE

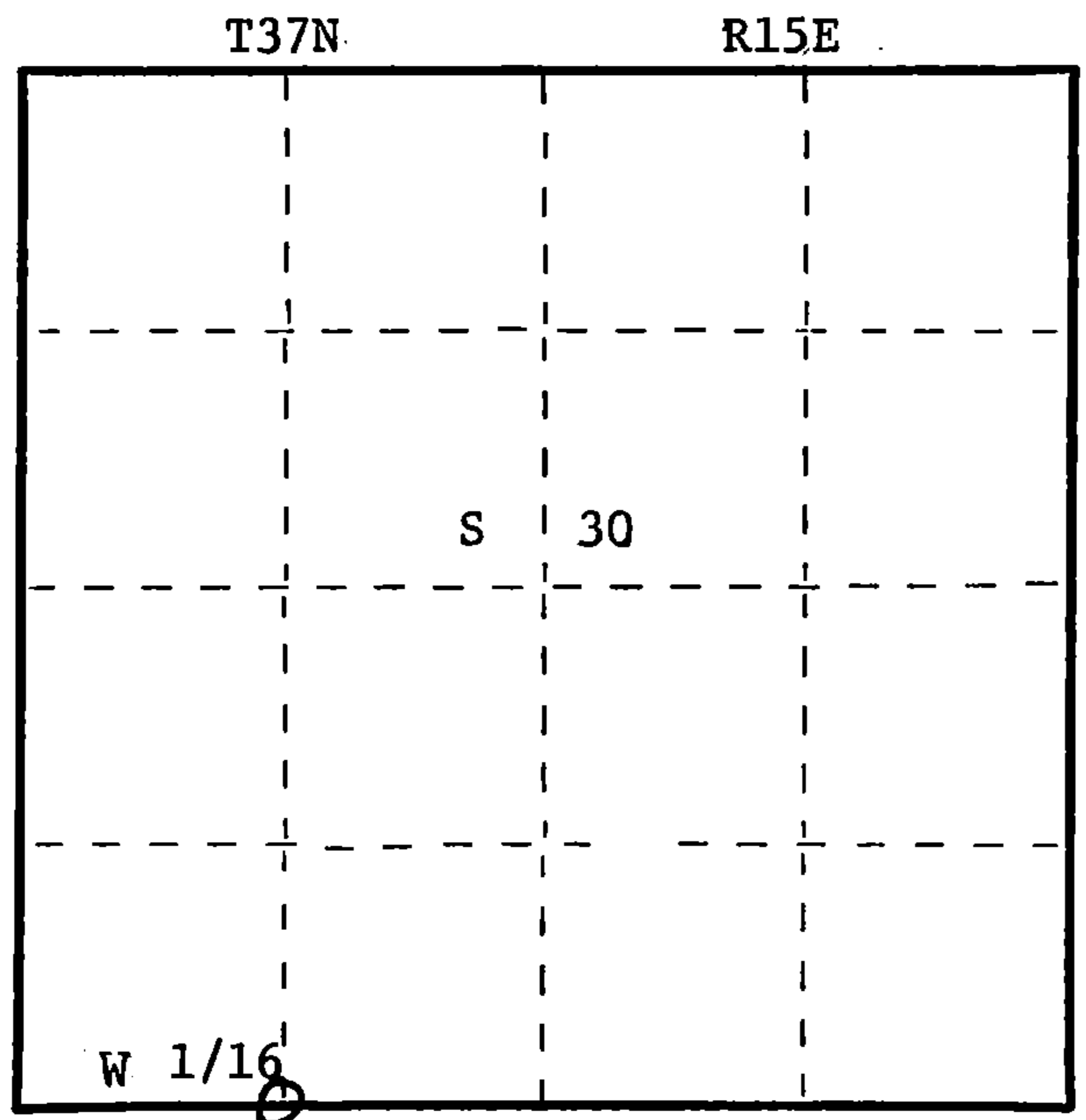

○ = Corner monument restored.

History of original corner establishment:

No evidence of any previous corner.

Description of corner evidence found:

Total distance from section corner 25-36 & 30-31 T37N R14 & 15E to 1/4 corner between sections 30-31 for a total distance of 2466.233 ft. at bearing N84-46-53W. Set W 1/16 1236.85 ft. of section corner and 1229.428 ft. of 1/4 corner.

Description of monument and accessories I established to perpetuate the original location of this corner.

Set a railroad spike 3 ft. north of CTH "G" for true corner.
Set a 1 1/2" iron pipe with 2" diameter brass cap for witness corner stamped:

Marked NBTs to true corner

Maple 5" N2°E 72.56 ft. Scribed 1/16 - B.T.
Twin maple 5" N28W 66.51 ft.

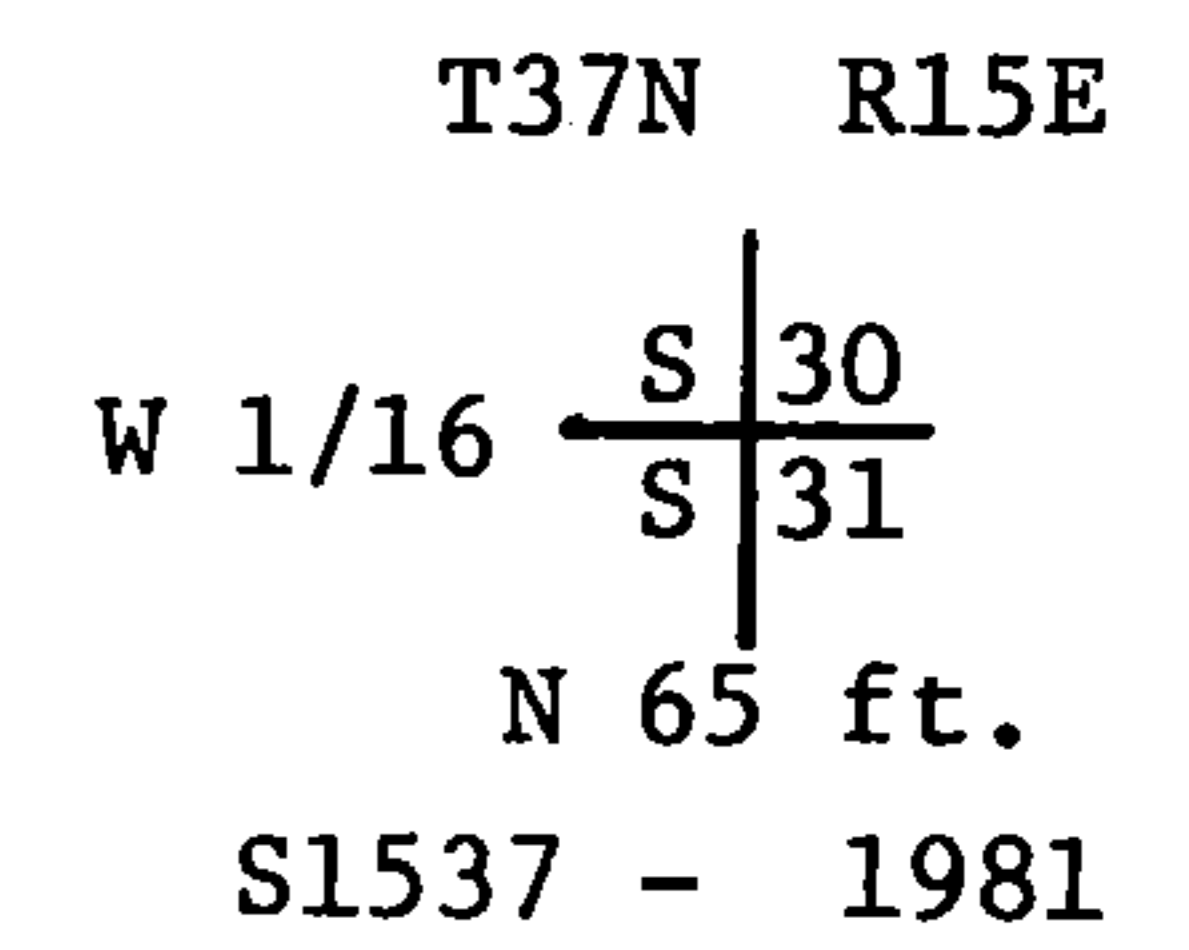

Dated at Rhinelander, Wis., this 21 day of September, 19 81

Signature Daniel K. Pleoger Title Registered Land Surveyor Registration No. 1537
(County Surveyor, Registered Land Surveyor, or other duly authorized official)

Office of Register of Deeds, County of Forest, I hereby certify that the within instrument was filed in this office for record on the 25th day of September, 19 81 at 2:00 o'clock P. M.

Eugene Staszny
(Register of Deeds)

DOCUMENT NO. 120537

By Deputy

43715300030